

**LEFT
EXIT 99**

STA 482+66.50
STR NO 4S0901074L100.0

 WEST Moline Rock Island	 WEST Peoria
 EXIT ONLY	

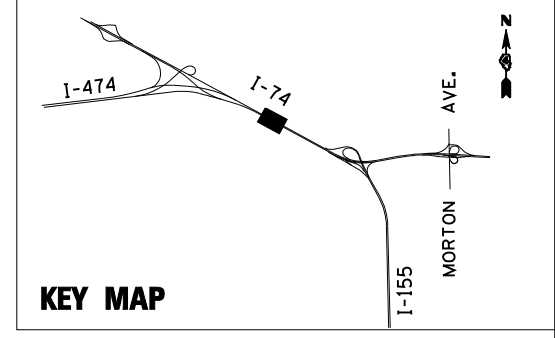

R3-4 (36x36)
STA 475+35, 0' LT

 R5-11 (30x24)
STA 475+35, 0' LT

D10-3 (12x48)
STA 481+20, 67' LT

R3-4 (36x36)
STA 476+65, 0' LT

 R5-11 (30x24)
STA 476+65, 0' LT

D10-3 (12x48)
STA 481+22, 71' RT

MATCH LINE STA. 471+00.00 C I-74

MATCH LINE STA. 486+00.00 C I-74

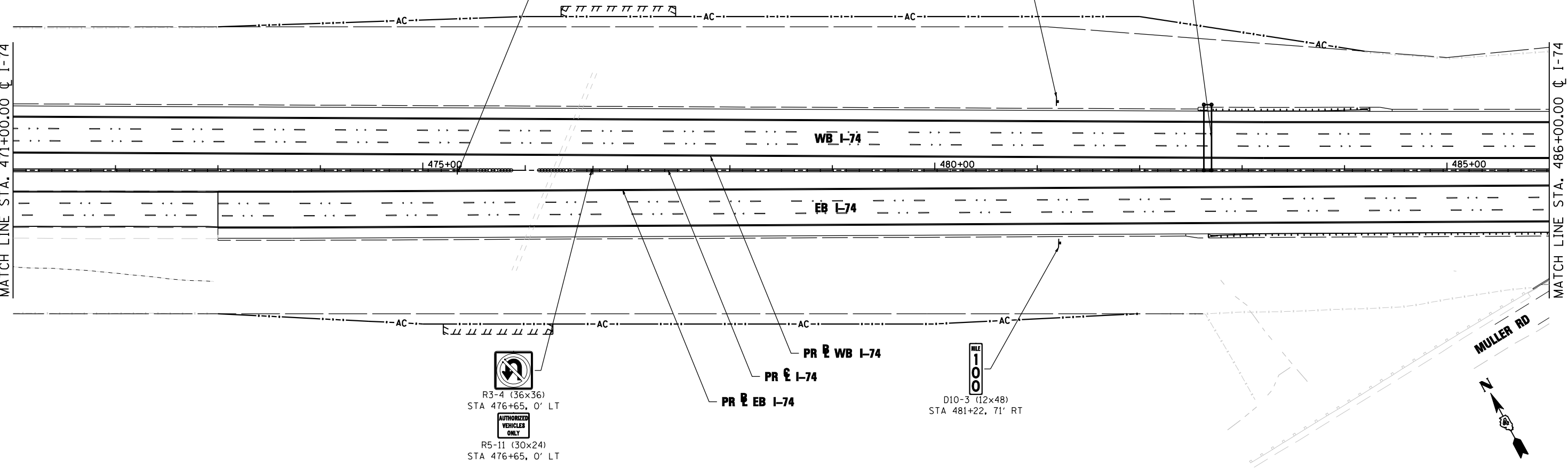

FILE NAME =	DESIGNED - LDC	REVISED -
...D468620-sh1-1-74-sign02.dgn	DRAWN - SMS	REVISED -
USER NAME = IDOT	CHECKED - GEB	REVISED -
PLOT DATE = 7/16/2012	DATE - JULY 20, 2012	REVISED -



**STATE OF ILLINOIS
DEPARTMENT OF TRANSPORTATION**

**SIGNING PLAN
I-74**

SCALE: 1"=50' SHEET NO. 2 OF 36 SHEETS STA. 471+00.00 TO STA. 486+00.00

F.A.I. RTE.	SECTION	COUNTY	TOTAL SHEETS	SHEET NO.
• 90-I14R(14HB-4,14,14HVB)BR		TAZEWELL	2433	1549
			CONTRACT NO. 68620	
ILLINOIS FED. AID PROJECT				