

- STAGE 1 REMOVAL**
- 1) Remove approximately 4'-10" of the existing WB bridge
 - 2) Remove approximately 6'-10" of the existing EB bridge

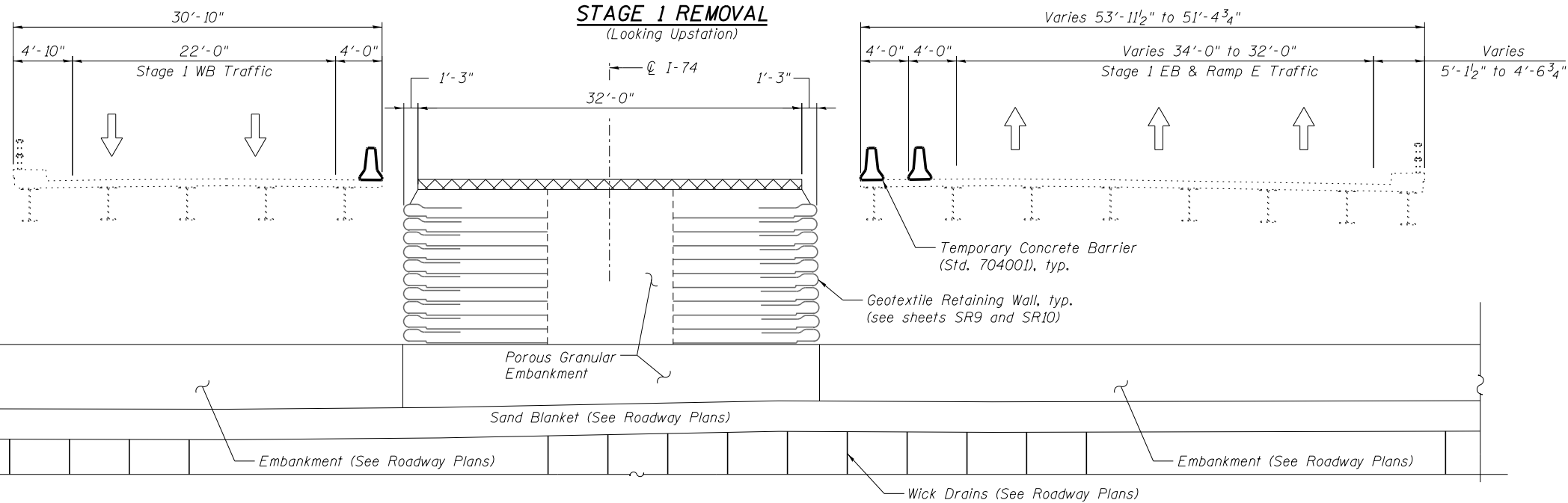

- STAGE 1 CONSTRUCTION**
- 1) Existing ground in vicinity of existing piers shall be excavated for Lightweight Cellular Concrete Fill as shown on sheet SR10.
 - 2) Lightweight Cellular Concrete Fill shall be placed to the elevation of existing ground.
 - 3) A free draining sand blanket layer shall be placed on the existing ground beneath both existing WB and EB structures.
 - 4) Wick Drains shall be installed to facilitate consolidation (see Roadway plans).
 - 5) Embankment shall be placed and compacted beneath the existing WB and EB structures so that the top of embankment is located 10'-0" from bottom of existing girders.
 - 6) Settlement Platforms shall be installed to monitor consolidation (see Roadway plans).
 - 7) Geotextile Retaining Wall shall be installed at the locations and to the limits shown on sheet SR9.
 - 8) Porous Granular Embankment shall be placed between the Geotextile Retaining Walls.
 - 9) Temporary Pavement shall be installed above the Geotextile Retaining Walls

- STAGE 1 TRAFFIC**
- WB I-74 traffic on existing WB bridge
 - EB I-74 traffic and Ramp E traffic on existing EB bridge

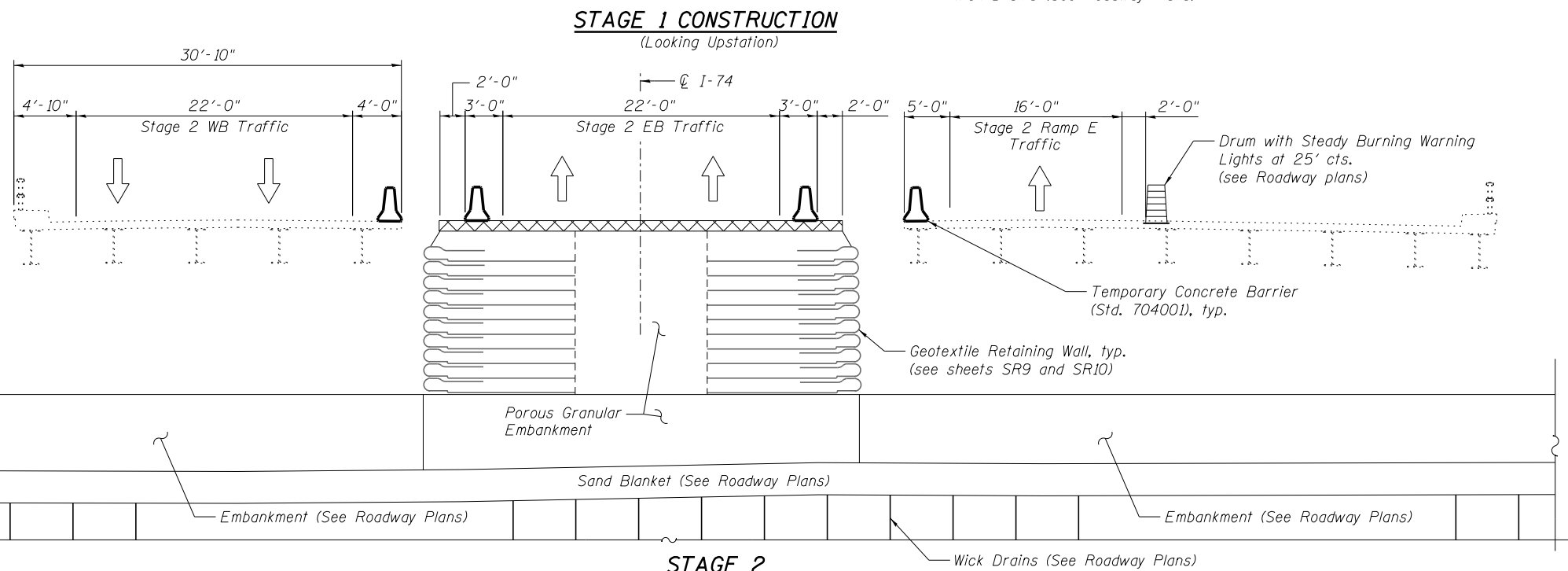

- STAGE 2 TRAFFIC**
- WB I-74 traffic on existing WB bridge
 - EB I-74 traffic on temporary pavement
 - Ramp E traffic on existing EB bridge

- LEGEND:**
- ⊗ Indicates temporary pavement
 - ▨ Indicates removal

- NOTE:**
- See Maintenance of Traffic plans for more information.

benesch
engineers · scientists · planners

Alfred Benesch & Company
205 North Michigan Avenue, Suite 2400
Chicago, Illinois 60601
312-565-0450 Job No. 10056

FILE NAME =	USER NAME = mbecker	DESIGNED - MFB	REVISED -
xxxxxx_68620_03.stgl.dgn		CHECKED - KWS	REVISED -
	PLOT SCALE =	DRAWN - MFB/DTS	REVISED -
	PLOT DATE = 7/16/2012	CHECKED - KWS	REVISED -

STATE OF ILLINOIS
DEPARTMENT OF TRANSPORTATION

STAGE REMOVAL DETAILS 1 OF 5
STRUCTURE NO. 090-0014 / 0015 REMOVAL

SHEET NO. SR3 OF SR22 SHEETS

F.A.I. RTE.	SECTION	COUNTY	TOTAL SHEETS	SHEET NO.
74	90-[14R;14HB-4,14,14HVB]BRJ	TAZEWELL	2433	2071
CONTRACT NO. 68620				
ILLINOIS FED. AID PROJECT				

X:\100005\10056\Engineering\Documents_Phase_1\174overRR\Final\xxxxxx_68620_03.stgl.dgn 7:44:37 AM 7/16/2012