

PAVEMENT MARKING LEGEND

- ① THERMOPLASTIC PAVEMENT MARKING, LINE 5" (SOLID YELLOW)
- ② MODIFIED URETHANE PAVEMENT MARKING, LINE 6" (SOLID WHITE)
- ③ MODIFIED URETHANE PAVEMENT MARKING, LINE 6" (2' DASH, 6' SKIP, WHITE)
- ④ MODIFIED URETHANE PAVEMENT MARKING, LINE 5" (SOLID WHITE)
- ⑤ MODIFIED URETHANE PAVEMENT MARKING, LINE 5" (10' DASH, 30' SKIP, YELLOW)
- ⑥ MODIFIED URETHANE PAVEMENT MARKING, LINE 12" (SOLID YELLOW)
- ⑦ MODIFIED URETHANE PAVEMENT MARKING, LINE 5" (SOLID YELLOW)
- ⑧ PREFORMED PLASTIC PAVEMENT MARKING, TYPE B - INLAID - LINE 24" (SOLID WHITE)
- ↖ PREFORMED PLASTIC PAVEMENT MARKING, TYPE B - INLAID - LETTERS & SYMBOLS (WHITE)
- ◆ RAISED REFLECTIVE PAVEMENT MARKER (2 WAY AMBER)
- ◀ RAISED REFLECTIVE PAVEMENT MARKER (1 WAY AMBER)
- ◁ RAISED REFLECTIVE PAVEMENT MARKER (1 WAY CRYSTAL)

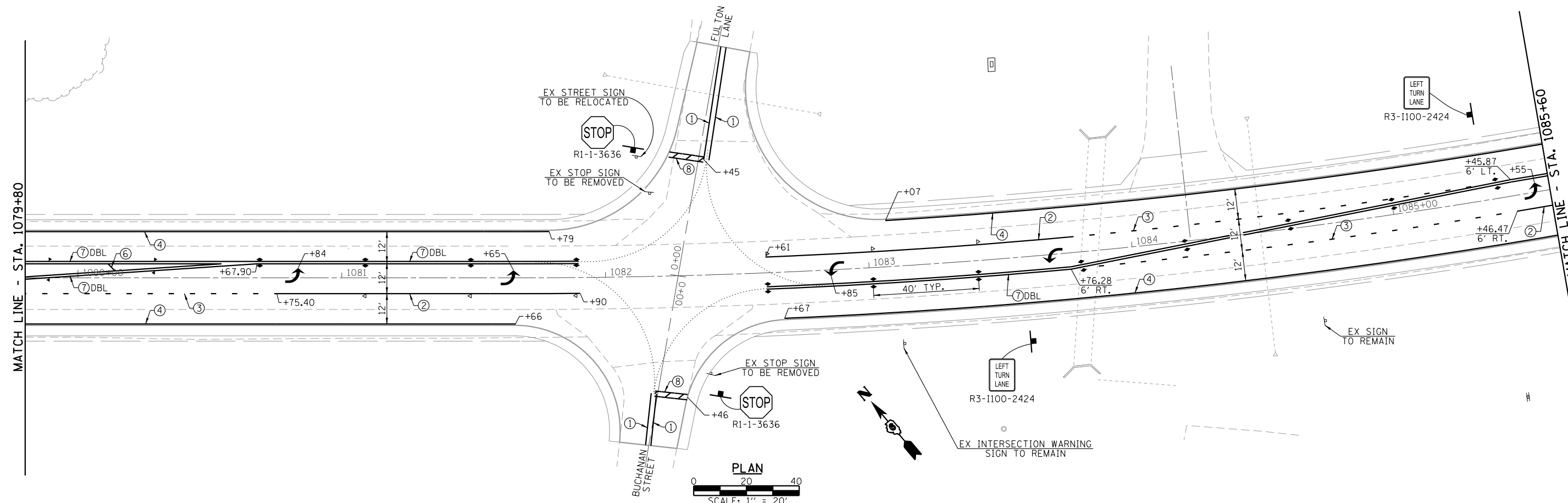
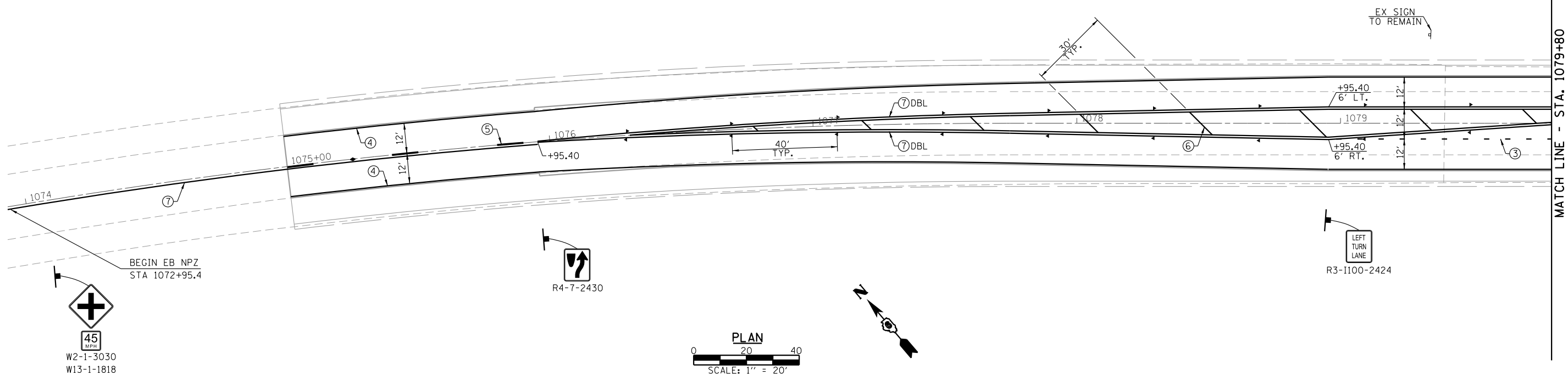

USER NAME = *USER*	DESIGNED -	REVISED -
PLOT SCALE = *SCALE*	DRAWN -	REVISED -
PLOT DATE = *DATE*	CHECKED -	REVISED -
	DATE -	REVISED -

Allen Henderson & Associates, Inc.
Civil and Structural Engineers Springfield, IL
62703 Phone: (217)544-8033 IL Design Firm
No. 184-001907

PAVEMENT MARKING PLAN
SCALE: 1" = 20' SHEET NO. 1 OF 3 SHEETS STA. 10+75 TO STA. 1085+60

F.A.P. RTE.	SECTION	COUNTY	TOTAL SHEETS	SHEET NO.
67	3 (N, L, RS-3)	CASS	64	27
CONTRACT NO. 72075				
FED. ROAD DIST. NO. ILLINOIS FED. AID PROJECT				