

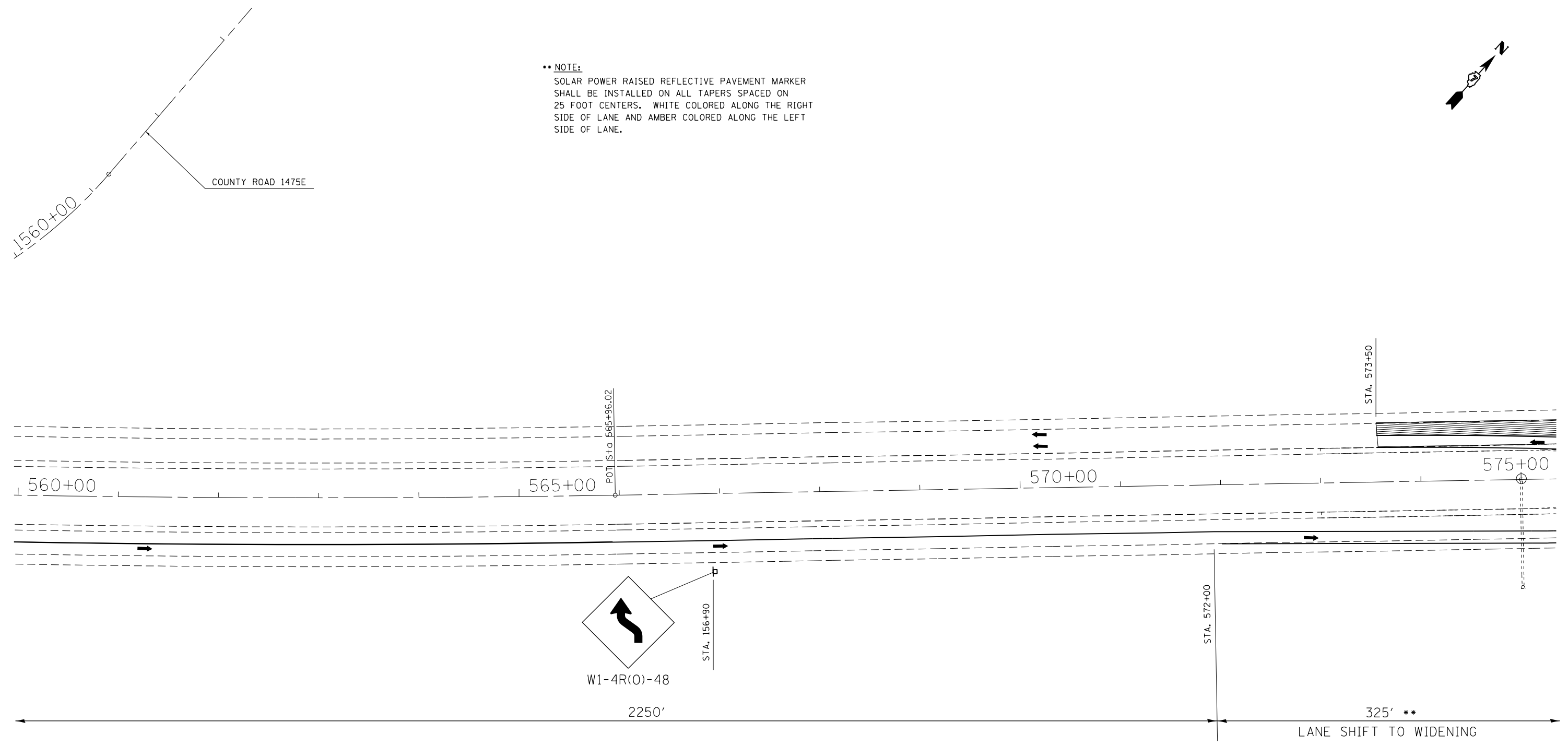





**\*\* NOTE:**  
 SOLAR POWER RAISED REFLECTIVE PAVEMENT MARKER SHALL BE INSTALLED ON ALL TAPERS SPACED ON 25 FOOT CENTERS. WHITE COLORED ALONG THE RIGHT SIDE OF LANE AND AMBER COLORED ALONG THE LEFT SIDE OF LANE.



**LEGEND**

-  WORK AREA
-  TEMPORARY CONCRETE BARRIER
-  PAVEMENT MARKING
-  TYPE II BARRICADE W/STEADY BURN MONODIRECTIONAL LIGHT
-  DRUM W/STEADY BURN MONODIRECTIONAL LIGHT

|   |                              |            |           |
|---|------------------------------|------------|-----------|
| FILE NAME =   | USER NAME = steffenmk        | DESIGNED - | REVISED - |
| ci:\pw\work\p\midot\steffenmk\d0186453\d74466-sh1-staging.dgn |                              | DRAWN -    | REVISED - |
|   | PLOT SCALE = 100.0000' / in. | CHECKED -  | REVISED - |
|   | PLOT DATE = 8/20/2012        | DATE -     | REVISED - |

**STATE OF ILLINOIS  
 DEPARTMENT OF TRANSPORTATION**

**STAGE 2**

SCALE: 50      SHEET NO. 3 OF 12 SHEETS      STA. 560+00      TO STA. 575+00

|                                |         |                    |           |
|--------------------------------|---------|--------------------|-----------|
| (18-47-VB)K,(18-47B,18-47HB)BR |         | TOTAL SHEETS       | SHEET NO. |
| F.A.I. RTE.                    | SECTION | COUNTY             |           |
| 70                             | .       | CUMBERLAND         | 147 42    |
|                                |         | CONTRACT NO. 74466 |           |
| ILLINOIS FED. AID PROJECT      |         |                    |           |