

**NORTH CURB LINE**

Location	Station	Offset	Theoretical Grade Elevations
W. End of West Appr. Pav't.	142+05.50	27.85 Rt.	555.61
A1	142+15.55	27.99 Rt.	555.56
A2	142+25.60	28.12 Rt.	555.52
E. End of West Appr. Pav't.	142+35.65	28.23 Rt.	555.47

**NORTH EDGE OF PAVEMENT**

Location	Station	Offset	Theoretical Grade Elevations
W. End of West Appr. Pav't.	142+08.67	35.00 Rt.	555.40
A1	142+18.67	35.00 Rt.	555.35
A2	142+28.68	35.00 Rt.	555.31
E. End of West Appr. Pav't.	142+38.69	35.00 Rt.	555.26

**☉ E.B. LANES AND P.G.**

Location	Station	Offset	Theoretical Grade Elevations
W. End of West Appr. Pav't.	142+14.00	47.00 Rt.	555.04
A1	142+24.03	47.00 Rt.	554.99
A2	142+34.06	47.00 Rt.	554.95
E. End of West Appr. Pav't.	142+44.10	47.00 Rt.	554.90

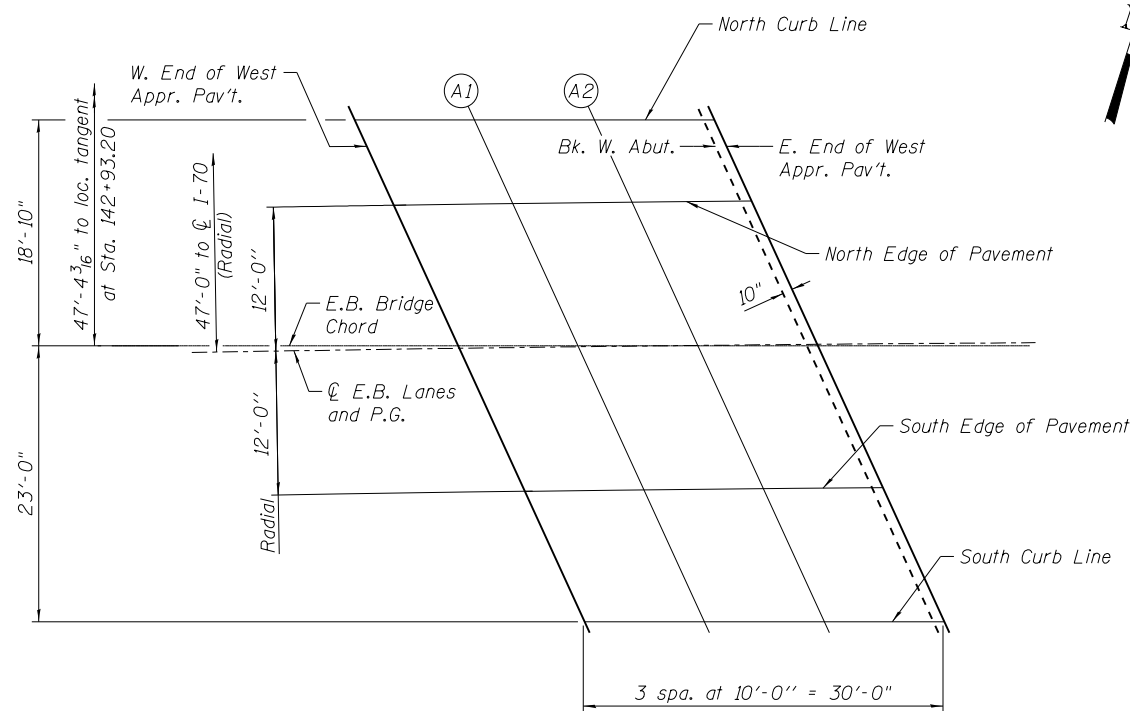

**PLAN**  
West Approach (E.B.)

**SOUTH EDGE OF PAVEMENT**

Location	Station	Offset	Theoretical Grade Elevations
W. End of West Appr. Pav't.	142+19.36	59.00 Rt.	554.68
A1	142+29.41	59.00 Rt.	554.63
A2	142+39.46	59.00 Rt.	554.59
E. End of West Appr. Pav't.	142+49.53	59.00 Rt.	554.54

**SOUTH CURB LINE**

Location	Station	Offset	Theoretical Grade Elevations
W. End of West Appr. Pav't.	142+24.26	69.94 Rt.	554.35
A1	142+34.38	70.05 Rt.	554.30
A2	142+44.51	70.14 Rt.	554.25
E. End of West Appr. Pav't.	142+54.63	70.22 Rt.	554.21

N:\PROJECTS\0003377\00\0003377\07\Design\Structure\CAD\018-0047 & 018-0048-74466\_09 Top of West Approach Slab (E.B).dgn



USER NAME = bsauter	DESIGNED - AMK	REVISED -
	CHECKED - MHT	REVISED -
PLOT SCALE = 16x0.0000 '1' / in.	DRAWN - RD	REVISED -
PLOT DATE = 8/14/2012	CHECKED - MHT	REVISED -

**STATE OF ILLINOIS  
DEPARTMENT OF TRANSPORTATION**

**E.B. TOP OF WEST APPROACH SLAB ELEVATIONS  
SN 018-0047 (W.B.) & 018-0048 (E.B.)**

SHEET NO. S-9 OF S-34 SHEETS

F.A.I. RTE.	SECTION	COUNTY	TOTAL SHEETS	SHEET NO.
70	(18-47B, 18-47HB)BR	CUMBERLAND	147	67
<b>CONTRACT NO. 74466</b>				
ILLINOIS FED. AID PROJECT				