

NORTH CURB LINE

Location	Station	Offset	Theoretical Grade Elevations
W. End of East Appr. Pav't.	143+72.91	27.96 Rt.	554.80
A3	143+82.96	27.82 Rt.	554.75
A4	143+93.00	27.65 Rt.	554.70
E. End of East Appr. Pav't.	144+03.05	27.47 Rt.	554.65

NORTH EDGE OF PAVEMENT

Location	Station	Offset	Theoretical Grade Elevations
W. End of East Appr. Pav't.	143+76.27	35.00 Rt.	554.58
A3	143+86.41	35.00 Rt.	554.53
A4	143+96.55	35.00 Rt.	554.47
E. End of East Appr. Pav't.	144+06.70	35.00 Rt.	554.41

☉ E.B. LANES AND P.G.

Location	Station	Offset	Theoretical Grade Elevations
W. End of East Appr. Pav't.	143+82.03	47.00 Rt.	554.21
A3	143+92.19	47.00 Rt.	554.16
A4	144+02.36	47.00 Rt.	554.10
E. End of East Appr. Pav't.	144+12.54	47.00 Rt.	554.05

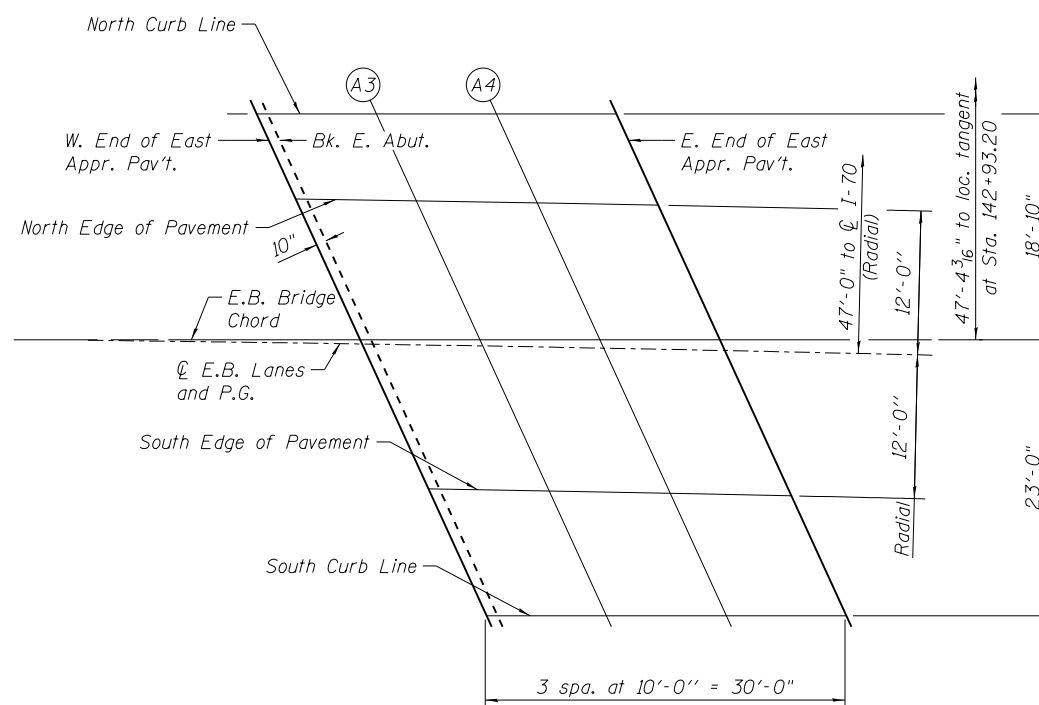

PLAN
East Approach (E.B.)

SOUTH EDGE OF PAVEMENT

Location	Station	Offset	Theoretical Grade Elevations
W. End of East Appr. Pav't.	143+87.82	59.00 Rt.	553.85
A3	143+98.01	59.00 Rt.	553.79
A4	144+08.20	59.00 Rt.	553.73
E. End of East Appr. Pav't.	144+18.41	59.00 Rt.	553.68

SOUTH CURB LINE

Location	Station	Offset	Theoretical Grade Elevations
W. End of East Appr. Pav't.	143+92.90	69.49 Rt.	553.53
A3	144+03.02	69.31 Rt.	553.47
A4	144+13.14	69.11 Rt.	553.42
E. End of East Appr. Pav't.	144+23.26	68.89 Rt.	553.37

N:\PROJ\0003377\00\0003377\07\Design\Structure\CAD\018-0047 & 018-0048-74466_10_Top of East Approach Slab (E.B).dgn



USER NAME = bsauter	DESIGNED - AMK	REVISED -
	CHECKED - MHT	REVISED -
PLOT SCALE = 16x0.0000 '1' / in.	DRAWN - RD	REVISED -
PLOT DATE = 8/14/2012	CHECKED - MHT	REVISED -

**STATE OF ILLINOIS
DEPARTMENT OF TRANSPORTATION**

**E.B. TOP OF EAST APPROACH SLAB ELEVATIONS
SN 018-0047 (W.B.) & 018-0048 (E.B.)**

SHEET NO. S-10 OF S-34 SHEETS

F.A.I. RTE.	SECTION	COUNTY	TOTAL SHEETS	SHEET NO.
70	(18-47B, 18-47HB)BR	CUMBERLAND	147	68
CONTRACT NO. 74466				
ILLINOIS FED. AID PROJECT				