

STATE OF ILLINOIS  
DEPARTMENT OF PUBLIC WORKS & BUILDINGS  
DIVISION OF HIGHWAYS

PROJECT NO.	18-47	SECTION	29	SHEET NO.	4
S.D.A.	1770	DESIGNER	CUMBERLAND	TOTAL SHEETS	19
DATE		DATE			

Note:  
Bars indicated thus 20x3-#5 etc. indicates  
20 lines of bars with 3 lengths per line  
Min bar laps = 20 dia.

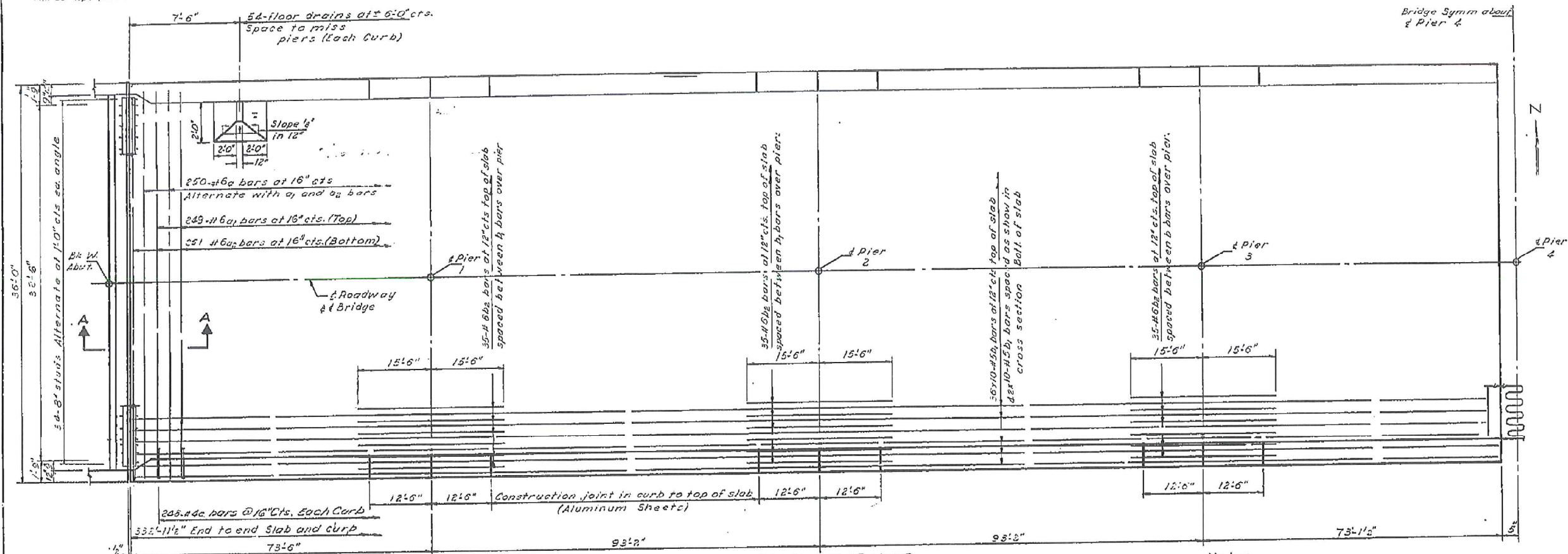

PLAN - WEST HALF  
(North & South Bridges)

Note:  
For end detail at expansion device and  
Pier #4, see sheet #8  
For Bill of Material, Cross Sections, and  
Details, see sheet #5.

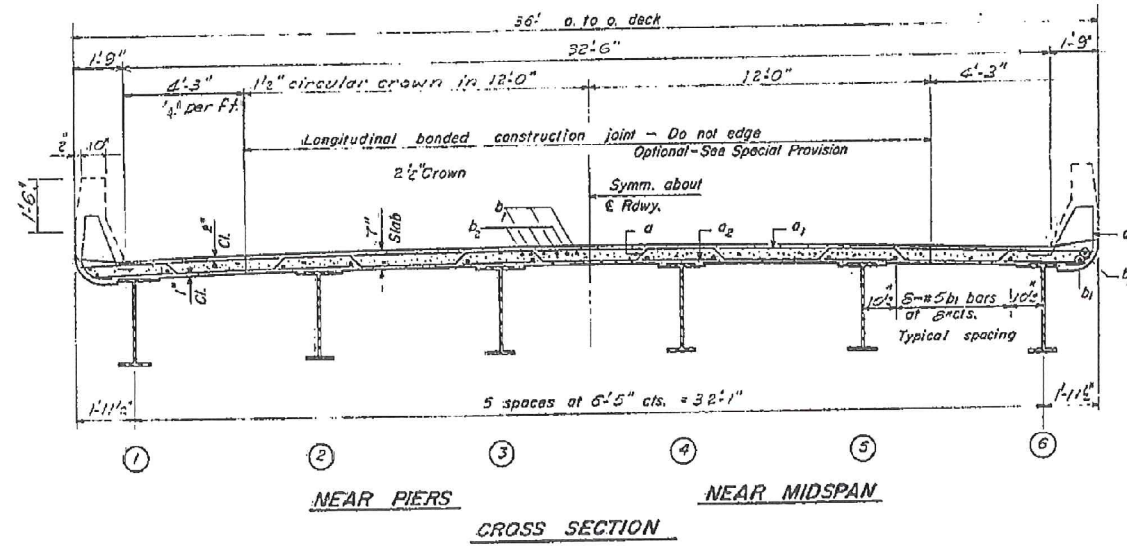

CROSS SECTION

DESIGNED	John W. Cook Jr.	EXAMINED	Jan. 12, 1966
CHECKED	J. Kessler	PASSED	
DRAWN	J. Kessler	APPROVED	
CHECKED	J. E.		

**SUPERSTRUCTURE**  
**NORTH & SOUTH BRIDGES**  
**F.A.T. RT. 70 SEC. 18-47B**  
**CUMBERLAND COUNTY**  
**STATION 158+31**

Rev 9-5-67 JWC Removed 3'-0" curb see sheet #5 for quantity changes.

BLANK, WESSELINK, COOK & ASSOCIATES DECATUR, ILLINOIS ENGINEERS - CONSULTANTS DESIGN FIRM NO. 184000894

FILE NAME =	USER NAME =	DESIGNED PBB	REVISED -	<b>STATE OF ILLINOIS DEPARTMENT OF TRANSPORTATION</b>	<b>EXISTING BRIDGE PLANS STRUCTURE NO. 018-0049(W.B.) &amp; 0050(E.B.)</b>	F.A.I. RTE.	SECTION	COUNTY	TOTAL SHEETS	SHEET NO.
	CHECKED MCB	REVISED -	70			(18-47-VBK (18-47B, 18-47HB)BR	CUMBERLAND	147	128	
PLOT SCALE =	DRAWN MLO	REVISED -	CONTRACT NO. 74466							
PLOT DATE =	CHECKED MCB	REVISED -	ILLINOIS FED. AID PROJECT							