

STATE OF ILLINOIS
DEPARTMENT OF TRANSPORTATION
DIVISION OF HIGHWAYS

**PROPOSED
HIGHWAY PLANS**

FAP ROUTE 805 (IL 161)
SECTION (101, 102, 61-1-1)I-1
PROJECT ACHSIP-0805(075)
MILLED RUMBLE STRIP SHOULDERS
MARION COUNTY

C-98-090-12

F.A.P. RTE.	SECTION	COUNTY	TOTAL SHEETS	SHEET NO.
805	101, 102, 61-1-1I-1	MARION	30	1
		ILLINOIS	CONTRACT NO. 76F98	

D-98-081-12

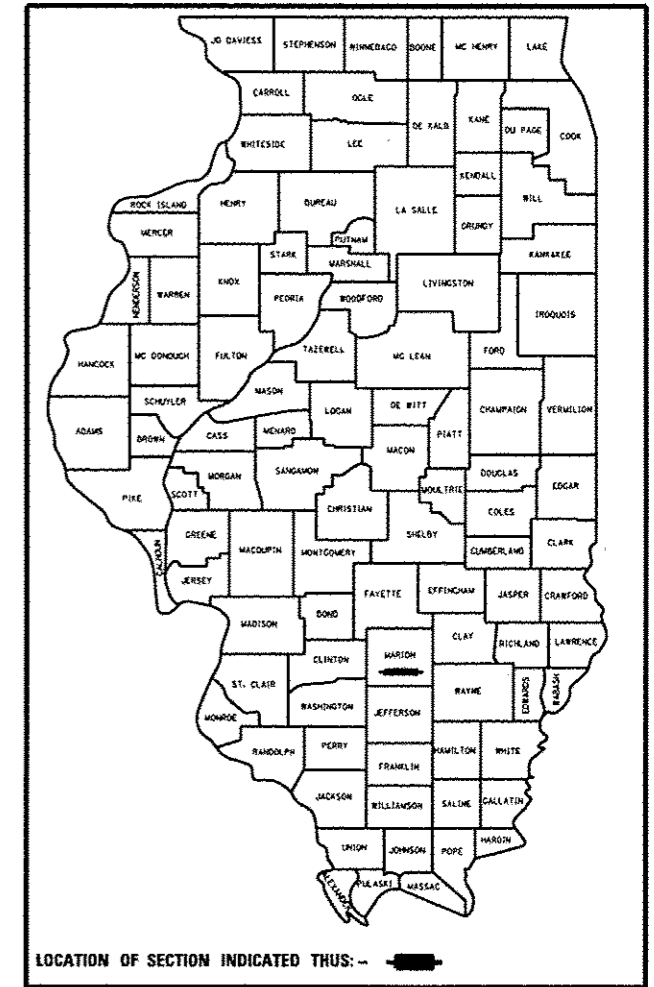

LOCATION OF SECTION INDICATED THUS: —■—

FOR INDEX OF SHEETS, SEE SHEET NO. 2

BRIDGE OMISSION

SN 061-0070 STA 212+52 TO STA 213+99
SN 061-0071 STA 215+85 TO STA 217+62

R 1 E

R 2 E

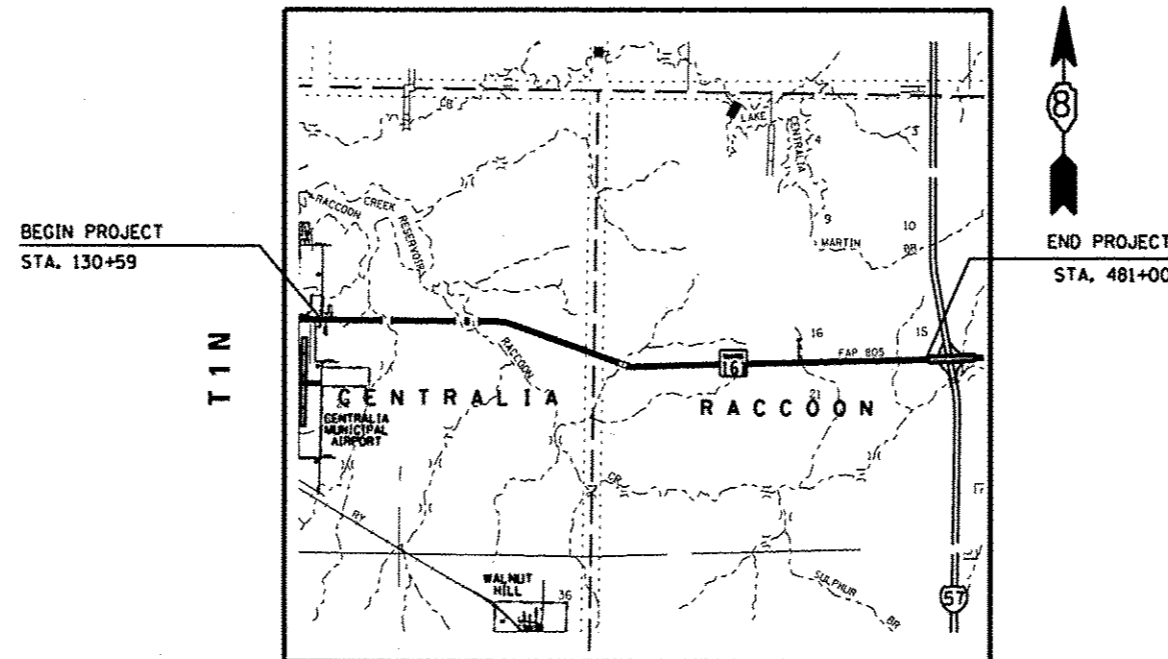

BEGIN PROJECT
STA. 130+59

END PROJECT
STA. 481+00

T 1 N

RACCOON TOWNSHIP
CENTRALIA TOWNSHIP

0 MI 1 MI 2 MI 3 MI 4 MI 5 MI 6 MI

GROSS LENGTH = 35041 FT. = 6.6 MILE
NET LENGTH = 28918 FT. = 5.5 MILE

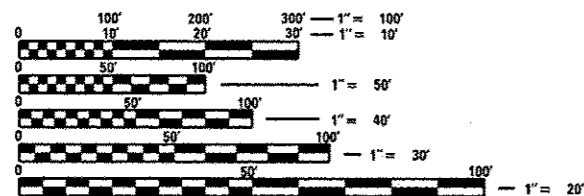

FULL SIZE PLANS HAVE BEEN PREPARED USING STANDARD ENGINEERING SCALES. REDUCED SIZED PLANS WILL NOT CONFORM TO STANDARD SCALES. IN MAKING MEASUREMENTS ON REDUCED PLANS, THE ABOVE SCALES MAY BE USED.

J.U.L.I.E.
JOINT UTILITY LOCATION INFORMATION FOR EXCAVATION
1-800-892-0123
OR 811

PROJECT ENGINEER MICHAEL PRITCHETT (618)346-3180
DESIGN ENGINEER GWEN LAGEMANN (618)346-3181

CONTRACT NO. 76F98

STATE OF ILLINOIS
DEPARTMENT OF TRANSPORTATION
DIVISION OF HIGHWAYS

SUBMITTED August 22, 2012
[Signature]
DEPUTY DIRECTOR OF HIGHWAYS, REGION ENGINEER
October 5, 2012
[Signature]
ENGINEER OF DESIGN AND ENVIRONMENT
October 5, 2012
[Signature]
DIRECTOR OF HIGHWAYS, CHIEF ENGINEER

PRINTED BY THE AUTHORITY
OF THE STATE OF ILLINOIS