

IL 13

WESTBOUND

STAGE 3
CONST.

EASTBOUND

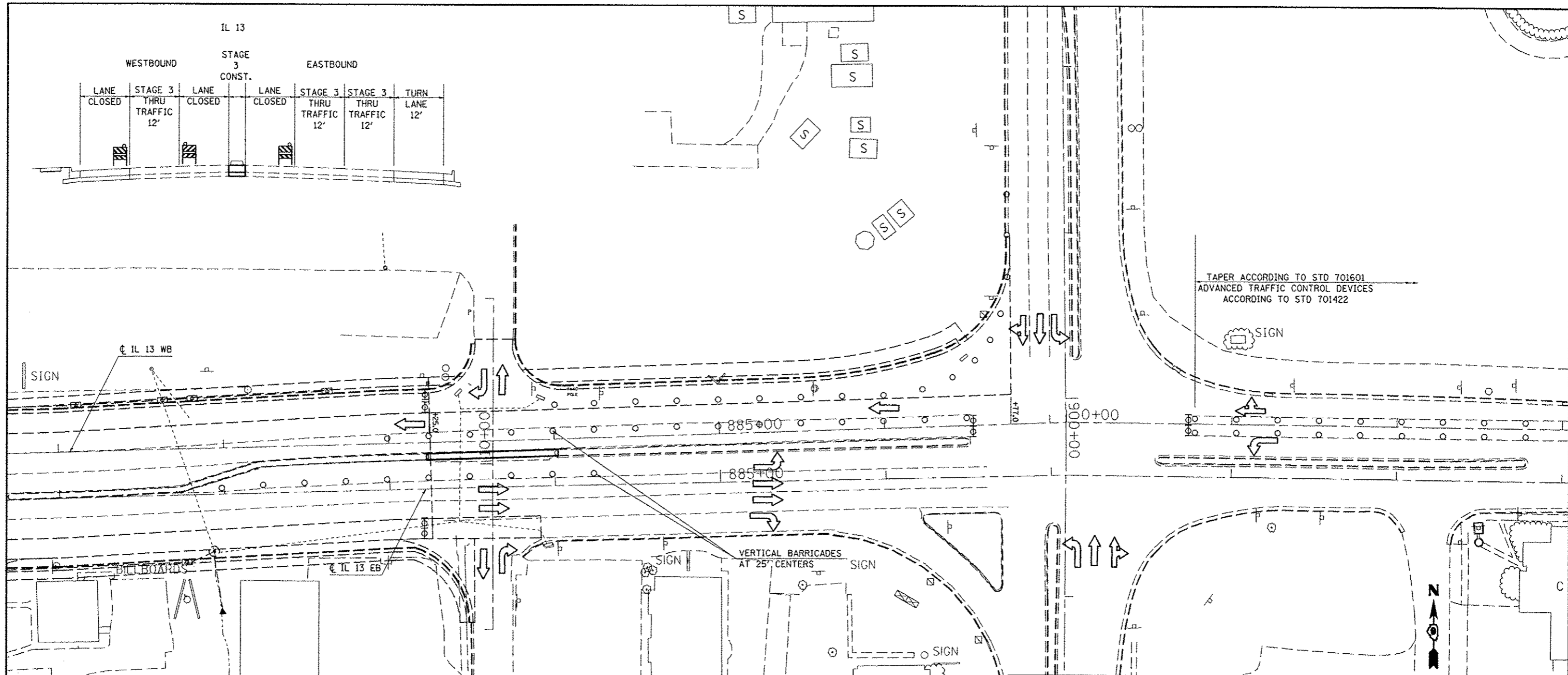
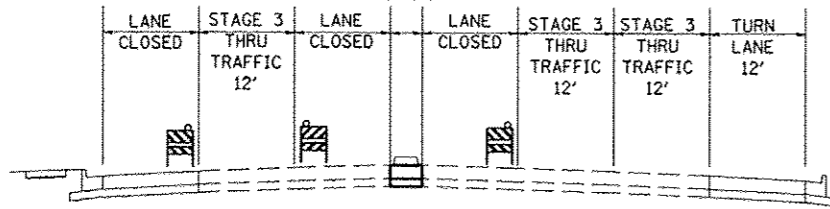

TAPER ACCORDING TO STD 701601
ADVANCED TRAFFIC CONTROL DEVICES
ACCORDING TO STD 701422

VERTICAL BARRICADES
AT 25' CENTERS

STAGE 3 FAP 331 (ILLINOIS 13)

NOTES:

- CLOSE IL 13 LANES ACCORDING TO STD 701601. REFER TO DROP OFF PROTECTION CHART. OPEN TO TWO THROUGH LANES AS QUICKLY AS POSSIBLE.
- SIDE ROAD TRAFFIC CONTROL ACCORDING TO STD 701601
- REMOVE EXISTING PAVEMENT AND MEDIAN. PLACE MEDIAN.
- FOR EACH PARTIAL OR FULL DAY UNDER THIS SET UP A LANE RENTAL WILL BE CHARGED AS FOLLOWS:
1 DAY IL 13 WB THROUGH
- REFER TO DROP OFF PROTECTION CHART FOR RESTRICTIONS ON REOPENING LANES AND REQUIRED CLEARANCES.
- USE TYPE III TAPE TO REVISE LANE DESIGNATIONS AS DIRECTED BY THE ENGINEER.

SYMBOLS

- CONE, DRUM, OR BARRICADE
- TYPE I OR TYPE II BARRICADE WITH FLASHING LIGHT
- TYPE III BARRICADE WITH FLASHING LIGHTS
- FLAGGER WITH TRAFFIC CONTROL SIGN

FILE NAME: c:\p\work\p\dot\k\collegk\d8184451\78203	USER NAME: #USER#	DESIGNED: -	REVISED: -
	ahs-atg.dgn	DRAWN: -	REVISED: -
	PLOT SCALE: 60,0000 1/4"	CHECKED: -	REVISED: -
	PLOT DATE: 5/11/2012	DATE: -	REVISED: -

**STATE OF ILLINOIS
DEPARTMENT OF TRANSPORTATION**

IL 13 STAGE 3

SCALE: 30 SHEET NO. 1 OF 1 SHEETS STA. TO STA.

F.A.P. RTE. 331	SECTION (IX-DR-5,RS-3,N-5,TS-4)	COUNTY WILLIAMSON	TOTAL SHEETS 288	SHEET NO. 71
CONTRACT NO. 78203				
ILLINOIS FED. AID PROJECT				