

IL 13: WEST OF RUSSELL ST.
WESTBOUND EASTBOUND

IL 13: EAST OF RUSSELL ST.
WESTBOUND EASTBOUND

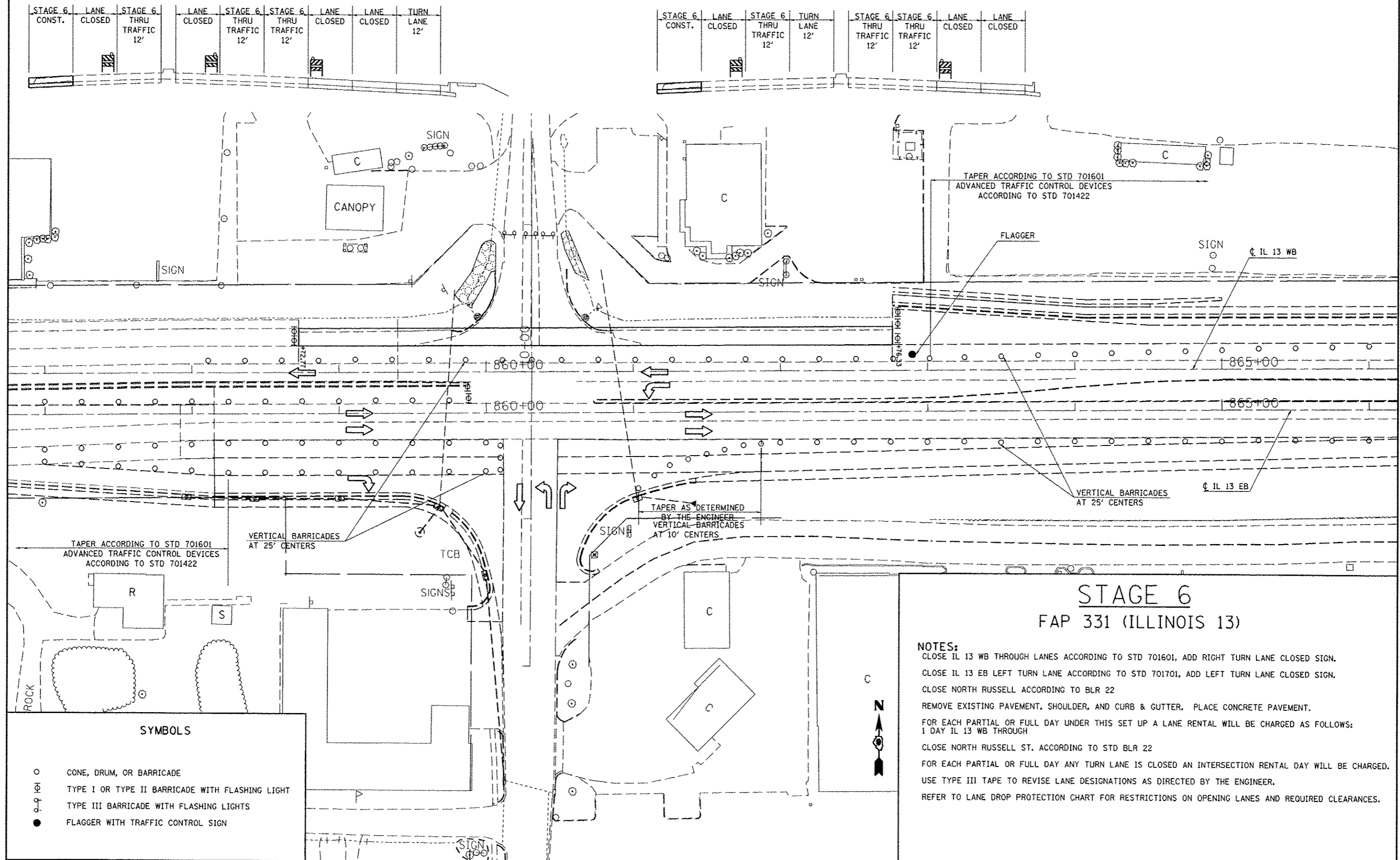

STAGE 6 CONST.	LANE CLOSED	STAGE 6 THRU TRAFFIC 12'	LANE CLOSED	STAGE 6 THRU TRAFFIC 12'	STAGE 6 THRU TRAFFIC 12'	LANE CLOSED	LANE CLOSED	TURN LANE 12'
-------------------	----------------	-----------------------------------	----------------	-----------------------------------	-----------------------------------	----------------	----------------	---------------------

STAGE 6 CONST.	LANE CLOSED	STAGE 6 THRU TRAFFIC 12'	TURN LANE 12'	STAGE 6 THRU TRAFFIC 12'	STAGE 6 THRU TRAFFIC 12'	LANE CLOSED	LANE CLOSED
-------------------	----------------	-----------------------------------	---------------------	-----------------------------------	-----------------------------------	----------------	----------------

TAPER ACCORDING TO STD 701601
ADVANCED TRAFFIC CONTROL DEVICES
ACCORDING TO STD 701422

VERTICAL BARRICADES
AT 25' CENTERS

TAPER AS DETERMINED
BY THE ENGINEER
VERTICAL BARRICADES
AT 10' CENTERS

TAPER ACCORDING TO STD 701601
ADVANCED TRAFFIC CONTROL DEVICES
ACCORDING TO STD 701422

VERTICAL BARRICADES
AT 25' CENTERS

STAGE 6 FAP 331 (ILLINOIS 13)

- NOTES:**
- CLOSE IL 13 WB THROUGH LANES ACCORDING TO STD 701601, ADD RIGHT TURN LANE CLOSED SIGN.
 - CLOSE IL 13 EB LEFT TURN LANE ACCORDING TO STD 701701, ADD LEFT TURN LANE CLOSED SIGN.
 - CLOSE NORTH RUSSELL ACCORDING TO BLR 22
 - REMOVE EXISTING PAVEMENT, SHOULDER, AND CURB & GUTTER. PLACE CONCRETE PAVEMENT.
 - FOR EACH PARTIAL OR FULL DAY UNDER THIS SET UP A LANE RENTAL WILL BE CHARGED AS FOLLOWS:
1 DAY IL 13 WB THROUGH
 - CLOSE NORTH RUSSELL ST. ACCORDING TO STD BLR 22
 - FOR EACH PARTIAL OR FULL DAY ANY TURN LANE IS CLOSED AN INTERSECTION RENTAL DAY WILL BE CHARGED.
 - USE TYPE III TAPE TO REVISE LANE DESIGNATIONS AS DIRECTED BY THE ENGINEER.
 - REFER TO LANE DROP PROTECTION CHART FOR RESTRICTIONS ON OPENING LANES AND REQUIRED CLEARANCES.

SYMBOLS

- CONE, DRUM, OR BARRICADE
- ⊕ TYPE I OR TYPE II BARRICADE WITH FLASHING LIGHT
- ⊙ TYPE III BARRICADE WITH FLASHING LIGHTS
- FLAGGER WITH TRAFFIC CONTROL SIGN

FILE NAME = c:\pwwork\pudot\kellaykd\010445117028	USER NAME = #USER# raht-stg.dgn	DESIGNED - DRAWN -	REVISED - REVISED -	STATE OF ILLINOIS DEPARTMENT OF TRANSPORTATION	IL 13 STAGE 6	F.A.P. RTE. 331	SECTION (IX-1R-5,RS-3,N-5,TS-4)	COUNTY WILLIAMSON	TOTAL SHEETS 288	SHEET NO. 74		
PLOT SCALE = 60.0000' / in.	CHECKED -	REVISED -	SCALE: 30			SHEET NO. 1 OF 1 SHEETS	STA. TO STA.	CONTRACT NO. 78203				
PLOT DATE = 5/11/2012	DATE -	REVISED -	ILLINOIS FED. AID PROJECT									