

# STAGE 4 / STAGE 5

F.A.P. RTE.	SECTION	COUNTY	TOTAL SHEETS	SHEET NO.
729	*	VERMILION	298	60
STA. 93+951.420		TO STA. 94+630		
FED. ROAD DIST. NO.		ILLINOIS FED. AID PROJECT		
• 36(W,RS-1) & 34Z-2(W,RS) CONTRACT #90939				

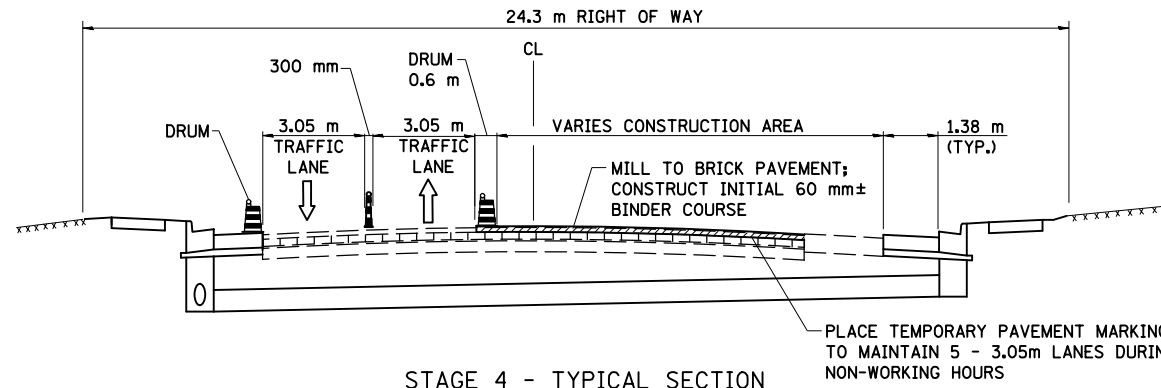

**STAGE 4 - TYPICAL SECTION**  
STA. 93+951.420 TO STA. 94+630.000

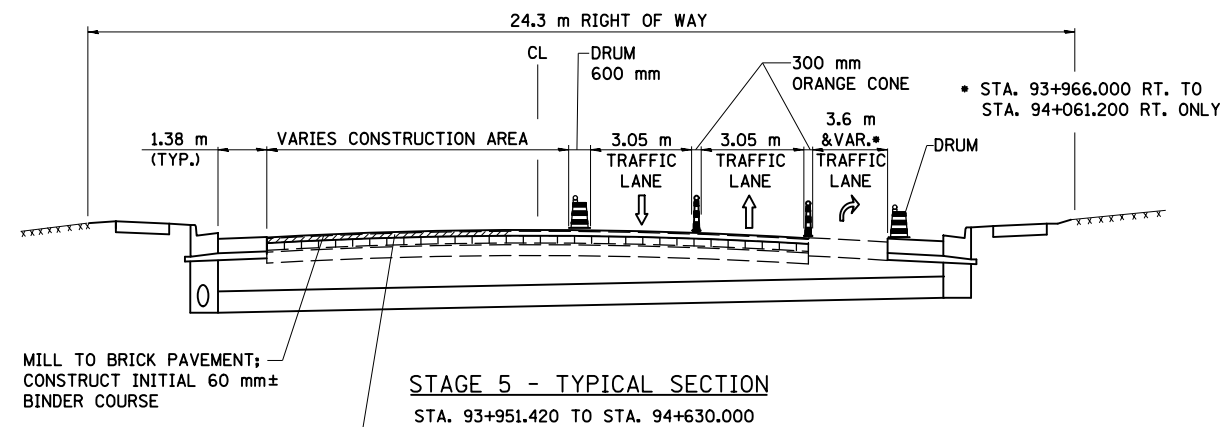

**STAGE 5 - TYPICAL SECTION**  
STA. 93+951.420 TO STA. 94+630.000

U.S. RTE. 136

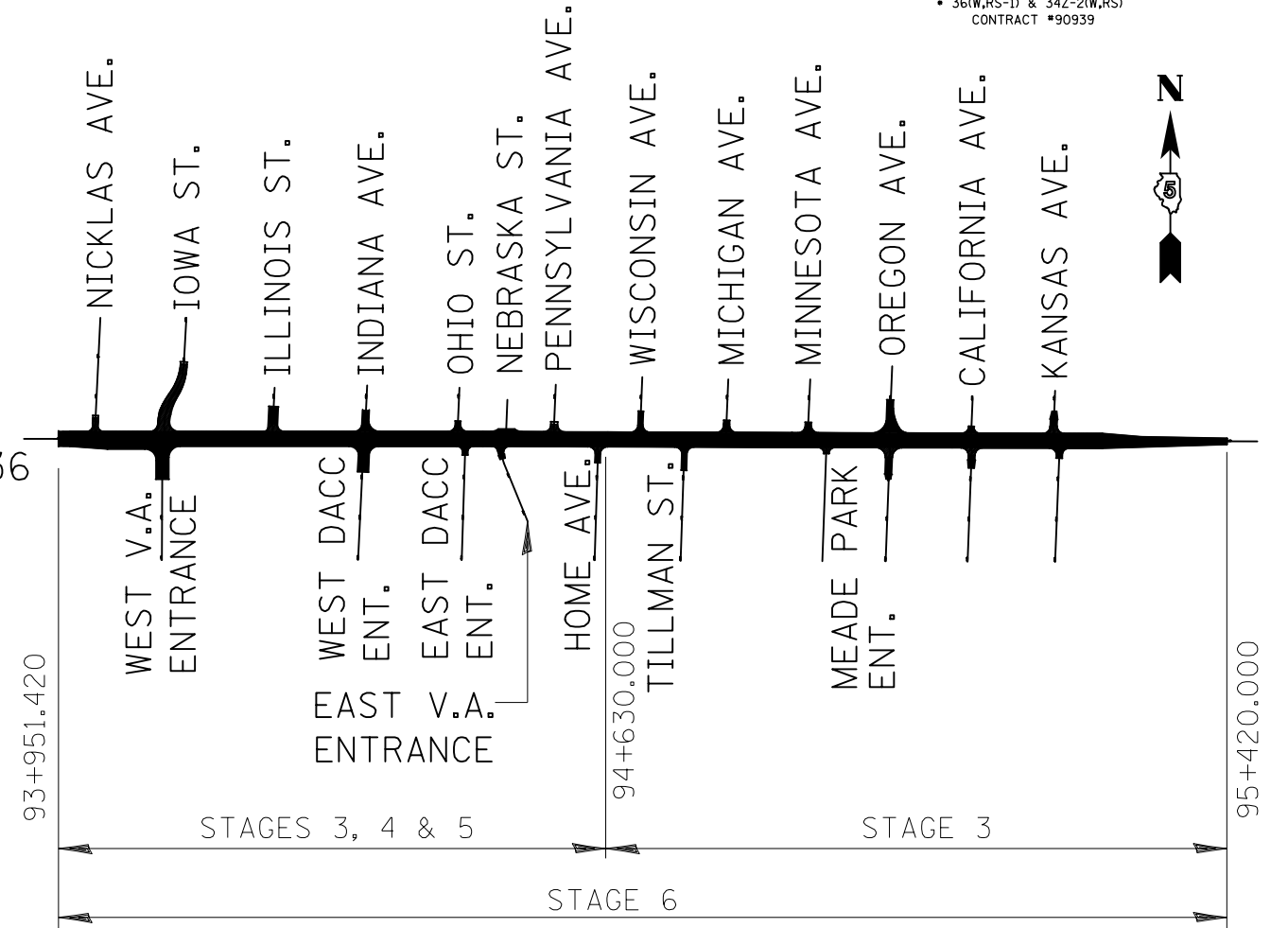

## PLAN

MILL TO BRICK PAVEMENT;  
CONSTRUCT INITIAL 60 mm±  
BINDER COURSE

PLACE TEMPORARY PAVEMENT MARKINGS  
TO MAINTAIN 5 - 3.05m LANES DURING  
NON-WORKING HOURS

**NOTE:**

1. ORANGE CONES, 1.07 m TALL, SHALL BE USED TO SEPARATE TRAFFIC IN THE LOCATIONS SHOWN INSTEAD OF BARRICADES OR LIGHTED DRUMS. THE DEVICES SHALL BE EQUIPPED WITH TWO 100-150 mm WHITE AND TWO 100-150 mm ORANGE HI-INTENSITY REFLECTIVE STRIPES. THE STRIPES SHALL BE SPACED AS SHOWN FOR DRUMS ON HIGHWAY STANDARD 702001.
2. EACH OF THESE DEVICES SHALL BE EQUIPPED WITH A RUBBER BALLAST WEIGHING NO LESS THAN 13.6 KG.
3. SPACING FOR THE 1.07 m TALL CONES SHALL BE AT 8 m CENTERS.

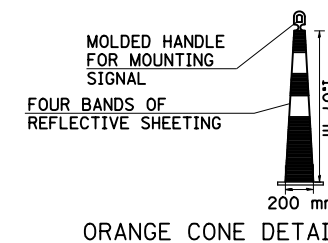

ORANGE CONE DETAIL

LEGEND		REVISIONS		ILLINOIS DEPARTMENT OF TRANSPORTATION MAINTENANCE OF TRAFFIC PLANS U.S. ROUTE 136
↑	DIRECTION OF TRAFFIC FLOW	NAME	DATE	
////	PROPOSED CONSTRUCTION			SCALE 1:500 DATE 8/03
				DRAWN BY FML CHECKED BY IYL

c:\pw\_work\pwidot\ceer-lock\j\d0313241\sec4.dgn  
8/17/2012