

F.A.P. RTE.	SECTION	COUNTY	TOTAL SHEETS	SHEET NO.
729	*	VERMILION	298	62
STA. 94+700		TO STA. 95+050		
FED. ROAD DIST. NO.		ILLINOIS FED. AID PROJECT		
* 36(W,RS-1) & 34Z-2(W,RS)				
CONTRACT #90939				

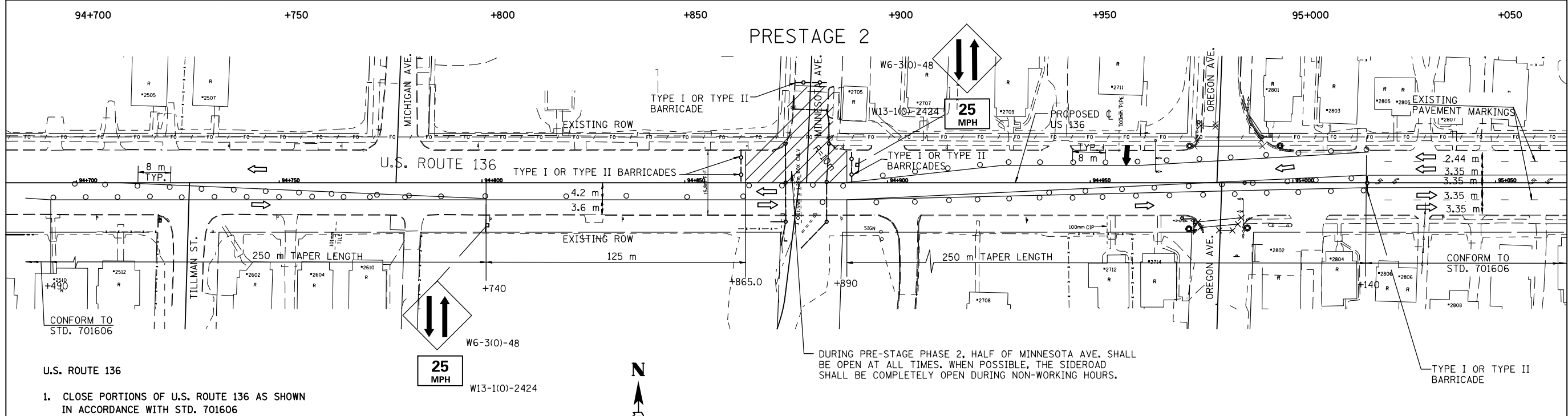

- U.S. ROUTE 136
1. CLOSE PORTIONS OF U.S. ROUTE 136 AS SHOWN IN ACCORDANCE WITH STD. 701606
 2. ALL SIDEROAD CLOSURES SHALL CONFORM TO DISTRICT 5 SPECIFICATIONS. ALL SIDEROADS ADJOINING TO PARTIALLY CLOSED U.S. ROUTE 136 SHALL CONFORM TO STD. 701606.
 3. CONSTRUCTION ADVISORY SPEED PLATE SHOULD BE 25 MPH.

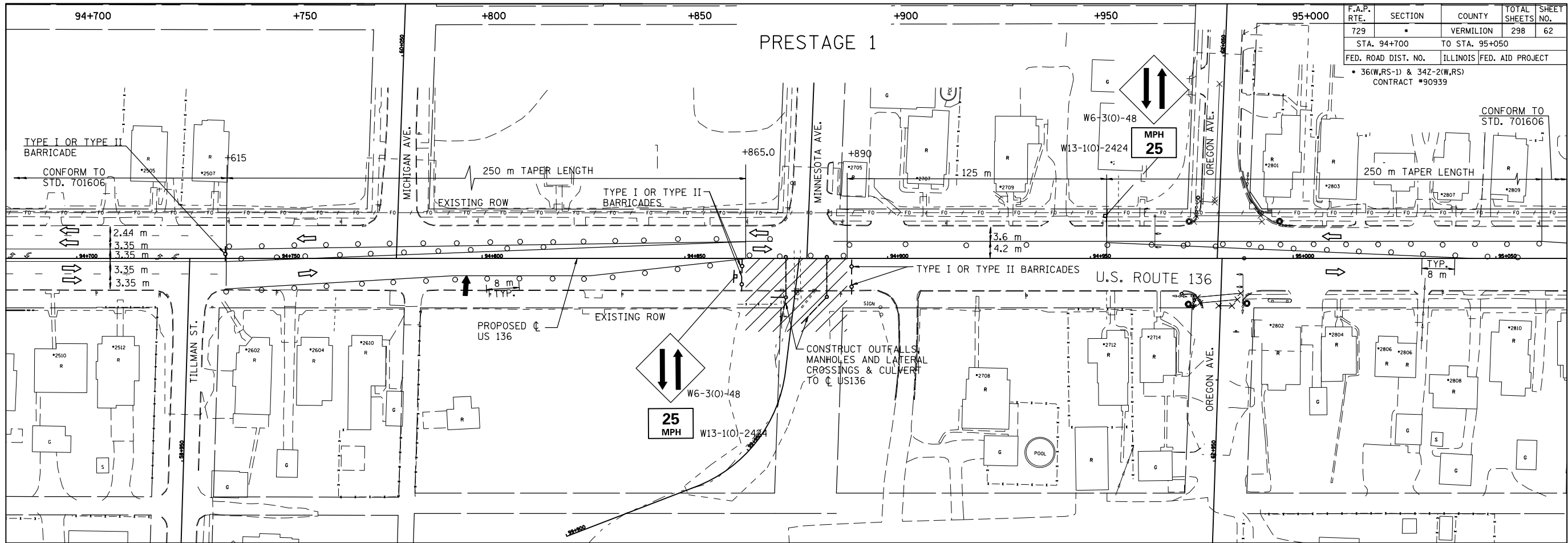
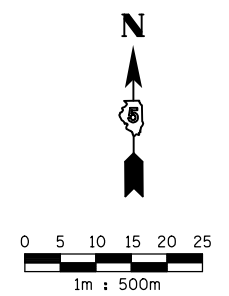

LEGEND	
	WORK AREA
	CONE OR BARRICADE WITH LIGHT
	ARROW BOARD
	DIRECTION OF TRAFFIC
	TYPE III BARRICADE WITH FLASHING LIGHT
	BARRICADE WITH STEADY LIGHT
	SIGN ON PORTABLE SUPPORT
	FLAGMAN WITH TRAFFIC CONTROL SIGN

REVISIONS	
NAME	DATE

ILLINOIS DEPARTMENT OF TRANSPORTATION
MAINTENANCE OF TRAFFIC PLANS
U.S. ROUTE 136

SCALE 1:500
DATE 8/03

DRAWN BY FML
CHECKED BY IYL

ct:\pw_work\pwork\ceer\lock\j\d0313241\prestage.dgn
8/17/2012