

94+450 94+500 94+550 94+600 94+650 94+700

STAGE 1 (CONTINUED)

F.A.P. RTE.	SECTION	COUNTY	TOTAL SHEETS	SHEET NO.
729	*	VERMILION	298	64
STA. 94+450		TO STA. 95+150		
FED. ROAD DIST. NO.	ILLINOIS	FED. AID PROJECT		
* 36(W,RS-1) & 34Z-2(W,RS)		CONTRACT #90939		

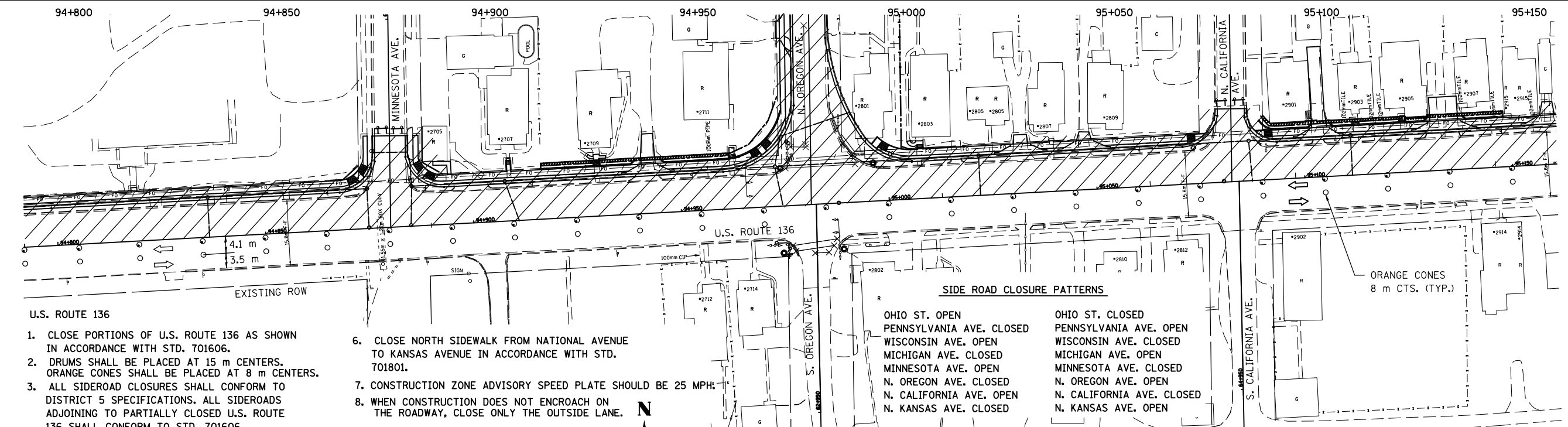
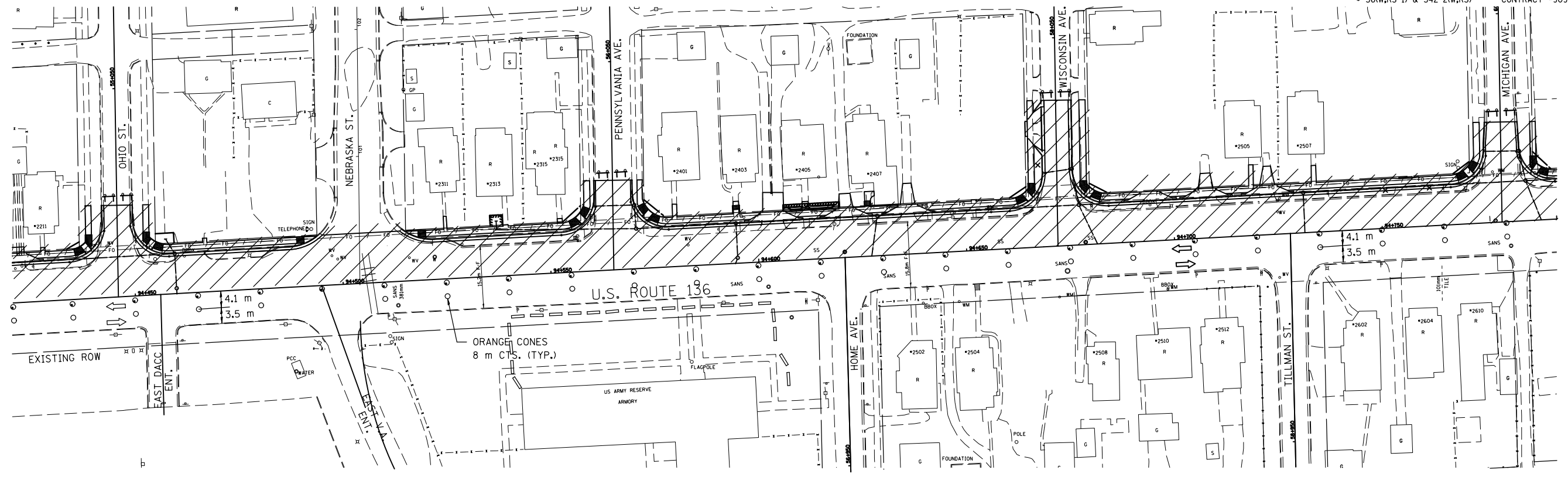

U.S. ROUTE 136

- CLOSE PORTIONS OF U.S. ROUTE 136 AS SHOWN IN ACCORDANCE WITH STD. 701606.
- DRUMS SHALL BE PLACED AT 15 m CENTERS. ORANGE CONES SHALL BE PLACED AT 8 m CENTERS.
- ALL SIDEROAD CLOSURES SHALL CONFORM TO DISTRICT 5 SPECIFICATIONS. ALL SIDEROADS ADJOINING TO PARTIALLY CLOSED U.S. ROUTE 136 SHALL CONFORM TO STD. 701606.
- NORTH SIDESTREETS SHALL BE OPEN AND CLOSED IN ALTERNATING FASHION FOR CONSTRUCTION. SEE SIDEROAD CLOSURE PATTERNS.
- NO LEFT TURNS WILL BE PERMITTED ONTO SIDESTREETS LEFT OPEN DURING CONSTRUCTION. SIGNS ERECTED TO INDICATE THIS SHALL BE INCLUDED IN THE COST OF THE APPLICABLE TRAFFIC CONTROL PAY ITEM.
- CLOSE NORTH SIDEWALK FROM NATIONAL AVENUE TO KANSAS AVENUE IN ACCORDANCE WITH STD. 701801.
- CONSTRUCTION ZONE ADVISORY SPEED PLATE SHOULD BE 25 MPH.
- WHEN CONSTRUCTION DOES NOT ENCR OACH ON THE ROADWAY, CLOSE ONLY THE OUTSIDE LANE.

SIDEROAD CLOSURE PATTERNS

- |                          |                           |
|--------------------------|---------------------------|
| OHIO ST. OPEN            | OHIO ST. CLOSED           |
| PENNSYLVANIA AVE. CLOSED | PENNSYLVANIA AVE. OPEN    |
| WISCONSIN AVE. OPEN      | WISCONSIN AVE. CLOSED     |
| MICHIGAN AVE. CLOSED     | MICHIGAN AVE. OPEN        |
| MINNESOTA AVE. OPEN      | MINNESOTA AVE. CLOSED     |
| N. OREGON AVE. CLOSED    | N. OREGON AVE. OPEN       |
| N. CALIFORNIA AVE. OPEN  | N. CALIFORNIA AVE. CLOSED |
| N. KANSAS AVE. CLOSED    | N. KANSAS AVE. OPEN       |

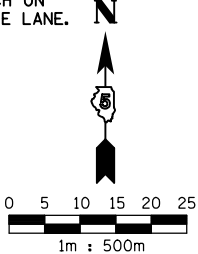

LEGEND

- |  |                              |  |  |
|--|------------------------------|--|--|
|  | WORK AREA                    |  | TYPE III BARRICADE WITH FLASHING LIGHT |
|  | CONE OR BARRICADE WITH LIGHT |  | BARRICADE WITH STEADY LIGHT            |
|  | ARROW BOARD                  |  | SIGN ON PORTABLE SUPPORT               |
|  | DIRECTION OF TRAFFIC         |  | CONE                                   |

REVISIONS

NAME	DATE

ILLINOIS DEPARTMENT OF TRANSPORTATION  
**MAINTENANCE OF TRAFFIC PLANS**  
**U.S. ROUTE 136**  
 SCALE 1:500 DRAWN BY FML  
 DATE 8/03 CHECKED BY IYL

ct:\pw\work\p\widot\ceer\lock\j\d0313241\stage1-2.dgn  
 8/17/2012