

94+450 94+500 94+550 94+600 94+650 94+700

STAGE 5 (CONTINUED)

F.A.P. RTE.	SECTION	COUNTY	TOTAL SHEETS	SHEET NO.
729	*	VERMILION	298	72
STA. 94+450		TO STA. 95+150		
FED. ROAD DIST. NO.	ILLINOIS	FED. AID PROJECT		
• 36(W,RS-1) & 34Z-2(W,RS)		CONTRACT #90939		

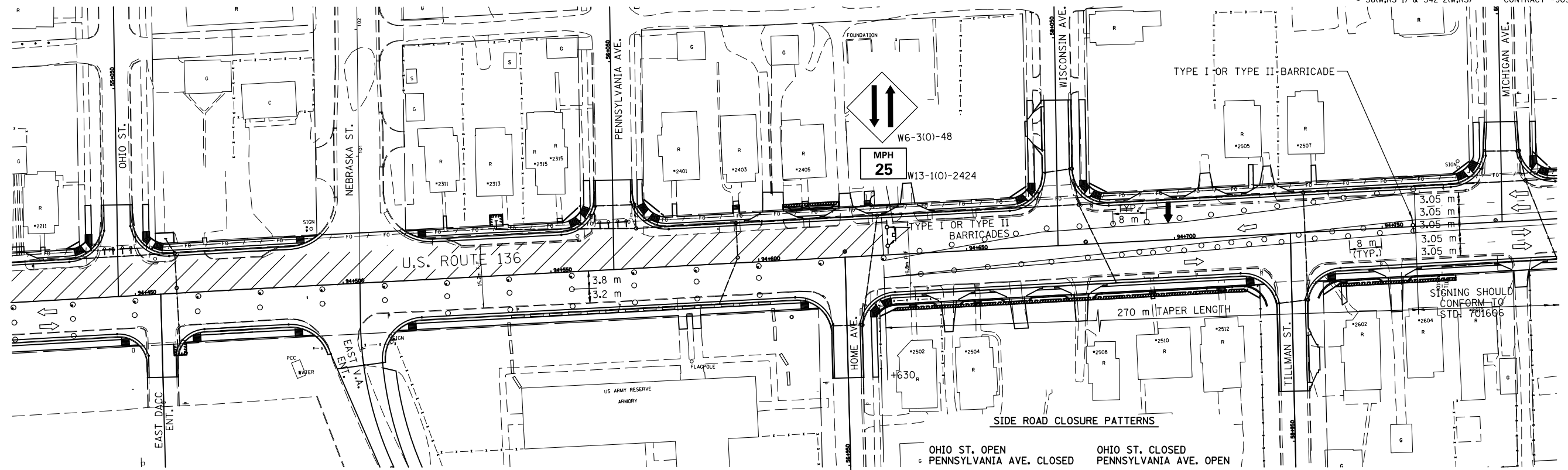

94+800 94+850 94+900 94+950 95+000 95+050 95+100 95+150

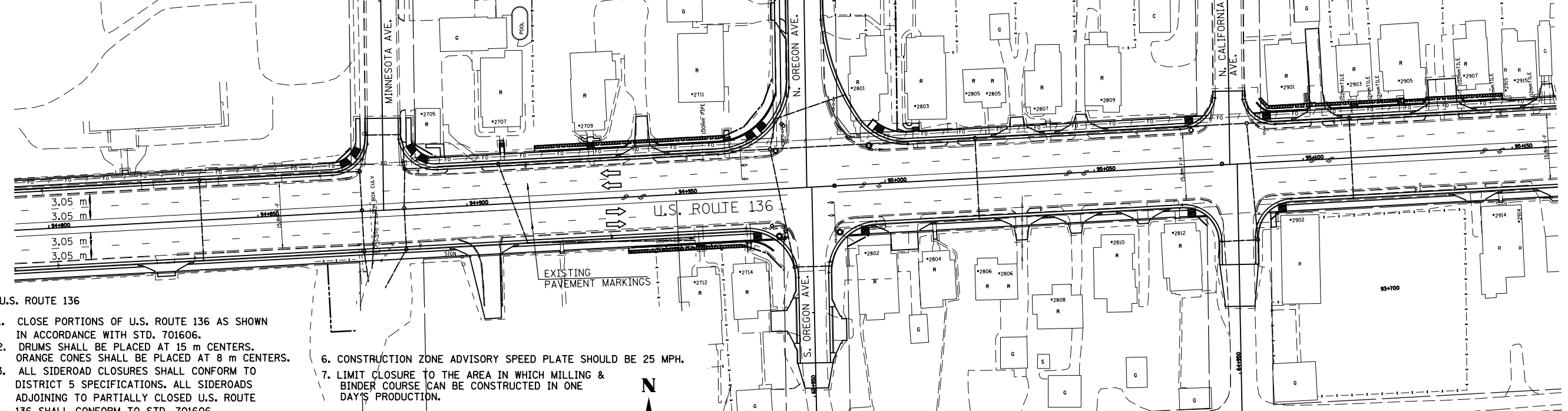

- U.S. ROUTE 136
- CLOSE PORTIONS OF U.S. ROUTE 136 AS SHOWN IN ACCORDANCE WITH STD. 701606.
 - DRUMS SHALL BE PLACED AT 15 m CENTERS. ORANGE CONES SHALL BE PLACED AT 8 m CENTERS.
 - ALL SIDEROAD CLOSURES SHALL CONFORM TO DISTRICT 5 SPECIFICATIONS. ALL SIDEROADS ADJOINING TO PARTIALLY CLOSED U.S. ROUTE 136 SHALL CONFORM TO STD. 701606.
 - NORTH SIDESTREETS SHALL BE OPEN AND CLOSED IN ALTERNATING FASHION FOR CONSTRUCTION. SEE SIDEROAD CLOSURE PATTERNS.
 - NO LEFT TURNS WILL BE PERMITTED ONTO SIDESTREETS LEFT OPEN DURING CONSTRUCTION. SIGNS ERECTED TO INDICATE THIS SHALL BE INCLUDED IN THE COST OF THE APPLICABLE TRAFFIC CONTROL PAY ITEM.
 - CONSTRUCTION ZONE ADVISORY SPEED PLATE SHOULD BE 25 MPH.
 - LIMIT CLOSURE TO THE AREA IN WHICH MILLING & BINDER COURSE CAN BE CONSTRUCTED IN ONE DAY'S PRODUCTION.

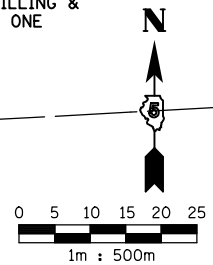

LEGEND

	WORK AREA		TYPE III BARRICADE WITH FLASHING LIGHT
	CONE OR BARRICADE WITH LIGHT		BARRICADE WITH STEADY LIGHT
	ARROW BOARD		SIGN ON PORTABLE SUPPORT
	DIRECTION OF TRAFFIC		CONE

REVISIONS	
NAME	DATE

ILLINOIS DEPARTMENT OF TRANSPORTATION
MAINTENANCE OF TRAFFIC PLANS
U.S. ROUTE 136

SCALE 1:500
 DATE 8/03
 DRAWN BY FML
 CHECKED BY IYL

ct:\pw_work\pwidot\ceer\lock\j\d0313241\stage5-2.dgn
 8/17/2012