

TRAFFIC SIGNAL MODERNIZATION FAP 729 (MAIN ST.)

& OREGON AVENUE

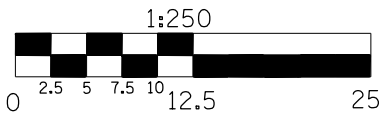

SIGNAL LAYOUT

F.A.P. RTE.	SECTION	COUNTY	TOTAL SHEETS	SHEET NO.
729		VERMILION	298	124

* 36(W,RS-1) & 34Z(W,RS)
CONTRACT #90939

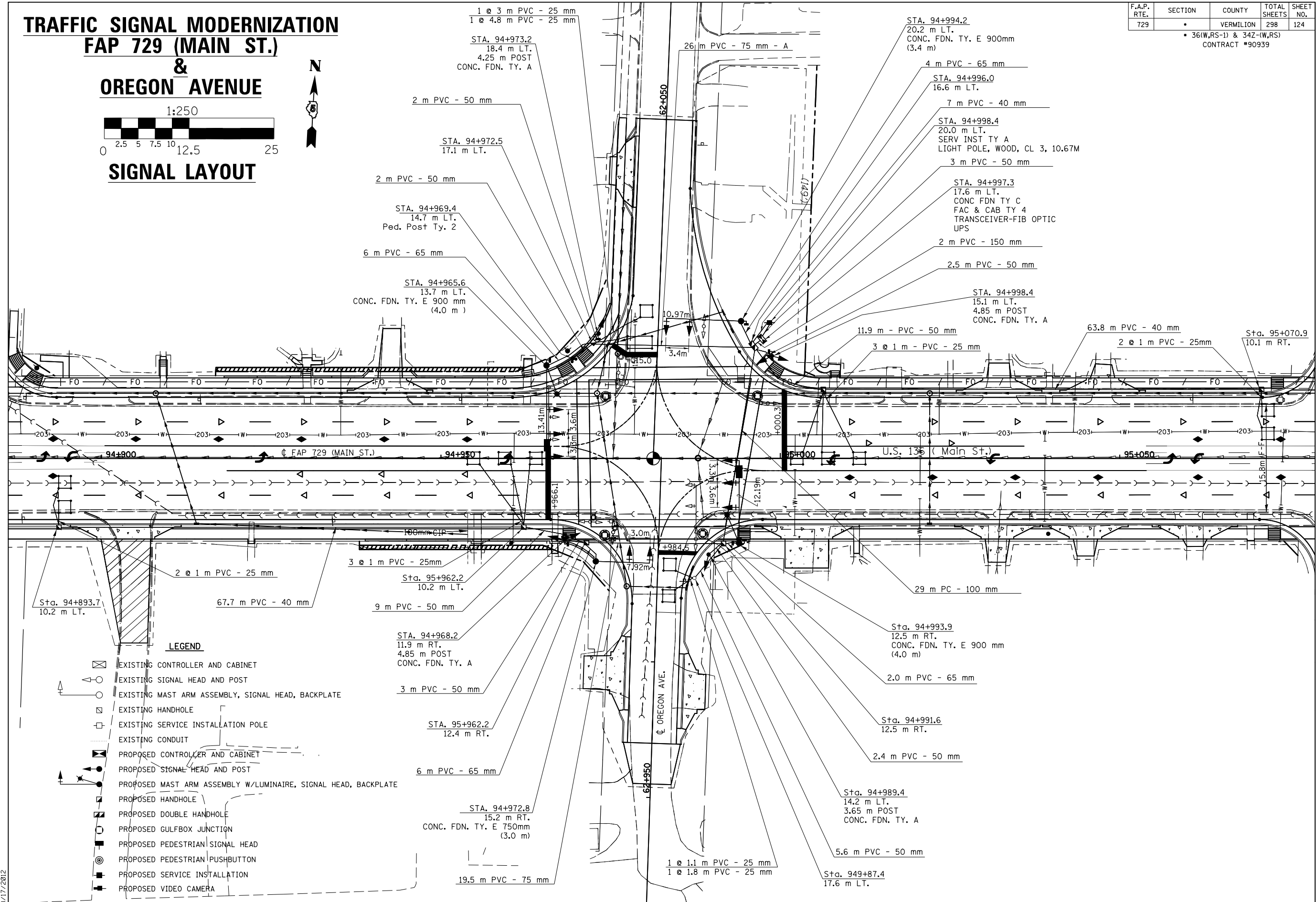

LEGEND

- EXISTING CONTROLLER AND CABINET
- EXISTING SIGNAL HEAD AND POST
- EXISTING MAST ARM ASSEMBLY, SIGNAL HEAD, BACKPLATE
- EXISTING HANDHOLE
- EXISTING SERVICE INSTALLATION POLE
- EXISTING CONDUIT
- PROPOSED CONTROLLER AND CABINET
- PROPOSED SIGNAL HEAD AND POST
- PROPOSED MAST ARM ASSEMBLY W/LUMINAIRE, SIGNAL HEAD, BACKPLATE
- PROPOSED HANDHOLE
- PROPOSED DOUBLE HANDHOLE
- PROPOSED GULFBOX JUNCTION
- PROPOSED PEDESTRIAN SIGNAL HEAD
- PROPOSED PEDESTRIAN PUSHBUTTON
- PROPOSED SERVICE INSTALLATION
- PROPOSED VIDEO CAMERA

8/17/2012

c:\pw_work\pwidot\clearlock\jd\0269091\sig sheets.dgn

c:\pw_work\pwidot\clearlock\jd\0269091\sig sheets.dgn