

FINAL	DATE
SURVEYED	BY
PLOTTED	
NOTE BOOK	
NO.	

ORIGINAL	DATE
SURVEYED	BY
PLOTTED	
NOTE BOOK	
NO.	

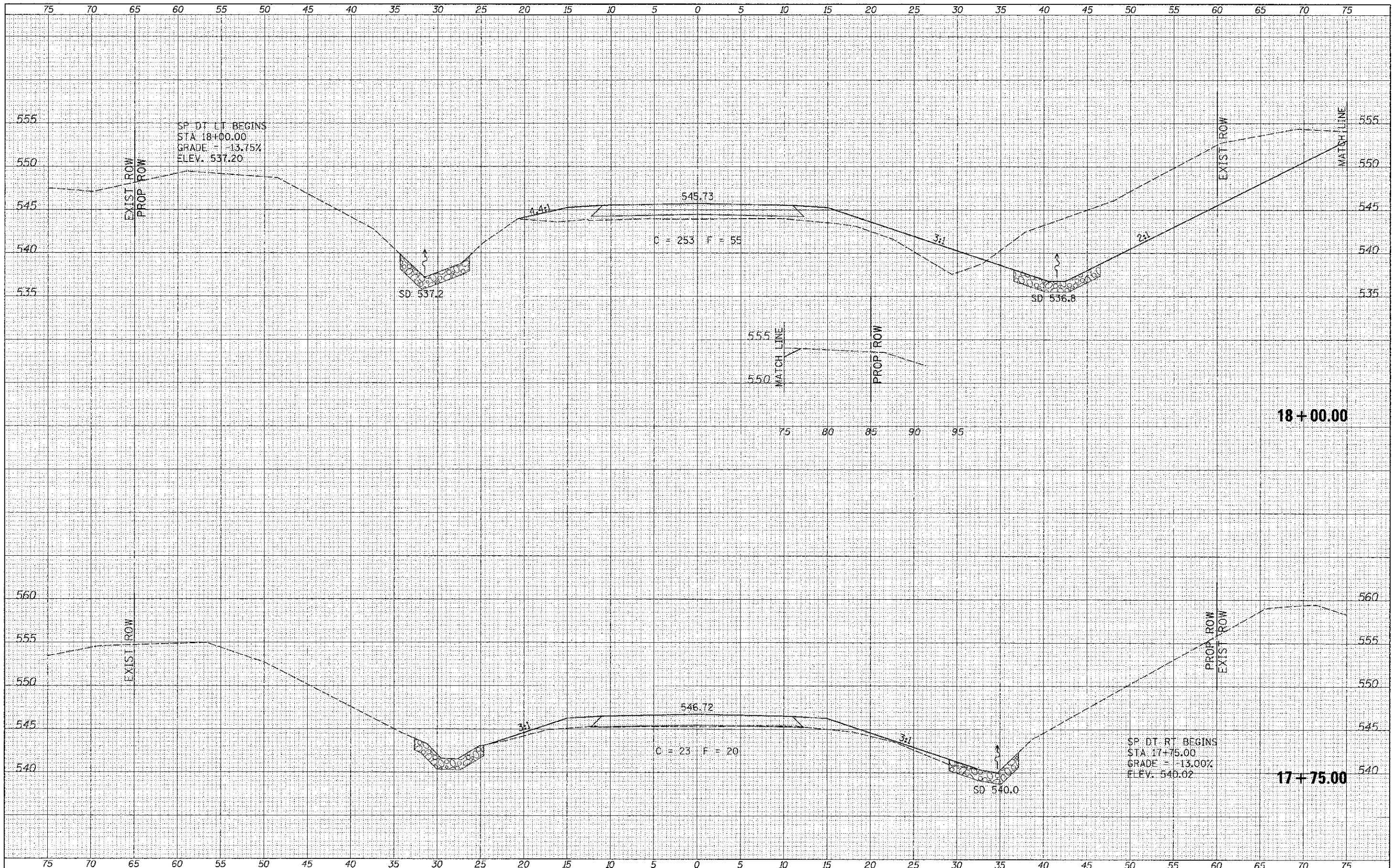

FILE NAME =  
\\bridge\2998 - Schuyler\2998\sbts.dgn

USER NAME = cthomes

DESIGNED -  
DRAWN -  
CHECKED -  
DATE -

REVISED -  
REVISED -  
REVISED -  
REVISED -

**SCHUYLER COUNTY  
COUNTY HIGHWAY 2  
OVER SUGAR CREEK**

**CROSS SECTIONS**

SCALE: 1"=5' SHEET 4 OF 12 SHEETS STA. 17+75.00 TO STA. 18+00.00

F.A.S. RTE.	SECTION	COUNTY	TOTAL SHEETS	SHEET NO.
455	07-00073-00-BR	SCHUYLER	35	27
CONTRACT NO. 93584			FED. ROAD DIST. NO. 7 [ILLINOIS] FED. AID PROJECT BRS-0455107	