

F.A. RTE.	SECTION	COUNTY	TOTAL SHEETS	SHEET NO.
HWY 37 & COLLINS	10-00004-00-BK	JOHNSON	16	4

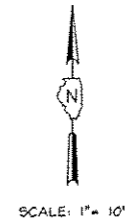
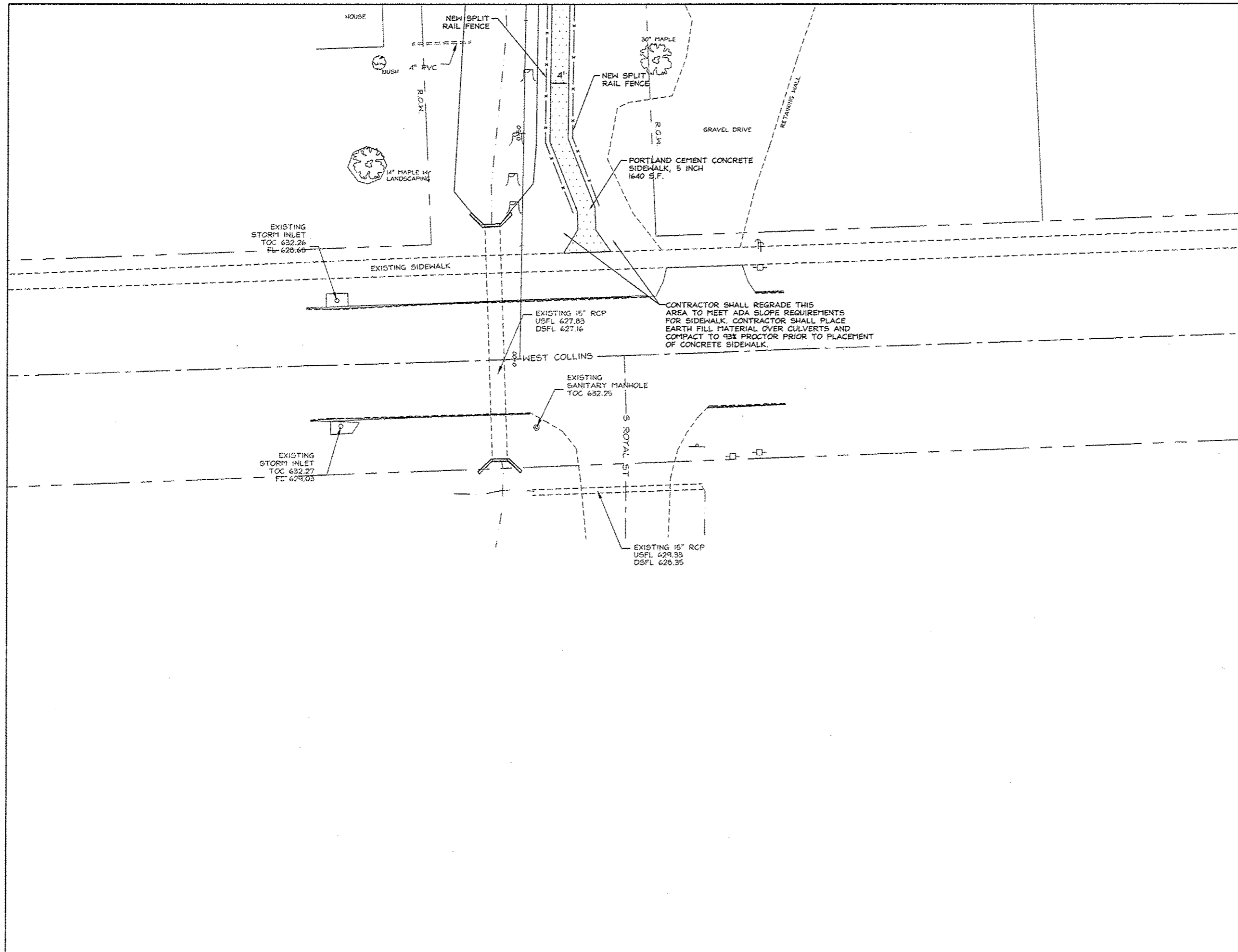

- LEGEND**
- IRON PIN FOUND
 - ▲ STONE FOUND
 - 1/2" IRON PIN SET
 - CONCRETE MONUMENT SET
 - ∕ ROAD SIGN
 - ⊖ POWER POLE
 - ⊕ GUY WIRE
 - ⊕ WATER METER
 - ⊕ WATER HYDRANT
 - ⊕ LIGHT POLE

CONTRACTOR SHALL REGRADE THIS AREA TO MEET ADA SLOPE REQUIREMENTS FOR SIDEWALK. CONTRACTOR SHALL PLACE EARTH FILL MATERIAL OVER CULVERTS AND COMPACT TO 93% PROCTOR PRIOR TO PLACEMENT OF CONCRETE SIDEWALK.

NO.	DESCRIPTION	BY	DATE	NO.	DESCRIPTION	BY	DATE
					DESIGNED		
					DRAWN	WFL	3/27/12
					CHECKED	JHC	3/27/12

VILLAGE OF GOREVILLE
 JOHNSON COUNTY, IL
 SCHOOL SAFE WAY PLAN
 PLAN SHEET



JOHN H. CRAWFORD & ASSOCIATES, P.C.
 CIVIL ENGINEERS, LAND SURVEYORS
 201 SOUTH DIVISION STREET, CARTERSVILLE, ILLINOIS 62916
 PHONE (618) 685-0370 FAX (618) 965-4692
 PROFESSIONAL DESIGN FIRM # 184-002895

SHEET NO.	
4	
ISSUE	DATE
A	3/27/12

X:\goreville\Lead_Plan\10-00004\JOHNSON\10-00004-00-BK\10-00004-00-BK-04.dwg 10/27/2012 3:46:18 PM