

F.A. RTE.	SECTION	COUNTY	TOTAL SHEETS	SHEET NO.
HWY 37 & COLLINS	10-00004-00-BH	JOHNSON	15	6

LEGEND

- ⊙ IRON PIN FOUND
- △ STONE FOUND
- 1/2" IRON PIN SET
- CONCRETE MONUMENT SET
- ROAD SIGN
- ⊥ POWER POLE
- GUY WIRE
- ⊕ WATER METER
- ⊕ WATER HYDRANT
- ☆ LIGHT POLE

SCALE: 1" = 10'

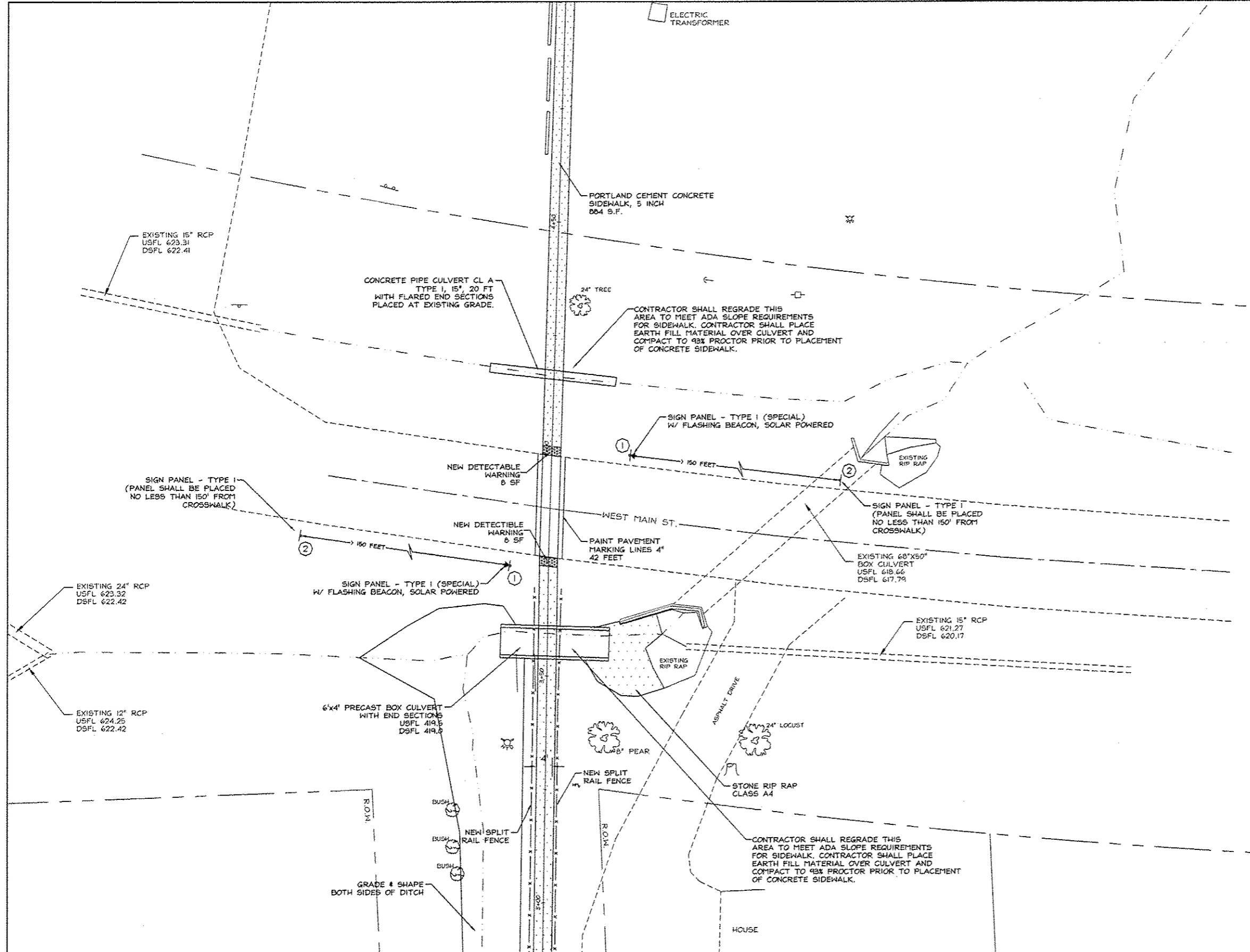

NO.	DESCRIPTION	BY	DATE	NO.	DESCRIPTION	BY	DATE
					DESIGNED		
					DRAWN	WFL	3/27/12
					CHECKED	JHC	3/27/12
				A1	REVISED PER IDOT REQUEST	WDS	7/30/12

VILLAGE OF GOREVILLE
JOHNSON COUNTY, IL
SCHOOL SAFE WAY PLAN
PLAN SHEET

JOHN H. CRAWFORD & ASSOCIATES, P.C.
CIVIL ENGINEERS, LAND SURVEYORS
201 SOUTH DIVISION STREET, CARTERSVILLE, ILLINOIS 62918
PHONE (618) 985-8370 FAX (618) 985-4692
PROFESSIONAL DESIGN FIRM # 184-052885

SHEET NO.	
6	
ISSUE	DATE
A1	7/30/12

K:\GIS\land Projects\GOREVILLE SCHOOLS 2012.dwg, 10/27/2012 3:25:31 PM