

| F.A. RTE. | SECTION | COUNTY | TOTAL SHEETS | SHEET NO. |
|------------------|----------------|---------|--------------|-----------|
| HWY 37 & COLLINS | 10-00004-00-SW | JOHNSON | 15 | 1 |

STATE OF ILLINOIS
DEPARTMENT OF TRANSPORTATION
DIVISION OF HIGHWAYS

CENTRAL BUREAU OF
LOCAL ROADS & STREETS

PLANS FOR
SAFE ROUTES TO SCHOOLS SIDEWALK IMPROVEMENTS

VILLAGE OF GOREVILLE - VARIOUS LOCATIONS

SECTION NO. 10-00004-00-SW

PROJECT NO. SRTS-4009(032)

JOB NO. C-40-110-09

CONTRACT NO. 99447

JOHNSON COUNTY

LENGTH OF PROJECT 820.54 FEET (0.1554 MILES)

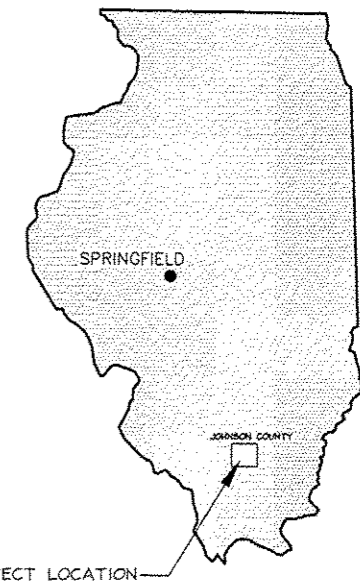

SHEET LAYOUT

- 1 COVER SHEET
- 2 NOTES & QUANTITIES
- 3-10 PLAN SHEETS
- 11-12 SIDEWALK PROFILE
- 13-14 SIDEWALK DETAIL
- 15 SIDEWALK SECTIONS

STANDARDS

- 280001-05-TEMPORARY EROSION CONTROL SYSTEMS
- 424001-05-CURB RAMP FOR SIDEWALKS
- 424001-06-PERPENDICULAR CURB RAMP FOR SIDEWALKS
- 701301-01-LANE CLOSURE, 2L, 2W, SHORT TIME OPERATIONS
- 720006-02-SIGN PANEL ERECTION DETAILS
- 729001-01-APPLICATION OF TYPES A & B METAL POST
- 780001-02-TYPICAL PAVEMENT MARKINGS

ENGINEER AND SURVEYOR'S CERTIFICATE

STATE OF ILLINOIS)
COUNTY OF WILLIAMSON)

I, JOHN H. CRAWFORD, ILLINOIS PROFESSIONAL ENGINEER NO. 29206 AND ILLINOIS PROFESSIONAL LAND SURVEYOR NO. 2061 DO HEREBY CERTIFY THAT THESE DRAWINGS WERE PREPARED BY ME, OR PREPARED UNDER MY DIRECT SUPERVISION.

IN WITNESS THEREOF, I HAVE SET MY HAND AND SEAL THIS 29TH DAY OF MAY 2012.

JOHN H. CRAWFORD
I.P.E. NO. 29206
I.P.L.S. NO. 2061
CARTERVILLE, ILLINOIS

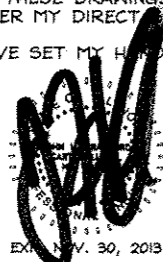

PROJECT LOCATION

PROJECT AREA MAP



Approved 6/26 2012
[Signature]
PRESIDENT, VILLAGE OF GOREVILLE

Passed JULY 9 2012
[Signature]
District 9 Engineer of Local Roads and Streets

Releasing for Bid Based on Limited Review
7/9 2012
[Signature]
Deputy Director of Highways, Region 5 Engineer

| NO. | DESCRIPTION | BY | DATE | NO. | DESCRIPTION | BY | DATE |
|-----|-------------|----|------|-----|-------------|-----|---------|
| | | | | | DESIGNED | | |
| | | | | | DRAWN | WDS | 3/27/12 |
| | | | | | CHECKED | JHC | 3/27/12 |

VILLAGE OF GOREVILLE
JOHNSON COUNTY, IL
SAFE ROUTES TO SCHOOL
COVER PAGE



JOHN H. CRAWFORD & ASSOCIATES, P.C.
CIVIL ENGINEERS, LAND SURVEYORS
201 SOUTH DIVISION STREET, CARTERVILLE, ILLINOIS 62916
PHONE (618) 985-6370 FAX (618) 985-4692
PROFESSIONAL DESIGN FIRM # 164-002865

| | |
|-----------|---------|
| SHEET NO. | |
| 1 | |
| ISSUE | DATE |
| A | 5/29/12 |

| F.A. RTE. | SECTION | COUNTY | TOTAL SHEET SHEETS | NO. |
|------------------|----------------|---------|--------------------|-----|
| Hwy 37 & COLLINS | 10-00004-00-SW | JOHNSON | 15 | 2 |

NOTES:

SUMMARY OF QUANTITIES

- ALL MATERIALS AND METHODS SHALL BE IN ACCORDANCE WITH STANDARD SPECIFICATIONS FOR WATER AND SEWER MAIN CONSTRUCTION IN ILLINOIS LATEST EDITION.
- CONTRACTORS SHALL CONTACT EACH UTILITY COMPANY PRIOR TO CONSTRUCTION. ANY DAMAGE CAUSED TO EXISTING UTILITIES SHALL BE THE CONTRACTORS RESPONSIBILITY AND CONTRACTOR SHALL LEND ALL POSSIBLE ASSISTANCE IN RESTORING SERVICE.
- NOT ALL OF THE GAS, POWER OR TELEPHONE LINES, WERE ABOVE OR BELOW GROUND, HAVE BEEN SHOWN ON THE PLANS. THE LOCATION OF EXISTING UNDERGROUND UTILITIES, SUCH AS GAS OR WATER MAINS, ETC., AS SHOWN ON THE PLANS HAVE BEEN DETERMINED FROM THE BEST AVAILABLE INFORMATION AND ARE GIVEN FOR THE CONVENIENCE OF THE CONTRACTOR. THE CONTRACTOR SHALL ASSUME RESPONSIBILITY FOR ALL UTILITIES, WHETHER SHOWN OR NOT, AND MUST REALIZE THAT THE ACTUAL LOCATIONS AND THOSE SHOWN MAY BE DIFFERENT.
- INTERRUPTION OF UTILITY SERVICE IS NOT EXPECTED. HOWEVER, IF INTERRUPTION OF ANY UTILITY SERVICE IS NECESSARY, THE CONTRACTOR SHALL GIVE AT LEAST ONE DAY NOTICE TO CUSTOMERS INVOLVED AND SHALL USE ALL HIS RESOURCES TO MINIMIZE INTERRUPTION.
- ALL DISTURBED AREAS SHALL BE GRADED TO PROVIDE POSITIVE DRAINAGE. CULVERTS, FIELD TILES AND OTHER DRAINAGE FACILITIES DAMAGED DURING CONSTRUCTION SHALL BE REPLACED BY CONTRACTOR AT NO ADDITIONAL COST TO THE VILLAGE.
- ANY PERMANENT SURFACE, STREET, DRIVEWAY, OR SIDEWALK DAMAGE BY CONTRACTOR SHALL BE REPAIRED BY CONTRACTOR.
- DETECTABLE WARNINGS SHALL BE YELLOW IN COLOR AT ALL LOCATIONS.

| CODE # | ITEM DESCRIPTION | TOTAL | UNIT |
|------------|--|-------|----------|
| 20100110 | TREE REMOVAL (6 - 15 UNIT DIAMETER) | 100 | UNIT |
| 20200100 | EARTH EXCAVATION | 300 | CU YD |
| 21400100 | GRADING AND SHAPING DITCH | 400 | FOOT |
| 25000100 | SEEDING, CLASS 1 | 0.9 | ACRE |
| 28100107 | STONE RIP RAP CLASS A 4 | 600 | SQ YD |
| 42400200 | PORTLAND CEMENT CONCRETE SIDEWALK 5 INCH | 4011 | SQ FT |
| 42400400 | PORTLAND CEMENT CONCRETE SIDEWALK 7 INCH | 524 | SQ FT |
| 42400800 | DETECTABLE WARNINGS | 256 | SQ FT |
| 44000300 | CURB REMOVAL | 98 | FOOT |
| 44000600 | SIDEWALK REMOVAL | 1401 | SQ FT |
| 50300225 | CONCRETE STRUCTURES | 28 | CU YD |
| 50901760 | PIPE HANDRAIL | 240 | FOOT |
| 54010604 | PRE CAST CONCRETE BOX CULVERT, 6'x4' | 24 | FOOT |
| 542A0220 | PIPE CULVERT CL A 1, 15" | 20 | FOOT |
| 67100100 | MOBILIZATION | 1 | LUMP SUM |
| 70100450 | TRAFFIC CONTROL AND PROTECTION | 1 | LUMP SUM |
| 72000100 | SIGN PANEL TYPE 1 | 144 | SQ FT |
| 72400500 | RELOCATE SIGN PANEL ASSEMBLY | 3 | EACH |
| 72900100 | METAL POST TYPE A | 168 | FOOT |
| Δ 78001150 | PAINT PAVEMENT MARKING LINE 12" | 1344 | FOOT |
| 54001001 | BOX CULVERT END SECTIONS, CULVERT NO. 1 | 2 | EACH |
| 42300100 | PORTLAND CEMENT CONCRETE DRIVEWAY PAVEMENT, 5 INCH | 16.3 | SQ YD |
| XX000503 | SPLIT RAIL FENCE | 680 | FOOT |
| Δ X0325714 | FLASHING BEACON POST MOUNTED, SOLAR POWERED INSTALLATION | 6 | EACH |

Δ SPECIALTY ITEMS

| NO. | DESCRIPTION | BY | DATE | NO. | DESCRIPTION | BY | DATE |
|-----|-------------|----|------|-----|--------------------------|-----|---------|
| | | | | | DESIGNED | | |
| | | | | | DRAWN | WFL | 3/27/12 |
| | | | | | CHECKED | JHC | 3/27/12 |
| | | | | A1 | REVISED PER IDOT REQUEST | WDS | 7/30/12 |

VILLAGE OF GOREVILLE
JOHNSON COUNTY, IL
SAFE ROUTES TO SCHOOL
NOTES AND QUANTITIES



JOHN H. CRAWFORD & ASSOCIATES, P.C.
CIVIL ENGINEERS, LAND SURVEYORS
201 SOUTH DIVISION STREET, CARTERSVILLE, ILLINOIS 62918
PHONE (618) 985-0370 FAX (618) 985-4092
PROFESSIONAL DESIGN FIRM # 184-002885

| | |
|-----------|---------|
| SHEET NO. | |
| 2 | |
| ISSUE | DATE |
| A1 | 7/30/12 |

| F.A. RTE. | SECTION | COUNTY | TOTAL SHEETS | SHEET NO. |
|------------------|-----------------|---------|--------------|-----------|
| HWY 37 & COLLINS | 10-00004-00-89H | JOHNSON | 15 | 3 |



SCALE: 1" = 10'

LEGEND

- IRON PIN FOUND
- △ STONE FOUND
- 1/2" IRON PIN SET
- CONCRETE MONUMENT SET
- ROAD SIGN
- POWER POLE
- GUY WIRE
- WATER METER
- WATER HYDRANT
- ☆ LIGHT POLE

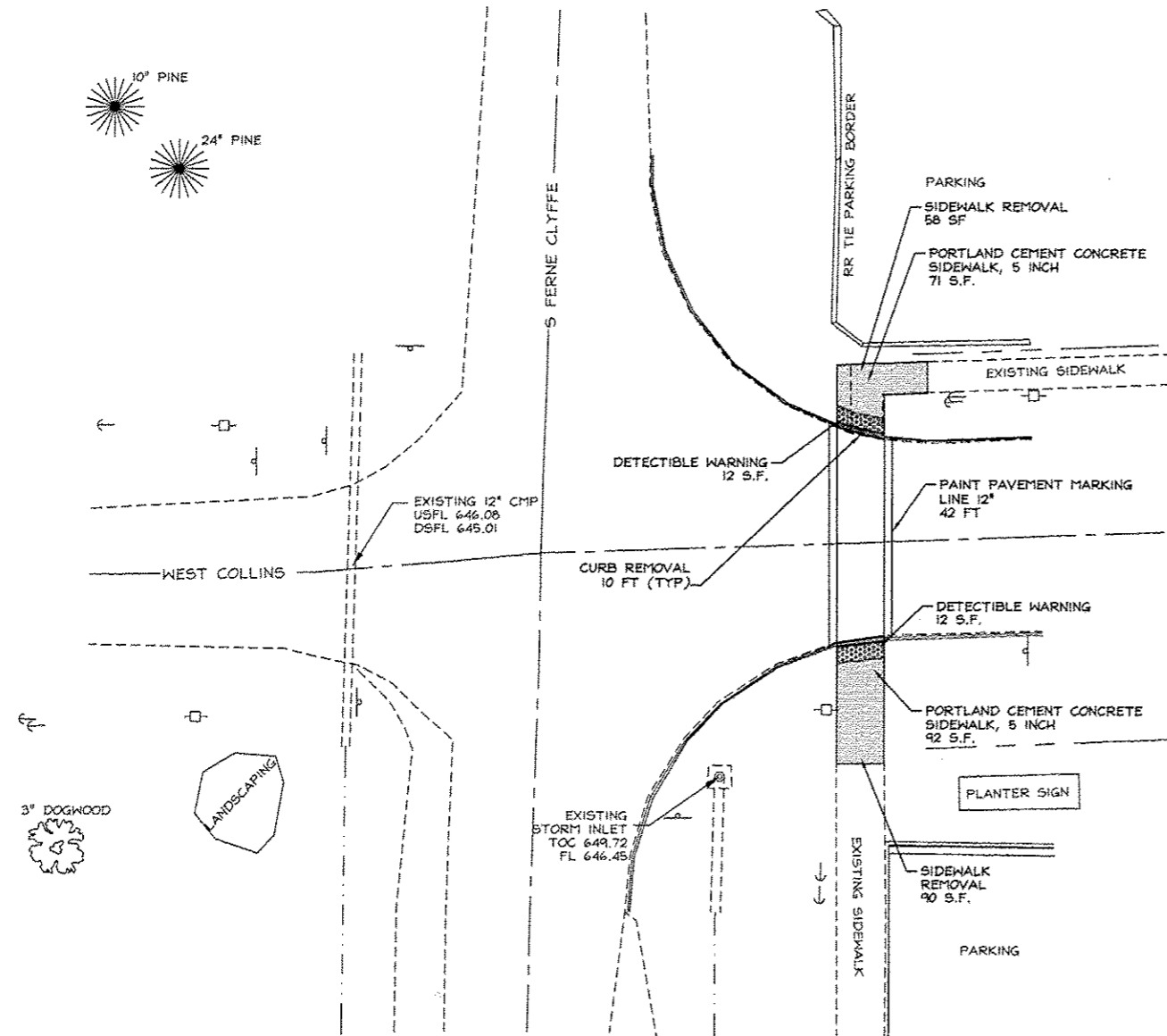

| NO. | DESCRIPTION | BY | DATE | NO. | DESCRIPTION | BY | DATE |
|-----|-------------|----|------|-----|-------------|----|------|
| | | | | | | | |
| | | | | | | | |
| | | | | | | | |

VILLAGE OF GOREVILLE
 JOHNSON COUNTY, IL
 SCHOOL SAFE WAY PLAN
 PLAN SHEET



JOHN H. CRAWFORD & ASSOCIATES, P.C.
 CIVIL ENGINEERS, LAND SURVEYORS
 201 SOUTH DIVISION STREET, CARTERSVILLE, ILLINOIS 62810
 PHONE (618) 985-6370 FAX (618) 985-4692
 PROFESSIONAL DESIGN FIRM # 184-002885

| SHEET NO. | |
|-----------|---------|
| 3 | |
| ISSUE | DATE |
| A | 3/27/12 |

I:\Projects\2012\12-00004\12-00004-00-89H\12-00004-00-89H.dwg 6/15/2012 10:35:24 AM

| F.A. RTE. | SECTION | COUNTY | TOTAL SHEETS | SHEET NO. |
|------------------|----------------|---------|--------------|-----------|
| HWY 37 & COLLINS | 10-00004-00-BK | JOHNSON | 16 | 4 |

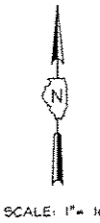
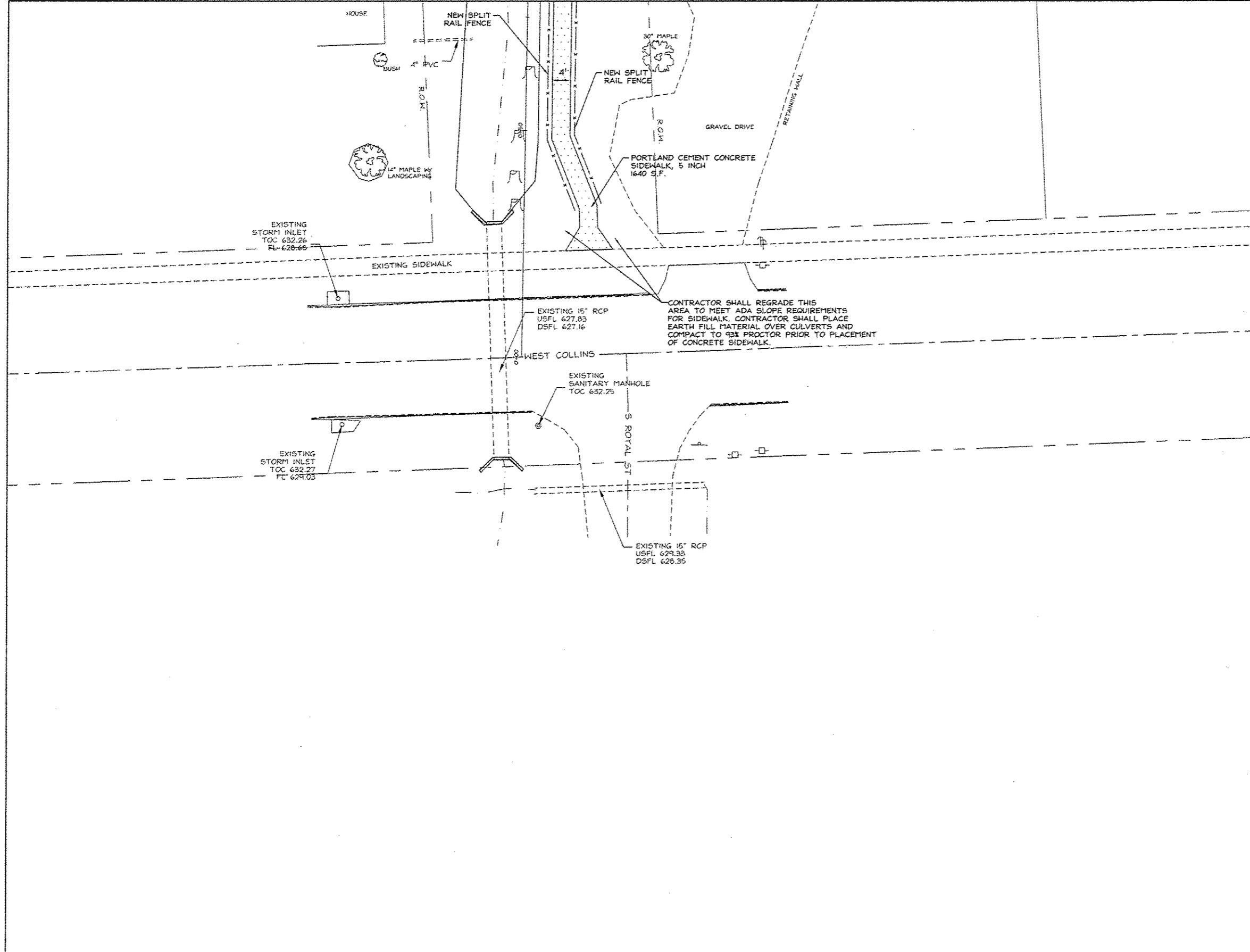

- LEGEND**
- IRON PIN FOUND
 - △ STONE FOUND
 - 1/2" IRON PIN SET
 - CONCRETE MONUMENT SET
 - ∕ ROAD SIGN
 - ⊖ POWER POLE
 - ⊕ GUY WIRE
 - ⊕ WATER METER
 - ⊕ WATER HYDRANT
 - ⊕ LIGHT POLE

| NO. | DESCRIPTION | BY | DATE | NO. | DESCRIPTION | BY | DATE |
|-----|-------------|----|------|-----|-------------|----|------|
| | | | | | | | |
| | | | | | | | |
| | | | | | | | |
| | | | | | | | |

VILLAGE OF GOREVILLE
JOHNSON COUNTY, IL
SCHOOL SAFE WAY PLAN
PLAN SHEET



JOHN H. CRAWFORD & ASSOCIATES, P.C.
CIVIL ENGINEERS, LAND SURVEYORS
201 SOUTH DIVISION STREET, CARTERSVILLE, ILLINOIS 62910
PHONE (618) 685-0370 FAX (618) 965-4692
PROFESSIONAL DESIGN FIRM # 184-002895

| | |
|-----------|---------|
| SHEET NO. | |
| 4 | |
| ISSUE | DATE |
| A | 3/27/12 |

X:\goreville\Lead_Plan\10-00004\GOREVILLE_SCHOOL_SAFE_WAY_PLAN_SHEET_4.dwg 10/27/2012 3:46:18 PM

| F.A. RTE. | SECTION | COUNTY | TOTAL SHEETS | SHEET NO. |
|------------------|----------------|---------|--------------|-----------|
| HWY 37 & COLLINS | 10-00004-00-SH | JOHNSON | 15 | 5 |

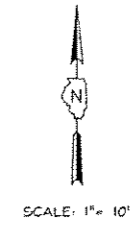

- LEGEND**
- IRON PIN FOUND
 - △ STONE FOUND
 - 1/2" IRON PIN SET
 - CONCRETE MONUMENT SET
 - ∕ ROAD SIGN
 - ⊕ POWER POLE
 - ⊖ GUY WIRE
 - ⊙ WATER METER
 - ⊕ WATER HYDRANT
 - ☆ LIGHT POLE

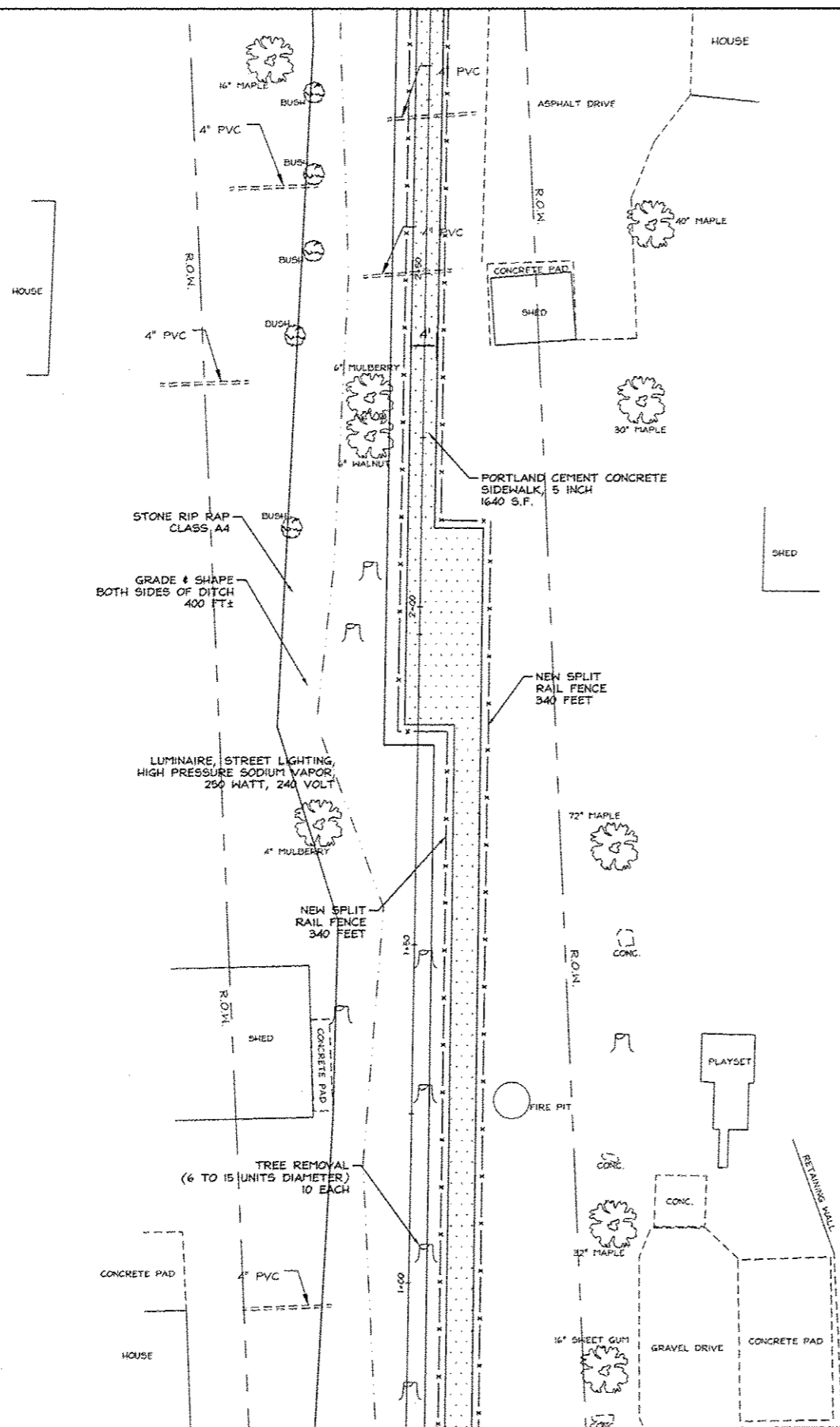

| NO. | DESCRIPTION | BY | DATE | NO. | DESCRIPTION | BY | DATE | NO. | DESCRIPTION | BY | DATE |
|-----|-------------|----|------|-----|-------------|----|------|-----|-------------|-----|---------|
| | | | | | | | | | DESIGNED | | |
| | | | | | | | | | DRAWN | WFL | 3/27/12 |
| | | | | | | | | | CHECKED | JHC | 3/27/12 |

VILLAGE OF GOREVILLE
 JOHNSON COUNTY, IL
 SCHOOL SAFE WAY PLAN
 PLAN SHEET



JOHN H. CRAWFORD & ASSOCIATES, P.C.
 CIVIL ENGINEERS, LAND SURVEYORS
 201 SOUTH DIVISION STREET, CARTERSVILLE, ILLINOIS 62916
 PHONE (618) 985-8370 FAX (618) 985-4892
 PROFESSIONAL DESIGN FIRM # 164-002885

| | |
|-----------|---------|
| SHEET NO. | |
| 5 | |
| ISSUE | DATE |
| A | 3/27/12 |

C:\WORK\1004 PROJECT\GOREVILLE SCHOOLSAFEWAYPLAN\GOREVILLE_SCHOOLSAFEWAYPLAN.DWG, 10/27/2012 2:51:20 PM

| F.A. RTE. | SECTION | COUNTY | TOTAL SHEETS | SHEET NO. |
|------------------|----------------|---------|--------------|-----------|
| HWY 37 & COLLINS | 10-00004-00-BH | JOHNSON | 15 | 6 |

SCALE: 1" = 10'

LEGEND

- ⊙ IRON PIN FOUND
- △ STONE FOUND
- 1/2" IRON PIN SET
- CONCRETE MONUMENT SET
- ROAD SIGN
- ⊕ POWER POLE
- GUY WIRE
- ⊕ WATER METER
- ⊕ WATER HYDRANT
- ⊕ LIGHT POLE

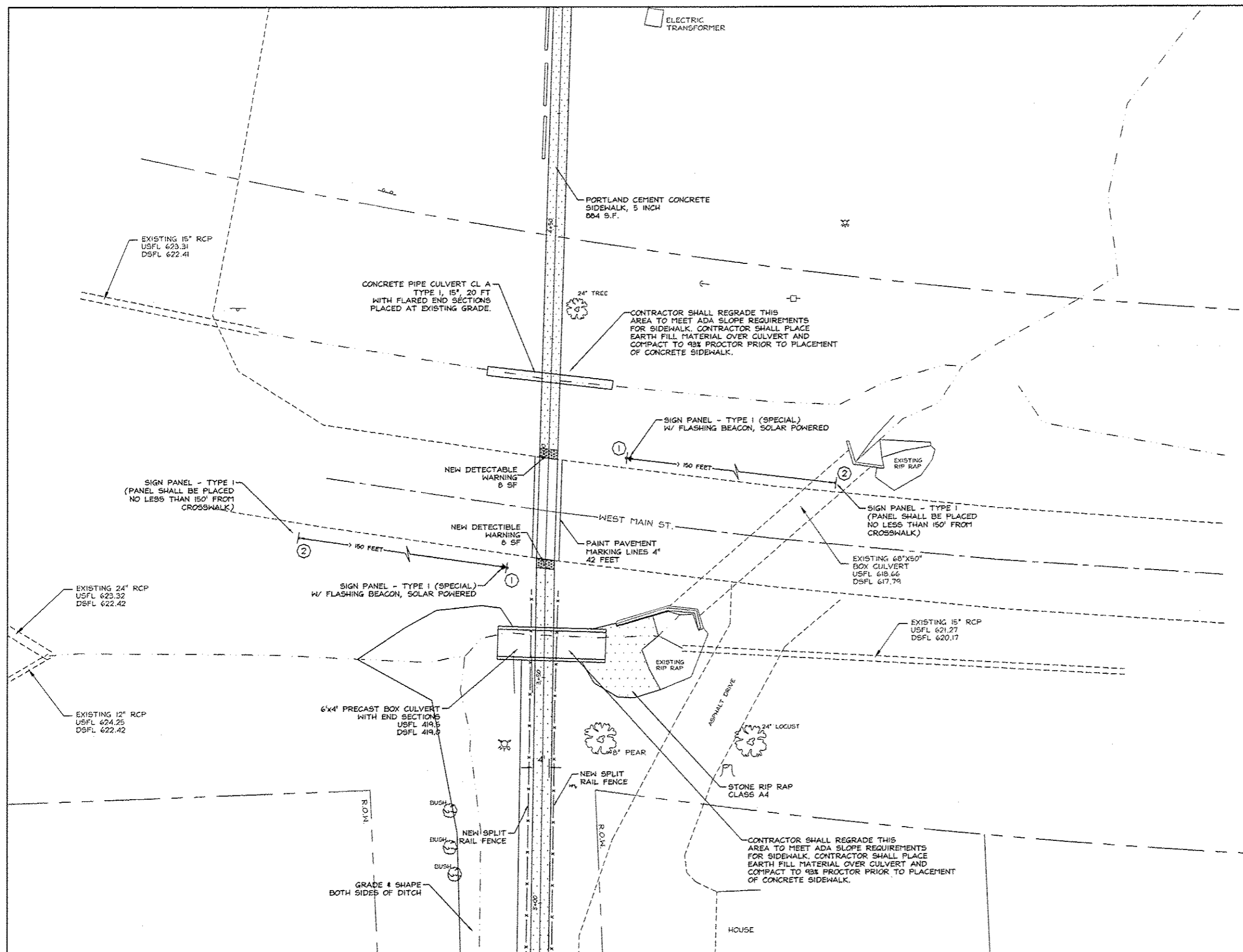

| NO. | DESCRIPTION | BY | DATE | NO. | DESCRIPTION | BY | DATE |
|-----|-------------|----|------|-----|--------------------------|-----|---------|
| | | | | | DESIGNED | | |
| | | | | | DRAWN | WFL | 3/27/12 |
| | | | | | CHECKED | JHC | 3/27/12 |
| | | | | A1 | REVISED PER IDOT REQUEST | WDS | 7/30/12 |

VILLAGE OF GOREVILLE
 JOHNSON COUNTY, IL
 SCHOOL SAFE WAY PLAN
 PLAN SHEET

JOHN H. CRAWFORD & ASSOCIATES, P.C.
 CIVIL ENGINEERS, LAND SURVEYORS
 201 SOUTH DIVISION STREET, CARTERSVILLE, ILLINOIS 62918
 PHONE (618) 985-8370 FAX (618) 985-4692
 PROFESSIONAL DESIGN FIRM # 184-052865

| | |
|-----------|---------|
| SHEET NO. | |
| 6 | |
| ISSUE | DATE |
| A1 | 7/30/12 |

K:\GIS\land Projects\Goreville\GOREVILLE SAFEWAY PLAN SHEETS 2012.dwg, 10/27/2012 3:25:31 PM

| F.A. RTE. | SECTION | COUNTY | TOTAL SHEET | SHEET |
|------------------|----------------|---------|-------------|-------|
| HWY 37 & COLLINS | 10-00004-00-SK | JOHNSON | 15 | 7 |

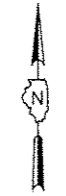

SCALE: 1" = 10'

- LEGEND**
- IRON PIN FOUND
 - △ STONE FOUND
 - 1/2" IRON PIN SET
 - CONCRETE MONUMENT SET
 - ⚡ ROAD SIGN
 - ⊕ POWER POLE
 - ⊖ GUY WIRE
 - ⊕ WATER METER
 - ⊕ WATER HYDRANT
 - ☆ LIGHT POLE

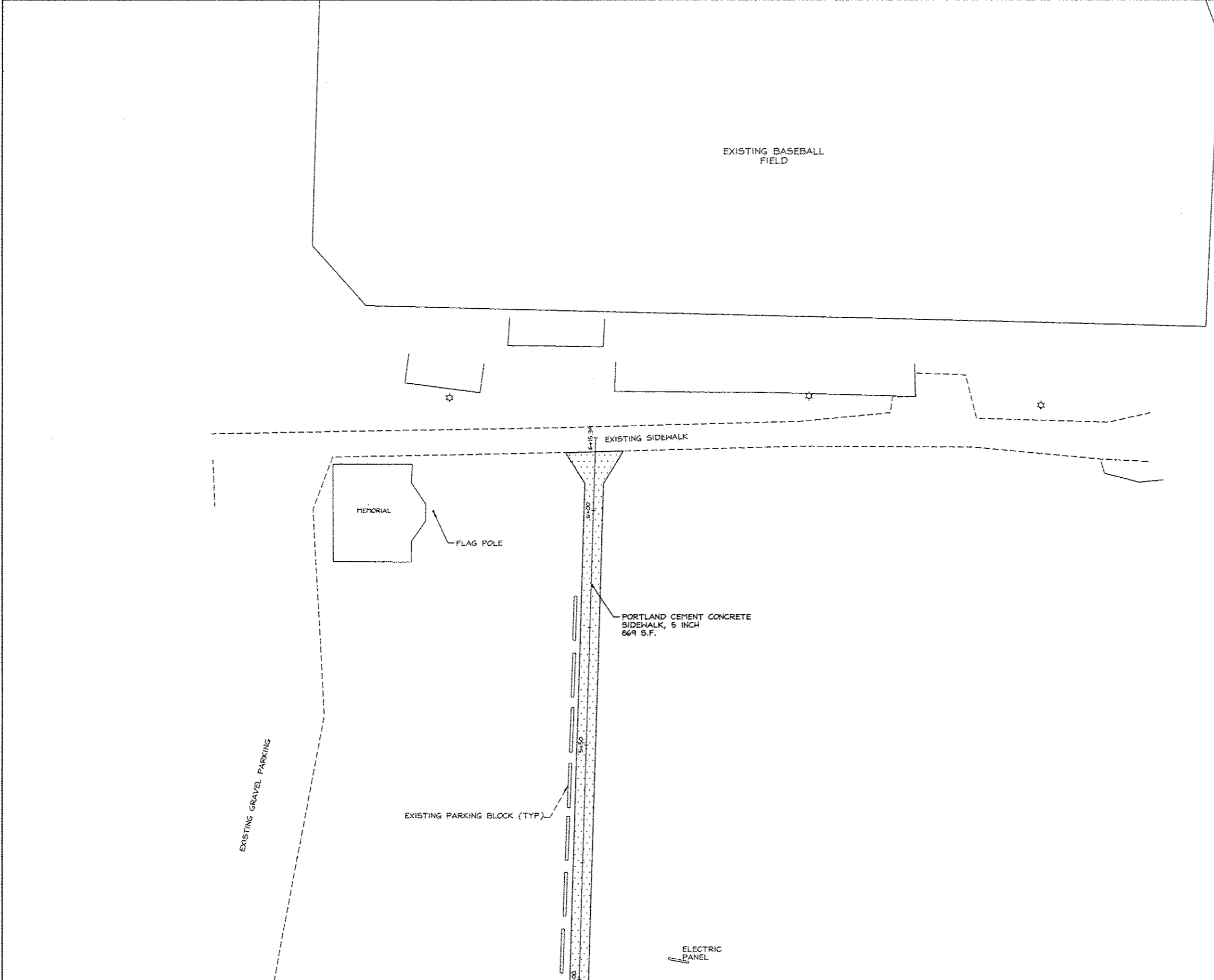

| NO. | DESCRIPTION | BY | DATE | NO. | DESCRIPTION | BY | DATE |
|-----|-------------|----|------|-----|-------------|----|------|
| | | | | | | | |
| | | | | | | | |
| | | | | | | | |
| | | | | | | | |

VILLAGE OF GOREVILLE
 JOHNSON COUNTY, IL
 SCHOOL SAFE WAY PLAN
 PLAN SHEET



JOHN H. CRAWFORD & ASSOCIATES, P.C.
 CIVIL ENGINEERS, LAND SURVEYORS
 201 SOUTH DIVISION STREET, CARTERSVILLE, ILLINOIS 62919
 PHONE (618) 995-6370 FAX (618) 995-6692
 PROFESSIONAL DESIGN FIRM # 164-002865

| | |
|-----------|---------|
| SHEET NO. | |
| 7 | |
| ISSUE | DATE |
| A | 3/27/12 |

V:\Projects\12-00004\GOREVILLE SCHOOL SAFE WAY PLAN SHEET 7.DWG 6/7/2012 10:34 AM

| F.A. RTE. | SECTION | COUNTY | TOTAL SHEET | SHEET NO. |
|------------------|----------------|---------|-------------|-----------|
| HWY 37 & COLLINS | 10-00004-00-3H | JOHNSON | 15 | 8 |



SCALE: 1" = 10'

- LEGEND**
- IRON PIN FOUND
 - △ STONE FOUND
 - 1/2" IRON PIN SET
 - CONCRETE MONUMENT SET
 - ∠ ROAD SIGN
 - ⊖ POWER POLE
 - ⊘ GUY WIRE
 - ⊕ WATER METER
 - ⊙ WATER HYDRANT
 - ⊛ LIGHT POLE
 - MAILBOX

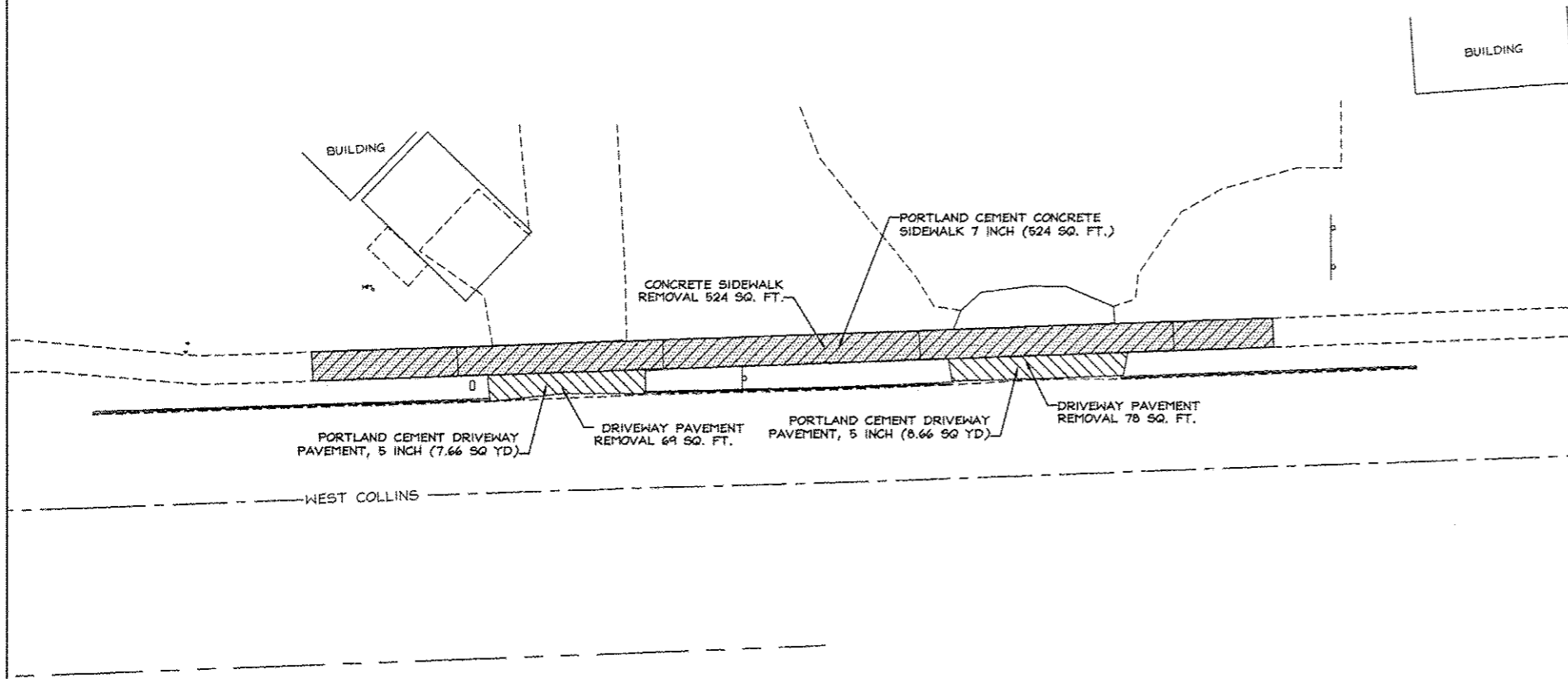

10/10/2012 9:04:11 AM C:\WORK\100004\100004_00_3H.DWG 3/27/12 10:29:01 AM

| NO. | DESCRIPTION | BY | DATE | NO. | DESCRIPTION | BY | DATE |
|-----|-------------|----|------|-----|-------------|----|------|
| | | | | | | | |
| | | | | | | | |
| | | | | | | | |
| | | | | | | | |

VILLAGE OF GOREVILLE
 JOHNSON COUNTY, IL
 SCHOOL SAFE WAY PLAN
 PLAN SHEET



JOHN H. CRAWFORD & ASSOCIATES, P.C.
 CIVIL ENGINEERS, LAND SURVEYORS
 201 SOUTH DIVISION STREET, CARTERSVILLE, ILLINOIS 62919
 PHONE (618) 895-6370 FAX (618) 895-4592
 PROFESSIONAL DESIGN FIRM # 184-002885

| SHEET NO. | |
|-----------|---------|
| 8 | |
| ISSUE | DATE |
| A | 3/27/12 |

| | | | | |
|------------------|----------------|---------|--------------|-----------|
| F.A. RTE. | SECTION | COUNTY | TOTAL SHEETS | SHEET NO. |
| HWY 37 & COLLINS | 10-00004-00-SW | JOHNSON | 16 | 9 |

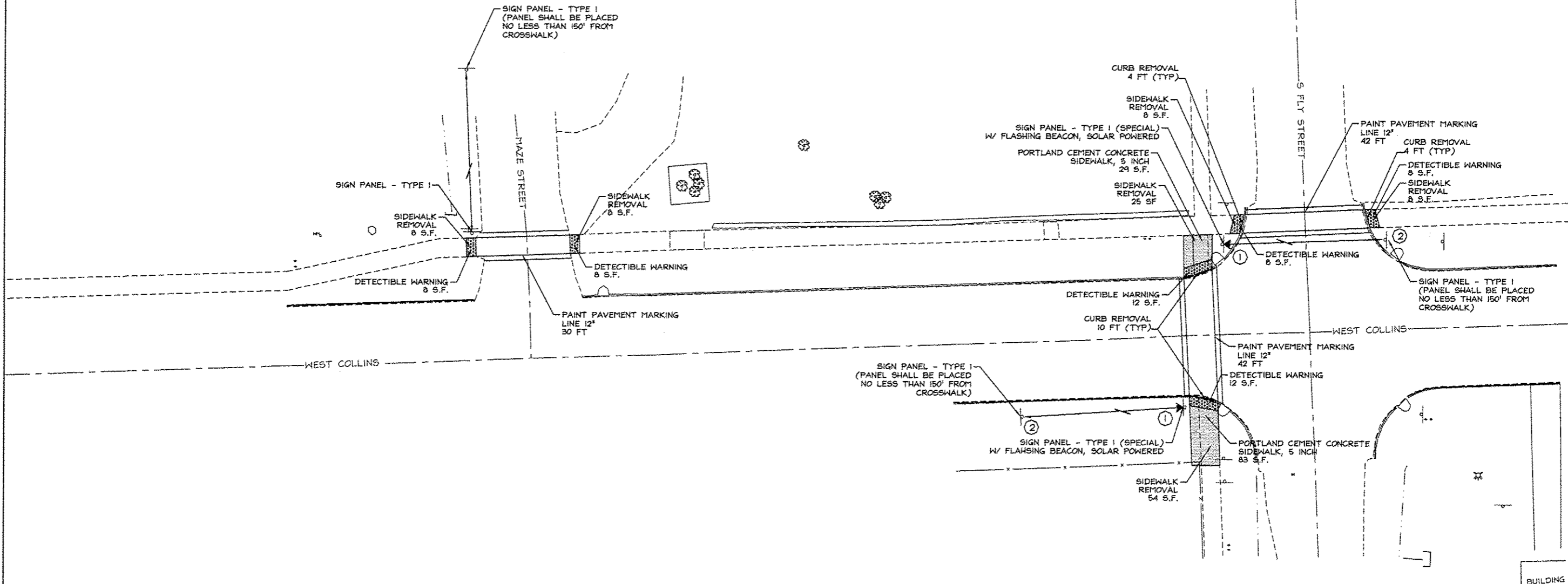

SCALE: 1" = 10'

LEGEND

- IRON PIN FOUND
- △ STONE FOUND
- 1/2" IRON PIN SET
- CONCRETE MONUMENT SET
- ⊕ ROAD SIGN
- ⊖ POWER POLE
- ⊘ GUY WIRE
- ⊙ WATER METER
- ⊚ WATER HYDRANT
- ⊛ LIGHT POLE

| NO. | DESCRIPTION | BY | DATE | NO. | DESCRIPTION | BY | DATE | DESIGNED | BY | DATE |
|-----|-------------|----|------|-----|-------------|----|------|----------|-----|---------|
| | | | | | | | | | | |
| | | | | | | | | DRAWN | WFL | 3/27/12 |
| | | | | | | | | CHECKED | JHC | 3/27/12 |

VILLAGE OF GOREVILLE
JOHNSON COUNTY, IL
SCHOOL SAFE WAY PLAN
PLAN SHEET

JOHN H. CRAWFORD & ASSOCIATES, P.C.
CIVIL ENGINEERS, LAND SURVEYORS
201 SOUTH DIVISION STREET, CARTERSVILLE, ILLINOIS 62816
PHONE (618) 955-0370 FAX (618) 955-4692
PROFESSIONAL DESIGN FIRM # 184-002885

| | |
|-----------|---------|
| SHEET NO. | |
| 9 | |
| ISSUE | DATE |
| A | 3/27/12 |

10/25/2011 10:00 AM PROJECT: SCHOOL SAFE WAY PLAN SHEET NO. 9 DATE: 3/27/12 10:00 AM

| F.A. RTE. | SECTION | COUNTY | TOTAL SHEETS | SHEET NO. |
|------------------|----------------|---------|--------------|-----------|
| Hwy 37 & COLLINS | 10-00004-00-54 | JOHNSON | 15 | 10 |

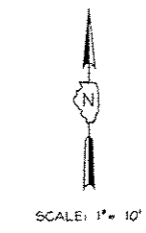

- LEGEND**
- ⊙ IRON PIN FOUND
 - △ STONE FOUND
 - 1/2" IRON PIN SET
 - CONCRETE MONUMENT SET
 - ROAD SIGN
 - ⊕ POWER POLE
 - GUY WIRE
 - ⊕ WATER METER
 - ⊕ WATER HYDRANT
 - ⊕ LIGHT POLE

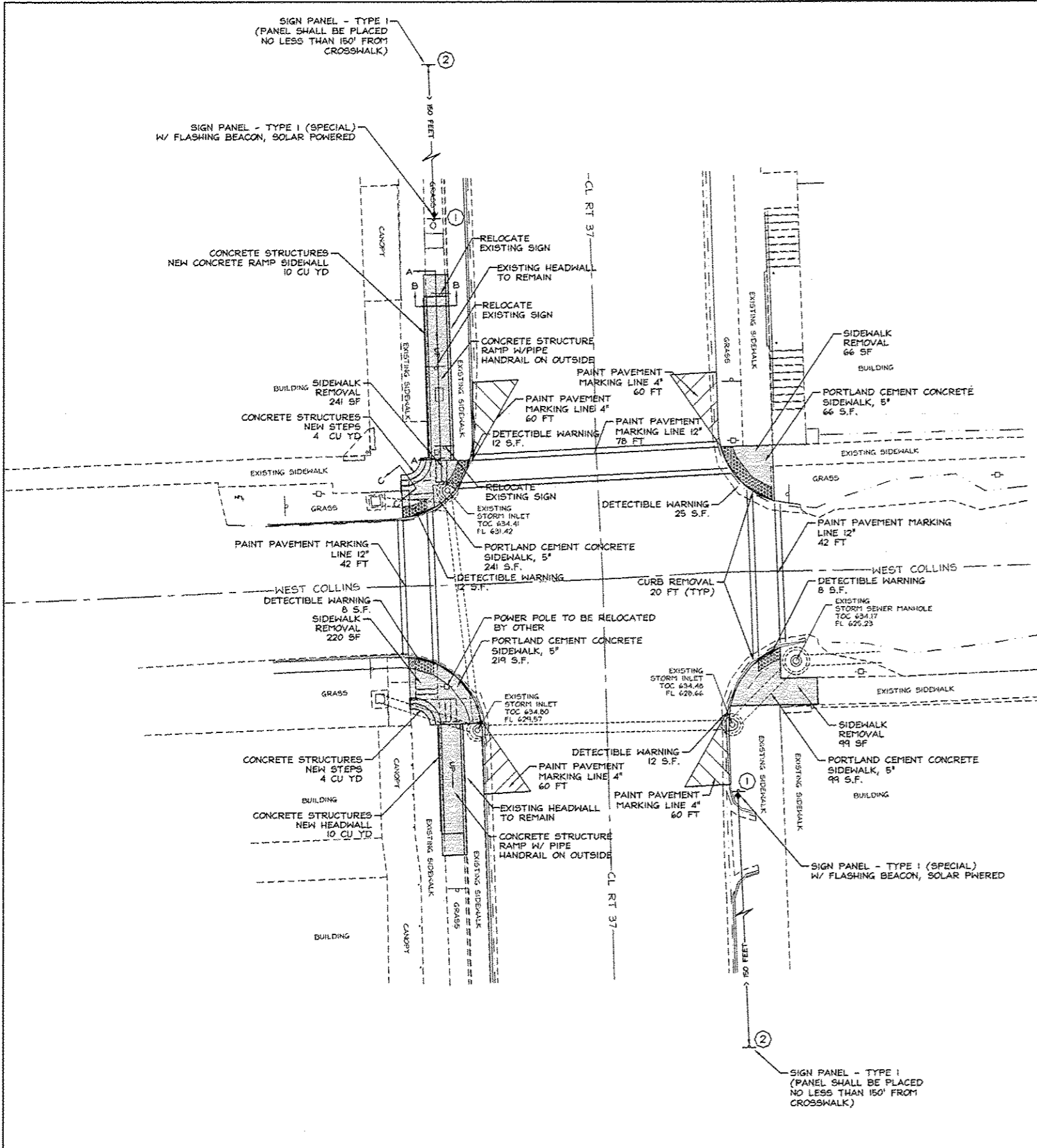

C:\Users\land\Documents\PROJECTS\2012\2012_03_27_12_15_51_17.dwg

| NO. | DESCRIPTION | BY | DATE | NO. | DESCRIPTION | BY | DATE |
|-----|-------------|----|------|-----|-------------|-----|---------|
| | | | | | DESIGNED | | |
| | | | | | DRAWN | WFL | 3/27/12 |
| | | | | | CHECKED | JHC | 3/27/12 |

VILLAGE OF GOREVILLE
 JOHNSON COUNTY, IL
 SCHOOL SAFE WAY PLAN
 PLAN SHEET

JOHN H. CRAWFORD & ASSOCIATES, P.C.
 CIVIL ENGINEERS, LAND SURVEYORS
201 SOUTH DIVISION STREET, CARTERSVILLE, ILLINOIS 62918
 PHONE (618) 985-9370 FAX (618) 985-4992
 PROFESSIONAL DESIGN FIRM # 164-002892

| | |
|-----------|---------|
| SHEET NO. | |
| 10 | |
| ISSUE | DATE |
| A | 3/27/12 |

| | | | | |
|------------------|----------------|---------|--------------|-----------|
| F.A. RTE. | SECTION | COUNTY | TOTAL SHEETS | SHEET NO. |
| Hwy 37 & COLLINS | 10-00004-00-3W | JOHNSON | 16 | 11 |

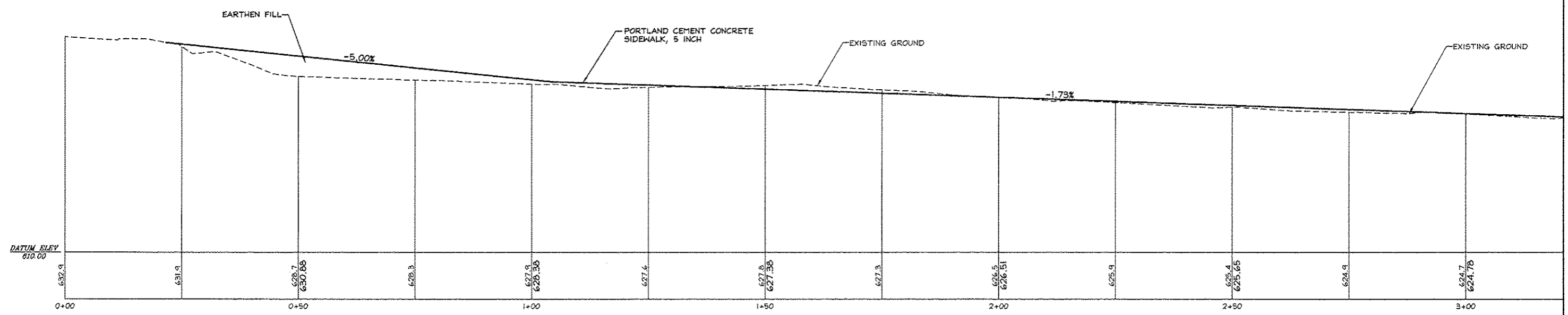

VILLAGE OF GOREVILLE, ILLINOIS, 1000 WEST MAIN STREET, GOREVILLE, ILLINOIS 62246-1111

| NO. | DESCRIPTION | BY | DATE | NO. | DESCRIPTION | BY | DATE |
|-----|-------------|----|------|-----|-------------|----|------|
| | | | | | | | |
| | | | | | | | |
| | | | | | | | |

VILLAGE OF GOREVILLE
 JOHNSON COUNTY, IL
 SCHOOL SAFE WAY PLAN
 SIDEWALK PROFILE



JOHN H. CRAWFORD & ASSOCIATES, P.C.
 CIVIL ENGINEERS, LAND SURVEYORS
 201 SOUTH DIVISION STREET, CARTERSVILLE, ILLINOIS 62918
 PHONE (618) 985-6370 FAX (618) 985-4882
 PROFESSIONAL DESIGN FIRM # 184-002855

| | |
|-----------|---------|
| SHEET NO. | |
| 11 | |
| ISSUE | DATE |
| A | 3/27/12 |

| F.A. RTE. | SECTION | COUNTY | TOTAL SHEETS | SHEET NO. |
|------------------|----------------|---------|--------------|-----------|
| HWY 37 # COLLINS | 10-00004-00-SW | JOHNSON | 15 | 12 |

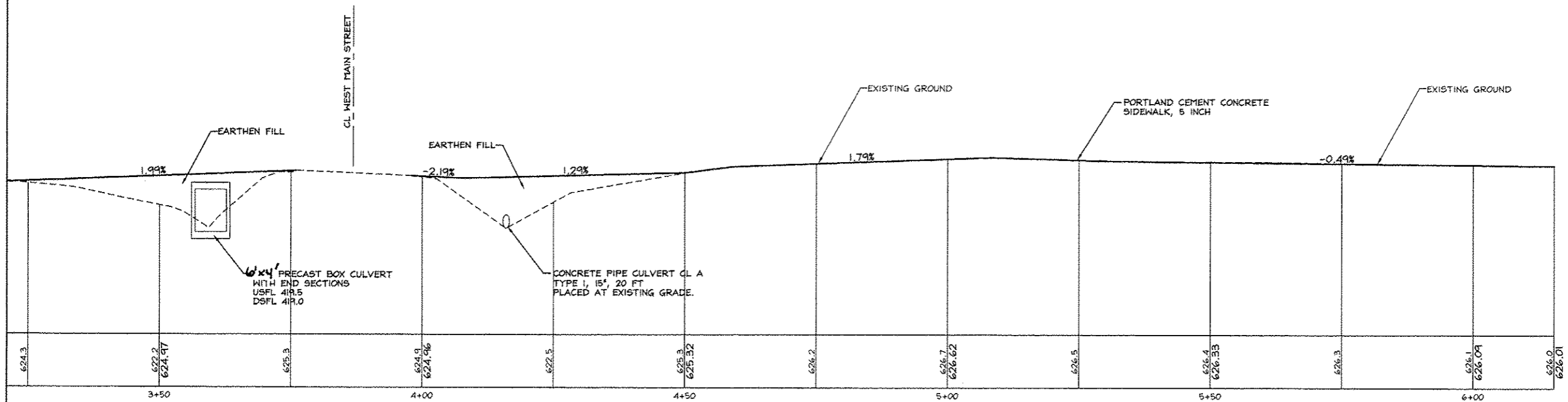

| NO. | DESCRIPTION | BY | DATE | NO. | DESCRIPTION | BY | DATE |
|-----|-------------|----|------|-----|-------------|----|------|
| | | | | | | | |
| | | | | | | | |
| | | | | | | | |

VILLAGE OF GOREVILLE
 JOHNSON COUNTY, IL
 SCHOOL SAFE WAY PLAN
 SIDEWALK PROFILE



JOHN H. CRAWFORD & ASSOCIATES, P.C.
 CIVIL ENGINEERS, LAND SURVEYORS
 201 SOUTH DIVISION STREET, CARTERSVILLE, ILLINOIS 62918
 PHONE (618) 985-6370 FAX (618) 985-4652
 PROFESSIONAL DESIGN FIRM # 184-002885

| | |
|-----------|---------|
| SHEET NO. | |
| 12 | |
| ISSUE | DATE |
| A | 3/27/12 |

I:\Projects\2012\12-00004-00-SW\12-00004-00-SW-12.dwg 3/27/12 10:26:13 AM

| | | | | |
|------------------|----------------|---------|--------------|-----------|
| F.A. RTE. | SECTION | COUNTY | TOTAL SHEETS | SHEET NO. |
| HWY 57 & COLLINS | 10-00004-00-SH | JOHNSON | 15 | 13 |

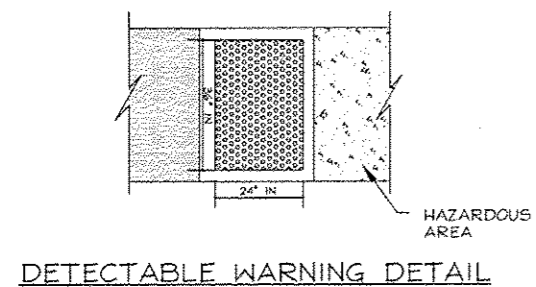
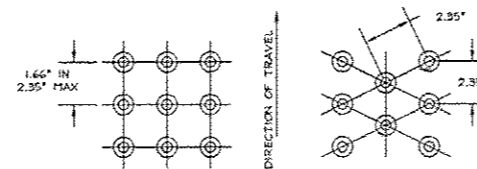
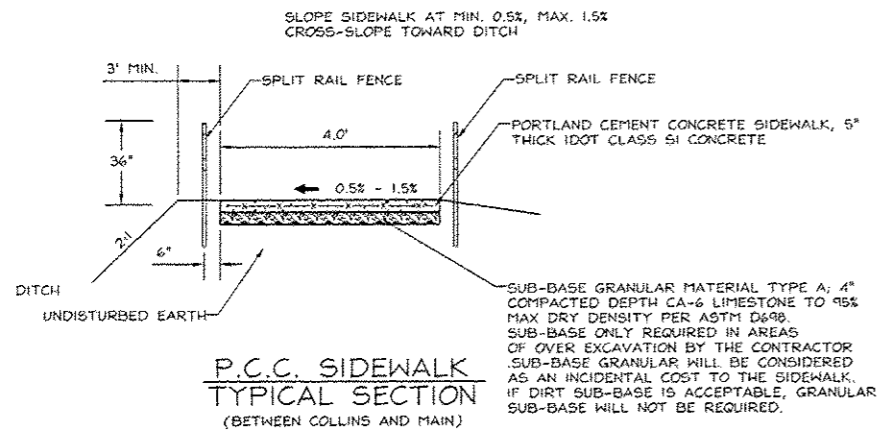
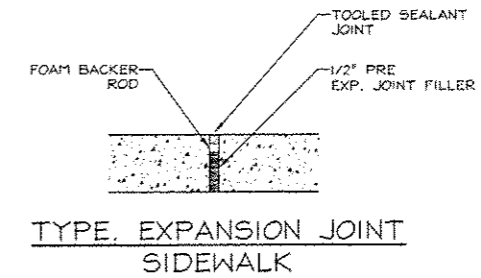
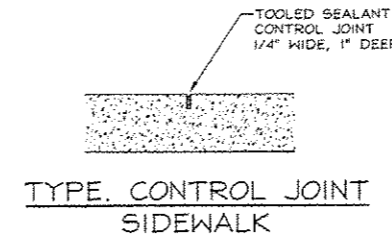
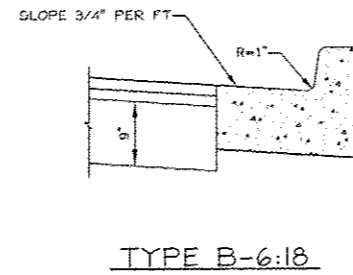
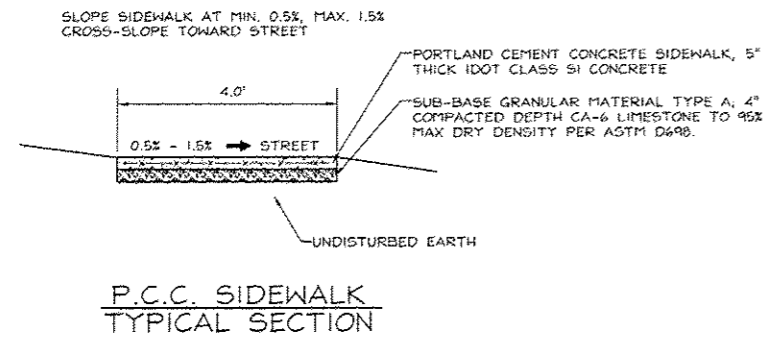

| LOCATION | QTY | SIGN CODE | SIZE | SYMB/LETT/BORD | BACKGROUND |
|----------|-----|---|---------|----------------|--------------------------|
| ① | 6 | SI-1 | 36"X36" | BLACK | FLUORESCENT YELLOW-GREEN |
| | 6 | WI6-7P | 24"X12" | BLACK | FLUORESCENT YELLOW-GREEN |
| | 6 | AMBER BEACON-SEE SPECIFICATIONS FOR DETAILS | | | |
| ② | 6 | SI-1 | 36"X36" | BLACK | FLUORESCENT YELLOW-GREEN |
| | 6 | WI6-9P | 24"X12" | BLACK | FLUORESCENT YELLOW-GREEN |

SCHEDULE OF SIGNS

| NO. | DESCRIPTION | BY | DATE | NO. | DESCRIPTION | BY | DATE |
|-----|-------------|----|------|-----|-------------|-----|---------|
| | | | | | DESIGNED | | |
| | | | | | DRAWN | WFL | 3/27/12 |
| | | | | | CHECKED | JHC | 3/27/12 |

VILLAGE OF GOREVILLE
JOHNSON COUNTY, IL
SAFE ROUTES TO SCHOOL
SIDEWALK DETAIL AND SIGN SCHEDULE



JOHN H. CRAWFORD & ASSOCIATES, P.C.
CIVIL ENGINEERS, LAND SURVEYORS
201 SOUTH DIVISION STREET, CARTERSVILLE, ILLINOIS 62918
PHONE (618) 985-8370 FAX (618) 985-4682
PROFESSIONAL DESIGN FIRM # 184-002985

| | |
|-----------|---------|
| SHEET NO. | |
| 13 | |
| ISSUE | DATE |
| A | 3/27/12 |

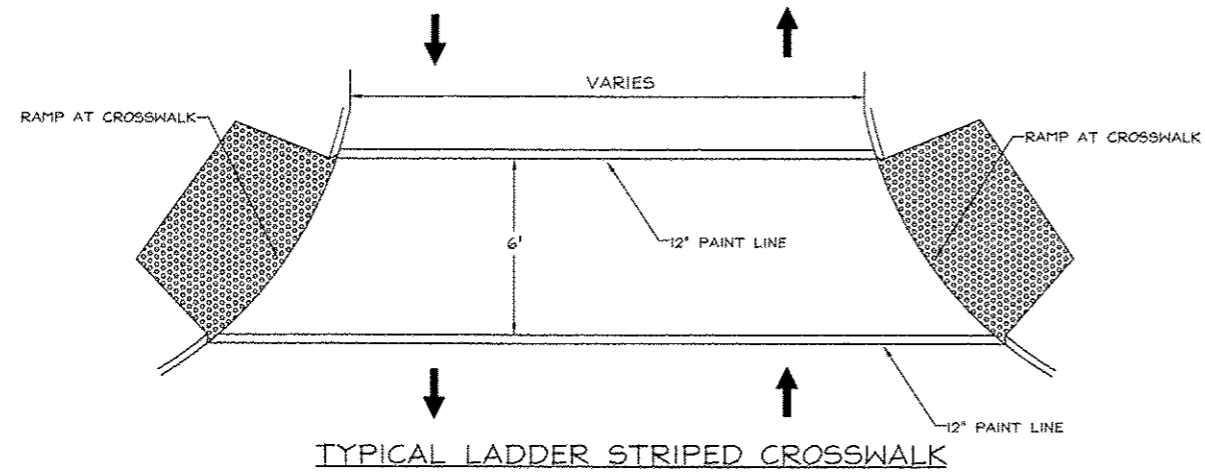

NOTE: DETAILS FOR WORK LOCATED AT THE SOUTHWEST CORNER OF HIGHWAY 37 AND COLLINS STREET SHALL BE MIRROR VIEW OF DETAILS A-A, B-B, AND C-C.

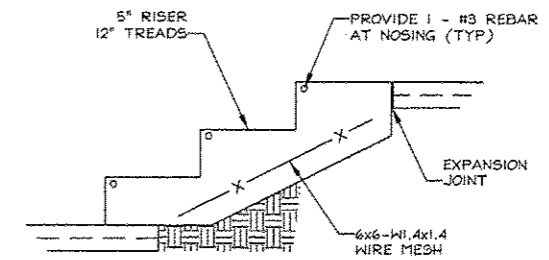
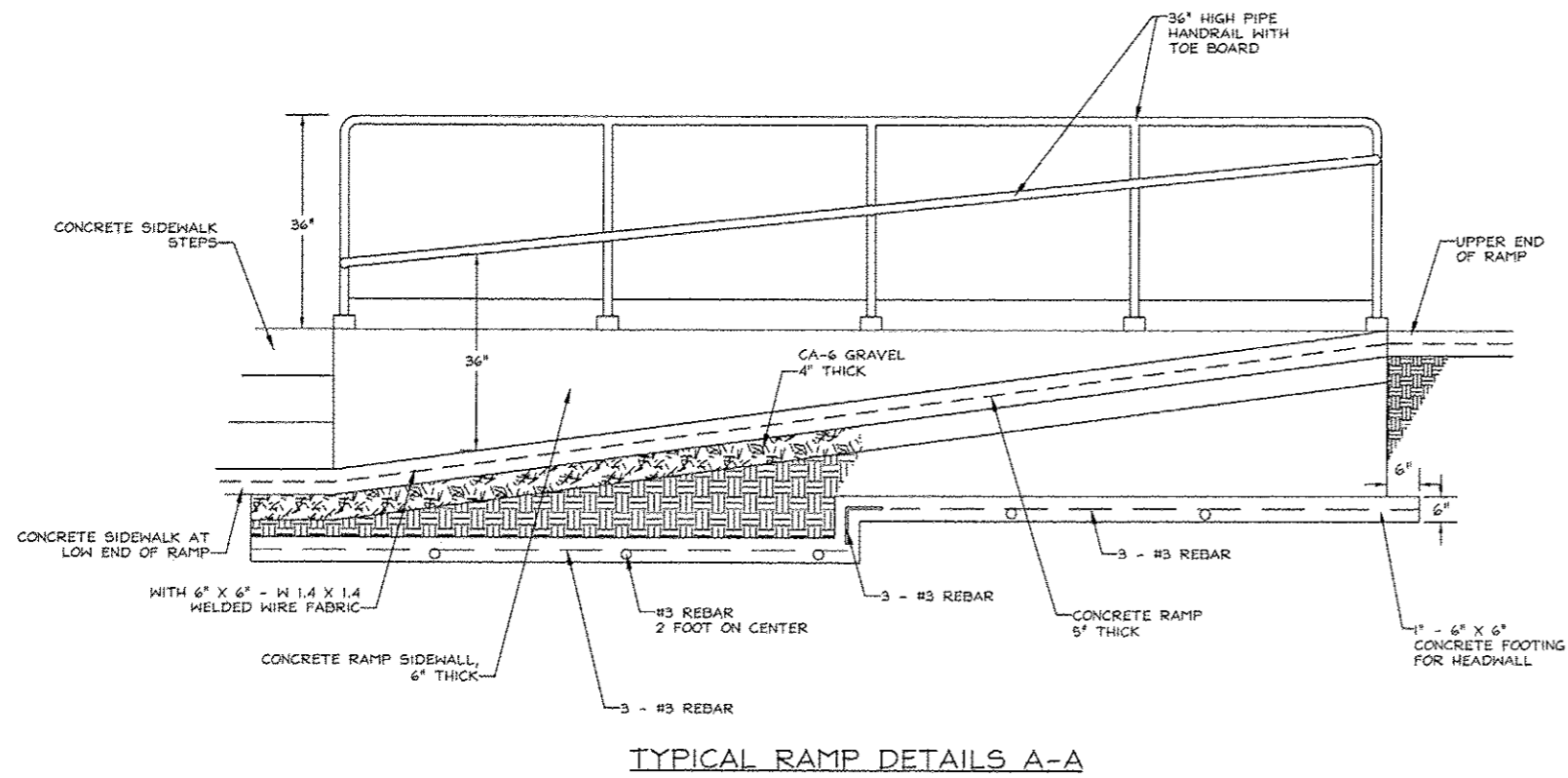
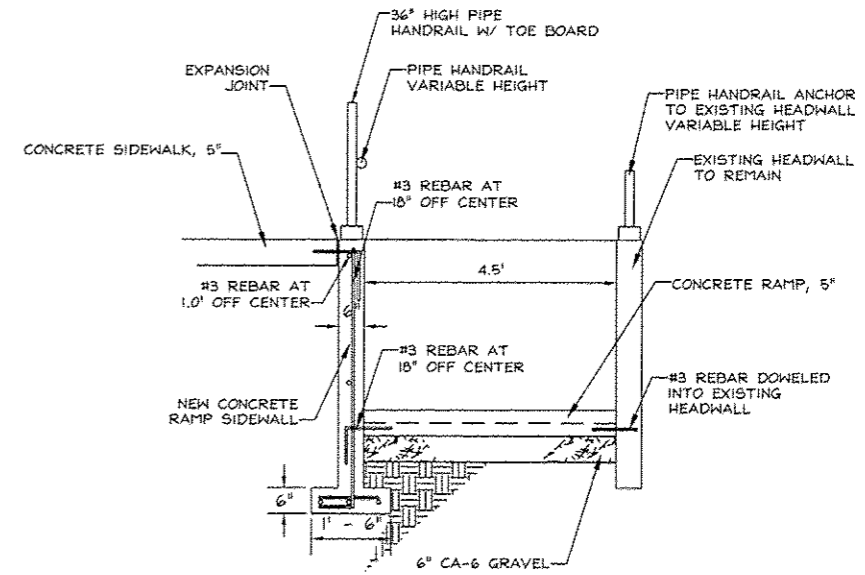

| NO. | DESCRIPTION | BY | DATE | NO. | DESCRIPTION | BY | DATE |
|-----|-------------|----|------|-----|-------------|-----|---------|
| | | | | | DESIGNED | | |
| | | | | | DRAWN | WFL | 3/27/12 |
| | | | | | CHECKED | JHC | 3/27/12 |

VILLAGE OF GOREVILLE
JOHNSON COUNTY, IL
SAFE ROUTES TO SCHOOL
SIDEWALK DETAIL

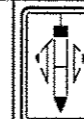

JOHN H. CRAWFORD & ASSOCIATES, P.C.
CIVIL ENGINEERS, LAND SURVEYORS
201 SOUTH DIVISION STREET, CARTERSVILLE, ILLINOIS 62918
PHONE (618) 965-6370 FAX (618) 965-6992
PROFESSIONAL DESIGN FIRM # 184-002885

| | |
|-----------|---------|
| SHEET NO. | |
| 14 | |
| ISSUE | DATE |
| A | 3/27/12 |

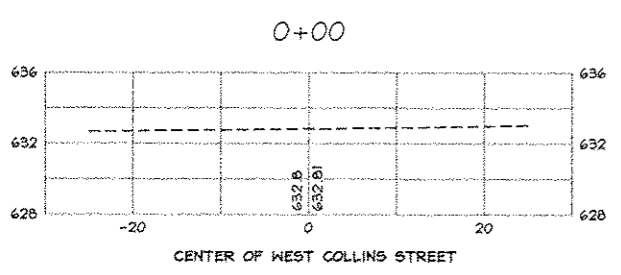
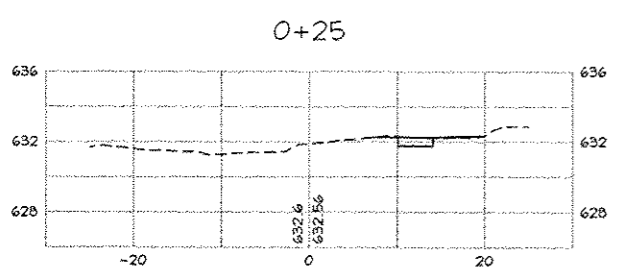
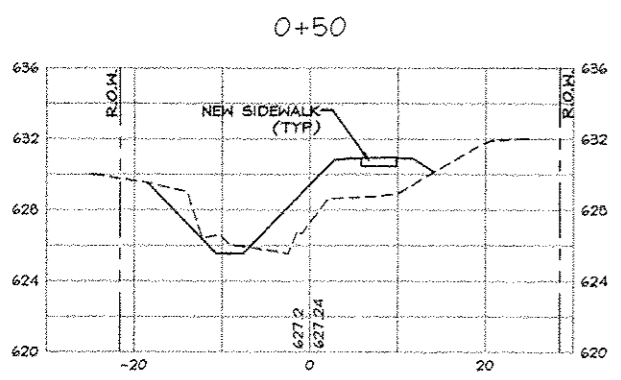
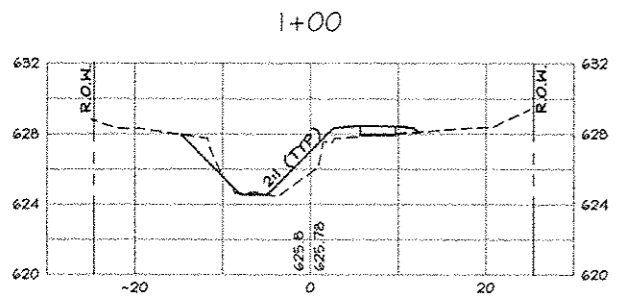
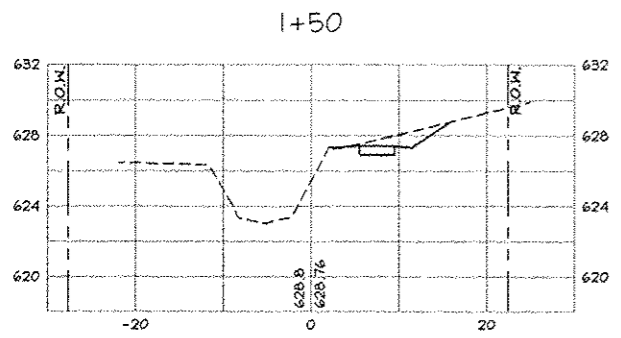

CENTER OF WEST COLLINS STREET

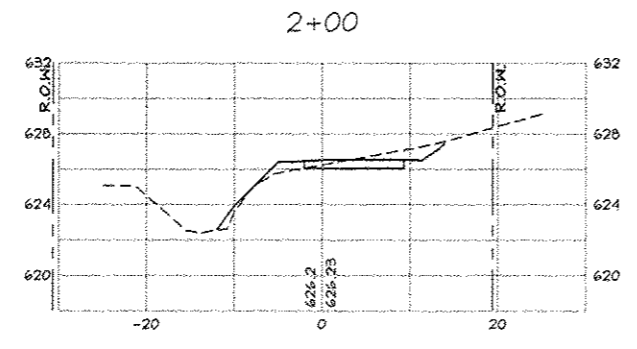
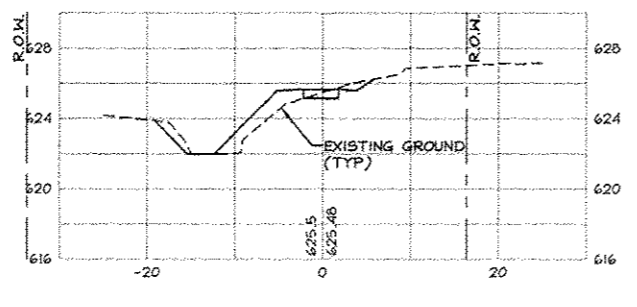
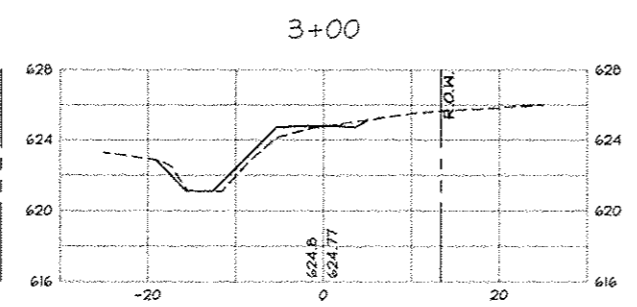
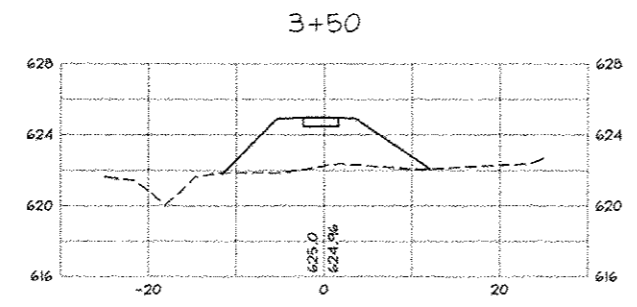

CENTER OF WEST MAIN STREET

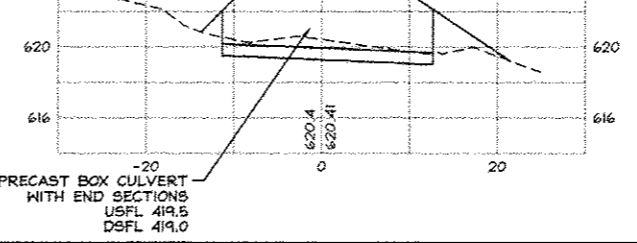
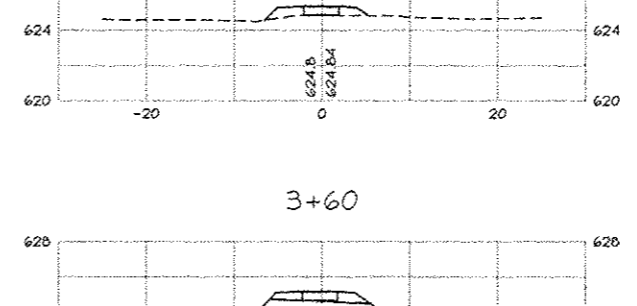
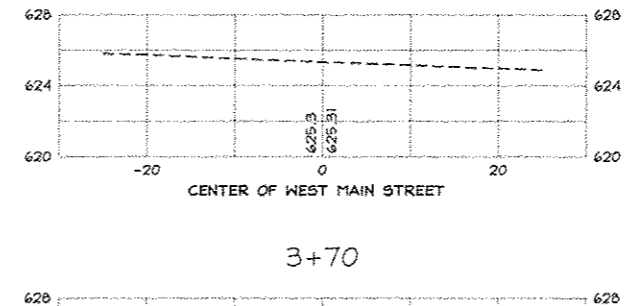
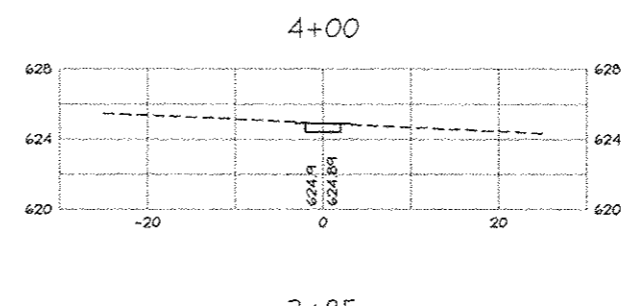
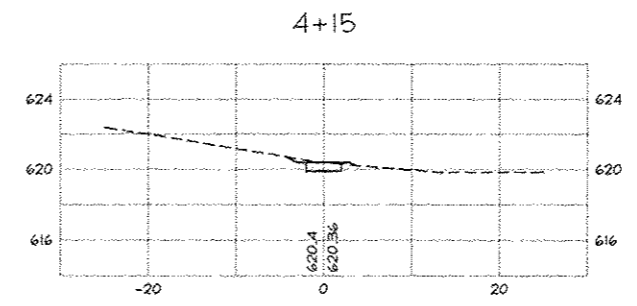

4x6' PRECAST BOX CULVERT WITH END SECTIONS USFL 419.5 DSFL 419.0

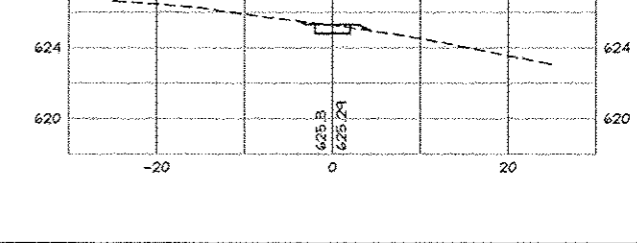
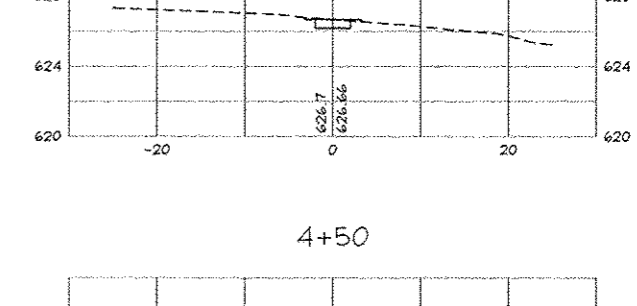
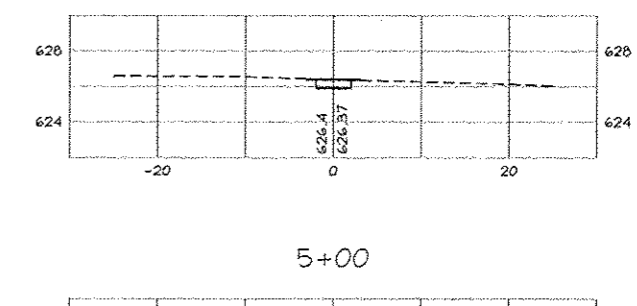
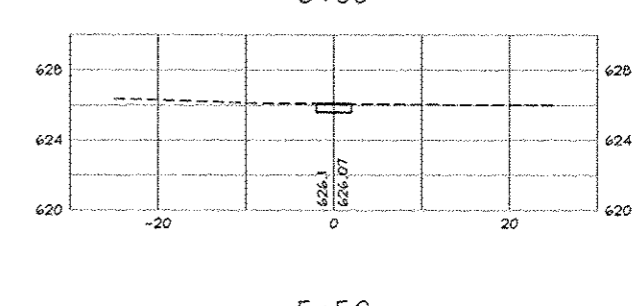
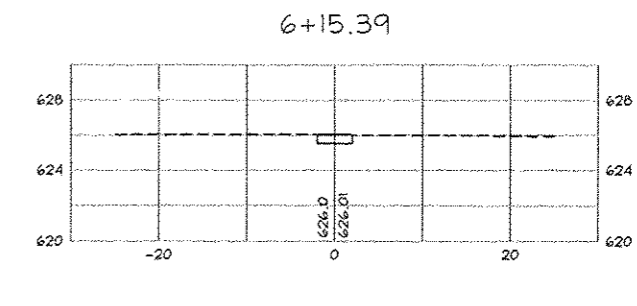

| NO. | DESCRIPTION | BY | DATE | NO. | DESCRIPTION | BY | DATE |
|-----|-------------|----|------|-----|-------------|----|------|
| | | | | | | | |
| | | | | | | | |
| | | | | | | | |

VILLAGE OF GOREVILLE
 JOHNSON COUNTY, IL
 SCHOOL SAFE WAY PLAN
 SIDEWALK SECTIONS

JOHN H. CRAWFORD & ASSOCIATES, P.C.
 CIVIL ENGINEERS, LAND SURVEYORS
 201 SOUTH DIVISION STREET, CARTERSVILLE, ILLINOIS 62918
 PHONE (618) 985-4370 FAX (618) 985-4892
 PROFESSIONAL DESIGN FIRM # 184-002885

| | |
|-----------|---------|
| SHEET NO. | |
| 15 | |
| ISSUE | DATE |
| A | 3/27/12 |

10/11/2011 10:34:53 AM
 C:\WORK\PROJECTS\SAFEWAY\SAFEWAY.DWG
 8/11/2011 10:34:53 AM