

Summary of Quantities							
#	Item	Section	Quantity			Unit	Rates/Remarks
			SITE A	SITE B	TOTAL		
1	Special Clearing	201	0.8	0.2	1	L.S.	
2	Earth Excavation	202	34,570	1,469	36,039	C.Y.	
3	Earth Excavation & Hauling	202	0	200	200	C.Y.	
4	Special Excavation	214	2,384	296	2,680	C.Y.	
5	Riprap Fill, C-4	216	0	308.1	308.1	TON	
6	CA Fill, CA-2	216	0	22.2	22.2	TON	
7	Filter Fabric	216	0	45	45	S.Y.	
8	Seeding - Slope Mixture	250	9.5	4.3	13.8	ACRE	
9	Seeding - Lawn Mixture	250	5.0	0	5.0	ACRE	
10	Nitrogen Fertilizer Nutrient	250	2,900	860	3,760	POUND	100 POUND/ACRE -- TWICE
11	Phosphorus Fertilizer Nutrient	250	2,175	645	2,820	POUND	150 POUND/ACRE
12	Potassium Fertilizer Nutrient	250	5,075	1,505	6,580	POUND	350 POUND/ACRE
13	Agricultural Ground Limestone	250	72.5	21.5	94.0	TON	5 TON/ACRE
14	Mulch, Method 2, Procedure 1	IDOT 251	14.5	4.3	18.8	ACRE	
15	Mowing	258	14.5	4.3	18.8	ACRE	
16	Stone Riprap, A-3	IDOT 281	110.7	0	110.7	TON	
17	Special Excelsior Blanket	286	2,693	124	2,817	S.Y.	8' WIDTH
18	Pipe Culvert, 21" Diameter Aluminized Steel Type 2 Corrugated	IDOT 542	40	0	40	FOOT	MATERIAL & DELIVERY ONLY - SEE NOTE SHEET 8
19	Dewatering Impoundments	614	0.5	0.5	1	L.S.	
20	Mine Opening Marker	666	0	1	1	EACH	
21	Mobilization (Max. 6% of Bid)	671	0.7	0.3	1	L.S.	

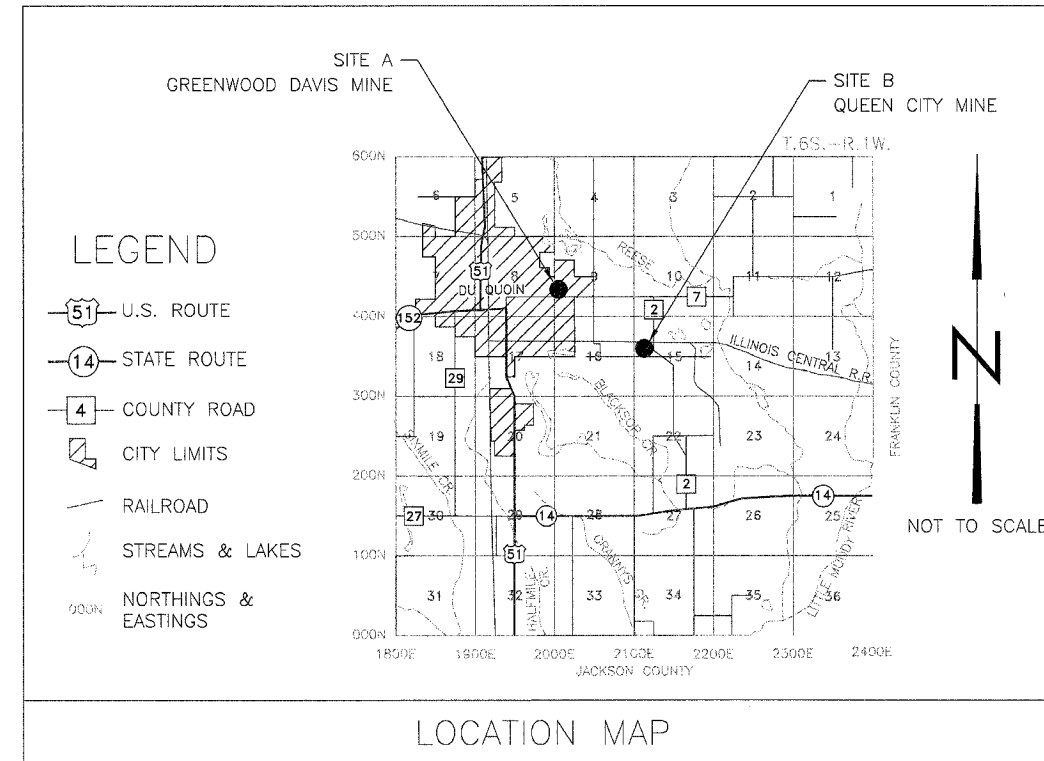

**GENERAL NOTES**

Unless otherwise noted on the plans, all disturbed areas within the construction limits will be amended with agricultural ground limestone, fertilizer nutrients, seeded and mulched at the required rates specified in the plans.

The contractor is responsible for visiting the site and familiarizing himself with the existing conditions and the proposed reclamation work prior to submitting a bid.

The contractor shall provide and pay for all field engineering services to execute the project as specified in the Field Engineering section of the Special Provisions.

The contractor is responsible for locating and protecting all existing utility lines pertaining to the work.

Unless noted on the plans, all onsite access roads may be used for construction and must be maintained during construction and restored to original or better condition at the completion of work by the contractor. Access roads to the site as designated on the plans are to be maintained to the satisfaction of the engineer.

The construction limits will be staked by the engineer prior to construction. The contractor is responsible for the repair and / or restitution at his own expense for all damages done to any area outside the construction limits.

Application rates specified in the plans are shown in the Summary of Quantities-Rates/Remarks column.

The locations from which Borrow Excavation comes must meet the review requirements of Article 107.22 and Section 204 of the Special Provisions prior to hauling to the project sites.

**CONSTRUCTION NOTES**

**BURIAL/REMOVAL OF MATERIAL**-Concrete and masonry debris designated for burial by the engineer shall be buried at least three feet below proposed final grade. Onsite organic debris and present trash shall be disposed of in an engineer approved offsite landfill in accordance with Section 201 of the Standard Specifications and Section 501 of the Special Provisions. This work shall be incidental to the Special Excavation.

**EROSION CONTROL**-The contractor shall schedule his operations and take such precautions that may be necessary to prevent or minimize erosion. Failure to comply with this requirement shall cause the contractor to be fully responsible for repairing any eroded areas and cleaning up areas or drainage structures that have become silted in or damaged.

**AGRICULTURAL GROUND LIMESTONE**-Immediately prior to seed bed preparation, fertilizer nutrients and agricultural ground limestone shall be uniformly spread at the rates specified in the plans.

**MULCHING**-Within 24 hours from the time seeding has been performed, the seeded area shall be given a covering of mulch at the rates specified in the plans. The mulch is to be anchored into the soil in accordance with the requirements for method 2, procedure 1 of Article 251.03 of the Standard Specifications. If Excelsior or Special Excelsior Blanket is to be used, the blanket shall be placed the same day that the areas are seeded.

Schedule of Seeding, Fertilizer Nutrients, Mulch and Mowing							
ITEM (Unit)	INITIAL APPLICATION SPRING 2008 JAN 1 - MARCH 15		SECOND APPLICATION FALL 2008 AUG 20 - SEPT 30		MOWING EXACT DATE TO BE SET BY ENGINEER		TOTAL QUANTITY
	SITE A	SITE B	SITE A	SITE B	SITE A	SITE B	
SEEDING (acres)	9.5 (SLOPE) 5.0 (LAWN)	4.3 (SLOPE)					18.8
NITROGEN FERTILIZER NUTRIENT (pounds)	1,450	430	1,450	430			3,760
PHOSPHOROUS FERTILIZER NUTRIENT (pounds)	2,175	645					2,820
POTASSIUM FERTILIZER NUTRIENT (pounds)	5,075	1,505					6,580
AGRICULTURAL GROUND LIMESTONE (tons)	72.5	21.5					94.0
MULCH, METHOD 2 PROCEDURE 2 (acres)	14.5	4.3					18.8
MOWING (acres)					14.5	4.3	18.8

Drawn By: \_\_\_\_\_ Date: 10/2/07  
Checked By: \_\_\_\_\_