

FAP R/L	SECTION	COUNTY	TOTAL SHEETS	SHEET NO.
338	114 BY-R-1	WILL	139	21
STA. 3218+00		TO STA. 3232+00		
FED. ROAD DIST. NO.	ILLINOIS	FAP 338 (ILL. RTE. 59)		

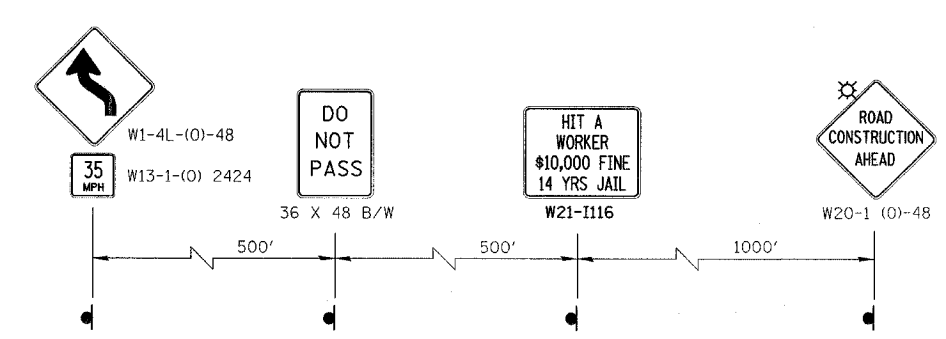

ADVANCE SIGNING FOR SOUTHBOUND ILLINOIS 59
(SPACING MAY VARY DUE TO FIELD CONDITIONS)

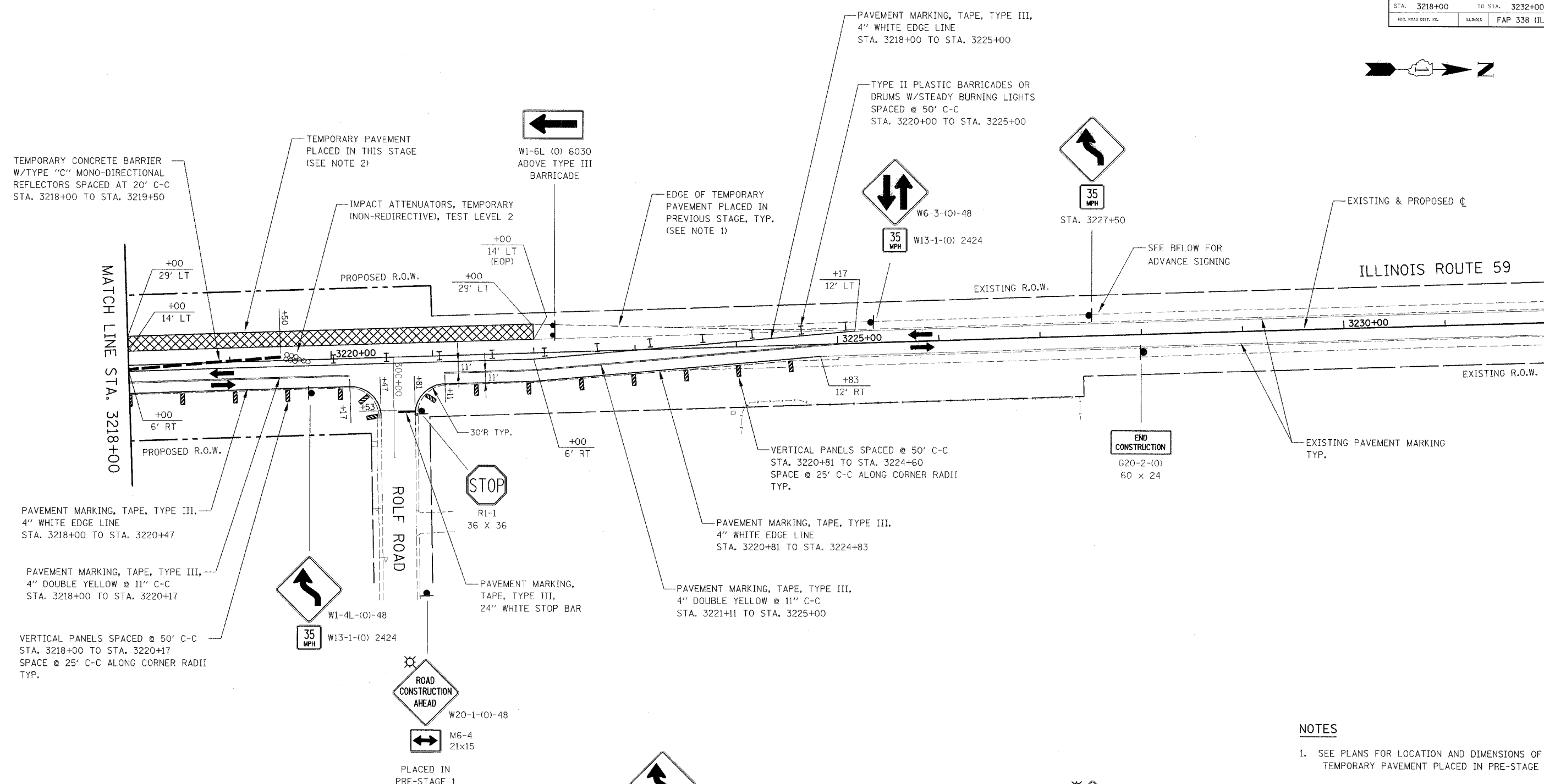
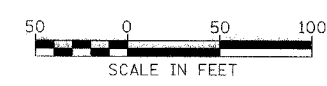

NOTES

1. SEE PLANS FOR LOCATION AND DIMENSIONS OF TEMPORARY PAVEMENT PLACED IN PRE-STAGE 1.
2. TEMPORARY PAVEMENT SHALL BE CONSTRUCTED IN ACCORDANCE WITH DETAIL ON SHEET NO. 102. THIS WORK SHALL BE PAID FOR AT THE CONTRACT UNIT PRICE FOR TEMPORARY PAVEMENT.
3. SEE CROSS SECTIONS FOR GRADING DETAILS.

ILLINOIS DEPARTMENT OF TRANSPORTATION
DISTRICT NO. 1 SCHAUMBURG

**STAGING PLANS
ILLINOIS ROUTE 59
STAGE 1**

SCALE AS SHOWN
DATE AUGUST 17, 2007

DRAWN BY REW
CHECKED BY JCM