

FAP RTE.	SECTION	COUNTY	TOTAL SHEETS	SHEET NO.
338	114 BY-R-1	WILL	139	45
STA.	TO STA.			
3190+00	3204+00			
FED. ROAD DIST. NO.	ILLINOIS	FAP 338 (IL RTE. 59)		

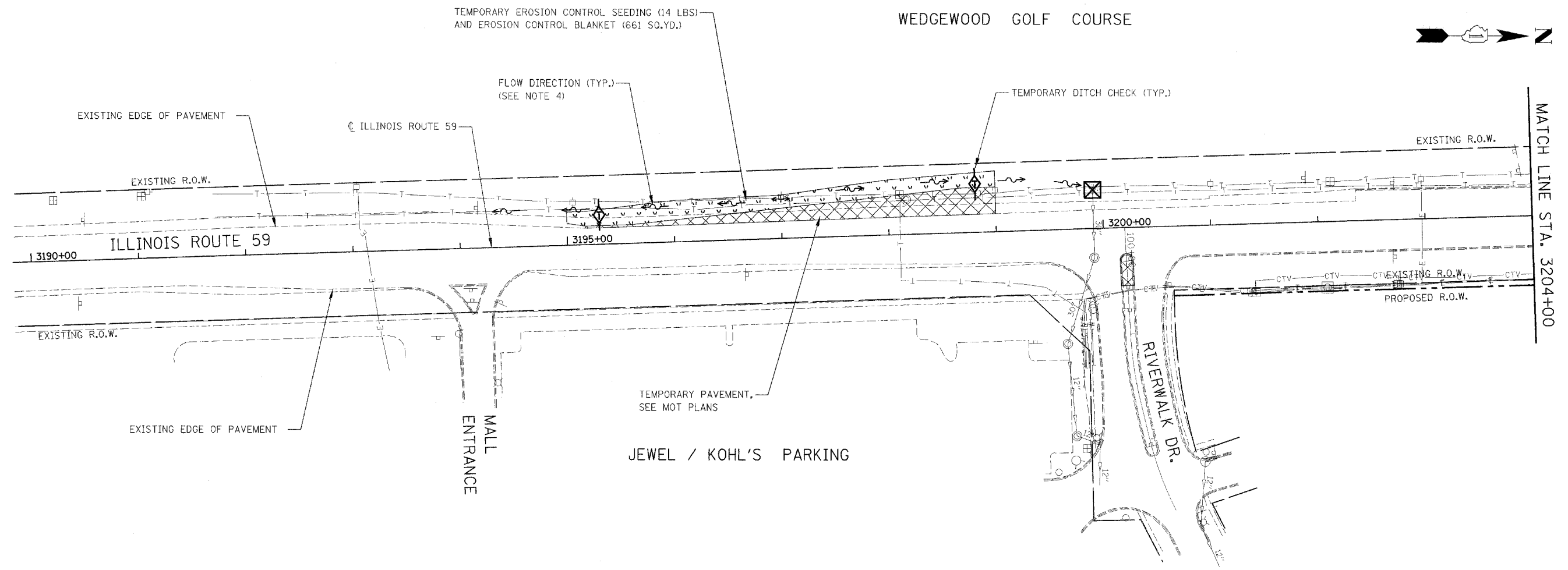

EROSION CONTROL LEGEND

	TEMPORARY EROSION CONTROL SEEDING AND EROSION CONTROL BLANKET		INLET AND PIPE PROTECTION OR INLET FILTER
	PERMANENT SEEDING (SEE NOTE 3)		TEMPORARY DITCH CHECK
	TEMPORARY PAVEMENT		FLOW DIRECTION (SEE NOTE 4)
	RIPRAP		PERMANENT DRAINAGE STRUCTURE NUMBER (SEE NOTE 5)
	SEDIMENT CONTROL SILT FENCE (SEE NOTE 2)		PROPOSED STORM SEWER (SEE NOTE 5)
			TEMPORARY PIPE CULVERT

GENERAL EROSION CONTROL NOTES:

TREE TRUNK PROTECTION, TREE ROOT PRUNING, AND TREE PRUNING WILL BE REQUIRED FOR THIS PROJECT. A REPRESENTATIVE FROM IDOT'S ROADSIDE DEVELOPMENT UNIT WILL DETERMINE LOCATIONS ON SITE AT THE START OF CONSTRUCTION. PAY ITEMS HAVE BEEN INCLUDED IN THE SUMMARY OF QUANTITIES.

THE CONTRACTOR WILL BE REQUIRED TO SUBMIT CERTIFICATION STATEMENT (NPDES ATTACHMENT 6). FULL COMPLIANCE WITH ALL TERMS OF THE NPDES PERMIT MUST BE STRICTLY ADHERED TO.

INLET FILTERS ARE TO BE PROVIDED AND MAINTAINED FOR ALL EXISTING AND PROPOSED DRAINAGE STRUCTURES WITHIN THE PROJECT LIMITS AND ALL STRUCTURES NOTED FOR INLET FILTER AS DIRECTED BY THE ENGINEER.

NOTES

1. THE CONSTRUCTION LIMITS WILL BE STAKED BY THE ENGINEER PRIOR TO COMMENCING CONSTRUCTION. THE CONSTRUCTION LIMITS MAY BE ADJUSTED BY THE ENGINEER TO PRESERVE TREES AND NO ADDITIONAL COMPENSATION WILL BE PAID TO THE CONTRACTOR FOR CHANGED CONSTRUCTION LIMITS.
2. SEDIMENT CONTROL SILT FENCE SHALL BE ERECTED ADJACENT TO R.O.W., EASEMENT, AND CONSTRUCTION LIMITS AND AS DIRECTED BY THE ENGINEER.
3. SEE LANDSCAPING PLANS FOR SEEDING INFORMATION.
4. SEE PRE-STAGE 1 CROSS SECTIONS FOR GRADING INFORMATION.
5. SEE PROPOSED DRAINAGE PLANS FOR STORM SEWER INFORMATION.



ILLINOIS DEPARTMENT OF TRANSPORTATION
 DISTRICT NO. 1 SCHAUMBURG
 EROSION CONTROL PLAN
 PRE-STAGE 1
 ILLINOIS ROUTE 59

SCALE AS SHOWN
 DATE AUGUST 17, 2007
 DRAWN BY RTA
 CHECKED BY JCM