

FAP DIST.	SECTION	COUNTY	TOTAL SHEETS	SHEET NO.
338	114 BY-R-1	WILL	139	49
STA. 3204+00		TO STA. 3218+00		
FEL. ROAD DIST. NO.		ILLINOIS	FAP 338 (IL RTE. 59)	

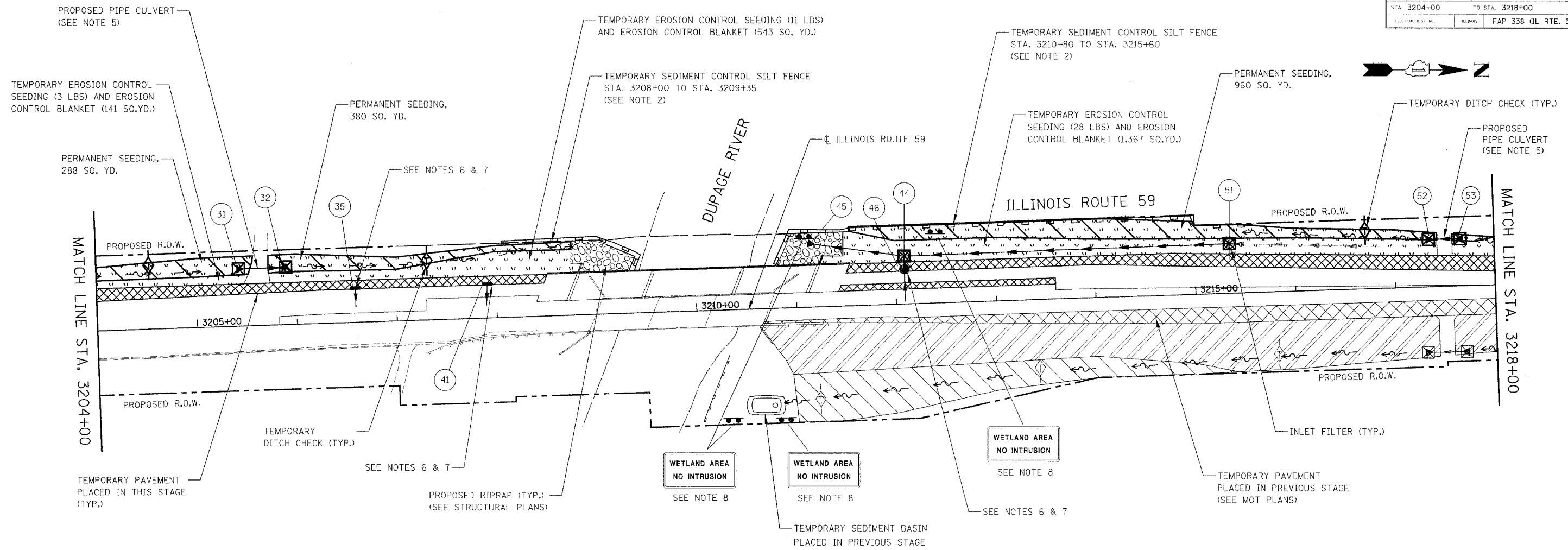

EROSION CONTROL LEGEND

	TEMPORARY EROSION CONTROL SEEDING AND EROSION CONTROL BLANKET		INLET AND PIPE PROTECTION OR INLET FILTER INSTALLED IN PREVIOUS STAGE
	TEMPORARY EROSION CONTROL SEEDING AND EROSION CONTROL BLANKET INSTALLED IN PREVIOUS STAGE		TEMPORARY DITCH CHECK
	PERMANENT SEEDING (SEE NOTE 3)		TEMPORARY DITCH CHECK INSTALLED IN PREVIOUS STAGE
	PERMANENT SEEDING INSTALLED IN PREVIOUS STAGE		FLOW DIRECTION (SEE NOTE 4)
	TEMPORARY PAVEMENT PLACED IN THIS STAGE		PERMANENT DRAINAGE STRUCTURE NUMBER (SEE NOTE 5)
	RIPRAP		PROPOSED STORM SEWER (SEE NOTE 5)
	SEDIMENT CONTROL SILT FENCE (SEE NOTE 2)		PROPOSED STORM SEWER INSTALLED IN PREVIOUS STAGE
	SEDIMENT CONTROL SILT FENCE INSTALLED IN PREVIOUS STAGE		TEMPORARY PIPE CULVERT
	INLET AND PIPE PROTECTION OR INLET FILTER		TEMPORARY PIPE CULVERT INSTALLED IN PREVIOUS STAGE

NOTES

1. THE CONSTRUCTION LIMITS WILL BE STAKED BY THE ENGINEER PRIOR TO COMMENCING CONSTRUCTION. THE CONSTRUCTION LIMITS MAY BE ADJUSTED BY THE ENGINEER TO PRESERVE TREES AND NO ADDITIONAL COMPENSATION WILL BE PAID TO THE CONTRACTOR FOR CHANGED CONSTRUCTION LIMITS.
2. SEDIMENT CONTROL SILT FENCE SHALL BE ERECTED ADJACENT TO R.O.W., EASEMENT, AND CONSTRUCTION LIMITS AND AS DIRECTED BY THE ENGINEER.
3. SEE LANDSCAPING PLANS FOR SEEDING INFORMATION.
4. SEE STAGES 1 & 2 CROSS SECTIONS FOR GRADING INFORMATION.
5. SEE PROPOSED DRAINAGE PLANS FOR STORM SEWER INFORMATION.
6. PROPOSED STRUCTURE SHALL BE COVERED WITH STEEL PLATE OF A THICKNESS APPROVED BY THE ENGINEER AND TEMPORARILY BURIED. PAYMENT FOR THE INSTALLATION AND REMOVAL OF THE STEEL PLATE INCLUDING ANY REQUIRED EXCAVATION SHALL BE CONSIDERED INCLUDED IN THE COST OF THE PROPOSED STRUCTURE.
7. ANY REQUIRED ADJUSTMENT AND/OR RECONSTRUCTION OF THE PROPOSED STRUCTURE TO FINAL RIM ELEVATION SHALL NOT BE PAID FOR SEPERATELY. THE COST FOR THIS WORK SHALL BE INCLUDED IN THE COST OF THE PROPOSED STRUCTURE.
8. CONTRACTOR SHALL ERECT SIGNS AS DIRECTED BY THE ENGINEER. COST OF ERECTING SIGNS SHALL BE CONSIDERED INCIDENTAL TO SEDIMENT CONTROL SILT FENCE. THE SIGNS WILL BE SUPPLIED BY IDOT. THE CONTRACTOR SHALL CONTACT RICK WANNER AT (847) 705-4172 WHEN SIGNS ARE NEEDED. THE SIGN SHALL REMAIN IN PLACE WHILE WORK IS BEING DONE IN THIS AREA, AND SHALL BE TAKEN DOWN ONLY WHEN DIRECTED BY THE ENGINEER.



ILLINOIS DEPARTMENT OF TRANSPORTATION
 DISTRICT NO. 1 SCHAUMBURG
 EROSION CONTROL PLAN
 STAGE 1 & 2
 ILLINOIS ROUTE 59

SCALE AS SHOWN
 DATE AUGUST 17, 2007

DRAWN BY RTA
 CHECKED BY JCM