

DATE	SECTION	COUNTY	TOTAL SHEETS	SHEET NO.
338	114 BY-R-1	WILL	139	62
STA.		TO STA.		
FED. ROAD DIST. NO.		MILEMIS		FED. AID PROJECT

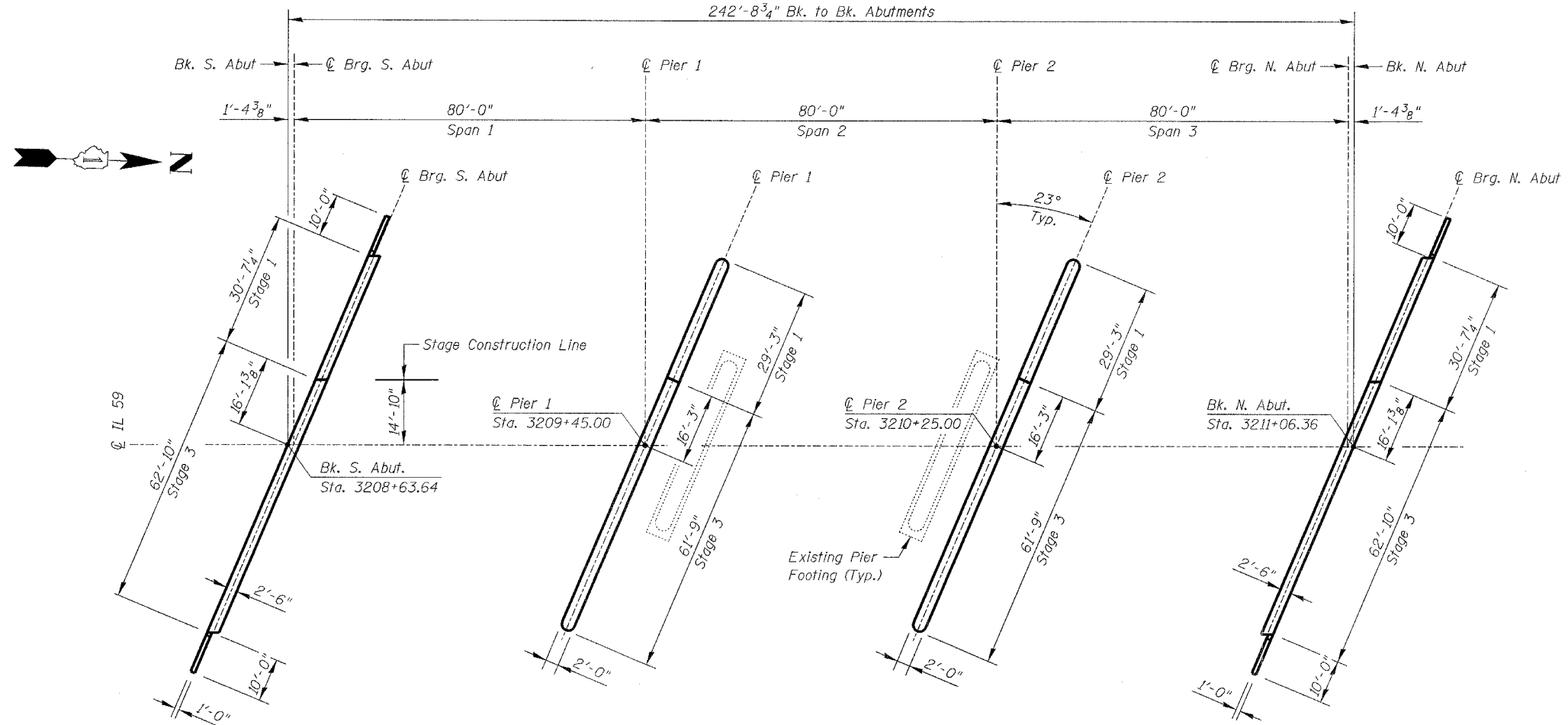

FOOTING LAYOUT

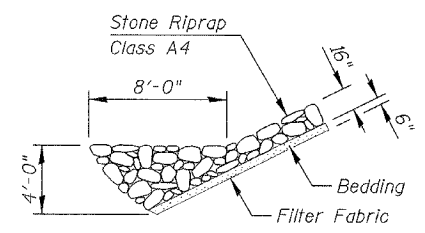

STONE RIPRAP ANCHOR DETAIL

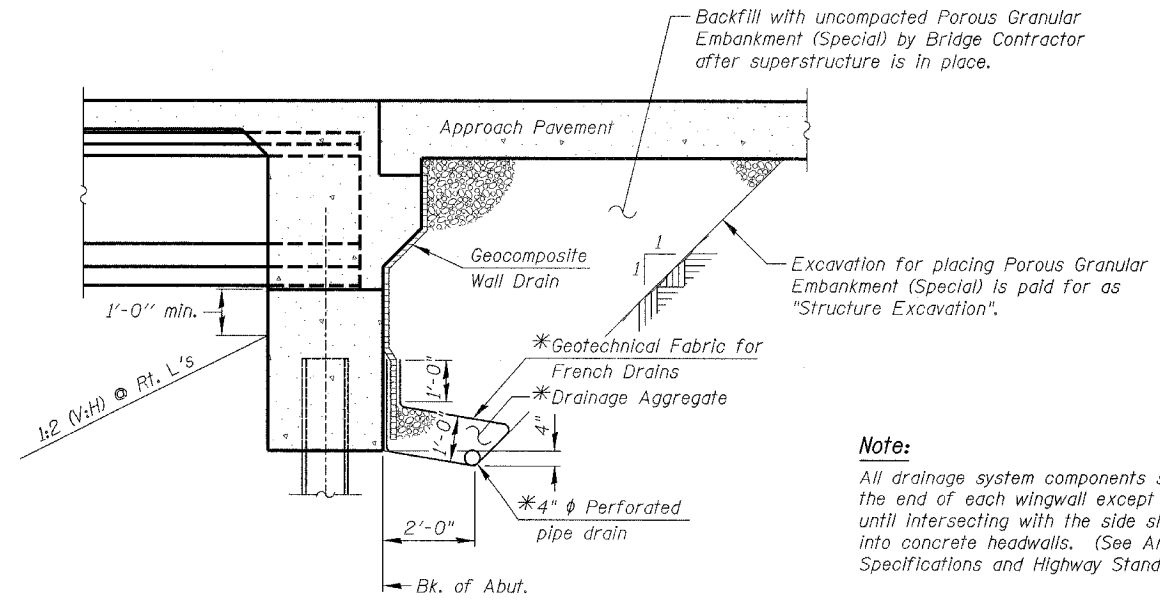

SECTION THRU INTEGRAL ABUTMENT
(Horiz. dim. @ Rt. L's)

*Included in the cost of "Pipe Underdrains for Structures 4".

Note:
All drainage system components shall extend to 2'-0" from the end of each wingwall except an outlet pipe shall extend until intersecting with the side slopes. The pipes shall drain into concrete headwalls. (See Article 601.05 of the Standard Specifications and Highway Standard 601101).

BILL OF MATERIAL

Item	Unit	Quantity
Porous Granular Embankment (Special)	Cu. Yd.	410
Stone Riprap, Class A4	Sq. Yd.	2200
Filter Fabric	Sq. Yd.	2200
Geocomposite Wall Drain	Sq. Yd.	176
Pipe Underdrains for Structures 4"	Foot	260

Notes:
Pipe Underdrain Outflow location and elevation to be determined by the Engineer in the field.

DWG. S-03 of 34

REVISIONS		ILLINOIS DEPARTMENT OF TRANSPORTATION FOOTING LAYOUT ILLINOIS ROUTE 59 OVER DUPAGE RIVER FAP ROUTE 338 SECTION 114 BY-R-1 WILL COUNTY STATION 3209+85.00 STRUCTURE NUMBER 099-0339
NAME	DATE	
		SCALE: NONE DATE: 08/17/07
		DESIGNED BY: TB CHECKED BY: WPM
		DRAWN BY: TL CHECKED BY: TB

FILE: L:\16632.0\Acad\Structures\Roadway Structures\Bridges\66320\50339-FPO.dgn