

FAP NO.	SECTION	COUNTY	TOTAL SHEETS	SHEET NO.
338	114 BY-R-1	WILL	139	94
STA.	TO STA.			
FED. ROAD DIST. NO.	ILLINOIS	FAP 338 (IL RTE. 59)		

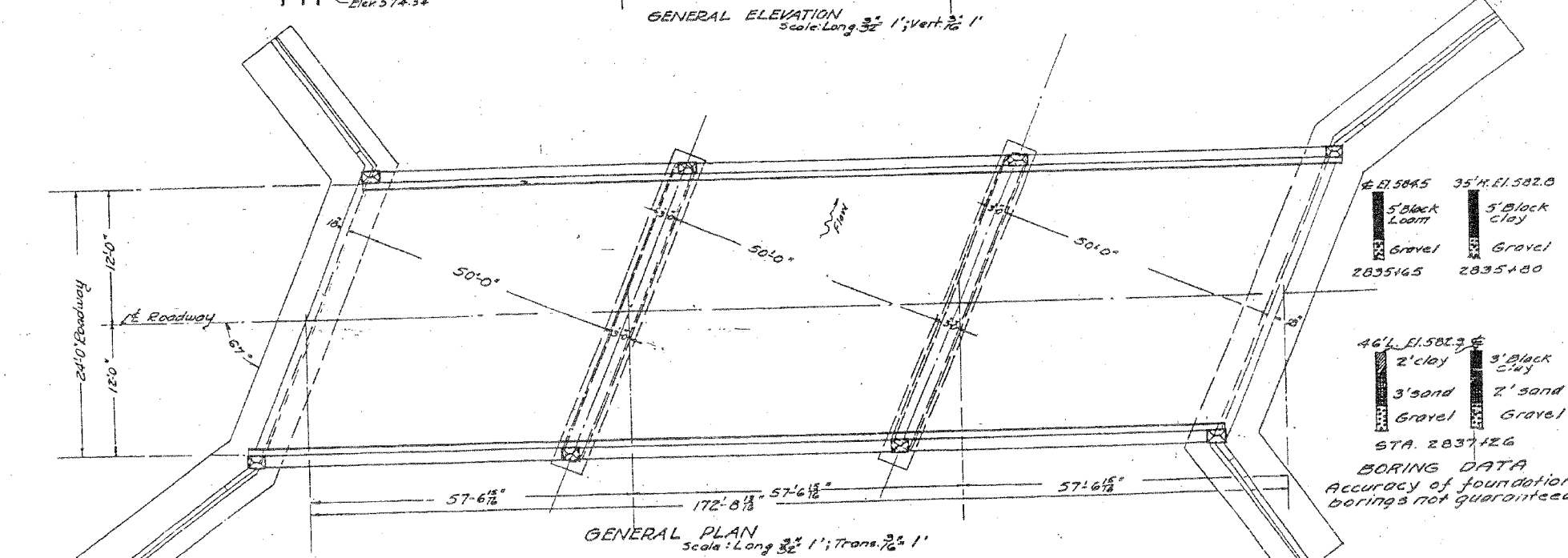
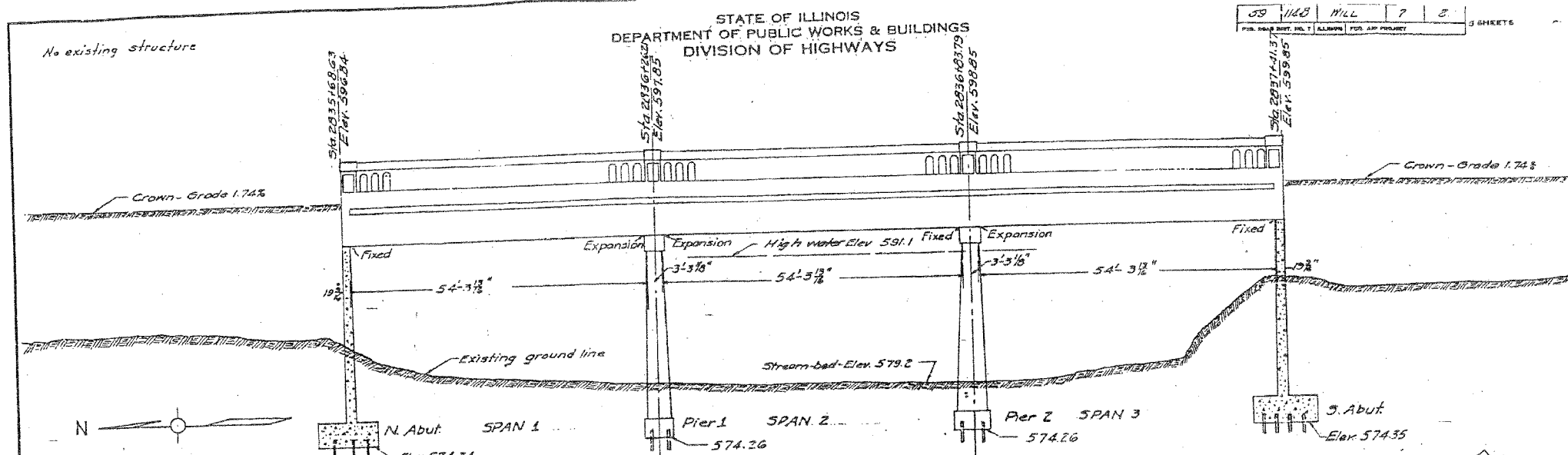

4' El. 584.5 35' H. El. 582.0
 5' Black Loam 5' Black clay
 Gravel Gravel
 2835+65 2835+80

 46' El. 582.9
 2' clay 3' Black clay
 3' sand 2' sand
 Gravel Gravel
 STA. 2837+26
 BORING DATA
 Accuracy of foundation borings not guaranteed.

TOTAL BILL OF MATERIAL

Items	Superstructure	Abutments	Piers	Totals
Reinforcing steel-lbs.	86,720	20,000		106,720
Class X Concrete Cu Yds.	293.8	285.9		579.7
Class A Concrete Cu Yds.			163.0	163.0
Structural steel-lbs.	1300			1300
Untreated Piles-Lin Ft.		3280	880	4160
4" P.C.C. Pav't Sq. Yds.	435			435
Rockers & Plates	5270			5270
Name Plate	1			1

* 1560 ft 10 Ton, 280 ft 12 Ton, 300 ft 15 Ton, 1340 ft 20 Ton

COMPUTED - Chan. E. M...
 CHECKED - M. J. M...
 DRAWN - C. E. M...
 CHECKED - M. J. M...
 SPECIAL ASSEMBLED -
 CHECKED -
 EXAMINED - 11-21-1932
 PASSED BY -
 APPROVED -
 CHIEF HIGHWAY ENGINEER

GENERAL ELEVATION
 S.B.I. ROUTE 59-SEC. 14B
 WILL COUNTY
 STA. 2836+55

FOR INFORMATION ONLY

ILLINOIS DEPARTMENT OF TRANSPORTATION
 DISTRICT NO. 1 SCHAUMBURG
1932 EXISTING STRUCTURE PLANS
 FAP ROUTE 338 SECTION 114 BY-R-1
 WILL COUNTY
 SN 099-0143 (E)
 SCALE _____ DRAWN BY _____
 DATE AUGUST 17, 2007 CHECKED BY _____