

FAP ROUTE	SECTION	COUNTY	TOTAL SHEETS	SHEET NO.
338	114 BY-R-1	WILL	139	97
STA.		TO STA.		
FED. ROAD DIST. NO.		ILLINOIS		
FAP 338 (IL RTE. 59)				

1. At 211' corner of base portion of existing roadway approximately 100' left Sta. 2836+55.00. Structure: R.C. Deck Girder, 3 Spans @ 57'-6" R.C. Abutments & Piers, No Piles, Handrail & other concrete to be furnished as shown on plans by Bridge Contractor.

STATE OF ILLINOIS
DEPARTMENT OF PUBLIC WORKS & BUILDINGS
DIVISION OF HIGHWAYS

PROJECT NO.	SECTION	COUNTY	TOTAL SHEETS	SHEET NO.
60C19	114BY	WILL	139	97
FAP ROAD DIST. NO.		ILLINOIS		
FAP 338 (IL RTE. 59)				

GENERAL NOTES

Class "C" Concrete shall be used throughout except in piers.
Class "A" concrete shall be used in piers.
The concrete floor slab shall be finished in accordance with applicable provisions of Section 5119 of the Standard Specifications. For Expansion Bolts see Special Provisions.
All piles shall be steel H Piles 8" x 8".
The contractor shall drive one test pile in each Abutment in permanent locations as directed by the Engineer before ordering remainder of piles.
Boring Data are shown on the drawings only as a guide to bidders in estimating soil conditions which may be encountered in the work.
All rollers, bearing plates, lead plates and anchor bolts shall be fabricated and set in accordance with Article 30.5 of the Std. Specs. and are included for payment as structural steel.
Except as otherwise provided, all structural steel shall receive one shop coat of red lead paint & two field coats of aluminum paint. See Art. 36.1 to 36.5 of the Std. Specs.
All paint shall be furnished and applied by the Contractor. The following surfaces of the bridge shall be waterproofed: Back of Abutment - Extensions & Wing Walls.
Coarse aggregate to be used in parapet handrail and end post must be absolutely free of chert, flint, limonite, lignite and soft sandstone.
Steel H Piles shall be driven to refusal.
For grouting see Special Provisions.
For bridge deck sealant see Special Provisions.
It shall be the responsibility of the Contractor to verify all dimensions and conditions existing in the field prior to construction and ordering of materials.

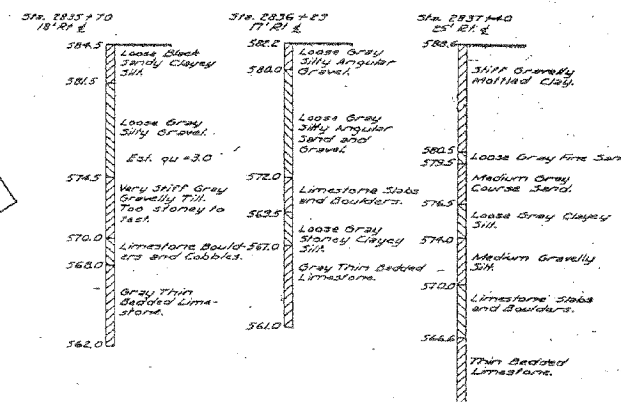
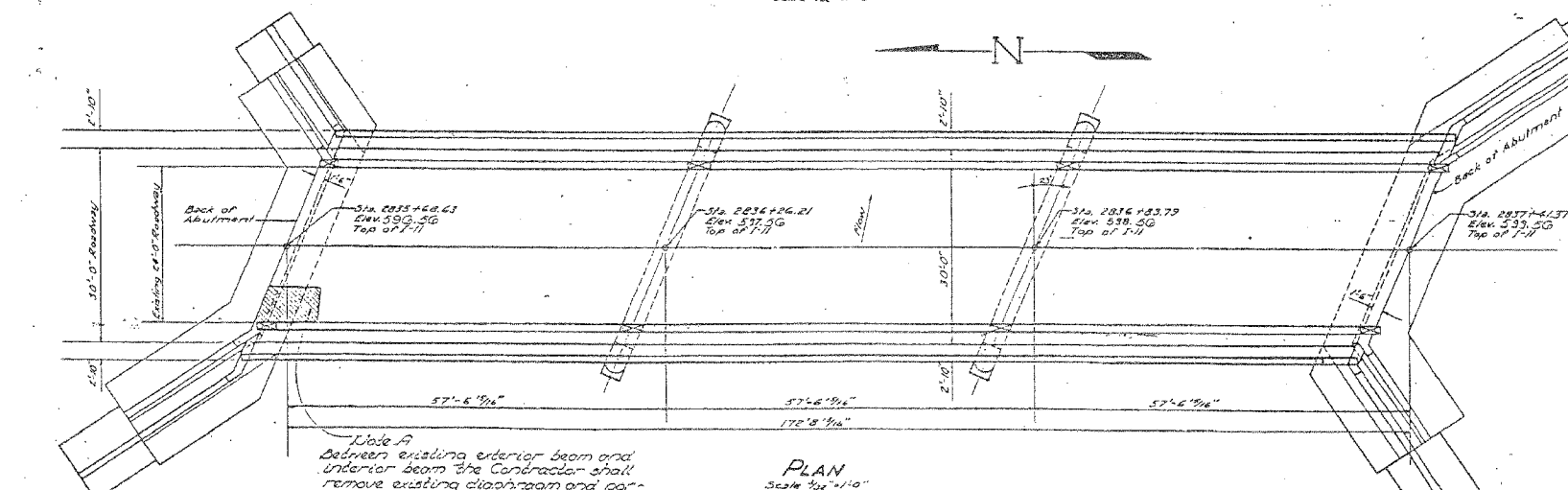
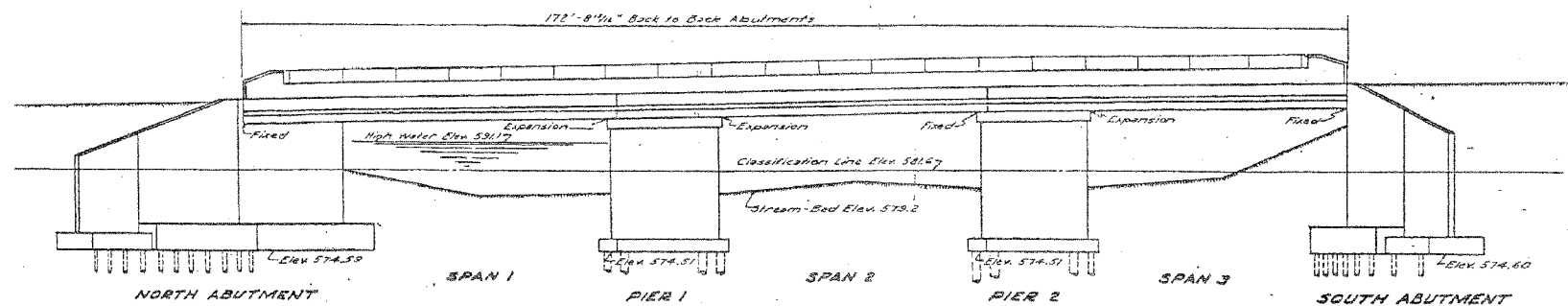

BORING DATA

TOTAL BILL OF MATERIAL

Item	Units	Super	Sub	Total
Cement for Groutings	Sacks	0	2	2
Ext. Con. Surface Course F-11	Sq. Yds.	65	0	65
Bridge Deck Sealant	Sq. Yds.	575	0	575
Class "A" Concrete	Cu. Yds.	0	64.4	64.4
Class "C" Concrete	Cu. Yds.	184.0	255.0	439.0
Reinforcement Bars	Lbs.	45690	10,510	56,200
Concrete Removal	Cu. Yds.	110.9	10.5	121.4
Expansion Bolts 3/8"	Each	237	237	474
Steel Pins A307	Lbs.	780	780	1,560
Test Run Steel A307	Each	1	1	2
Structural Steel	Lbs.	3372	3372	6,744
Aluminum Handrail	Lin. Ft.	319.0	0	319.0
Class A Excavation for Structure	Cu. Yds.	140	140	280
Class B Excavation for Structure	Cu. Yds.	400	400	800
Expansion Bolts 3/8"	Each	100	100	200
Wedge Piles	Each	One	One	Two
Asphalt Surface Removal	Sq. Yds.	635	635	1,270
Preformed Joint Sealant	Lin. Ft.	??	??	??

NOTE: * ESTIMATE 2 SACKS OF CEMENT FOR REPAIRS AT ABUTMENTS & 0.2 CU. YDS. OF CONCRETE REMOVAL.

Station 2836+55
BLMP 193
STATE OF ILLINOIS
S.E. PLAN 29 SEC. 114 BY
FA PROJECT F-176(18)
LOADING H-20

NAME PLATE
See Sta. 2836+55

DESIGN STRESSES
F_c = 20,000 p.s.i. (Reinforcement)
F_s = 1,400 p.s.i. (Superstructure)
F_s = 800 p.s.i. (Substructure)
n = 10

WATERWAY INFORMATION
Drainage Area: 141,400 Acres
Channel: Level Sand, Clay, Cultivated
Opening Required: 60' x 7' (Total) 1634' of
Present Bridge Opening: 1530' of
Proposed Bridge Opening: 1520'

DESIGNED: *James R. ...*
CHECKED: *M. A. ...*
DRAWN: *J. ...*
HECKED: *M. A. ...*
EXAMINED: *W. E. ...*
PASSED: *...*
APPROVED: *R. B. ...*

FOR INFORMATION ONLY

ILLINOIS DEPARTMENT OF TRANSPORTATION
DISTRICT NO. 1 SCHAUMBURG
1964 EXISTING STRUCTURE PLANS
FAP ROUTE 338 SECTION 114 BY-R-1
WILL COUNTY
SN 099-0143 (E)
SCALE: _____ DRAWN BY: _____
DATE: AUGUST 17, 2007 CHECKED BY: _____