

| | | | | |
|---------------------|-----------|----------|------------------|-----------|
| F.A.U. RTE. | SECTION | COUNTY | TOTAL SHEETS | SHEET NO. |
| 2678 | N-7-5-I-1 | COOK | 18 | 7 |
| STA. | | TO STA. | | |
| FED. ROAD DIST. NO. | | ILLINOIS | FED. AID PROJECT | |

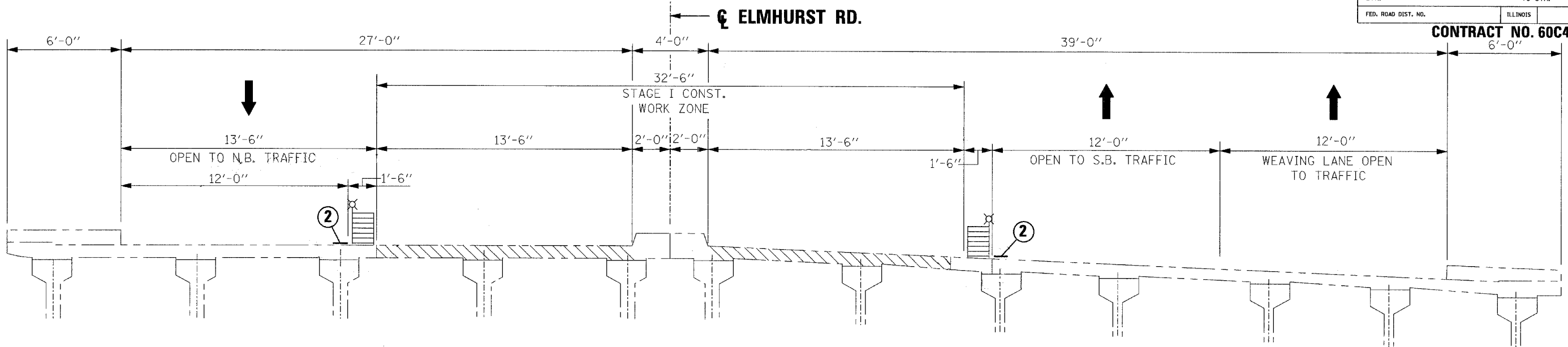

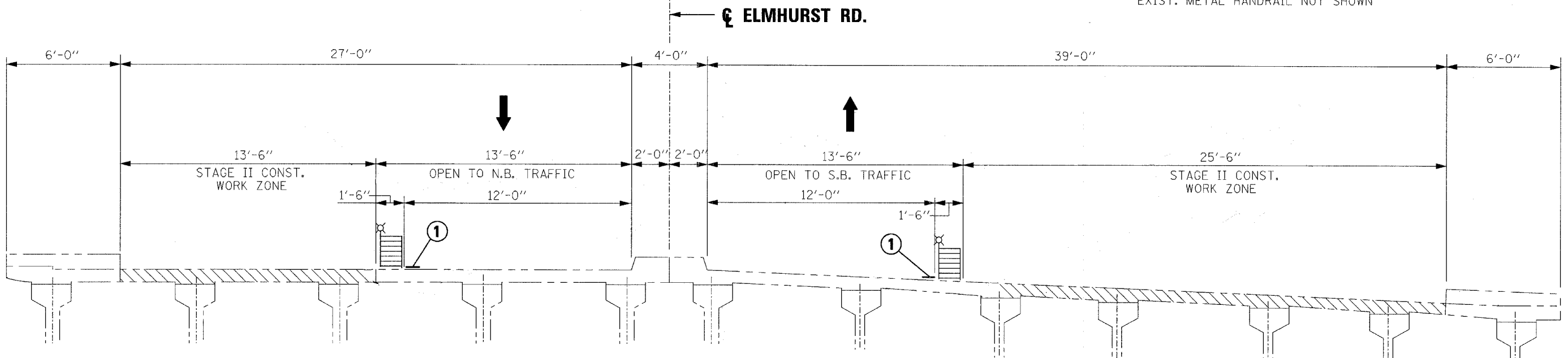

**TYPICAL CROSS SECTION - STAGE I CONST.
(LOOKING SOUTH)**

NOTE:
EXIST. METAL HANDRAIL NOT SHOWN



**TYPICAL CROSS SECTION - STAGE II CONST.
(LOOKING SOUTH)**

LEGEND:

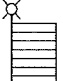
-  **WORK ZONE**
-  **RT. EDGE LINE-SOLID WHITE**
-  **LT. EDGE LINE-SOLID YELLOW**
-  **NON-METALLIC DRUMS WITH MONO-DIRECTIONAL STEADY BURNING LIGHTS @ 50 FT. CTS.**

| REVISIONS | |
|-----------|------|
| NAME | DATE |
| | |
| | |
| | |
| | |
| | |

ILLINOIS DEPARTMENT OF TRANSPORTATION

CONSTRUCTION STAGING
TYPICAL SECTIONS
F.A.U. RTE. 2678 / ELMHURST ROAD

SCALE: NONE
DATE: JULY 25, 2007

DRAWN BY: F.M.
CHECKED BY: B.N.S.

CHRISTIAN-ROGE & ASSOC., INC.
CHICAGO ILLINOIS