

F.A.P. RTE.	SECTION	COUNTY	TOTAL SHEETS	SHEET NO.
370	0103 I-2	COOK	27	8
STA.		TO STA.		
FED. ROAD DIST. NO.		ILLINOIS FED. AID PROJECT		

\*REF-p001

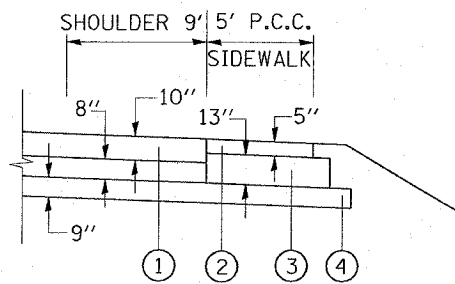
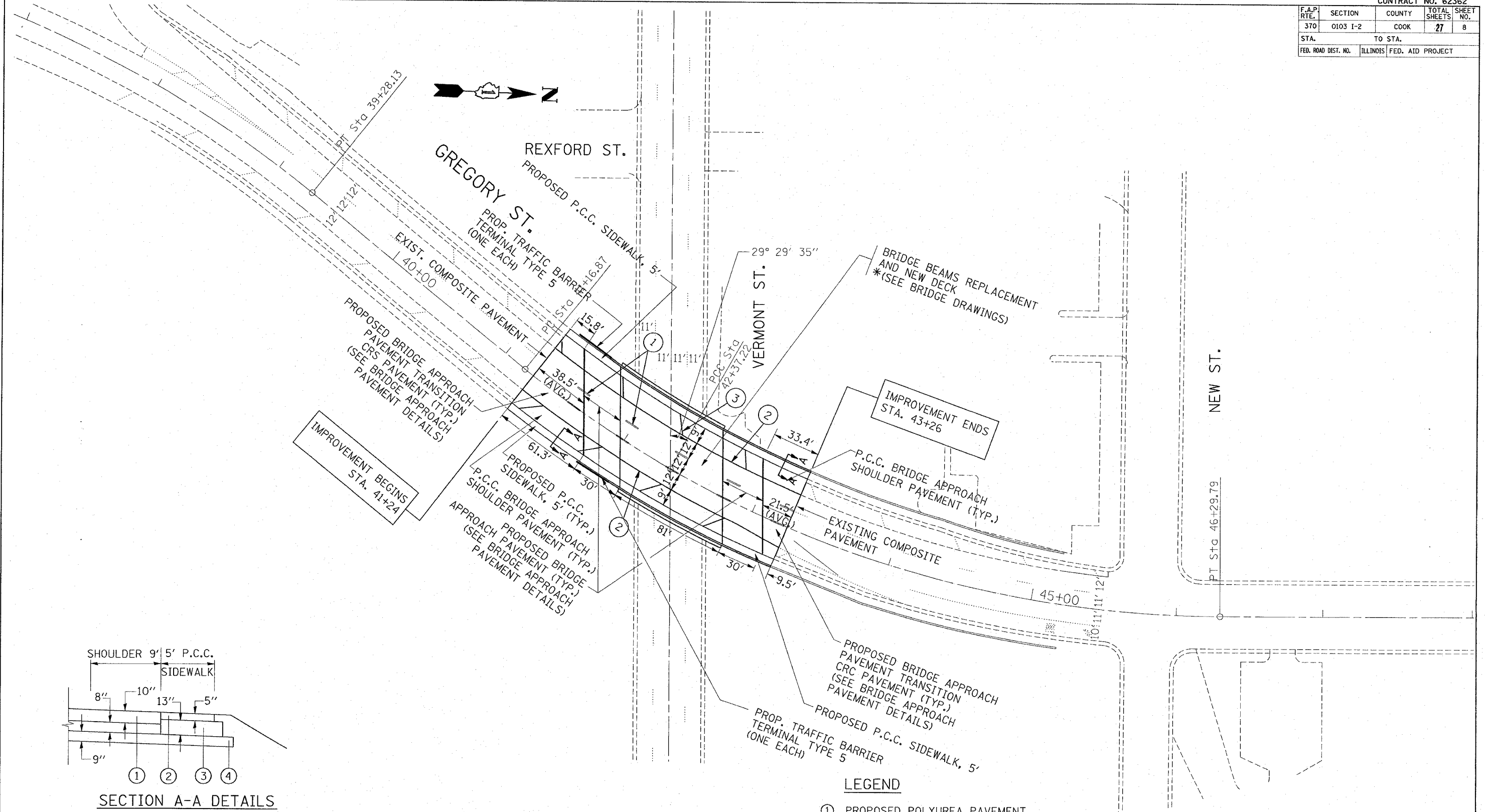

SECTION A-A DETAILS

- ① PROPOSED SHOULDER (SEE APPROACH PAVEMENT DETAILS)
- ② PROPOSED P.C.C. SIDEWALK, 5"
- ③ PROPOSED SUB-BASE GRANULAR MATERIAL (CA<sub>6</sub>), 8" AND VARIES TO 13"
- ④ PROPOSED POURUS GRANULAR EMBANKMENT, (PGE) 9"

- LEGEND**
- ① PROPOSED POLYUREA PAVEMENT MARKING TYPE 1 - LINE 4" LANE LINE (10' DASH, 30' SKIP)
  - ② PROPOSED POLYUREA PAVEMENT MARKING TYPE 1 SOLID WHITE 4" EDGE LINE
  - ③ PROPOSED POLYUREA PAVEMENT MARKING TYPE 1 - LINE 12" WHITE DIAGONAL

REVISIONS	
NAME	DATE

ILLINOIS DEPARTMENT OF TRANSPORTATION  
 WESTERN AVE/ GREGORY ST.  
 OVER VERMONT AVE.  
 PROPOSED ROADWAY AND  
 PAVEMENT MARKING PLAN

SCALE: VERT. 1"=30'  
 HORIZ. DATE 8/29/2007  
 DRAWN BY  
 CHECKED BY

PLOT DATE = 8/29/2007  
 PLOT SCALE = 30.0000 IN.  
 USER NAME = dhrakosgn