

F.A.P. RTE.	SECTION	COUNTY	TOTAL SHEETS	SHEET NO.
348	2005-007 TS	COOK	26	19
STA.		TO STA.		
FED. ROAD DIST. NO.		ILLINOIS FED. AID PROJECT		
CONTRACT NO. 62918				

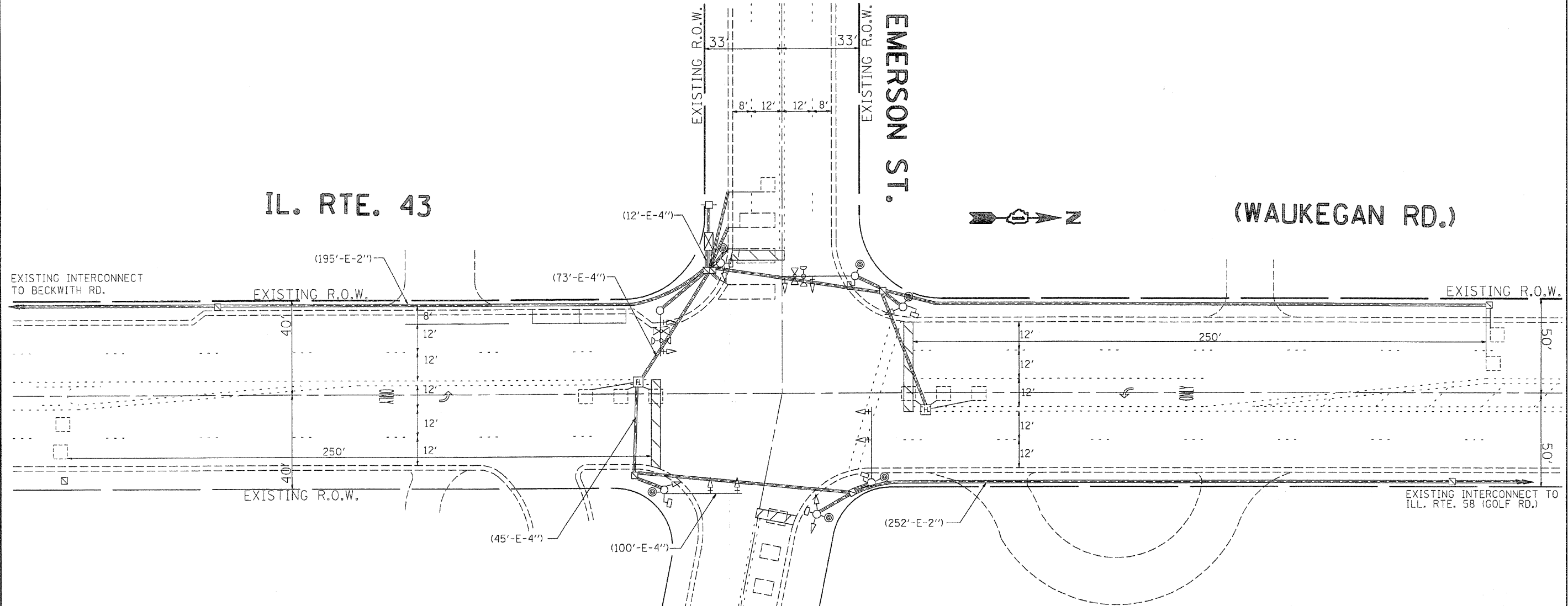

TRAFFIC SIGNAL LEGEND

	PROPOSED	EXISTING		PROPOSED	EXISTING
CONTROLLER CABINET			EMERGENCY VEHICLE SYSTEM DETECTOR		
RAILROAD CONTROL CABINET			CONFIRMATION BEACON		
SERVICE INSTALLATION, (P) POLE OR (G) GROUND MOUNT			JUNCTION BOX		
TELEPHONE CONNECTION			HANDHOLE		
SIGNAL HEAD			HEAVY DUTY HANDHOLE		
SIGNAL HEAD WITH BACKPLATE			DOUBLE HANDHOLE		
SIGNAL HEAD OPTICALLY PROGRAMMED			G.S. CONDUIT IN TRENCH OR PUSHED		
SIGNAL HEAD PEDESTRIAN			COMMON TRENCH		
SIGNAL POST			UNIT DUCT		
WOOD POLE			PEDESTRIAN PUSHBUTTON DETECTOR		
STEEL MAST ARM ASSEMBLY AND POLE			DETECTOR LOOP, TYPE I		
ALUMINUM MAST ARM ASSEMBLY AND POLE			PREFORMED DETECTOR LOOP		
STEEL COMBINATION MAST ARM ASSEMBLY AND POLE WITH LUMINAIRE					

REVISIONS	
NAME	DATE

ILLINOIS DEPARTMENT OF TRANSPORTATION
**TRAFFIC SIGNAL
MODERNIZATION PLAN**
**IL. RTE. 43 (WAUKEGAN RD.)
AT EMERSON ST.**

SCALE: VERT. 1"=20'
HORIZ. 1"=40'
DATE 8/13/2007

DRAWN BY: BCK
DESIGNED BY: BCK
CHECKED BY: BAD