

F.A.P. RTE.	SECTION	COUNTY	TOTAL SHEETS	SHEET NO.
*595	5HBR	ROCK ISLAND	139	21

STA.	TO STA.
FED. ROAD DIST. NO.	ILLINOIS FED. AID PROJECT

\*(IL 5/IL 92)

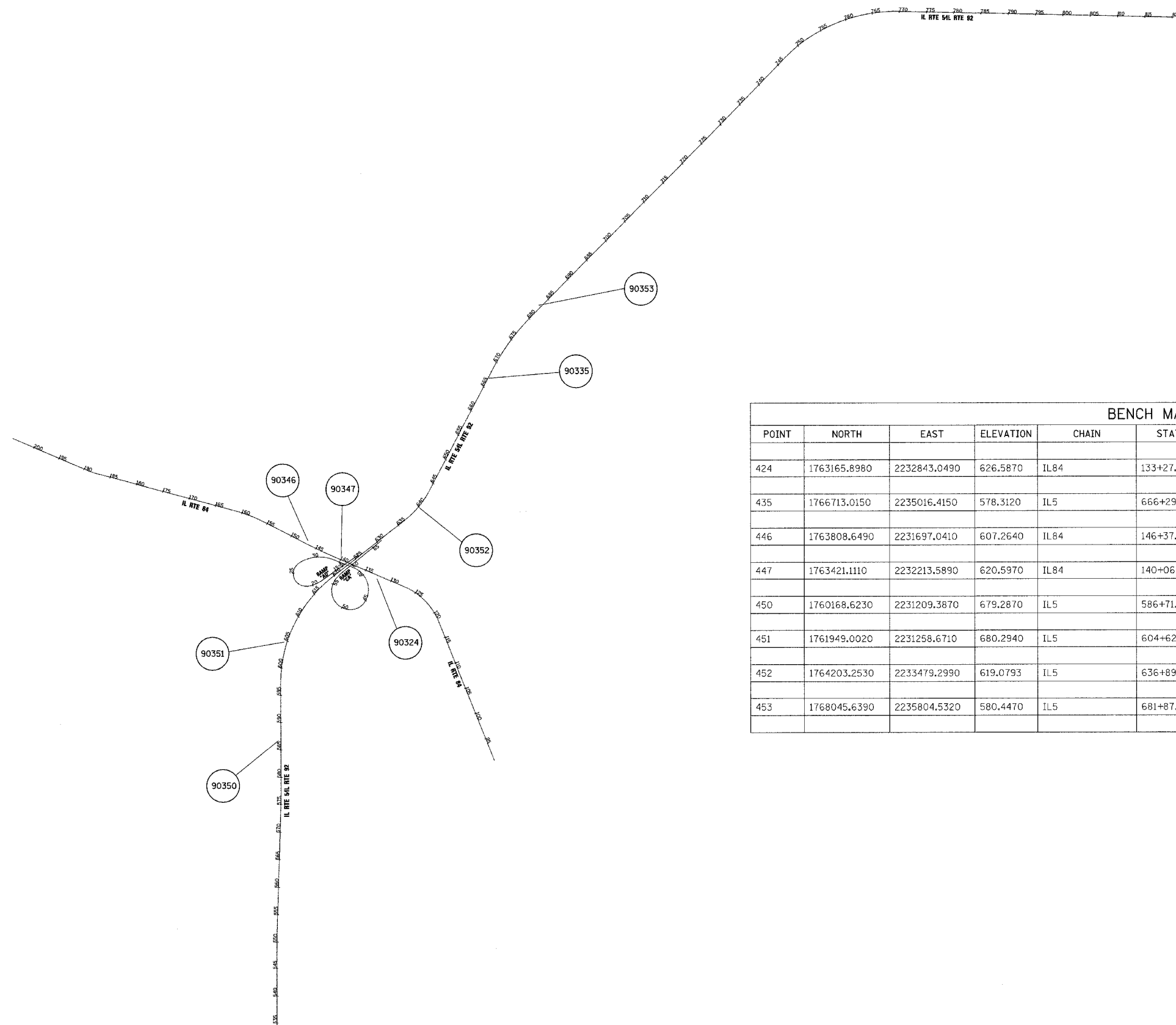

BENCH MARKS							
POINT	NORTH	EAST	ELEVATION	CHAIN	STATION	OFFSET	DESCRIPTION
424	1763165.8980	2232843.0490	626.5870	IL84	133+27.2228	58.4721' LT	FOUNDATION, BOLT
435	1766713.0150	2235016.4150	578.3120	IL5	666+29.2722	99.1253' RT	R.O.W. MARKER, TOP
446	1763808.6490	2231697.0410	607.2640	IL84	146+37.4090	64.0364' RT	POWER POLE WITH LIGHT, BOLT
447	1763421.1110	2232213.5890	620.5970	IL84	140+06.2677	72.0135' LT	FOUNDATION, BOLT
450	1760168.6230	2231209.3870	679.2870	IL5	586+71.6729	57.5755' RT	GPS CONTROL POINT, PIN
451	1761949.0020	2231258.6710	680.2940	IL5	604+62.9045	1.0227' LT	SIGN FOUNDATION, BOLT
452	1764203.2530	2233479.2990	619.0793	IL5	636+89.4432	37.1771' RT	WALL, DISK
453	1768045.6390	2235804.5320	580.4470	IL5	681+87.8351	40.4385' LT	RAILROAD SIG. FOUNDATION, BOLT

PLOT DATE = Wed Aug 22 13:44:28 2007  
 FILE NAME = c:\p\o\j\eta\p\206293\_486283\hvo.dgn  
 PLOT SCALE = 1/8" = 100'  
 USER NAME = gonssad

REVISIONS	
NAME	DATE

ILLINOIS DEPARTMENT OF TRANSPORTATION  
  
**FAP ROUTE 595 (IL 5/IL 92)**  
  
**SECTION 5HBR**  
  
**ROCK ISLAND COUNTY**  
  
 SCALE: VERT. \_\_\_\_\_  
 HORIZ. \_\_\_\_\_  
 DATE \_\_\_\_\_  
 DRAWN BY \_\_\_\_\_  
 CHECKED BY \_\_\_\_\_