

F.A.P. RTE.	SECTION	COUNTY	TOTAL SHEETS	SHEET NO.
311	5 BR-1	LASALLE	32	12

STA. 255+00.00 TO STA. 261+40.00  
 FED. ROAD DIST. NO. ILLINOIS FED. AID PROJECT

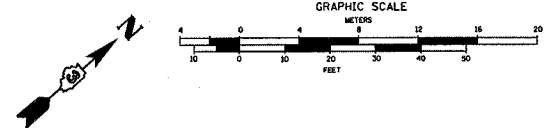

NOTE A:  
 ALL TREES WITHIN CONSTRUCTION LIMITS ARE TO BE REMOVED UNLESS DESIGNATED WITH A CIRCLE ON THE PLAN SHEET AND NOTED IN THE TREE TRUNK PROTECTION SCHEDULE.

**PAVEMENT REMOVAL LEGEND**

- PAVEMENT REMOVAL
- REMOVAL OF EXISTING STRUCTURES STA 260+04.5 TO STA 260+41.5

PR PAVEMENT WIDENING TO BE CONST.  
 AS HMA SURF CSE, 1 1/2" ON HMA BASE CSE, 11 3/4" ON 4" SUBBASE GRN MTL, TY A

PR HMA SURFACE REM, 3/4" PR LVL BINDER, 3/4" PR HMA SURFACE CSE, 1 1/2" SEE MIX TABLE & SCHEDULE FOR DETAILS

STA 260+23 (0° SKEW)  
 PR TRIPLE 11'X9'X100' BOX CULVERT (PRECAST W/CAST-IN-PLACE HOWLS.)  
 PR SN 050-2043, SEE STRUCTURE PLANS EX BRIDGE (SN 050-0067) TBR

PR HMA SURFACE CSE, 1 1/2" ON HMA BIND CSE, 11 3/4" ON 4" SUBBASE GRAN MTL, TY A

PR STONE DUMPED RIPRAP CL A4 W/ FILTER FABRIC & 6" BEDDING MATERIAL

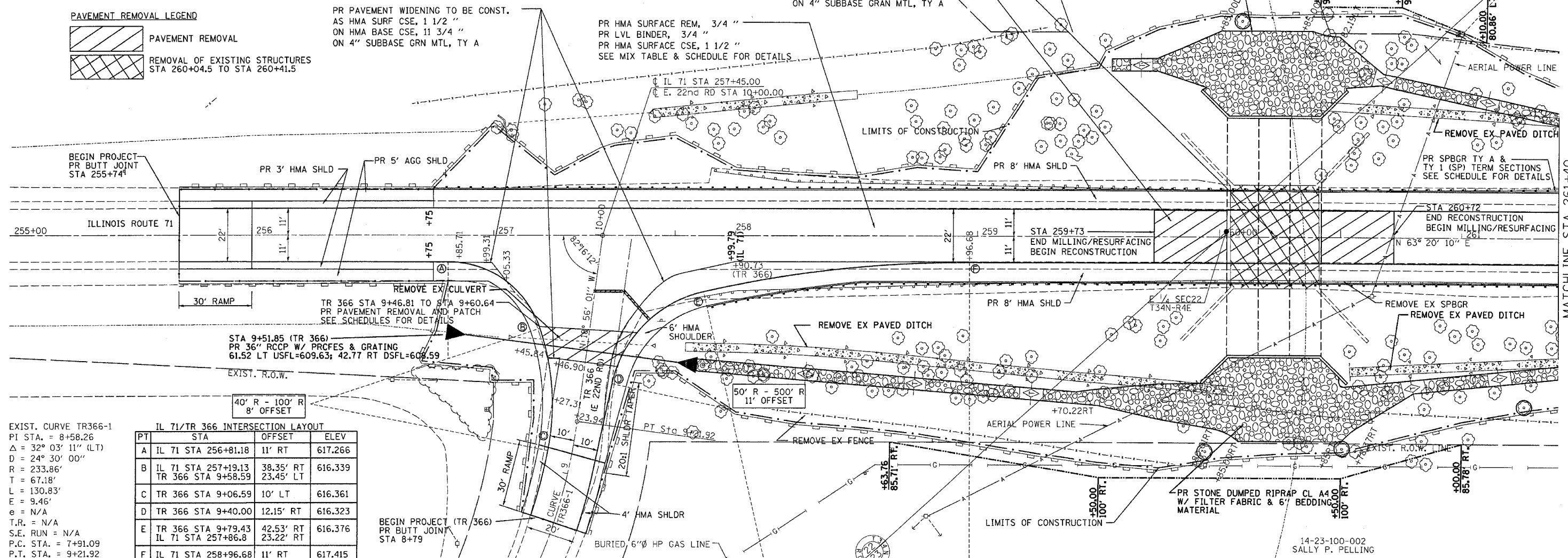

PLAN

DATE	BY

NO. \_\_\_\_\_  
 CHECKED BY \_\_\_\_\_  
 DATE \_\_\_\_\_

PROFILE

DATE	BY

NO. \_\_\_\_\_  
 CHECKED BY \_\_\_\_\_  
 DATE \_\_\_\_\_

EXIST. CURVE TR366-1  
 PI STA. = 8+58.26  
 $\Delta = 32^\circ 03' 11''$  (LT)  
 $D = 24^\circ 30' 00''$   
 $R = 233.86'$   
 $T = 67.18'$   
 $L = 130.83'$   
 $E = 9.46'$   
 $e = N/A$   
 $T.R. = N/A$   
 $S.E. RUN = N/A$   
 $P.C. STA. = 7+91.09$   
 $P.T. STA. = 9+21.92$

**IL 71/TR 366 INTERSECTION LAYOUT**

PT	STA	OFFSET	ELEV
A	IL 71 STA 256+81.18	11' RT	617.266
B	IL 71 STA 257+19.13 TR 366 STA 9+58.59	38.35' RT 23.45' LT	616.339
C	TR 366 STA 9+06.59	10' LT	616.361
D	TR 366 STA 9+40.00	12.15' RT	616.323
E	TR 366 STA 9+79.43 IL 71 STA 257+86.8	42.53' RT 23.22' RT	616.376
F	IL 71 STA 258+96.68	11' RT	617.415

