

F.A.P. RTE.	SECTION	COUNTY	TOTAL SHEETS	SHEET NO.
721	113BR1BR	DEWITT	81	16
STA.		TO STA.		
FED. ROAD DIST. NO.		ILLINOIS FED. AID PROJECT		

RECOVERY TIES

T.S. #400
STATION 246 + 27.79 / 18.39' RT.

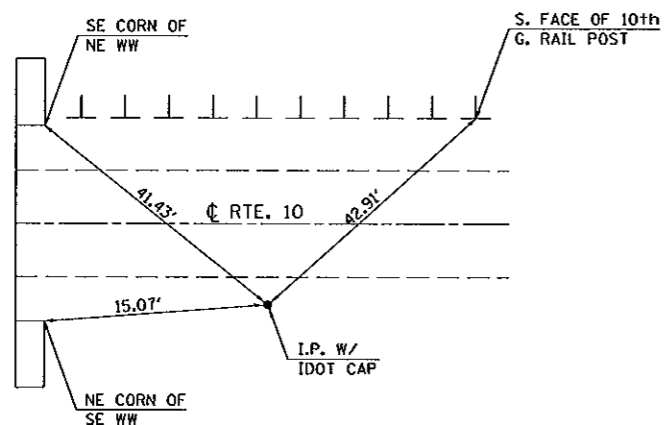

T.S. #401
STATION 236 + 93.18 / 18.78' RT.

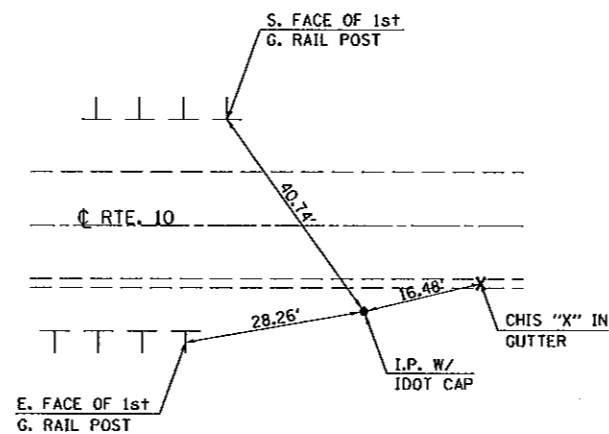

T.S. #402
STATION 241 + 72.51 / 348.75' LT.

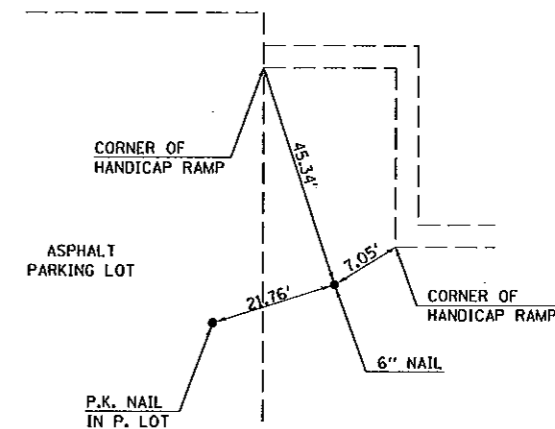

P.O.T. #1
STATION 230 + 21.50

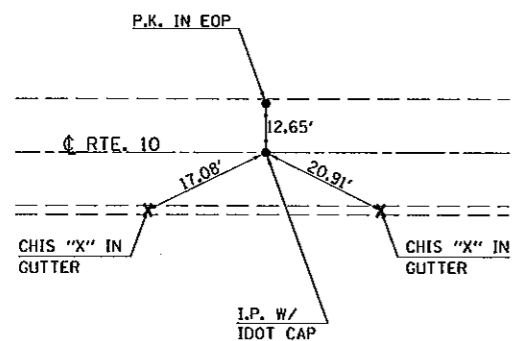

P.O.T. #4
STATION 262 + 53.10

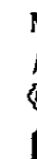
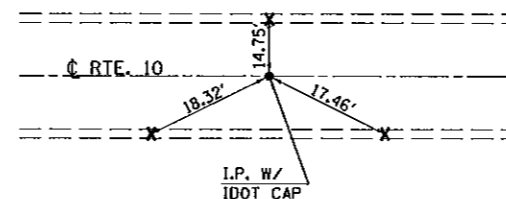

•ALL TIES ARE CHIS "X"'s
IN CONC. GUTTER.

ILLINOIS DEPARTMENT OF TRANSPORTATION
DETAIL OF RECOVERY TIE POINTS

F.A.P. RTE. 721 (IL RTE. 10)
SECTION 113BR1BR
DEWITT COUNTY

SCALE: NOT TO SCALE
DATE: 07/03/07

DRAWN BY: B.B.P.
CHECKED BY: R.M.N.