

TRAFFIC CONTROL PLAN FOR MARKED ROUTE ROAD CLOSED DETOUR

F.A.P. RTE.	SECTION	COUNTY	TOTAL SHEETS	SHEET NO.
721	113BR1BR	DEWITT	81	23
STA.		TO STA.		
FED. ROAD DIST. NO.		ILLINOIS FED. AID PROJECT		

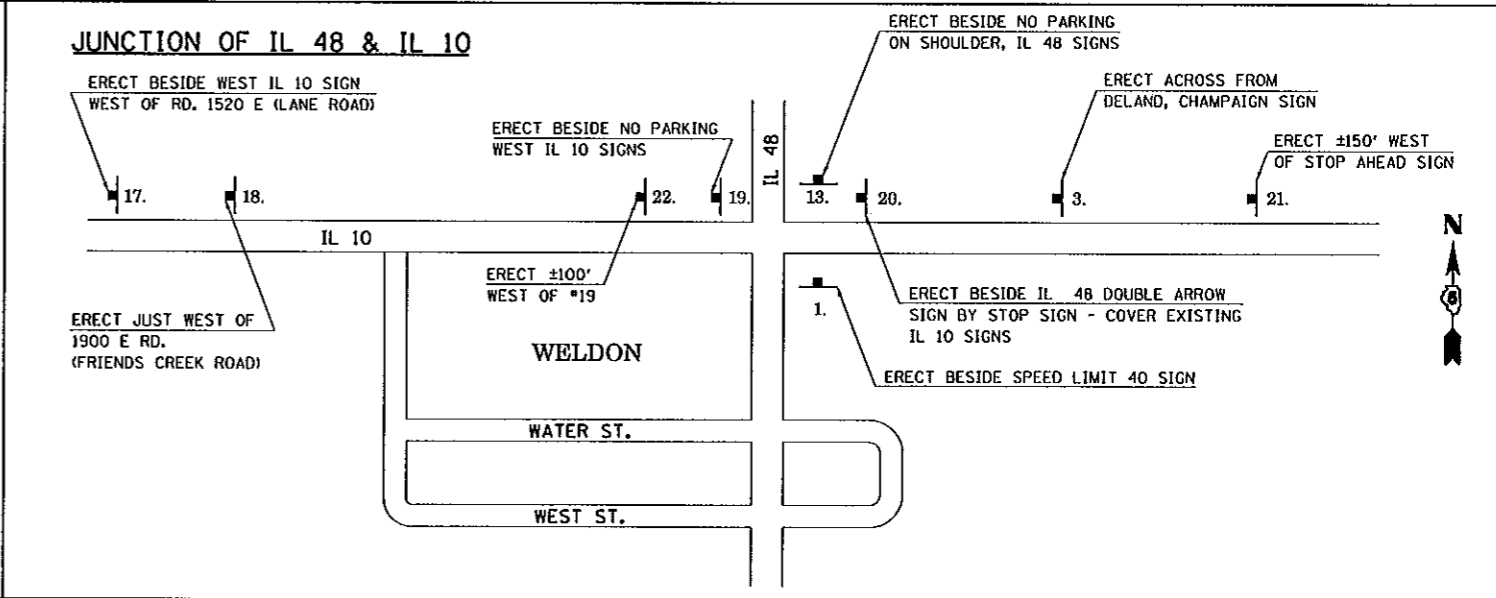
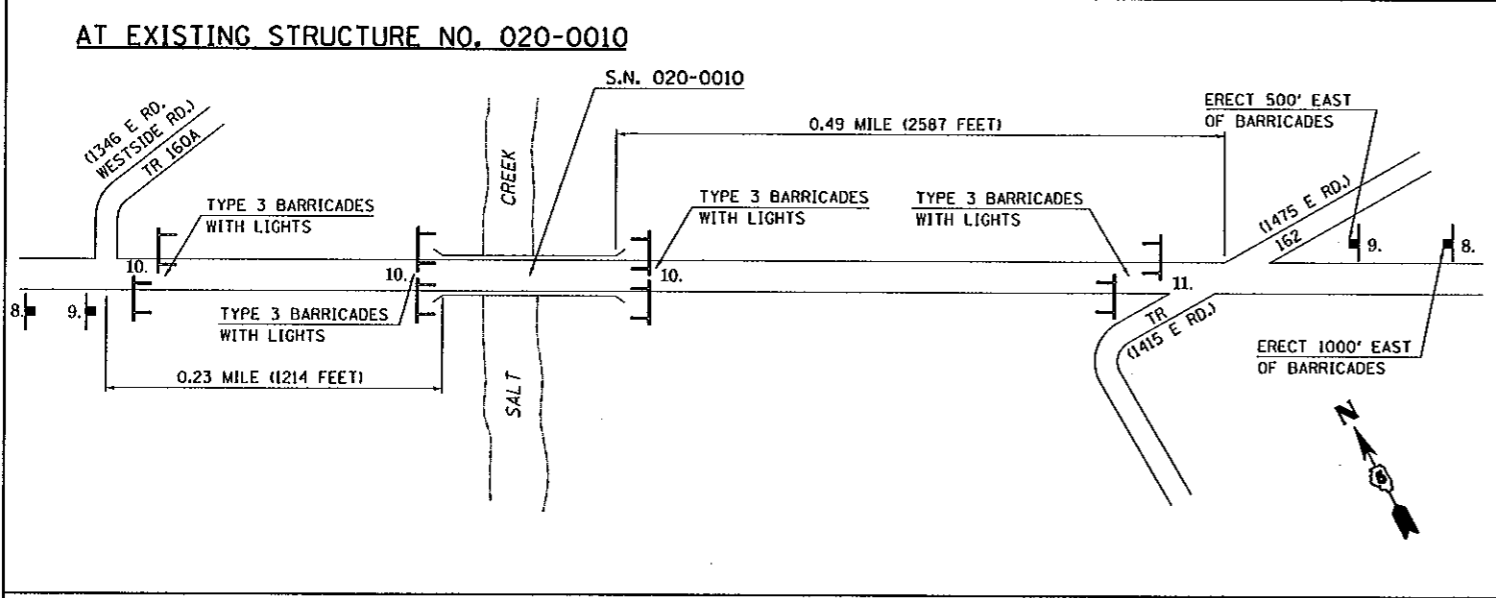
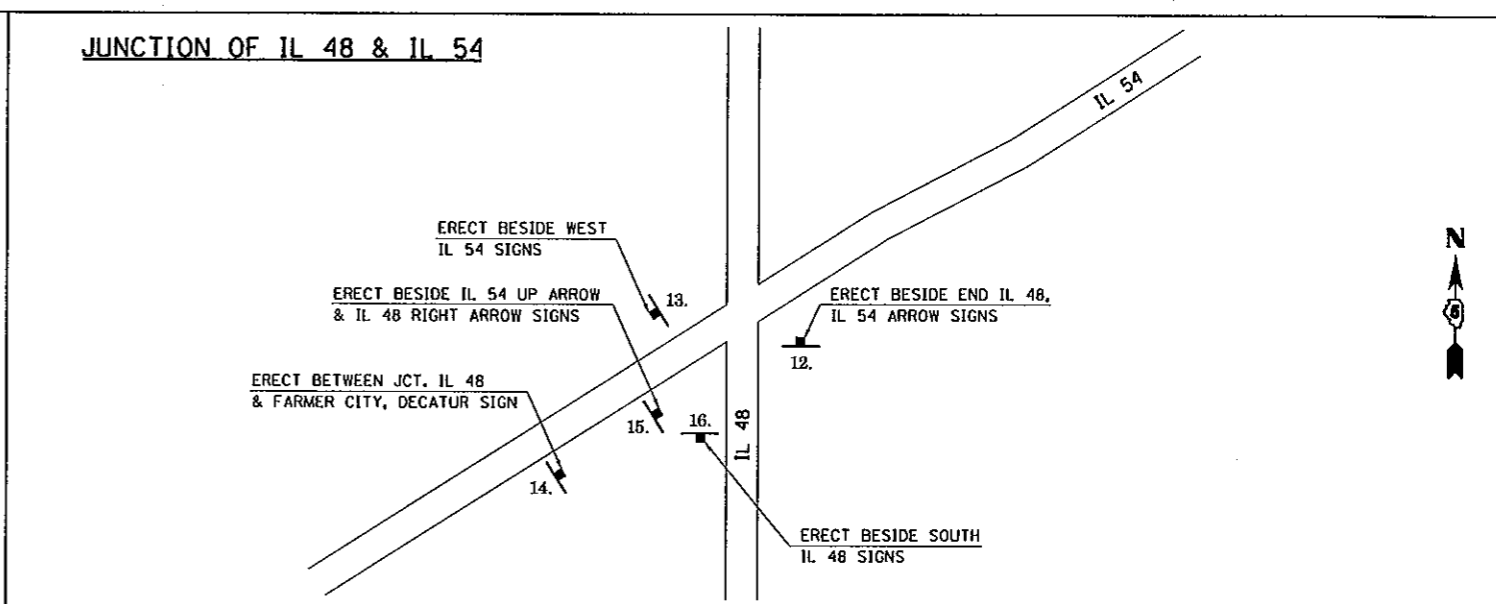
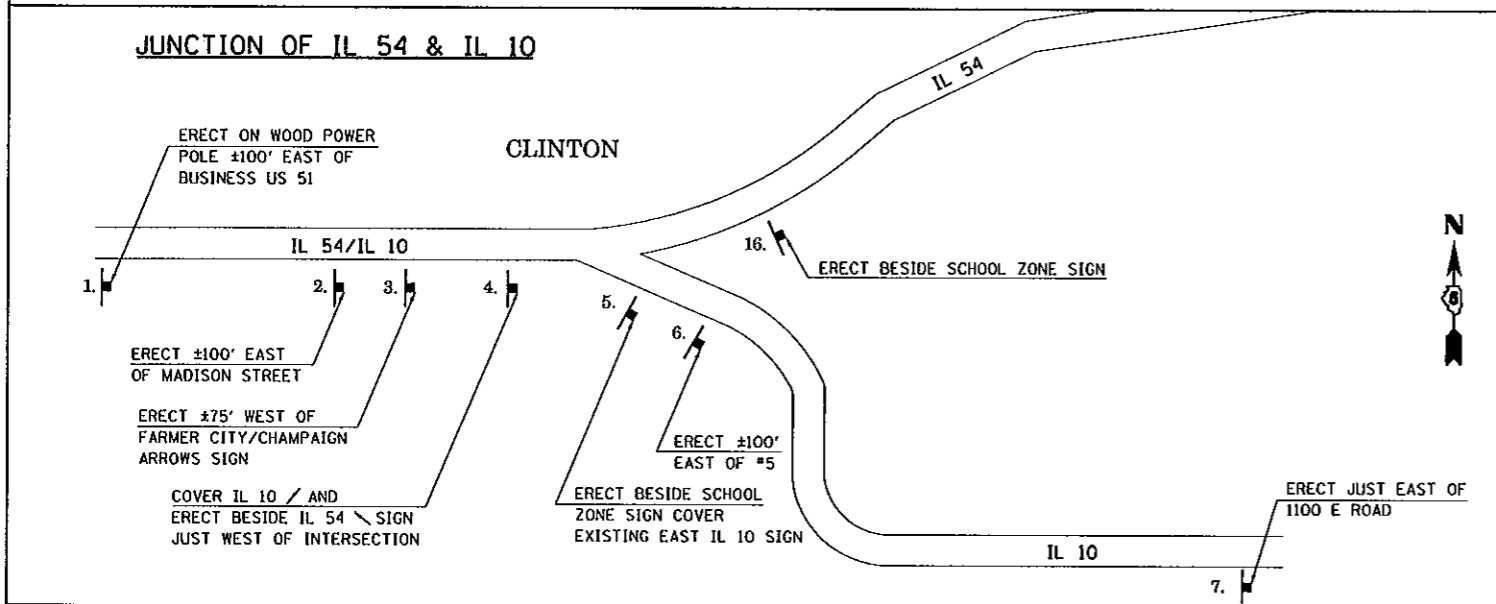

LEGEND

1. IL 10 CLOSED 4 MILES EAST OF CLINTON 36" x 18" ORANGE HWY C LETTERING	3. DETOUR AHEAD 48" x 48"	5. ROAD CLOSED AHEAD 4 MILES 24" x 12"	7. ROAD CLOSED AHEAD 2 1/2 MILES	9. BARRICADE AHEAD	11. ROAD CLOSED TO THRU TRAFFIC 60" x 30"	13. DETOUR WEST ILL 10	15. DETOUR EAST ILL 10	17. ROAD CLOSED AHEAD 1 MILE	19. ROAD CLOSED AHEAD 7 MILES	21. ROAD CLOSED AHEAD	22. IL 10 CLOSED AT SALT CREEK SPILLWAY ACCESS CLOSED 48" x 24" ORANGE HWY C LETTERING
2. ROAD CLOSED AHEAD 21" x 15" ORANGE	4. DETOUR EAST ILL 10	6. SPILLWAY ACCESS CLOSED WEST SIDE DAY-USE ACCESS OPEN 48" x 24" ORANGE HWY C LETTERING	8. ROAD CLOSED AHEAD	10. ROAD CLOSED 48" x 30"	12. DETOUR WEST ILL 10 24" x 12" 24" x 12" 24" x 24" 21" x 15"	14. DETOUR EAST ILL 10	16. DETOUR EAST ILL 10	18. ROAD CLOSED AHEAD 5 MILES	20. DETOUR WEST ILL 10	NOTE: A SECOND #22 SIGN SHALL BE ERECTED ON C.H. 14 (DEWITT RD.) AT THE MASCOUTIN AREA ENTRANCE. CONTACT IDNR FOR EXACT LOCATION.	

ILLINOIS DEPARTMENT OF TRANSPORTATION
**TRAFFIC CONTROL PLAN FOR
MARKED ROUTE ROAD CLOSED DETOUR**
F.A.P. RTE. 721 (IL RTE. 10)
SECTION 113BR1BR
DEWITT COUNTY

SCALE: NOT TO SCALE
DATE: 07/03/07

DRAWN BY: B.B.P.
CHECKED BY: R.M.N.

PLOT DATE = 7/3/2007
FILE NAME = c:\projects\4503002\vb110232det-011a.dgn
PLOT SCALE = 43.2354 / IN.
USER NAME = collierbw