

Bench Mark: BM#4676-2; 21.25' LT. @ Station 242+93.20. Elev. = 667.685

STATE OF ILLINOIS
DEPARTMENT OF TRANSPORTATION

ROUTE NO.	SECTION	COUNTY	TWP.	RANGE	SHEET	SHEET NO. 1
F.A.P. 721	(113BR) BR	DEWITT	B1	26	18 SHEETS	
FED. ROAD DIST. NO. 7	ILLINOIS	FED. AID PROJECT				

Contract #70232

GENERAL NOTES

Reinforcement bars shall conform to the requirements of ASTM A 706 Grade 60 (II, Modified). See Special Provisions.
Layout of slope protection system may be varied in the field to suit ground conditions as directed by the Engineer.
The Contractor shall drive test piles to 110% of the nominal required bearing specified in production locations at substructures specified or approved by the Engineer before ordering the remainder of piles.
Up to 1/4 inch will be ground off the bridge slab and bridge approach pavement. Reinforcement bars designated (E) shall be epoxy coated.
The embankment configuration shown shall be the minimum that must be placed and compacted prior to construction of the abutments.

INDEX OF SHEETS

1. General Plan & Details
2. Top of Slab Elevations
3. Top of West Approach Slab Elevations
4. Top of East Approach Slab Elevations
5. Superstructure
6. Superstructure Details
7. Drainage Scupper
8. Diaphragm Details
9. Framing Plan
10. Beam Details
11. West Abutment
12. East Abutment
13. Pier
14. Pier Details
15. Bar Splacers
16. Boring Logs

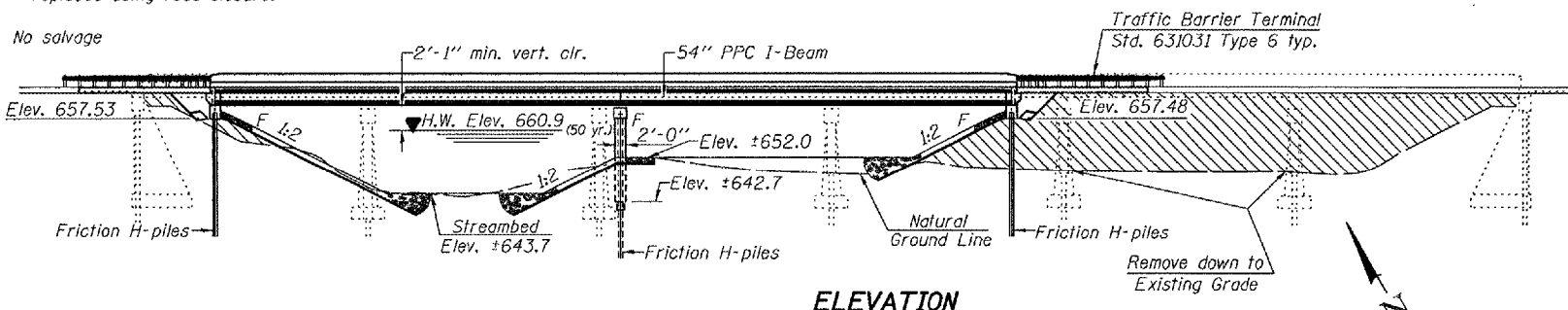

ELEVATION

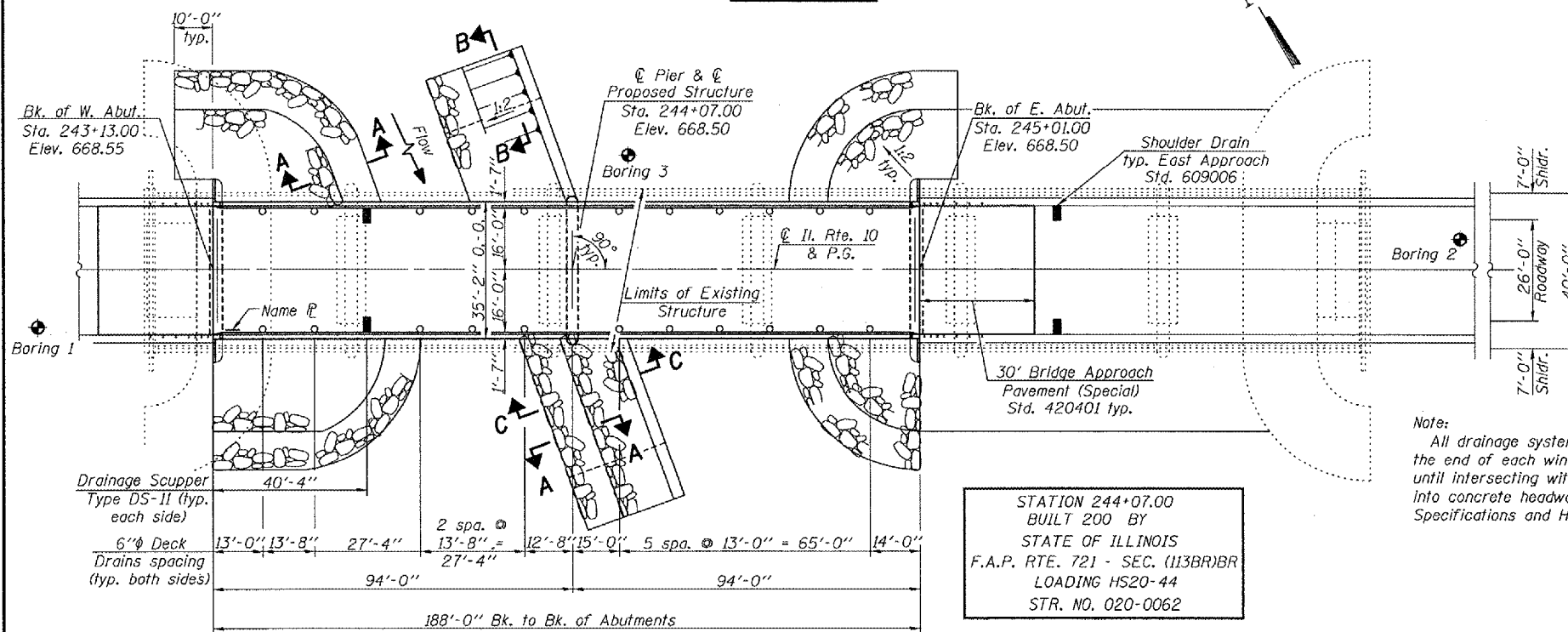

PLAN

STATION 244+07.00
BUILT 200 BY
STATE OF ILLINOIS
F.A.P. RTE. 721 - SEC. (113BR)BR
LOADING HS20-44
STR. NO. 020-0062

NAME PLATE

See Std. 515001

The profile grade shows the final elevations after grinding.

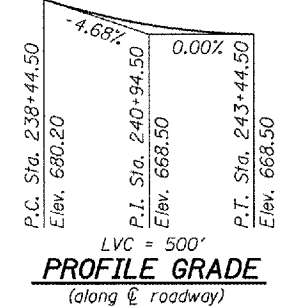

PROFILE GRADE

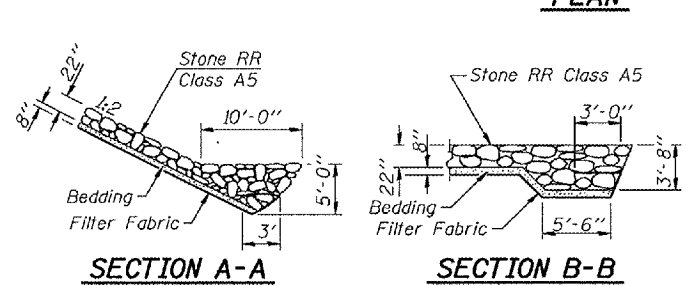

SECTION A-A

SECTION B-B

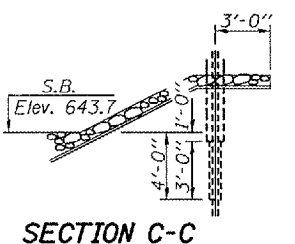

SECTION C-C

WATERWAY INFORMATION

		Exist. Low Grade Elev. 667.7 ft. @ Sta. 244+00				
Drainage Area = 294 mi. ²		Prop. Low Grade Elev. 667.8 ft. @ Sta. 249+00				
Flood	Freq.	Q	Opening Sq. Ft.	Not. H.W.E.	Head - Ft.	Headwater El.
	Yr.	C.F.S.	Exist. Prop.	Exist. Prop.	Exist. Prop.	Exist. Prop.
Design	50	10385	2503	1812	660.9	0.3 0.5 659.4 659.6
Base	100	11816	2701	1917	661.6	0.4 1.0 662.0 662.6
Max. Calc.	500	15201	3104	2168	663.0	0.4 1.4 663.4 664.4

Note:
All drainage system components shall extend to 2'-0" from the end of each wingwall except an outlet pipe shall extend until intersecting with the side slopes. The pipes shall drain into concrete headwalls. (See Article 601.05 of the Standard Specifications and Highway Standard 60110).

LOADING HS20-44
Allow 50#/sq. ft. for future wearing surface.

DESIGN SPECIFICATIONS
2002 AASHTO

DESIGN STRESSES

FIELD UNITS

$f'_c = 3,500$ psi
 $f_y = 60,000$ psi (reinforcement)

PRECAST PRESTRESSED UNITS

$f'_c = 6,000$ psi
 $f'_d = 5,000$ psi
 $f'_s = 270,000$ psi (1/2" low lax. strands)
 $f_{si} = 201,960$ psi (1/2" low lax. strands)

SEISMIC DATA

Seismic Performance Category (SPC) = A
Bedrock Acceleration Coefficient (A) = 4.62g
Site Coefficient (S) = 1.0

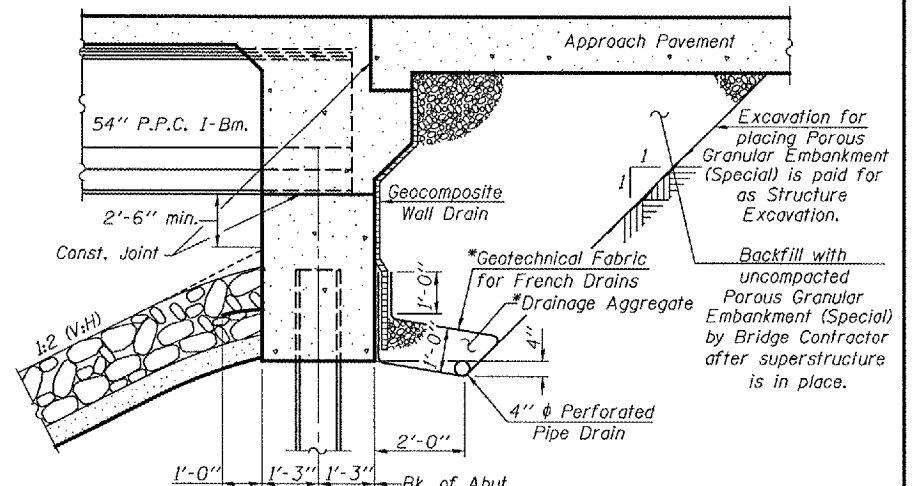

SECTION THRU INTEGRAL ABUTMENT

TOTAL BILL OF MATERIAL

ITEM	UNIT	SUPER	SUB	TOTAL
Removal of Existing Structures	Each			1
Concrete Superstructure	Cu. Yd.	242		242
Concrete Structures	Cu. Yd.		104	104
Structure Excavation	Cu. Yd.		282	282
Furnishing and Erecting Precast Prestressed Concrete I Beams, 54"	Foot	1119		1119
Reinforcement Bars, Epoxy Coated	Pound	50760	11690	62450
Test Pile Steel HP12x63	Each		3	3
Furnishing Steel Piles HP12x63	Foot		741	741
Driving Piles	Foot		741	741
Name Plates	Each			1
Porous Granular Embankment (Special)	Cu. Yd.		266	266
Stone Riprap, Class A5	Sq. Yd.		1475	1475
Filter Fabric	Sq. Yd.		1475	1475
Protective Coat	Sq. Yd.	826		826
Diamond Grinding (Bridge Section)	Sq. Yd.	809		809
Drainage Scuppers, DS-II	Each	2		2
Floor Drains	Each	22		22
Underwater Structure Excavation Protection-Location 1	Each			1
Geocomposite Wall Drain	Sq. Yd.		110	110
Pipe Underdrains for Structures 4"	Foot		163	163
Bar Splacers	Each	64		64
Bridge Deck Grooving	Sq. Yd.	627		627
Concrete Encasement	Cu. Yd.		7.0	7.0
Asbestos Bearing Pad Removal	Each			168

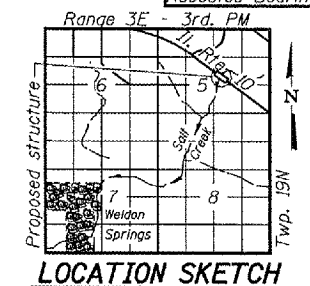

LOCATION SKETCH

GENERAL PLAN
ILLINOIS ROUTE 10 OVER
SALT CREEK
F.A.P. ROUTE 721 - SECTION (113BR)BR
DEWITT COUNTY
STATION 244+07.00
STRUCTURE NO. 020-0062

DESIGNED: [Signature]
CHECKED: [Signature]
DRAWN: R. Sommer
CHECKED: [Signature]

EXAMINED: [Signature] Sept. 7 2007
PASSED: [Signature]

STATE OF ILLINOIS
DEPARTMENT OF TRANSPORTATION
081-004625

EXPIRES 11-30-2008 10 Yr. Velocity through Exist. Bridge = 3.5 fps 10 Yr. Velocity through Prop. Bridge = 4.8 fps