

F.A.P. RTE.	SECTION	COUNTY	TOTAL SHEETS	SHEET NO.
42	106(B-1,B-2)	MONTGOMERY	61	11
STA. 124+00		TO STA. 130+00		
FED. ROAD DIST. NO.		ILLINOIS FED. AID PROJECT		

PLAN	SURVEYED	BY	DATE
NO.	NO.		
NOTE BOOK NO.	NO.		
CADD FILE NAME			

PROFILE	SURVEYED	BY	DATE
NO.	NO.		
NOTE BOOK NO.	NO.		
STRUCTURE NOTATION CHRD			

PLOT DATE = Aug 16 2007 02:45:27PM  
 FILE NAME = c:\projects\685598\kpluseng-1\m\11\_rpp\_1.dwg  
 PLOT SCALE = 42,3529 / IN.  
 USER NAME = laughlin-1

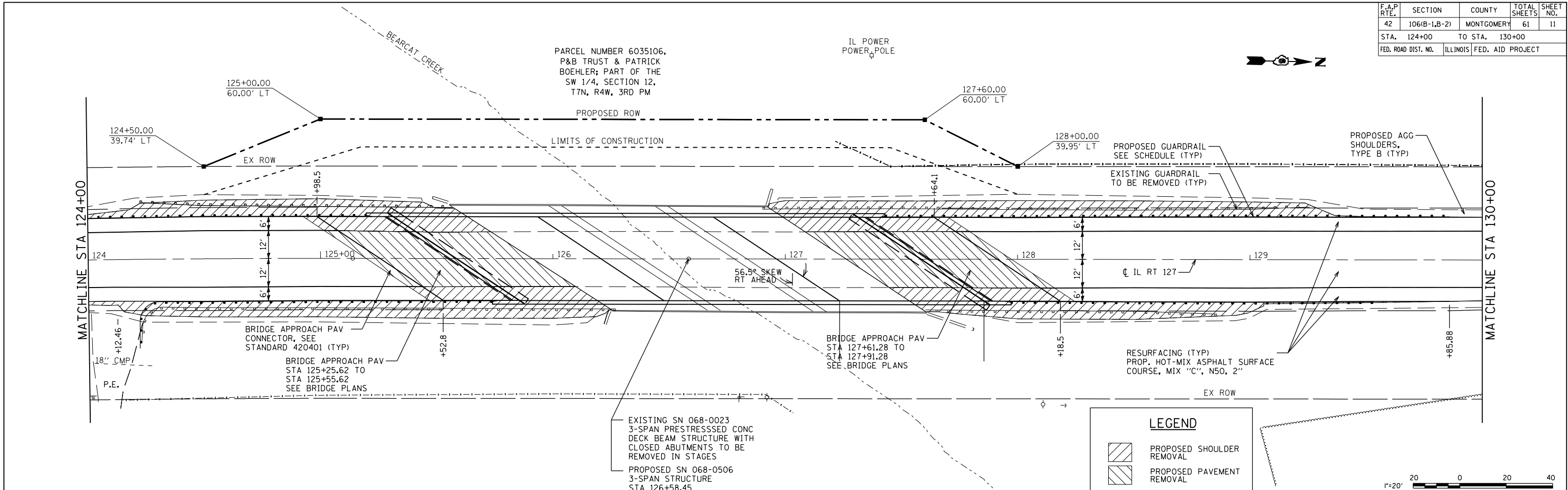

**LEGEND**

- PROPOSED SHOULDER REMOVAL
- PROPOSED PAVEMENT REMOVAL

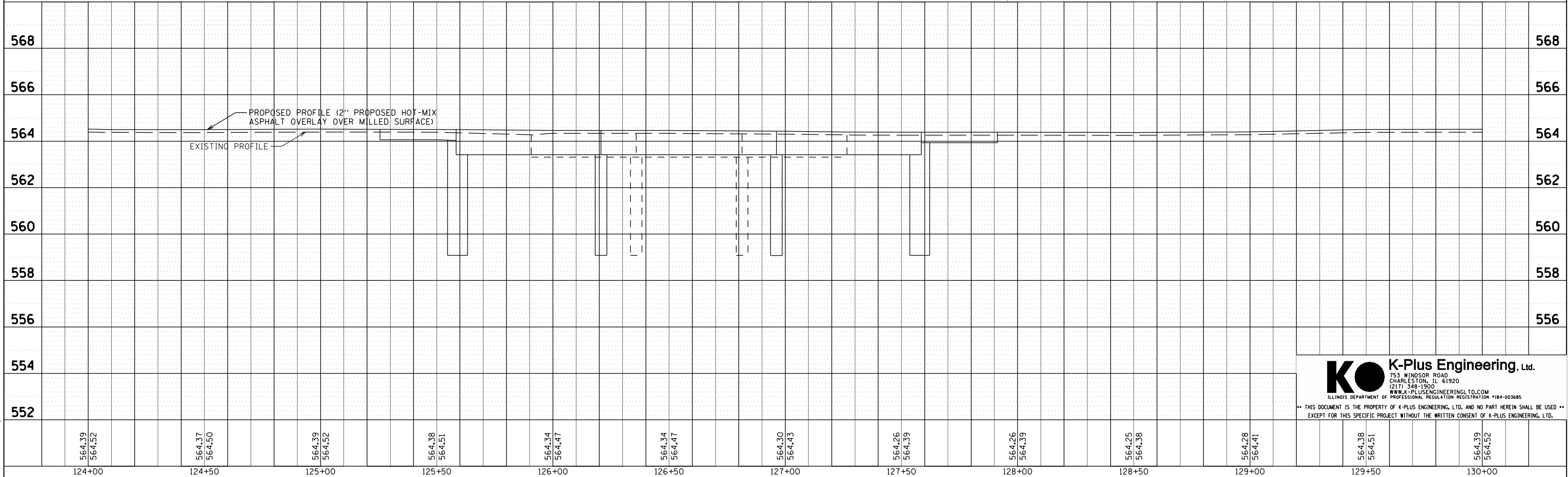
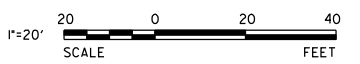

**K-Plus Engineering, Ltd.**  
 753 WINDSOR ROAD  
 CHARLESTON, IL 61920  
 (217) 348-1900  
 WWW.K-PLUSENGINEERING.LTD.COM  
 ILLINOIS DEPARTMENT OF PROFESSIONAL REGULATION REGISTRATION \*184-003685

\*\* THIS DOCUMENT IS THE PROPERTY OF K-PLUS ENGINEERING, LTD. AND NO PART HEREIN SHALL BE USED \*\*  
 EXCEPT FOR THIS SPECIFIC PROJECT WITHOUT THE WRITTEN CONSENT OF K-PLUS ENGINEERING, LTD.