

- Notes:
- Space reinforcement in cap to miss anchor bolts.
 - Pour steps monolithically with cap.
 - For Concrete Encasement details, see sheet 18 of 20.

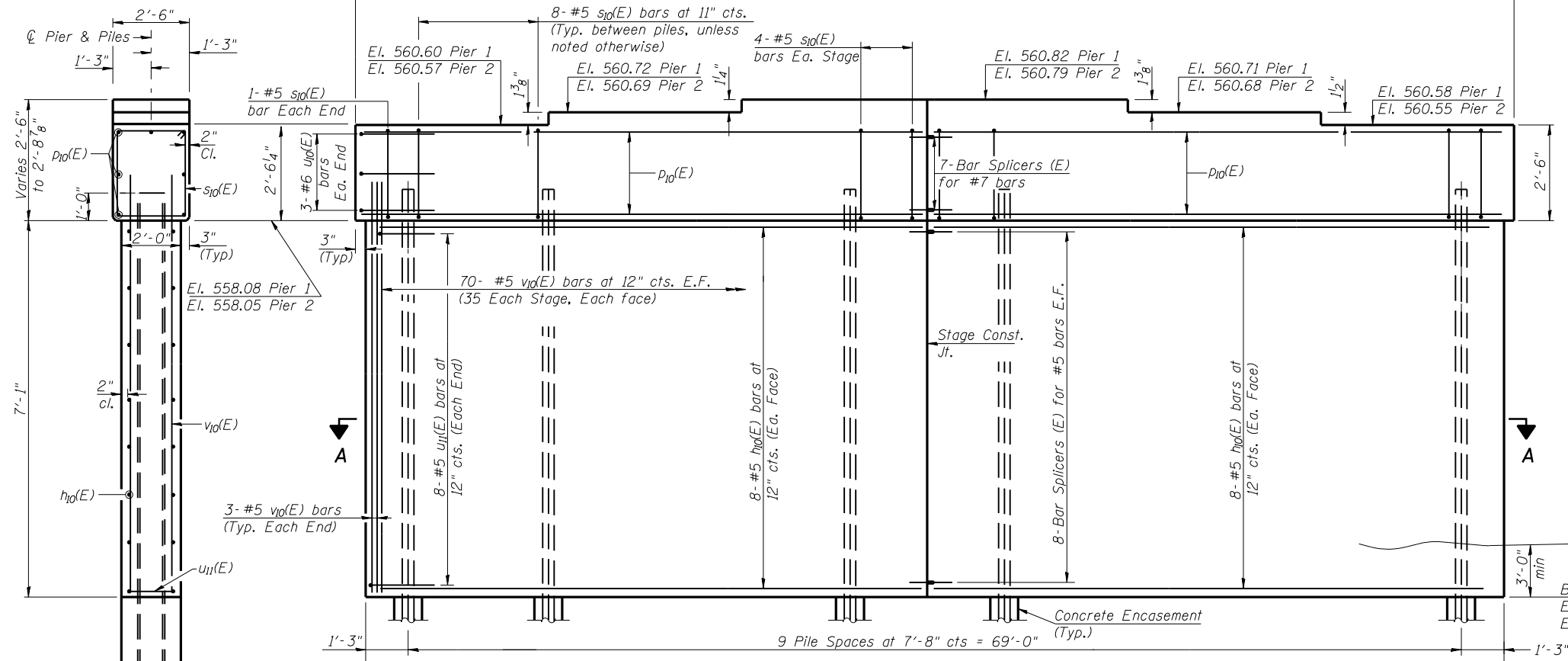
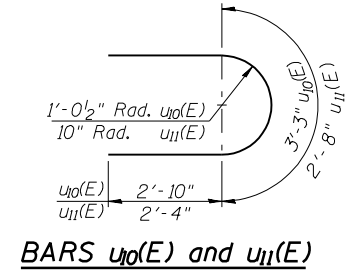
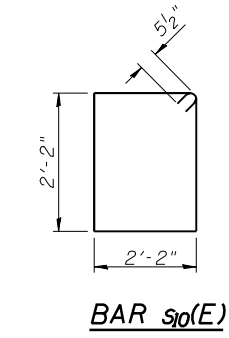
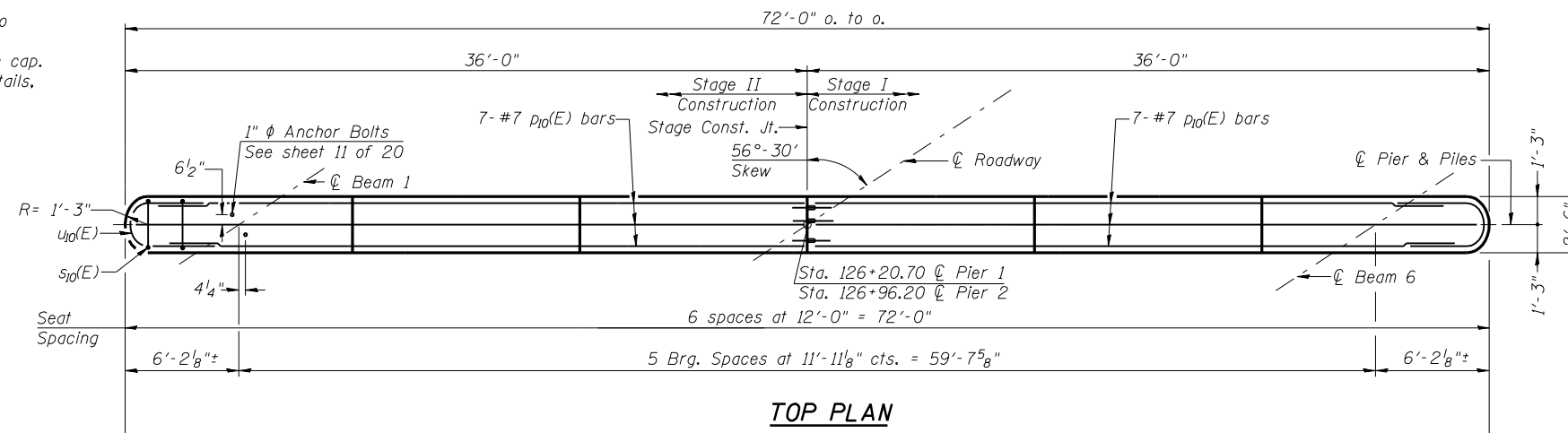

PILE DATA

Type: Steel HP 12x53
 Nominal Required Bearing: 345 kips
 Allowable Resistance Available: 115 kips
 Est. Length: 69 Ft. (Pier 1), 67 Ft. (Pier 2)
 No. Production Piles: 9 (Pier 1), 9 (Pier 2)
 No. Test Piles: 1 (Pier 1), 1 (Pier 2)

BILL OF MATERIAL
(Two Piers)

Bar	No.	Size	Length	Shape
h ₁₀ (E)	64	#5	34'-6"	—
p ₁₀ (E)	28	#7	34'-5"	—
s ₁₀ (E)	148	#5	9'-7"	⊠
u ₁₀ (E)	12	#6	8'-11"	U
u ₁₁ (E)	32	#5	7'-4"	U
v ₁₀ (E)	292	#5	9'-0"	—
Concrete Structures			Cu. Yd.	109.6
Concrete Encasement			Cu. Yd.	7.0
Reinforcement Bars, Epoxy Coated			Pound	8900
Structure Excavation			Cu. Yd.	99
Furnishing Steel Piles, HP 12x53			Foot	1224
Driving Piles			Foot	1224
Test Pile Steel, HP 12x53			Each	2
Underwater Structure Excavation Protection - Location 1			Each	1
Underwater Structure Excavation Protection - Location 2			Each	1

ELEVATION
(Looking North)

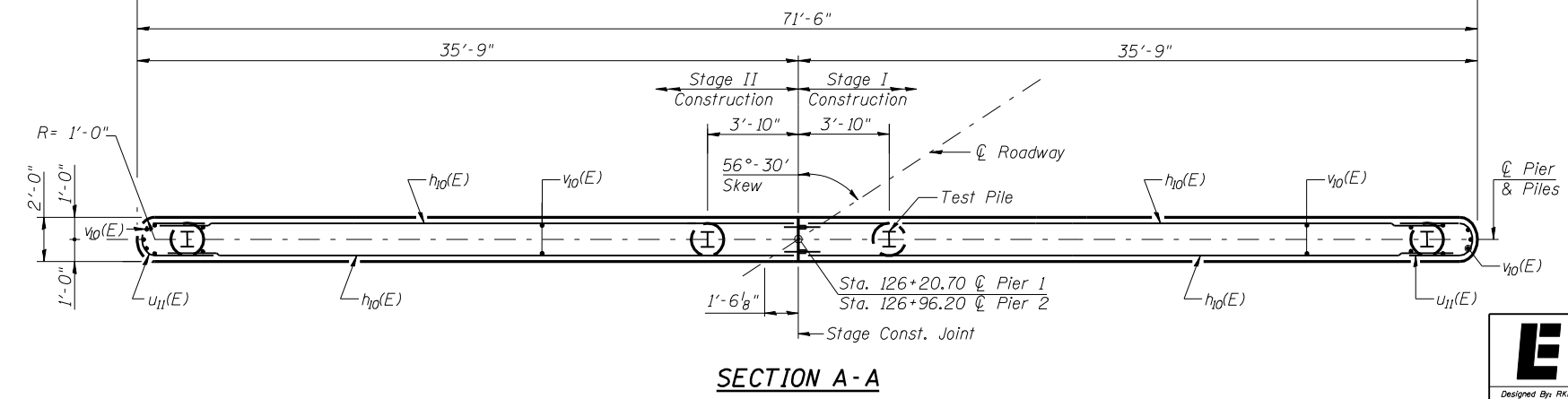

SECTION A-A

Lin Engineering, Ltd.
 Consulting Engineers
 Chatham, Illinois

Designed By: RKM
 Checked By: MTH
 Date: 04/2007

Drawn By: AJP
 File: 068-0506.DGN

REVISIONS	
NAME	DATE

ILLINOIS DEPARTMENT OF TRANSPORTATION
PIERS 1 & 2
 ILLINOIS ROUTE 127 OVER
 BEARCAT CREEK
 F.A.P. ROUTE 42 - SECTION 106 (B-1)
 MONTGOMERY COUNTY
 STA. 126+58.45
 STRUCTURE NO. 068-0506

Aug-16-2007 11:23:00AM 1:23:00 AM \$FILEABBREV\$