

F.A.I. RTE.	SECTION	COUNTY	TOTAL SHEETS	SHEET NO.
FAI 64	95-(5,6)RS-1	WASHINGTON	83	1

STATE OF ILLINOIS
DEPARTMENT OF TRANSPORTATION

DIVISION OF HIGHWAYS

**PROPOSED
HIGHWAY PLANS**

FAI ROUTE 64
SECTION 95-(5,6)RS-1
PROJECT: ACIM-064-2(119)057
WASHINGTON COUNTY

C-98-011-07
RESURFACING & BRIDGE REPAIRS

FOR INDEX OF SHEETS, SEE SHEET NO. 2

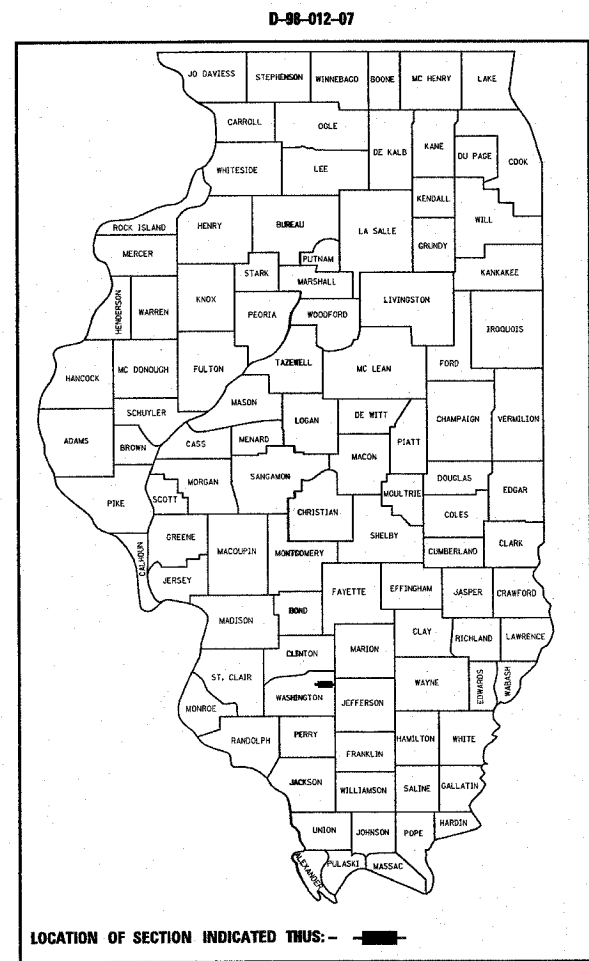

LOCATION OF SECTION INDICATED THUS: —

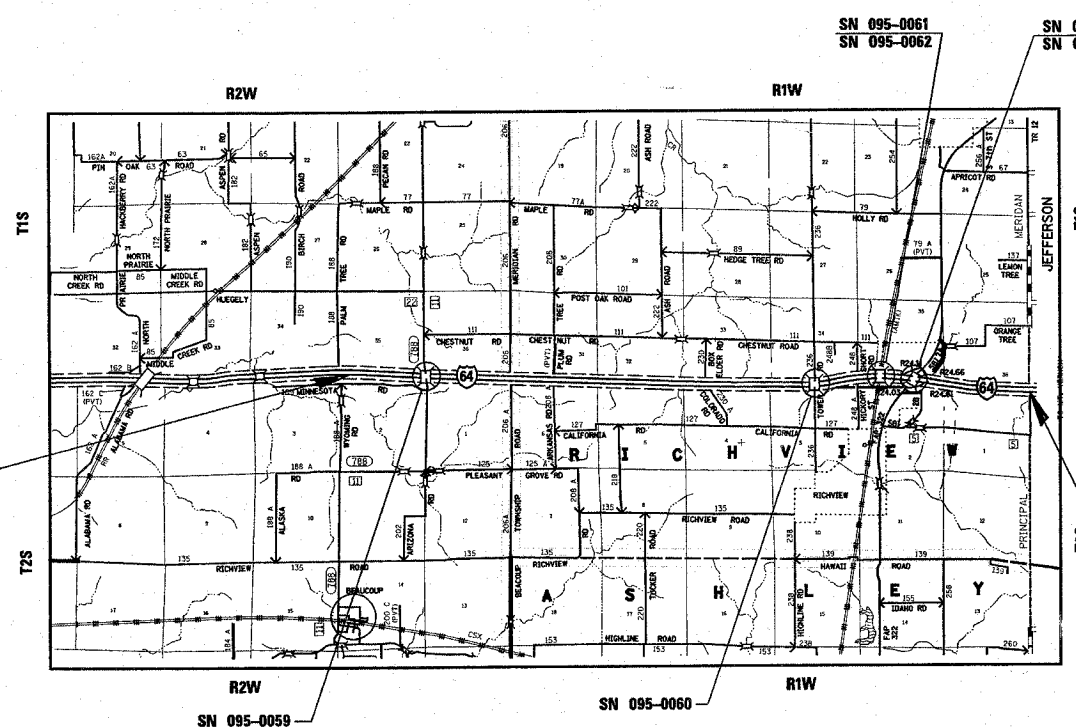

BEGIN PROJECT
STA 2935+25.00
LAT 38 23' 29" N
LONG -89 17' 37" W

END PROJECT
STA 3355+51.88
LAT 38 23' 14" N
LONG -89 08' 44" W

MICROFILMED _____
REEL NUMBER _____
AWARDED _____
RESIDENT ENGINEER _____
AS BUILT CHANGES WERE MADE
ON THE FOLLOWING SHEETS _____

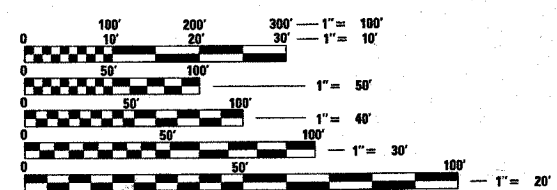

FULL SIZE PLANS HAVE BEEN PREPARED USING STANDARD ENGINEERING SCALES. REDUCED SIZED PLANS WILL NOT CONFORM TO STANDARD SCALES. IN MAKING MEASUREMENTS ON REDUCED PLANS, THE ABOVE SCALES MAY BE USED.

J.U.L.I.E.
JOINT UTILITY LOCATION INFORMATION FOR EXCAVATION
1-800-892-0123

2005 ADT = 19300 (ACTUAL)
2007 ADT = 19700 (ESTIMATED)
2027 ADT = 24000 (ESTIMATED)
S.U. = 5.0% M.U. = 32.6%

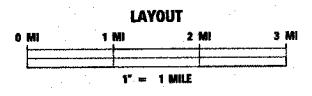

PROJECT LENGTH		
GROSS LENGTH	42026.88	7.960 MILES
NET LENGTH	42026.88	7.960 MILES

STATE OF ILLINOIS
DEPARTMENT OF TRANSPORTATION
DIVISION OF HIGHWAYS

SUBMITTED August 22, 2007

Mary Jamies
DEPUTY DIRECTOR OF HIGHWAYS
REGION FIVE ENGINEER

October 12, 2007
Eric E. Horne
ENGINEER OF DESIGN AND ENVIRONMENT

October 12, 2007
Milton R. Sees
DIRECTOR, DIVISION OF HIGHWAYS

**PRINTED BY THE AUTHORITY
OF THE STATE OF ILLINOIS**

PROJECT ENGINEER: PATTI LeBEAU (618) 346-3179
SQUAD LEADER: CHERYL KEPLAR (618) 346-3186

CONTRACT NO. 76A39