

SECTION	COUNTY	TOTAL SHEETS	SHEET NO.
95-(5,6)RS-1	WASHINGTON	83	27
STA. 3243+00 TO STA. 3273+00		ROAD DIST. NO. ILLINOIS FED. AID PROJECT	

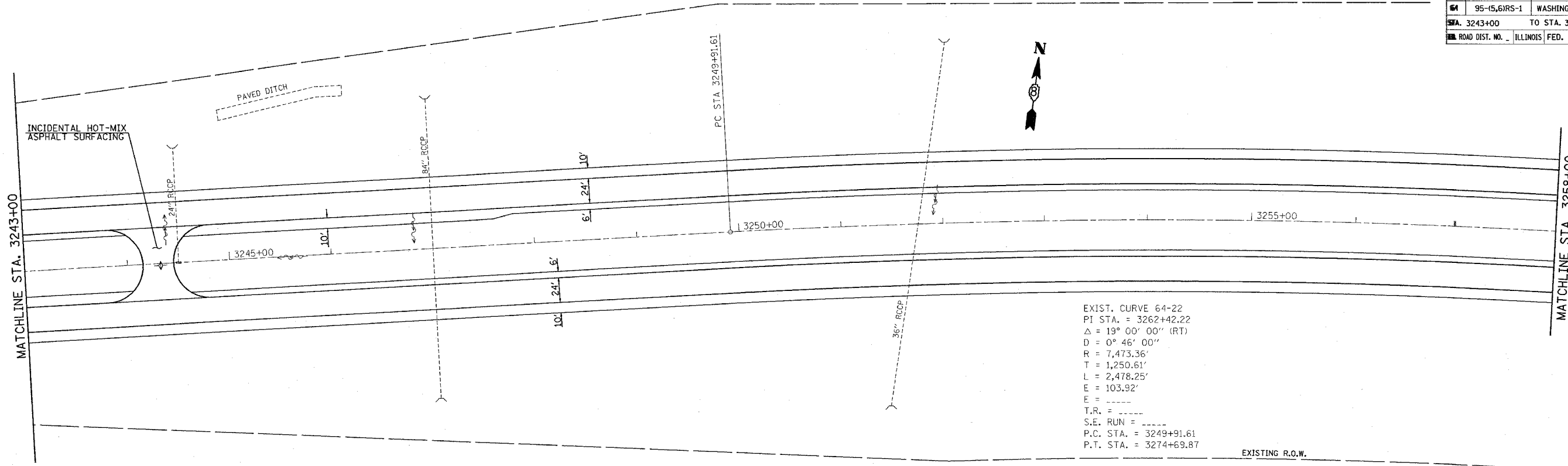

EXIST. CURVE 64-22
 PI STA. = 3262+42.22
 $\Delta = 19^\circ 00' 00''$ (RT)
 $D = 0^\circ 46' 00''$
 $R = 7,473.36'$
 $T = 1,250.61'$
 $L = 2,478.25'$
 $E = 103.92'$
 $E = \dots$
 $T.R. = \dots$
 $S.E. RUN = \dots$
 $P.C. STA. = 3249+91.61$
 $P.T. STA. = 3274+69.87$

EXISTING R.O.W.

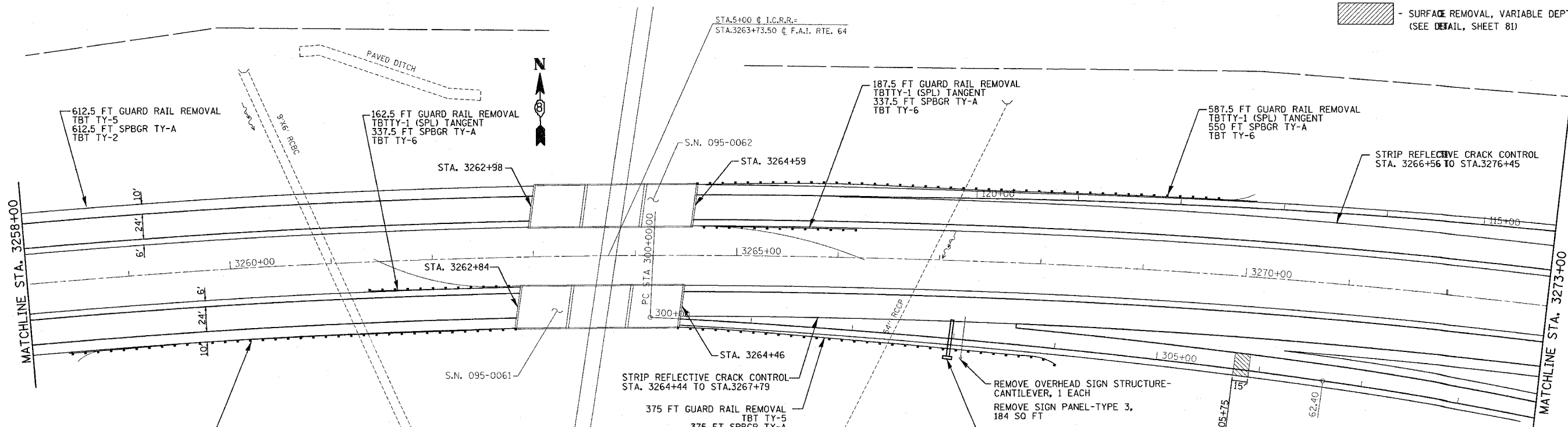

- SURFACE REMOVAL, VARIABLE DEPTH (SEE DETAIL, SHEET 81)

REMOVE OVERHEAD SIGN STRUCTURE - CANTILEVER, 1 EACH
 REMOVE SIGN PANEL - TYPE 3, 184 SQ FT
 OVERHEAD SIGN STRUCTURE - CANTILEVER SEE DETAIL SHEETS 68.-78.

REVISIONS	
NAME	DATE

ILLINOIS DEPARTMENT OF TRANSPORTATION
PLAN VIEW
 FAI RTE. 64
 SECTION 95-(5,6)RS-1
 WASHINGTON COUNTY

SCALE: VERT. _____
 HORIZ. _____
 DATE _____ DRAWN BY _____
 CHECKED BY _____

PLOT DATE = 8/21/2007
 FILE NAME = c:\nps\p1207\plan\p1207b.dgn
 PLOT SCALE = 50,000 / IN.
 REFERENCE = #REF#