

F.A.I. RTE.	SECTION	COUNTY	TOTAL SHEETS	SHEET NO.
64	95-(5,6)RS-1	WASHINGTON	83	43
STA. 3243+00		TO STA. 3273+00		
FED. ROAD DIST. NO. ILLINOIS FED. AID PROJECT				

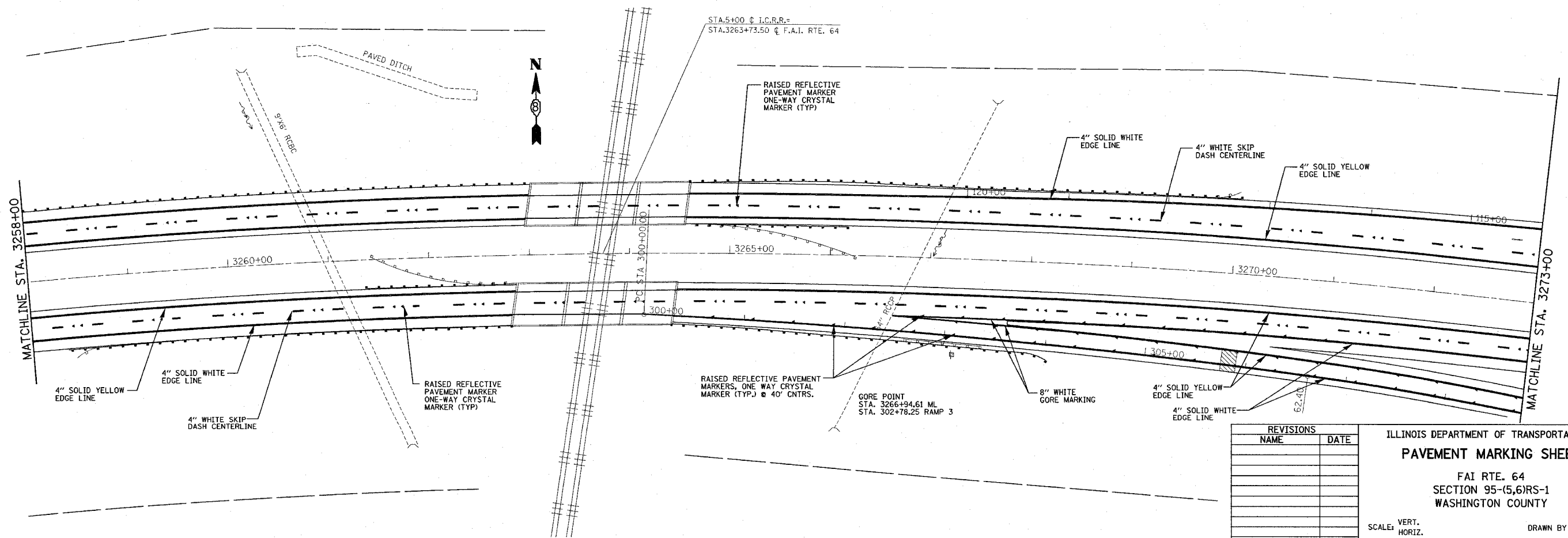
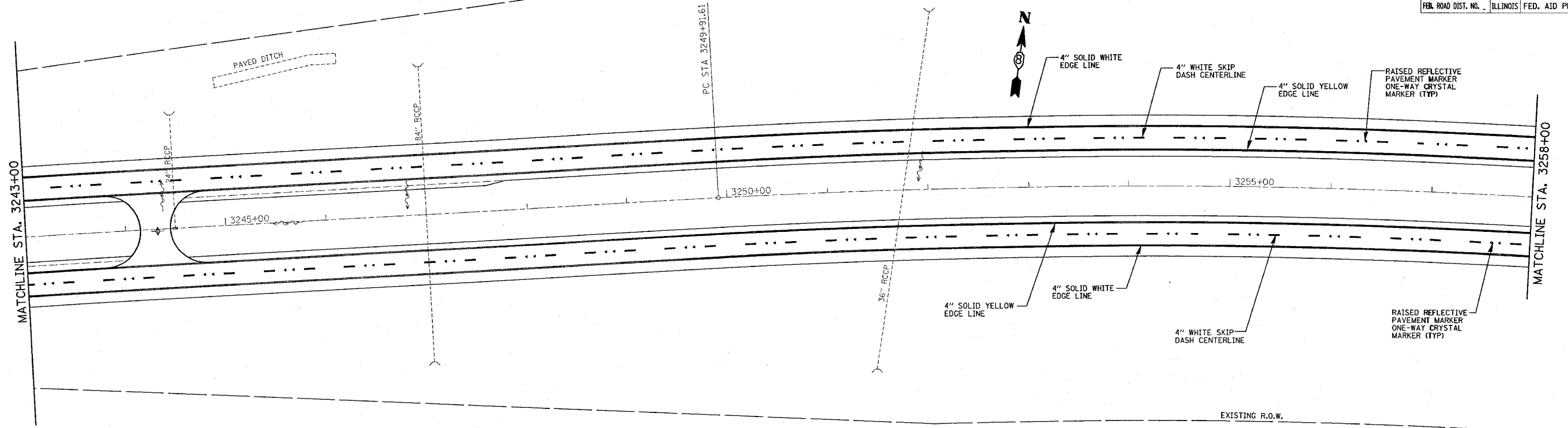

PLOT DATE = 8/21/2007
 FILE NAME = c:\projects\76a39\plan\pvmak0207b.dgn
 PLOT SCALE = 60,000 / IN.
 REFERENCE = #REF#

REVISIONS	
NAME	DATE

ILLINOIS DEPARTMENT OF TRANSPORTATION
PAVEMENT MARKING SHEET

FAI RTE. 64
 SECTION 95-(5,6)RS-1
 WASHINGTON COUNTY

SCALE: VERT.
 HORIZ.
 DATE

DRAWN BY
 CHECKED BY