

STATE OF ILLINOIS
DEPARTMENT OF TRANSPORTATION

ROUTE NO.	SECTION	COUNTY	TOTAL SHEETS	SHEET NO.	SHEET NO. 1
FAI 64	95-5HB-1	WASHINGTON	83	48	3 SHEETS
FED. ROAD DIST. NO. 7	ILLINOIS	FED. AID PROJECT			

Contract #76A39

INDEX OF SHEETS

Sheet No.	Description
1	General Plan
2	Superstructure Details
3	Floor Drain Details

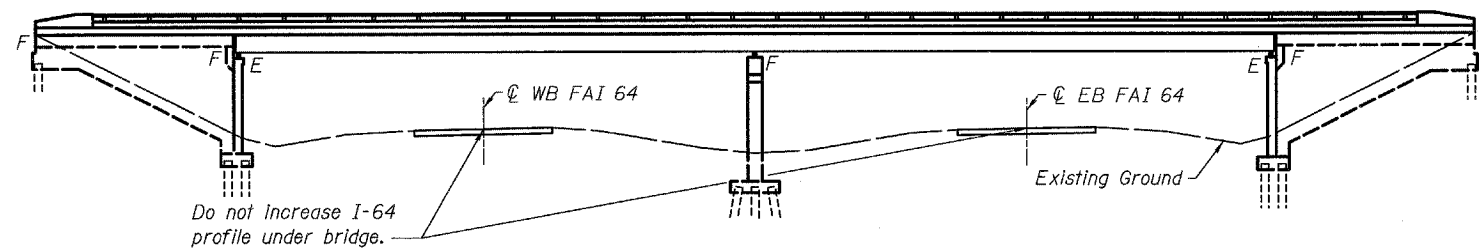

ELEVATION

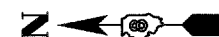

GENERAL NOTES

All new fasteners shall be high strength bolts. Holes shall be subpunched or subdrilled $\frac{1}{16}$ " dia. and reamed in the field to $\frac{13}{16}$ " dia. for $\frac{3}{4}$ " dia. bolts, unless otherwise noted. Holes shall be subpunched or subdrilled $\frac{13}{16}$ " dia. and reamed in the field to $\frac{15}{16}$ " dia. for $\frac{7}{8}$ " dia. bolts, unless otherwise noted.

All structural steel shall be AASHTO M 270 Grade 36, unless noted otherwise.

No field welding is permitted except as specified in the contract documents.

Plan dimensions and details relative to existing plans are subject to routine variations. The Contractor shall field verify existing dimensions and details affecting new construction and make necessary approved adjustments prior to construction or ordering of materials. Such variations shall not be cause for additional compensation for a change in scope of the work, however, the Contractor will be paid for the quantity actually furnished based upon the unit price bid for the work.

The existing structural steel coating contains lead. The Contractor shall take appropriate precautions to deal with the presence of lead on this project.

Work to be completed for this structure will require traffic control. Highway Standards 701201-02, 701400-02, & 701406-04 shall be used to complete the required construction.

Painting of drains to be completed under a separate paint only contract.

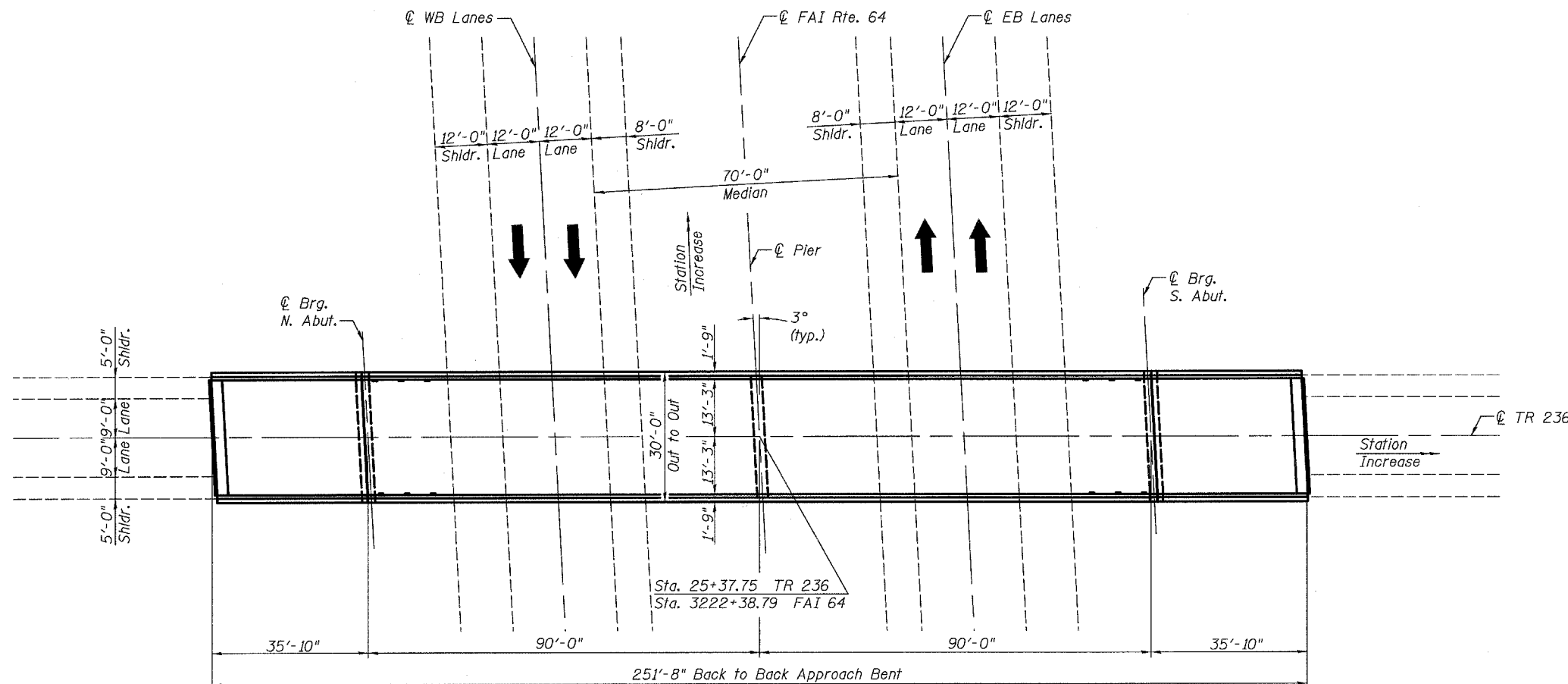

PLAN

TOTAL BILL OF MATERIAL

ITEM	UNIT	SUPER	SUB	TOTAL
Floor Drain Extension	Each	4	-	4
Plug Existing Deck Drains	Each	8	-	8
Silicone Joint Sealer, 1.5"	Foot	60	-	60
Slope Wall Crack Sealing	Foot	-	58	58
Traffic Control and Protection, Standard 701201	L Sum	1	-	1
Traffic Control and Protection, Standard 701406	L Sum	1	-	1

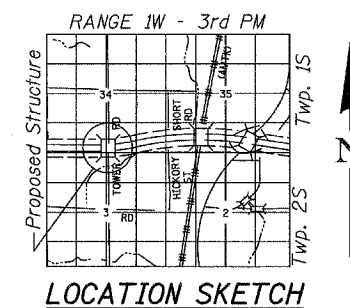

Plans Prepared By:
Oates Associates, Inc.

BRUCE P. SCHOPP
081-005155
COLLINSVILLE, ILLINOIS
STATE OF ILLINOIS

Bruce P. Schopp
8/24/07
EXP 11/30/08

GENERAL PLAN
TR 236 (TOWER ROAD) OVER
FAI 64
FAI ROUTE 64 SECTION 95-5HB-1
WASHINGTON COUNTY
STATION 3222+38.79
STRUCTURE NO. 095-0060