

F.A. RTE.	SECTION	COUNTY	TOTAL SHEETS	SHEET NO.
*	WILL	64	6	
STA. TO STA.				
FED. ROAD DIST. NO.	ILLINOIS FED. AID PROJECT			
02-11106-01-BR	CONTRACT NO. 83949			

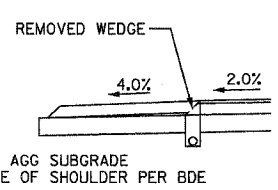
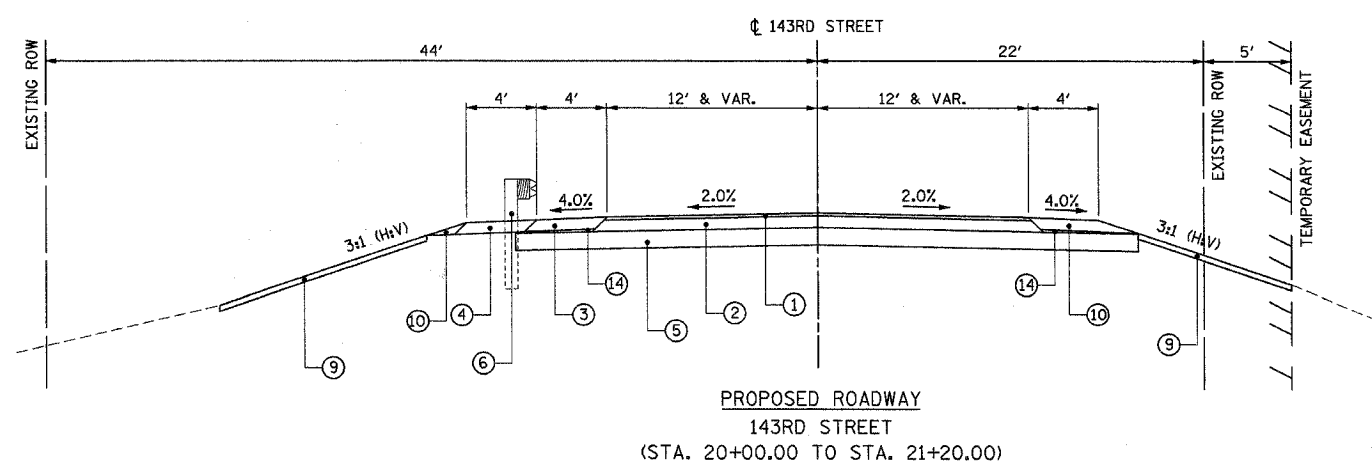
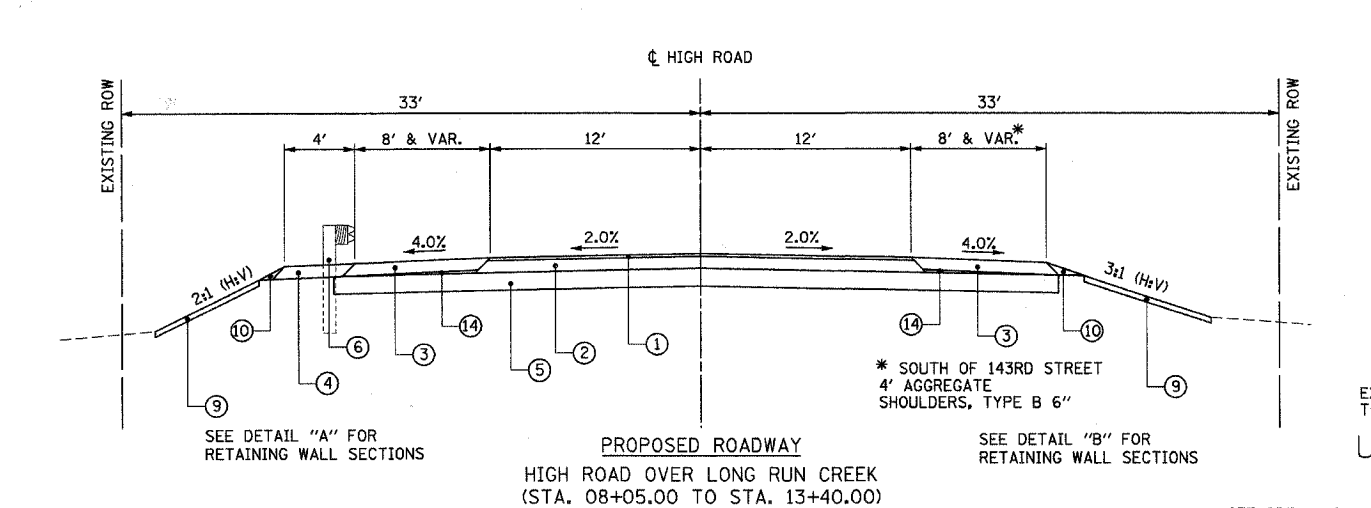
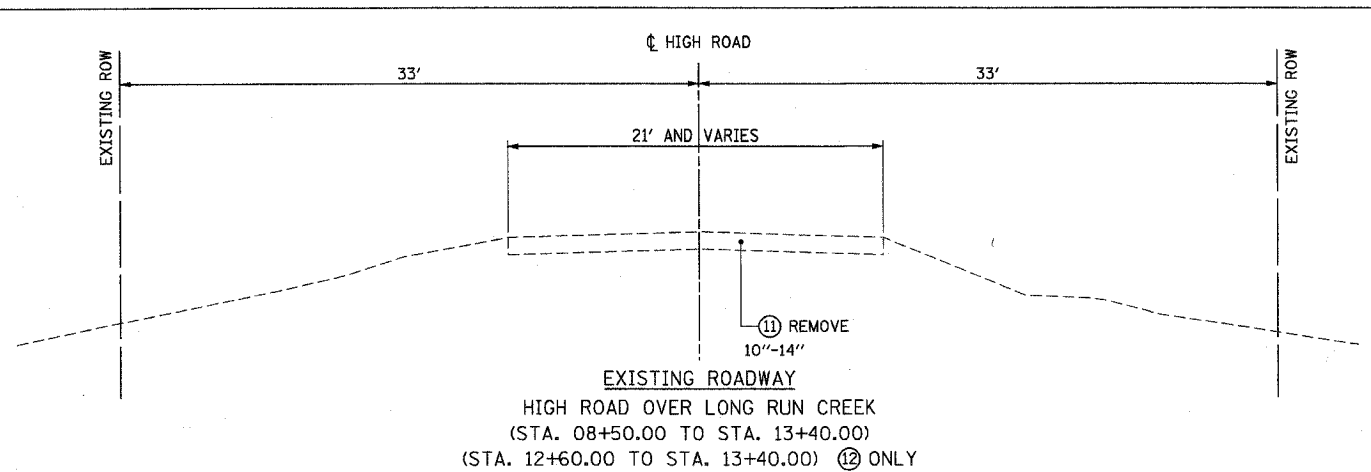

NOTES:
 1. SHOULDER TRANSITION FROM 4.0% TO 2.0% AT APPROACH PVMT. STA. 09+14.33 TO 09+46.33 & 10+68.67 TO 11+00.67 RT AND LT.
 2. FOR EXISTING AND PROPOSED HIGH ROAD BRIDGE AND APPROACH PAVEMENT TYPICAL SECTIONS, SEE STRUCTURAL SHEETS 17 TO 44.

MIXTURE TYPE	THICKNESS	AC TYPE	AIR VOIDS
HMA PAVEMENT (FULL-DEPTH), 10"			
HMA SURFACE COURSE, MIX "D", N50	IL 9.5MM	64-22	4% AT 50GYR
HMA BINDER COURSE, IL-19, N50, 8" (3 LIFTS)	8"	64-22/58-22 *	4% AT 50GYR
HOT-MIX ASPHALT SHOULDERS, 8"	8"	64-22/58-22 *	2% AT 30GYR
BITUMINOUS STABILIZATION 6" AT STEEL PLATE BEAM GUARDRAIL	6"	64-22/58-22 *	2% AT 30GYR
TEMPORARY PAVEMENT FULL DEPTH (NO SURFACE COURSE REQUIRED)			
HMA BINDER COURSE, IL-19, N50	6"	64-22/58-22 *	4% AT 50GYR
HMA SURFACE COURSE, MIX "D", N50 (RESURFACING)	IL 9.5MM	64-22	4% AT 50GYR
POLYMERIZED LEVELING BINDER (MACHINE METHOD), IL-4.75, N50	0.75"	64-22/58-22	4% AT 50GYR

THE UNIT WEIGHT USED TO CALCULATE ALL HMA SURFACE MIXTURE QUANTITIES IS 112 LBS/SQ YD/IN.
 *WHEN RAP EXCEEDS 20%, THE NEW ASPHALT BINDER IN THE MIX SHALL BE PG 58-22.

- LEGEND
- ① HOT-MIX ASPHALT SURFACE COURSE, MIX "D", N50 2"
 - ② HOT-MIX ASPHALT BINDER COURSE, IL-19.0, N50 8" (3 LIFTS)
 - ③ HOT-MIX ASPHALT SHOULDERS, 8"
 - ④ BITUMINOUS STABILIZATION 8" AT SPGR (PAID AS HMA SHOULDERS, 8" ADJACENT TO PROP HMA SHOULDER 8") OR BIT STAB 6" AT SPGR AS NOTED
 - ⑤ AGGREGATE SUBGRADE 12"
 - ⑥ STEEL PLATE BEAM GUARD RAIL, TYPE A
 - ⑦ CONCRETE STRUCTURES
 - ⑧ HOT-MIX ASPHALT SURFACE COURSE, MIX "D", N50 1.5"
 - ⑨ SEEDING, CLASS 4 & 5A COMPOST FURNISH AND PLACE 2"
 - ⑩ AGGREGATE SHOULDERS, TYPE B 6"
 - ⑪ EXISTING PAVEMENT
 - ⑫ HOT-MIX ASPHALT SURFACE REMOVAL, 1.5"
 - ⑬ POLYMERIZED LEVELING BINDER (MM), IL-4.75, N50
 - ⑭ SUBBASE GRANULAR MATERIAL, TYPE C

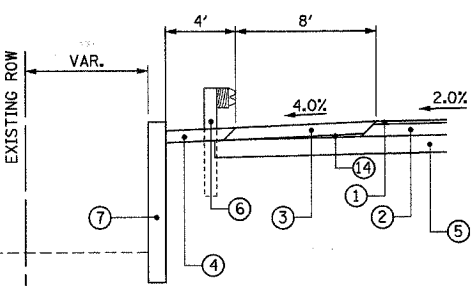

DETAIL A
 S.W. CORNER OF THE BRIDGE
 (STA. 08+45.83 TO STA. 09+79.00 LT)
 N.W. CORNER OF THE BRIDGE
 (STA. 10+36.00 TO STA. 10+69.17 LT)

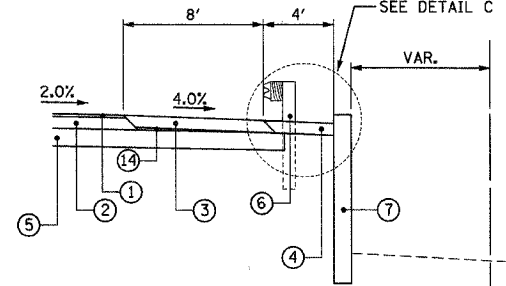

DETAIL B
 S.E. CORNER OF THE BRIDGE
 (STA. 09+20.83 TO STA. 09+79.00 RT)
 N.E. CORNER OF THE BRIDGE
 (STA. 10+36.00 TO STA. 12+19.17 RT)

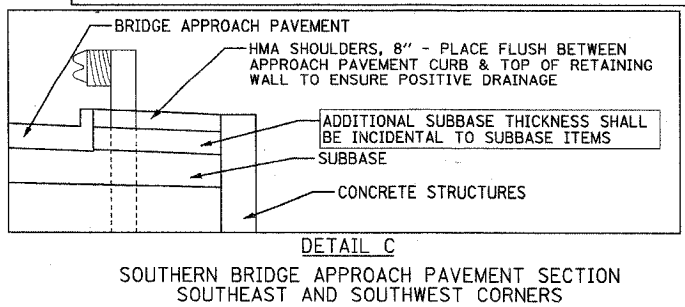
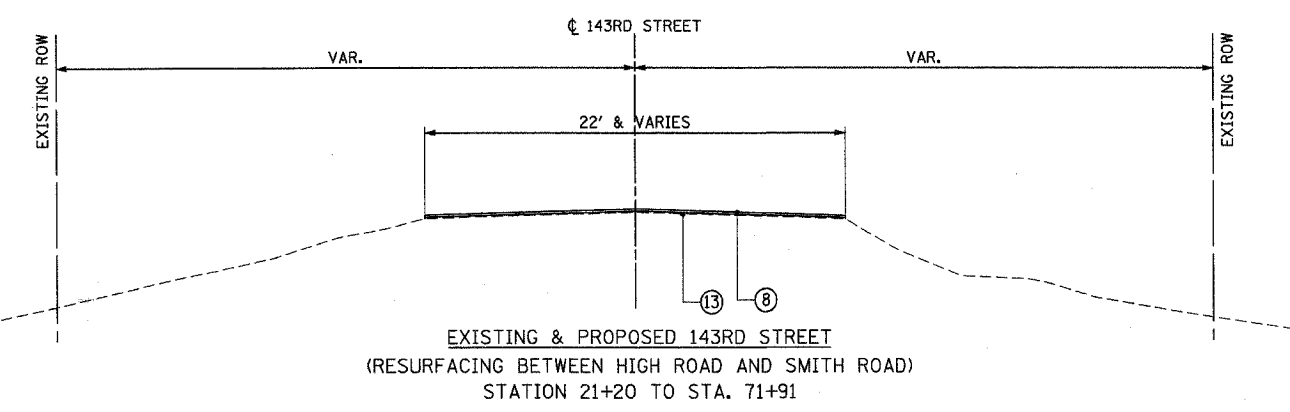

NAME	DATE

LOCKPORT TOWNSHIP HIGHWAY DEPARTMENT
 TR216A HIGH ROAD OVER LONG RUN CREEK
 SECTION 02-11106-01-BR
**TYPICAL SECTIONS
 HIGH ROAD &
 143RD STREET**
 SCALE: N/A
 DATE: 9-07-2007
 DRAWN BY: JB
 CHECKED BY: ACL
TENG

ATTORNEYS: DONALDSON, YSCORRE, DONALDSON, BROWNE & DONALDSON, INC.
 2015 SOUTH 203RD ST
 SUITE 100
 WILMINGTON, IL 62201
 TEL: 618-696-1100
 FAX: 618-696-1101
 WWW.DONALDSON-YS-CORRE.COM