

F.A. RTE.	SECTION	COUNTY	TOTAL SHEETS	SHEET NO.
			64	53
STA.		TO STA.		
FED. ROAD DIST. NO.		ILLINOIS FED. AID PROJECT		

**ROUTE MARKERS**

FOR U.S. ROUTES MI-40-2424

FOR ILLINOIS ROUTES MI-50-2424

R.R. UNMARKED ROUTES SPECIAL 24" x 18" VARIABLE 4" BLACK LETTERS ON WHITE REFLECTIVE BACKGROUND

**ARROWS SIGNS**

M5-1L-2115

M5-1R-2115

M6-1L-2115

M6-1R-2115

M6-3-2115

**CARDINAL DIRECTION & DETOUR SIGNS**

NORTH M3-1-219

EAST M3-2-219

SOUTH M3-3-219

WEST M3-4-219

DETOUR MI-7-219

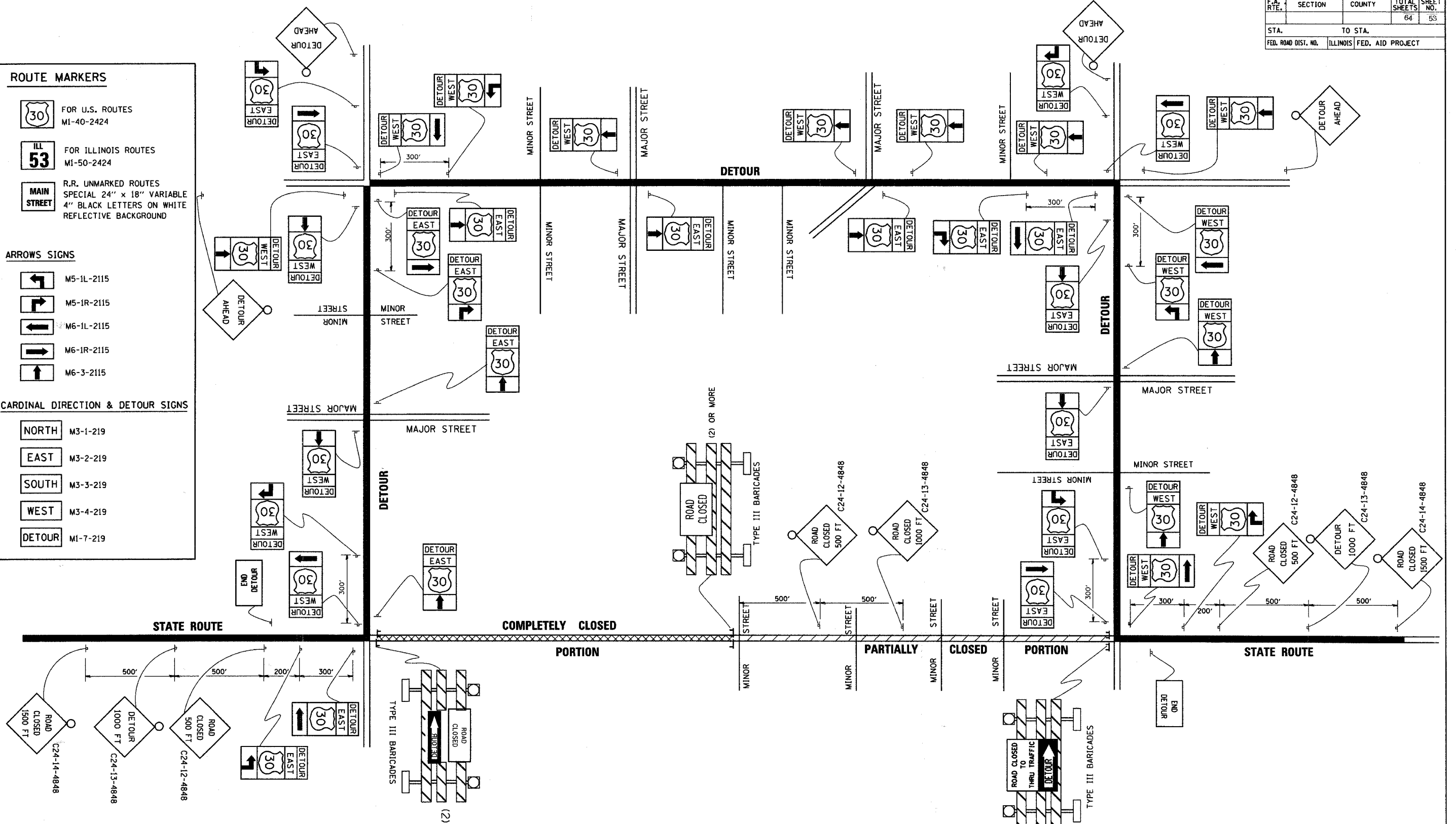

REVISIONS	
NAME	DATE
	10/18/02

ILLINOIS DEPARTMENT OF TRANSPORTATION

**TYPICAL MARKING FOR CLOSING STATE HIGHWAYS**

SCALE: NONE

DRAWN BY \_\_\_\_\_  
CHECKED BY \_\_\_\_\_

PLOT DATE = 3/7/2007  
FILE NAME = K:\databases\c21.dwg  
PLOT SCALE = 68.88888 / IN.  
USER NAME = bward-d