

CONTRACT NO. 83962

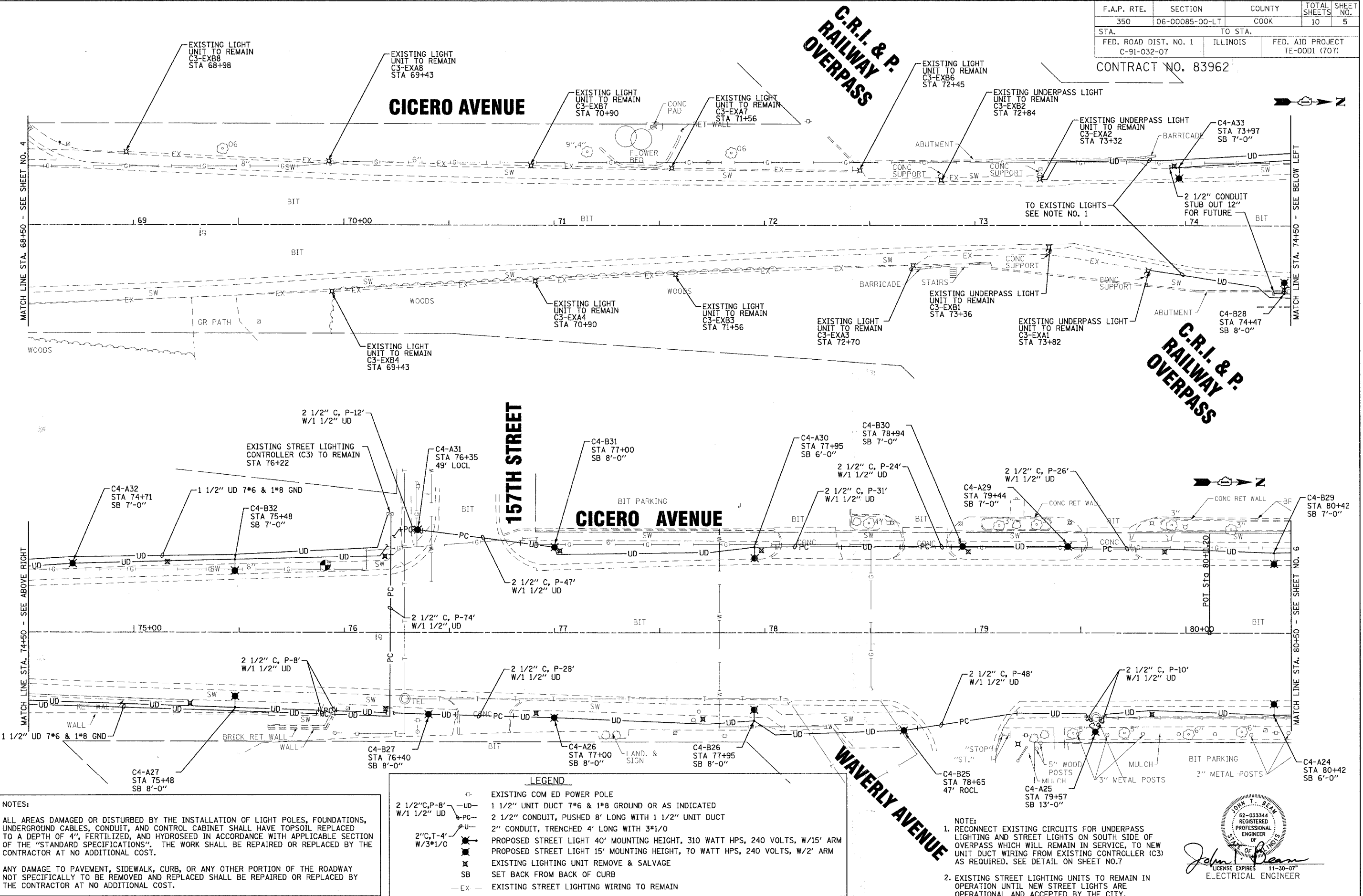

NOTES:

ALL AREAS DAMAGED OR DISTURBED BY THE INSTALLATION OF LIGHT POLES, FOUNDATIONS, UNDERGROUND CABLES, CONDUIT, AND CONTROL CABINET SHALL HAVE TOPSOIL REPLACED TO A DEPTH OF 4", FERTILIZED, AND HYDROSEED IN ACCORDANCE WITH APPLICABLE SECTION OF THE "STANDARD SPECIFICATIONS". THE WORK SHALL BE REPAIRED OR REPLACED BY THE CONTRACTOR AT NO ADDITIONAL COST.

ANY DAMAGE TO PAVEMENT, SIDEWALK, CURB, OR ANY OTHER PORTION OF THE ROADWAY NOT SPECIFICALLY TO BE REMOVED AND REPLACED SHALL BE REPAIRED OR REPLACED BY THE CONTRACTOR AT NO ADDITIONAL COST.

LEGEND

	EXISTING COM ED POWER POLE
	2 1/2" CONDUIT, PUSHED 8' LONG WITH 1 1/2" UNIT DUCT
	2" CONDUIT, TRENCHED 4' LONG WITH 3#1/0
	PROPOSED STREET LIGHT 40' MOUNTING HEIGHT, 310 WATT HPS, 240 VOLTS, W/15' ARM
	PROPOSED STREET LIGHT 15' MOUNTING HEIGHT, 70 WATT HPS, 240 VOLTS, W/2' ARM
	EXISTING LIGHTING UNIT REMOVE & SALVAGE
	SET BACK FROM BACK OF CURB
	EXISTING STREET LIGHTING WIRING TO REMAIN

NOTE:

- RECONNECT EXISTING CIRCUITS FOR UNDERPASS LIGHTING AND STREET LIGHTS ON SOUTH SIDE OF OVERPASS WHICH WILL REMAIN IN SERVICE, TO NEW UNIT DUCT WIRING FROM EXISTING CONTROLLER (C3) AS REQUIRED. SEE DETAIL ON SHEET NO.7
- EXISTING STREET LIGHTING UNITS TO REMAIN IN OPERATION UNTIL NEW STREET LIGHTS ARE OPERATIONAL AND ACCEPTED BY THE CITY.

John J. Beam
 LICENSE EXPIRES 11-30-07
 ELECTRICAL ENGINEER

COPYRIGHT © 2007, BY BAXTER & WOODMAN, INC.
 STATE OF ILLINOIS PROFESSIONAL DESIGN FIRM
 No. 021-000000-0000-0000-0000-0000-0000-0000-0000-0000-0000-0000
 9/17/2007

CONSULTANTS	REV. NO.	DATE	DESCRIPTION

* REFER TO EQUIPMENT MANUFACTURER'S SHOP DRAWINGS

DRAWING FILE: \$FILEA\$

BAXTER & WOODMAN
 Consulting Engineers

Baxter & Woodman
 815.459.1260
 Crystal Lake, Illinois
 Inca, Illinois
 Burlington, Wisconsin
 Mokena, Illinois
 DeKalb, Illinois
 Graylake, Illinois
 Rockford, Illinois
 Plainfield, Illinois
 630.773.1870
 262.762.7824
 708.478.3090
 815.787.8111
 847.233.5088
 815.489.1551
 815.609.7425

CITY OF OAK FOREST, ILLINOIS
FAP 350 CICERO AVENUE IMPROVEMENTS
(157TH ST. TO 159TH ST.)

STREET LIGHTING PLAN
CICERO AVENUE
STA 68+50 TO STA 80+50

DESIGNED BY	SCALE
JLR	1"=20'
DRAWN BY	PROJECT NO.
MAC	060467
CHECKED BY	SHEET NO.
JTB	
DATE	
06/21/07	5 OF 10