

FILE	SECTION	COUNTY	TOTAL SHEETS	SHEET NO.
2744	06-00241-00-PV	COOK	115	70
STA. 170+00		TO STA. 175+00		
LANDS		SURFACE TRANSPORTATION FUNDING		
CONTRACT NUMBER 83968				

RIDGE AVENUE
MATCH LINE STA. 175+00
(SEE SHEET NO. 71)

EXISTING RIDGE AVENUE

RIDGE AVENUE
MATCH LINE STA. 175+00
(SEE SHEET NO. 71)

PROPOSED RIDGE AVENUE

RIDGE AVENUE
MATCH LINE STA. 175+00
(SEE SHEET NO. 71)

CITY OF EVANSTON
ROADWAY GRADING PLAN
RIDGE AVENUE IMPROVEMENTS
STA. 170+00 to 175+00

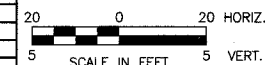

DATE: 8/31/2007
DESIGNED BY: RTM
TECHNICIAN: JRR
CHECKED BY: JRV

REVISIONS	
NAME	DATE
PREFINAL REVIEW	05.18.07

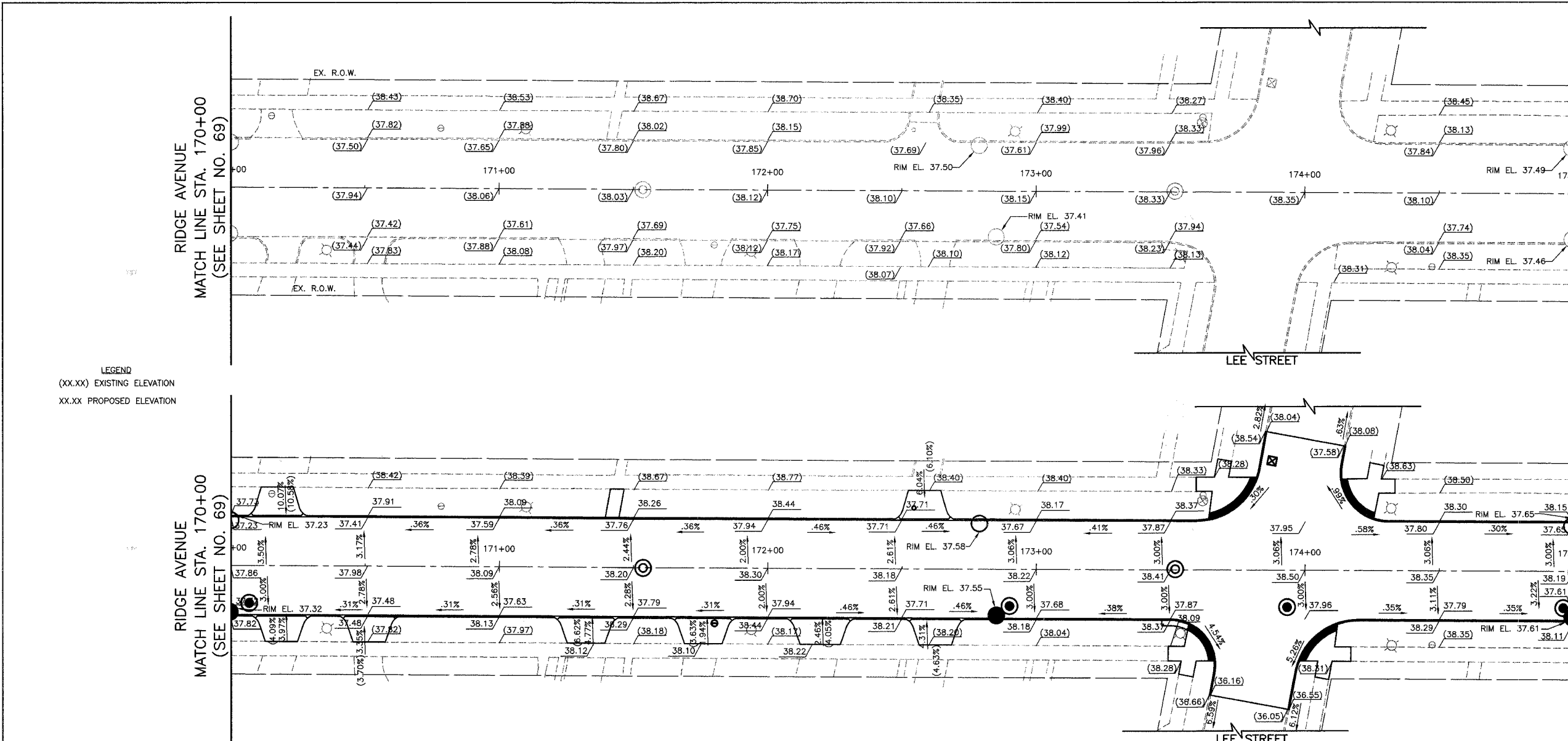

LEGEND
(XX.XX) EXISTING ELEVATION
XX.XX PROPOSED ELEVATION

