

Section
99-00215-00-TL
Sheet 16

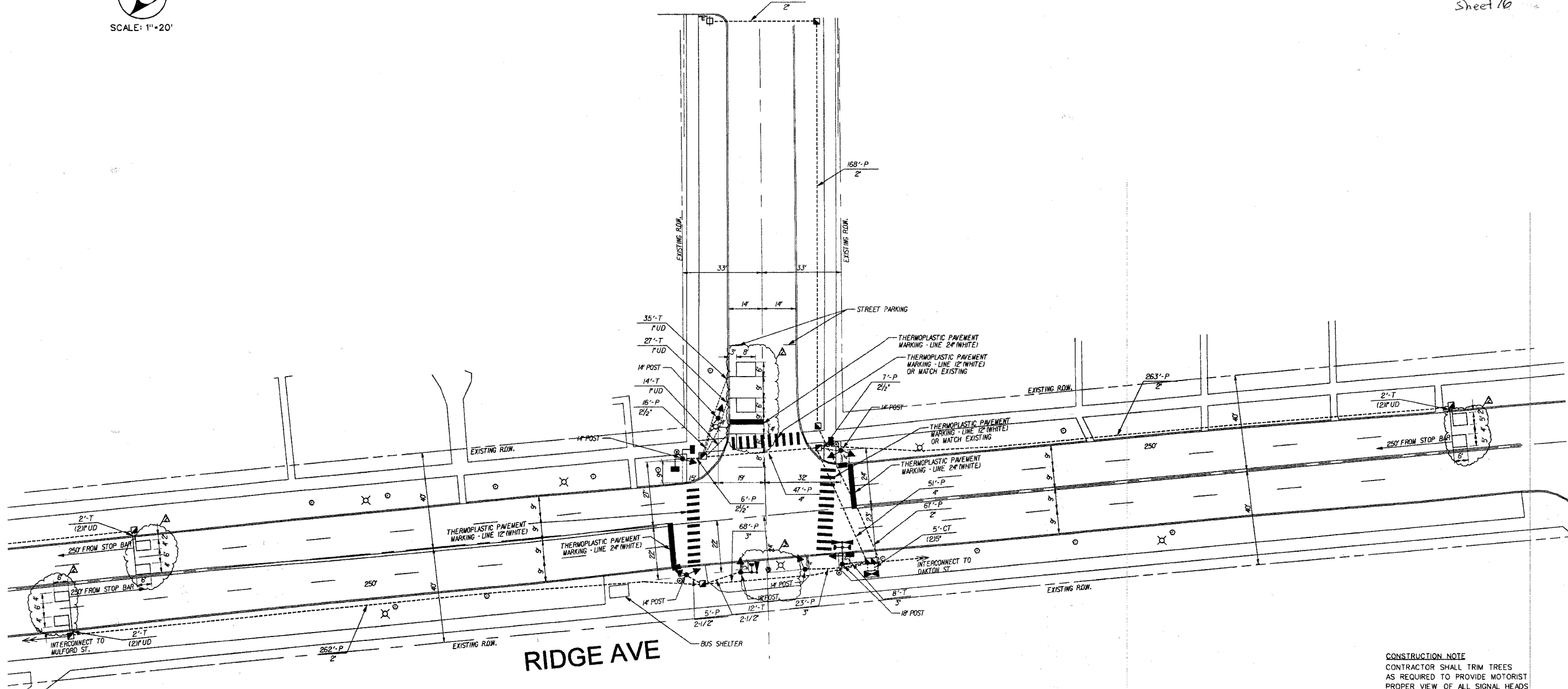

HULL TERRACE



RIDGE AVE

TRAFFIC SIGNAL LEGEND

	PROPOSED	EXISTING		PROPOSED	EXISTING
CONTROLLER	[Symbol]	[Symbol]	G.S. CONDUIT IN TRENCH OR PUSHED	[Symbol]	[Symbol]
SERVICE INSTALLATION	[Symbol]	[Symbol]	PEDESTRIAN PUSHBUTTON DETECTOR	[Symbol]	[Symbol]
SIGNAL HEAD	[Symbol]	[Symbol]	DETECTOR LOOP	[Symbol]	[Symbol]
SIGNAL HEAD WITH BACKPLATE	[Symbol]	[Symbol]	CAST IRON JUNCTION BOX	[Symbol]	[Symbol]
SIGNAL HEAD, PEDESTRIAN	[Symbol]	[Symbol]	EMERGENCY VEHICLE SYSTEM DETECTOR	[Symbol]	[Symbol]
SIGNAL POST	[Symbol]	[Symbol]	CONFIRMATION BEACON	[Symbol]	[Symbol]
MAST ARM ASSEMBLY AND POLE, STEEL	[Symbol]	[Symbol]	SIGNAL HEAD OPTICALLY PROGRAMMED	[Symbol]	[Symbol]
MAST ARM ASSEMBLY AND POLE, ALUMINUM	[Symbol]	[Symbol]	CONDUIT SPLICE	[Symbol]	[Symbol]
COMMON TRENCH	CT	[Symbol]	WOOD POLE	[Symbol]	[Symbol]
UNIT DUCT	UD	[Symbol]	RACEWAY FOR MAGNETIC DETECTOR, TYPE I OR TYPE II	[Symbol]	[Symbol]
HANDHOLE	[Symbol]	[Symbol]	VEHICLE DETECTOR, NON COMPENSATED	[Symbol]	[Symbol]
HEAVY DUTY HANDHOLE	[Symbol]	[Symbol]	MAGNETIC TYPE	[Symbol]	[Symbol]
DOUBLE HANDHOLE	[Symbol]	[Symbol]	RAILROAD CONTROL CABINET	[Symbol]	[Symbol]
			STREET LIGHT	[Symbol]	[Symbol]



5" X 8"

LOCATE AT EACH PEDESTRIAN BUTTON
4 REQUIRED
(INCIDENTAL TO CONTRACT)

GENERAL NOTE: SIGNAL HEADS SHALL CONTAIN L.E.D. MODULES FOR THE RED, YELLOW, GREEN BALL AND ARROW INDICATIONS. PEDESTRIAN HEADS SHALL CONTAIN 16" L.E.D. SIDE-BY-SIDE INTERNATIONAL SYMBOL INDICATIONS.

CONSTRUCTION NOTE
CONTRACTOR SHALL TRIM TREES AS REQUIRED TO PROVIDE MOTORIST PROPER VIEW OF ALL SIGNAL HEADS AND EMERGENCY VEHICLE PREEMPTION EQUIPMENT. THIS WORK SHALL BE INCIDENTAL TO THE CONTRACT.

TRAFFIC SIGNAL INSTALLATION PLAN

RIDGE AVE. @ HULL TERRACE
EVANSTON, ILLINOIS

CITY OF EVANSTON
16_spr.dgn

T16

SCALE: 1"=20'
DATE: APRIL 28, 2006
RAWN BY: DWS
CHECKED BY: PAW

REVISIONS		
NO.	DATE	DESCRIPTION
1	06-08-06	MISCELLANEOUS REVISION
2	11-15-06	DETECTOR LOOPS AND SYSTEM DETECTOR LOOPS TO BE INSTALLED BY OTHERS AT A LATER DATE
3	11-15-06	EVP REVISIONS