

SCHEDULE OF QUANTITIES

QTY	UNIT	ITEM DESCRIPTION
316	FOOT	THERMOPLASTIC PAVEMENT MARKING-LINE 6"
74	FOOT	THERMOPLASTIC PAVEMENT MARKING-LINE 24"
1	EACH	SERVICE INSTALLATION, POLE MOUNTED
11	FOOT	CONDUIT IN TRENCH, 2 1/2" DIA., GALVANIZED STEEL
18	FOOT	CONDUIT IN TRENCH, 3" DIA., GALVANIZED STEEL
10	FOOT	CONDUIT IN TRENCH, 5" DIA., GALVANIZED STEEL
742	FOOT	CONDUIT PUSHED, 2" DIA., GALVANIZED STEEL
37	FOOT	CONDUIT PUSHED, 2 1/2" DIA., GALVANIZED STEEL
207	FOOT	CONDUIT PUSHED, 4" DIA., GALVANIZED STEEL
6	EACH	HANDHOLE
1	EACH	HEAVY-DUTY HANDHOLE
1	EACH	DOUBLE HANDHOLE
39	FOOT	TRENCH AND BACKFILL FOR ELECTRICAL WORK
1	EACH	FULL-ACTUATED CONTROLLER AND TYPE IV CABINET, SPECIAL
1	EACH	TRANSCIVER - FIBER OPTIC
610	FOOT	ELECTRIC CABLE IN CONDUIT, GROUNDING, NO. 8 1/C
813	FOOT	ELECTRIC CABLE IN CONDUIT, SIGNAL NO. 14 2C
1460	FOOT	ELECTRIC CABLE IN CONDUIT, SIGNAL NO. 14 3C
1491	FOOT	ELECTRIC CABLE IN CONDUIT, SIGNAL NO. 14 5C
849	FOOT	ELECTRIC CABLE IN CONDUIT, LEAD-IN, NO. 14 1 PAIR
497	FOOT	ELECTRIC CABLE IN CONDUIT, NO. 20 3/C, TWISTED, SHIELDED
271	FOOT	ELECTRIC CABLE IN CONDUIT, SERVICE, NO. 8 2C
2	EACH	TRAFFIC SIGNAL POST, GALVANIZED STEEL 14 FT.
4	EACH	TRAFFIC SIGNAL POST, GALVANIZED STEEL 18 FT.
24	FOOT	CONCRETE FOUNDATION, TYPE A
4	FOOT	CONCRETE FOUNDATION, TYPE D
2	EACH	SIGNAL HEAD, LED, 1-FACE, 3-SECTION, BRACKET MOUNTED
4	EACH	PEDESTRIAN SIGNAL HEAD, LED, 1-FACE, BRACKET MOUNTED
4	EACH	INDUCTIVE LOOP DETECTOR
360	FOOT	DETECTOR LOOP, TYPE 1
2	EACH	LIGHT DETECTOR
1	EACH	LIGHT DETECTOR AMPLIFIER
6	EACH	PEDESTRIAN PUSH-BUTTON
1	EACH	TEMPORARY TRAFFIC SIGNAL INSTALLATION
1	EACH	REMOVE EXISTING TRAFFIC SIGNAL EQUIPMENT
3	EACH	REMOVE EXISTING HANDHOLE
5	EACH	REMOVE EXISTING CONCRETE FOUNDATION
2	EACH	SIGNAL HEAD, LED, 2-FACE, 3-SECTION, BRACKET MOUNTED
2	EACH	SIGNAL HEAD, LED, 3-FACE, 3-SECTION, BRACKET MOUNTED
2	EACH	PEDESTRIAN SIGNAL HEAD, LED, 2-FACE, BRACKET MOUNTED
1	EACH	REMOVE EXISTING SERVICE INSTALLATION

CABLE PLAN LEGEND

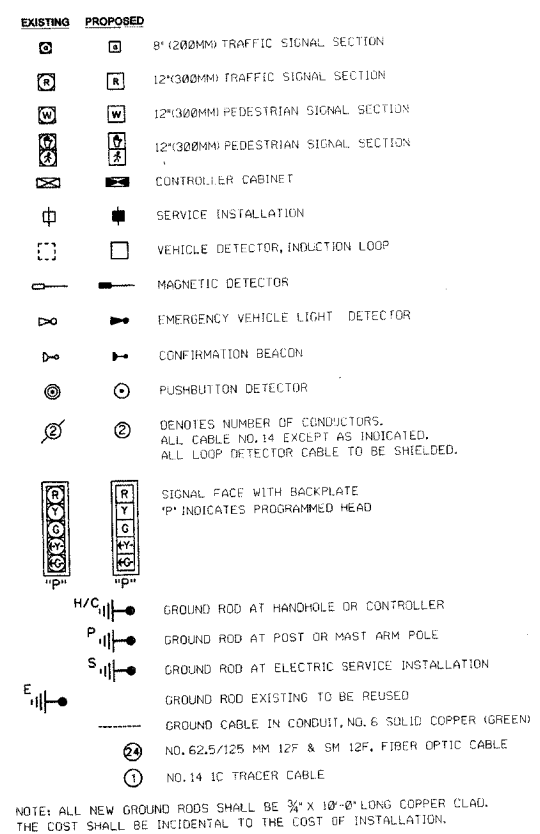

PROPOSED CABLE PLAN

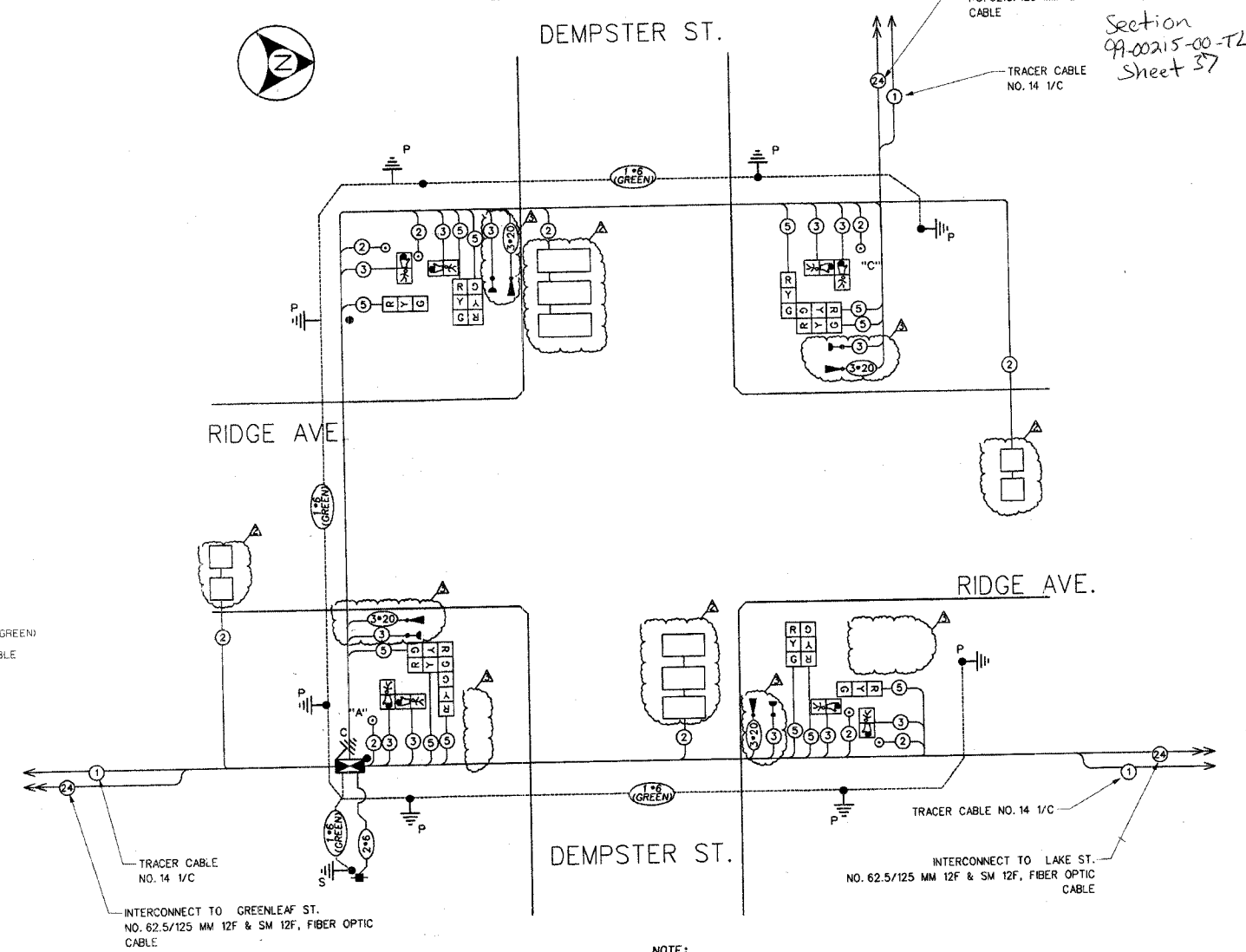

THE TRAFFIC SIGNAL CONTROL EQUIPMENT FOR THIS PROJECT SHALL BE "EAGLE" TO MATCH THE EXISTING ADJACENT SYSTEM.

PROPOSED CONTROLLER SEQUENCE

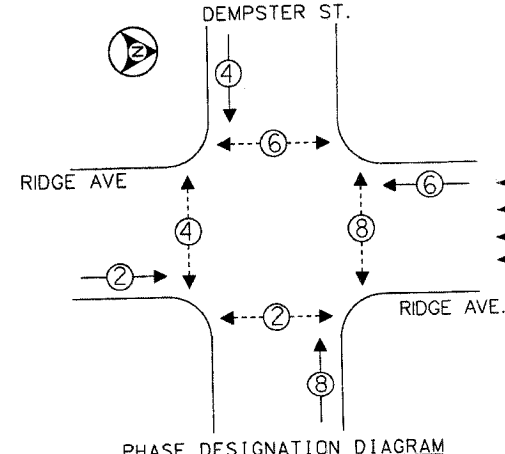

LEGEND

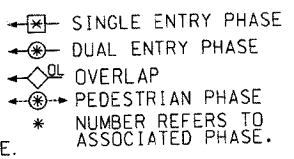

PHASE DESIGNATION DIAGRAM

PROPOSED EMERGENCY VEHICLE PREEMPTION SEQUENCE

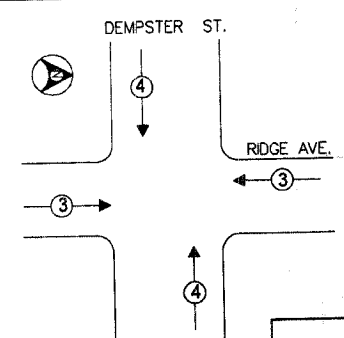

EMERGENCY VEHICLE PREEMPTOR	3	4
MOVEMENT	←→	↑↓

I.D.O.T. TRAFFIC SIGNAL INSTALLATION ELECTRICAL SERVICE REQUIREMENTS					TOTAL WATTAGE
TYPE	NO. OF LAMPS	INCAND	LED XX OPERATIONS	WATTAGE	
SIGNAL (RED)	12	135	17	0.50	102
(YELLOW)	12	135	25	0.25	75
(GREEN)	12	135	15	0.25	45
ARROW					
PED. SIGNAL	8	90	25	1.00	200
CONTROLLER	1	100	100	1.00	100
ILLUM. SIGN	4	84	25	1.00	100
FLASHER				0.50	
TOTAL =					622

ENERGY COSTS - BILLED TO: CITY OF EVANSTON (ADDRESS)

ENERGY SUPPLY - CONTACT: MIKE LYNCH PHONE: (847) 291-3329 COMPANY: COMED

FOUNDATION (DEPTH)	(FT.)	CABLE SLACK	(FT.)	VERTICAL	(FT.)
TYPE A - POST	4	HANDHOLE	6.5	ALL FOUNDATIONS	3.5
D - CONTROLLER	4	DOUBLE HANDHOLE	13	MAST ARM (L) POLE	20'+L-2 =
E - M ARM POLE		SIGNAL POST	2	BRACKET MOUNTED	13
24"	10	CONTROLLER CAB.	1	PEDE. PUSHBUTTON	4
30"	15	FIBER OPTIC	13	ELECTRIC SERVICE	13.5
		ELECTRIC SERVICE	1	SERVICE TO GROUND	13.5
		GROUND CABLE	1	POST MOUNTED	6

NO.	DATE	DESCRIPTION
Δ	06-08-06	MISCELLANEOUS REVISION
Δ	11-15-06	DETECTOR LOOPS AND SYSTEM DETECTOR LOOPS TO BE INSTALLED BY OTHERS AT A LATER DATE
Δ	11-15-06	EVP REVISIONS

CABLE PLAN, PHASE DESIGNATION DIAGRAM AND SCHEDULE OF QUANTITIES

RIDGE AVE. @ DEMPSTER ST. EVANSTON, ILLINOIS

CITY OF EVANSTON
37-op.dgn
T37
SCALE: NOT TO SCALE
DATE: APRIL 28, 2006
DRAWN BY: DWS
CHECKED BY: PAW