

Section
99.00215-00-TL
Sheet 41

SCHEDULE OF QUANTITIES

QTY	UNIT	ITEM DESCRIPTION
288	FOOT	THERMOPLASTIC PAVEMENT MARKING-LINE 6"
78	FOOT	THERMOPLASTIC PAVEMENT MARKING-LINE 24"
1	EACH	SERVICE INSTALLATION, POLE MOUNTED
5	FOOT	CONDUIT IN TRENCH, 2 1/2" DIA., GALVANIZED STEEL
7	FOOT	CONDUIT IN TRENCH, 3" DIA., GALVANIZED STEEL
10	FOOT	CONDUIT IN TRENCH, 5" DIA., GALVANIZED STEEL
871	FOOT	CONDUIT PUSHED, 2" DIA., GALVANIZED STEEL
14	FOOT	CONDUIT PUSHED, 3" DIA., GALVANIZED STEEL
182	FOOT	CONDUIT PUSHED, 4" DIA., GALVANIZED STEEL
7	EACH	HANDHOLE
1	EACH	DOUBLE HANDHOLE
22	FOOT	TRENCH AND BACKFILL FOR ELECTRICAL WORK
1	EACH	FULL-ACTUATED CONTROLLER AND TYPE IV CABINET, SPECIAL
1	EACH	TRANSCEIVER - FIBER OPTIC
546	FOOT	ELECTRIC CABLE IN CONDUIT, GROUNDING, NO. 6 1C
371	FOOT	ELECTRIC CABLE IN CONDUIT, SIGNAL NO. 14 2C
1289	FOOT	ELECTRIC CABLE IN CONDUIT, SIGNAL NO. 14 3C
7247	FOOT	ELECTRIC CABLE IN CONDUIT, SIGNAL NO. 14 5C
1549	FOOT	ELECTRIC CABLE IN CONDUIT, LEAD-IN, NO. 14 1 PAIR
603	FOOT	ELECTRIC CABLE IN CONDUIT, NO. 20 3/C, TWISTED, SHIELDED
204	FOOT	ELECTRIC CABLE IN CONDUIT, SERVICE, NO. 6 2C
1	EACH	TRAFFIC SIGNAL POST, GALVANIZED STEEL 14 FT.
1	EACH	TRAFFIC SIGNAL POST, GALVANIZED STEEL 16 FT.
1	EACH	TRAFFIC SIGNAL POST, GALVANIZED STEEL 18 FT.
16	FOOT	CONCRETE FOUNDATION, TYPE A
4	FOOT	CONCRETE FOUNDATION, TYPE D
7	EACH	INDUCTIVE LOOP DETECTOR
643	FOOT	DETECTOR LOOP, TYPE L
2	EACH	LIGHT DETECTOR
1	EACH	LIGHT DETECTOR AMPLIFIER
4	EACH	PEDESTRIAN PUSH-BUTTON
1	EACH	TEMPORARY TRAFFIC SIGNAL INSTALLATION
1	EACH	REMOVE EXISTING TRAFFIC SIGNAL EQUIPMENT
2	EACH	REMOVE EXISTING HANDHOLE
4	EACH	REMOVE EXISTING CONCRETE FOUNDATION
4	EACH	SIGNAL HEAD, LED, 3-FACE, 3-SECTION, BRACKET MOUNTED
4	EACH	PEDESTRIAN SIGNAL HEAD, LED, 2-FACE, BRACKET MOUNTED
1	EACH	REMOVE EXISTING SERVICE INSTALLATION

THE TRAFFIC SIGNAL CONTROL EQUIPMENT FOR THIS PROJECT SHALL BE "EAGLE" TO MATCH THE EXISTING ADJACENT SYSTEM.

CABLE PLAN LEGEND

EXISTING	PROPOSED	DESCRIPTION
□	□	8"(200MM) TRAFFIC SIGNAL SECTION
□	□	12"(300MM) TRAFFIC SIGNAL SECTION
□	□	12"(300MM) PEDESTRIAN SIGNAL SECTION
□	□	12"(300MM) PEDESTRIAN SIGNAL SECTION
□	□	CONTROLLER CABINET
□	□	SERVICE INSTALLATION
□	□	VEHICLE DETECTOR, INDUCTION LOOP
□	□	MAGNETIC DETECTOR
□	□	EMERGENCY VEHICLE LIGHT DETECTOR
□	□	CONFIRMATION BEACON
□	□	PUSHBUTTON DETECTOR
②	②	② DENOTES NUMBER OF CONDUCTORS. ALL CABLE NO. 14 EXCEPT AS INDICATED. ALL LOOP DETECTOR CABLE TO BE SHIELDED.
□	□	SIGNAL FACE WITH BACKPLATE
□	□	*P INDICATES PROGRAMMED HEAD
H/C		GROUND ROD AT HANDHOLE OR CONTROLLER
P		GROUND ROD AT POST OR MAST ARM POLE
S		GROUND ROD AT ELECTRIC SERVICE INSTALLATION
E		GROUND ROD EXISTING TO BE REUSED
---	---	GROUND CABLE IN CONDUIT, NO. 6 SOLID COPPER (GREEN)
②	②	NO. 62.5/125 MM 12F & SM 12F, FIBER OPTIC CABLE
①	①	NO. 14 1C TRACER CABLE

NOTE: ALL NEW GROUND RODS SHALL BE 3/4" X 10'-0" LONG COPPER CLAD. THE COST SHALL BE INCIDENTAL TO THE COST OF INSTALLATION.

PROPOSED CABLE PLAN

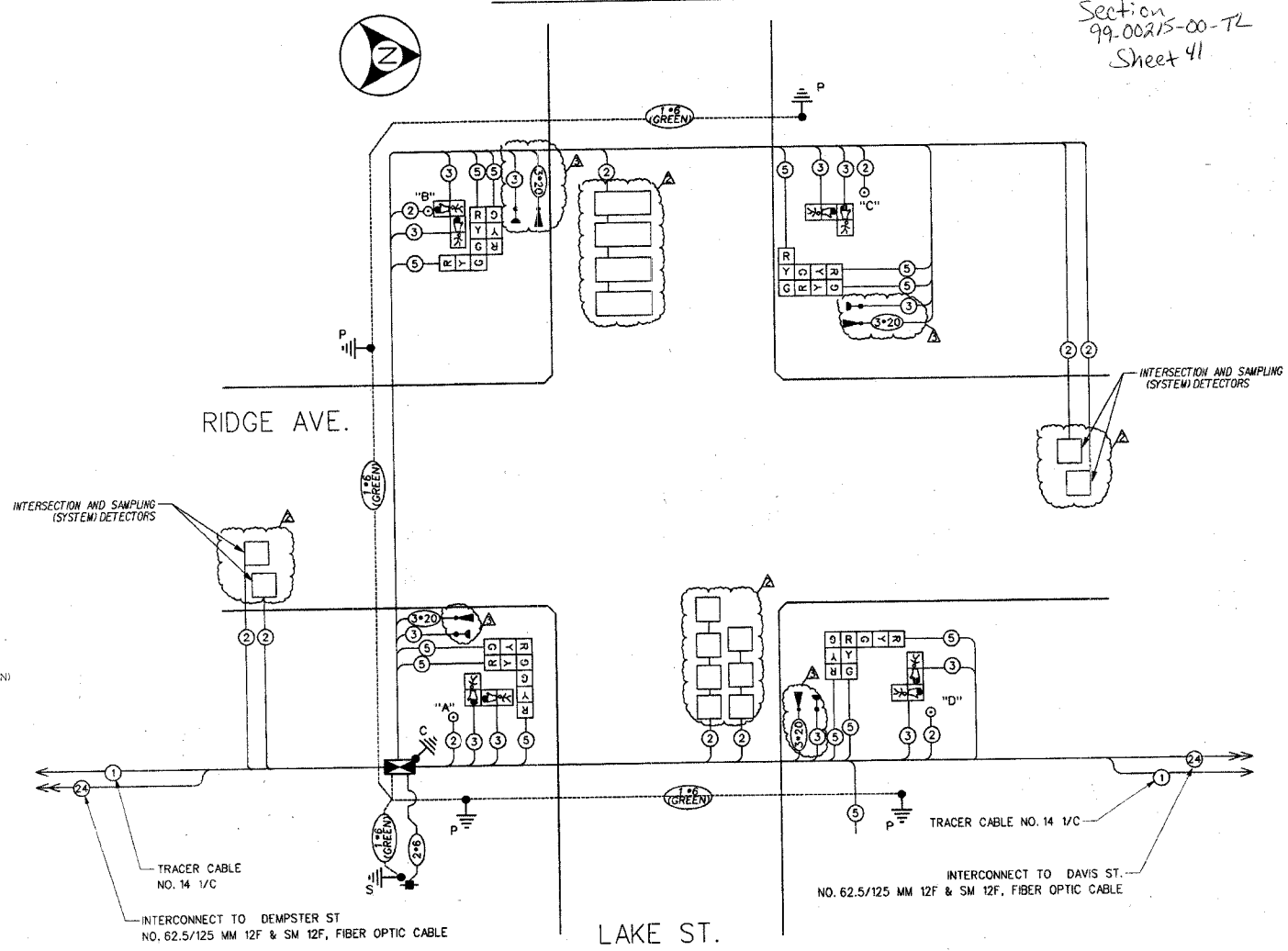

- NOTE:
- PUSH BUTTON "A" SHALL PLACE A CALL IN PHASES 2 AND 4
 - PUSH BUTTON "B" SHALL PLACE A CALL IN PHASES 4 AND 6
 - PUSH BUTTON "C" SHALL PLACE A CALL IN PHASES 6 AND 8
 - PUSH BUTTON "D" SHALL PLACE A CALL IN PHASES 2 AND 8

PROPOSED CONTROLLER SEQUENCE

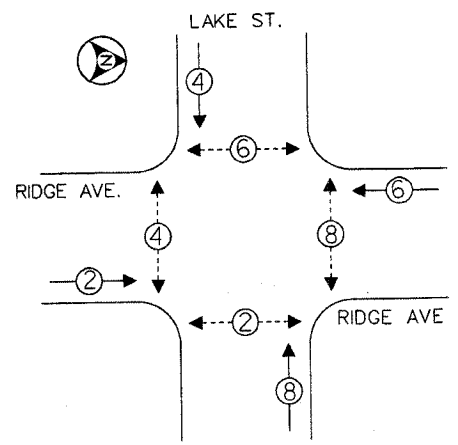

LEGEND

- SINGLE ENTRY PHASE
- DUAL ENTRY PHASE
- OVERLAP
- PEDESTRIAN PHASE
- * NUMBER REFERS TO ASSOCIATED PHASE.

PHASE DESIGNATION DIAGRAM

RESTORATION OF WORK AREA. RESTORATION OF THE TRAFFIC SIGNAL WORK AREA SHALL BE INCIDENTAL TO THE RELATED PAY ITEM SUCH AS FOUNDATION, CONDUIT, HANDHOLE, TRENCH, AND BACKFILL, ETC., AND NO EXTRA COMPENSATION SHALL BE ALLOWED. ALL ROADWAYS SURFACES SUCH AS SHOULDERS, MEDIAN, SIDEWALKS, PAVEMENT, ETC. SHALL BE REPLACED IN KIND. ALL DAMAGE TO MOVED LAWNS SHALL BE REPLACED WITH AN APPROVED SOD, AND ALL DAMAGE TO UNMOVED FIELDS SHALL BE SEEDED IN ACCORDANCE WITH STANDARD SPECIFICATIONS 252 AND 250 RESPECTIVELY.

FOUNDATION (DEPTH)	(FT.)	CABLE SLACK	(FT.)	VERTICAL	(FT.)
TYPE A - POST	4	HANDHOLE	6.5	ALL FOUNDATIONS	3.5
D - CONTROLLER	4	DOUBLE HANDHOLE	13	MAST ARM (L) POLE	20'+L-2 =
E - M ARM POLE		SIGNAL POST	2	BRACKET MOUNTED	13
24"	10	CONTROLLER CAB.	1	PED. PUSHBUTTON	4
30"	15	FIBER OPTIC	13	ELECTRIC SERVICE	13.5
		ELECTRIC SERVICE	1	SERVICE TO GROUND	13.5
		GROUND CABLE	1	POST MOUNTED	6

CABLE PLAN, PHASE DESIGNATION DIAGRAM AND SCHEDULE OF QUANTITIES

RIDGE AVE. @ LAKE ST.
EVANSTON, ILLINOIS

NO.	DATE	DESCRIPTION
Δ	06-08-06	MISCELLANEOUS REVISION
Δ	11-16-06	DETECTOR LOOPS AND SYSTEM DETECTOR LOOPS TO BE INSTALLED BY OTHERS AT A LATER DATE
Δ	11-15-06	EVP REVISIONS

PROPOSED EMERGENCY VEHICLE PREEMPTORS	
EMERGENCY VEHICLE PREEMPTOR	3 4
MOVEMENT	← → ↑ ↓

I.D.O.T. TRAFFIC SIGNAL INSTALLATION ELECTRICAL SERVICE REQUIREMENTS					TOTAL WATTAGE
TYPE	NO. OF LAMPS	XINCAND	LED	XX OPERATIONS	
SIGNAL (RED)	12	135	17	0.50	102
(YELLOW)	12	135	25	0.25	75
(GREEN)	12	135	15	0.25	45
ARROW		135	12	0.10	
PED. SIGNAL	8	90	25	1.00	200
CONTROLLER	1	100	100	1.00	100
ILLUM. SIGN		84		0.05	
FLASHER				0.50	
ENERGY COSTS TO:	TOTAL =				522

ENERGY COSTS - BILLED TO: CITY OF EVANSTON (ADDRESS)

ENERGY SUPPLY - CONTACT: MIKE LYNCH (847) 291-3329 PHONE: COMPANY: COMED

CITY OF EVANSTON

41_cp.dgn

T41

SCALE: NOT TO SCALE
DATE: APRIL 28, 2006

DRAWN BY: DWS
CHECKED BY: PAW