

Section
99-00215-00-TL
Sheet 45

SCHEDULE OF QUANTITIES		
QTY	UNIT	ITEM DESCRIPTION
336	FOOT	THERMOPLASTIC PAVEMENT MARKING-LINE 8"
94	FOOT	THERMOPLASTIC PAVEMENT MARKING-LINE 24"
15	EACH	SERVICE INSTALLATION, POLE MOUNTED CONDUIT IN TRENCH, 2 1/2" DIA., GALVANIZED STEEL
10	FOOT	CONDUIT IN TRENCH, 5" DIA., GALVANIZED STEEL
628	FOOT	CONDUIT PUSHED, 2" DIA., GALVANIZED STEEL
15	FOOT	CONDUIT PUSHED, 2 1/2" DIA., GALVANIZED STEEL
41	FOOT	CONDUIT PUSHED, 3" DIA., GALVANIZED STEEL
191	FOOT	CONDUIT PUSHED, 4" DIA., GALVANIZED STEEL
7	EACH	HANDHOLE
2	EACH	HEAVY-DUTY HANDHOLE
1	EACH	DOUBLE HANDHOLE
25	FOOT	TRENCH AND BACKFILL FOR ELECTRICAL WORK
1	EACH	FULL-ACTUATED CONTROLLER AND TYPE V CABINET, SPECIAL
1	EACH	MASTER CONTROLLER
1	EACH	TRANSCEIVER - FIBER OPTIC
728	FOOT	ELECTRIC CABLE IN CONDUIT, SIGNAL NO. 14 2C
508	FOOT	ELECTRIC CABLE IN CONDUIT, SIGNAL NO. 14 3C
1300	FOOT	ELECTRIC CABLE IN CONDUIT, SIGNAL NO. 14 5C
1200	FOOT	ELECTRIC CABLE IN CONDUIT, LEAD-IN, NO. 14 1 PAIR
712	FOOT	ELECTRIC CABLE IN CONDUIT, NO. 20 3/C, TWISTED, SHIELDED
382	FOOT	ELECTRIC CABLE IN CONDUIT, SERVICE, NO. 6 2C
402	FOOT	TRAFFIC SIGNAL POST, GALVANIZED STEEL 14 FT.
3	EACH	TRAFFIC SIGNAL POST, GALVANIZED STEEL 18 FT.
2	EACH	CONCRETE FOUNDATION, TYPE A
20	FOOT	CONCRETE FOUNDATION, TYPE D
4	FOOT	SIGNAL HEAD, LED, 1-FACE, 3-SECTION, BRACKET MOUNTED
1	EACH	PEDESTRIAN SIGNAL HEAD, LED, 1-FACE, BRACKET MOUNTED
2	EACH	INDUCTIVE LOOP DETECTOR
5	EACH	DETECTOR LOOP, TYPE 1
546	FOOT	DETECTOR LOOP, TYPE 1
2	EACH	LIGHT DETECTOR
1	EACH	LIGHT DETECTOR AMPLIFIER
5	EACH	PEDESTRIAN PUSH-BUTTON
1	EACH	TEMPORARY TRAFFIC SIGNAL INSTALLATION
1	EACH	REMOVE EXISTING TRAFFIC SIGNAL EQUIPMENT
3	EACH	REMOVE EXISTING HANDHOLE
3	EACH	REMOVE EXISTING CONCRETE FOUNDATION
6	EACH	SIGNAL HEAD, LED, 2-FACE, 3-SECTION, BRACKET MOUNTED
4	EACH	PEDESTRIAN SIGNAL HEAD, LED, 2-FACE, BRACKET MOUNTED
3	EACH	REMOVE EXISTING SERVICE INSTALLATION

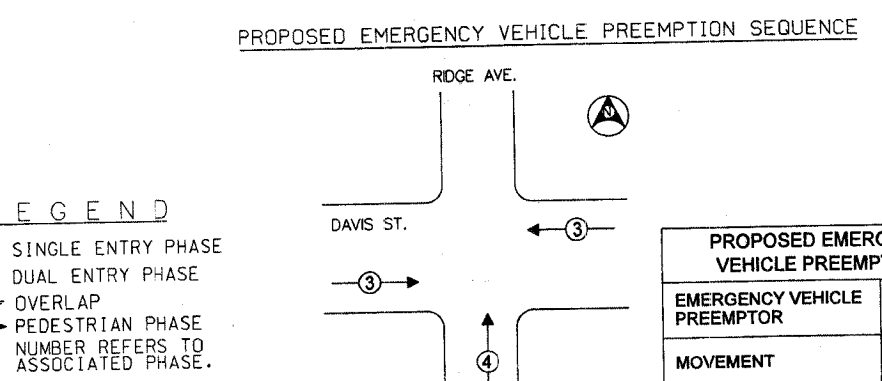
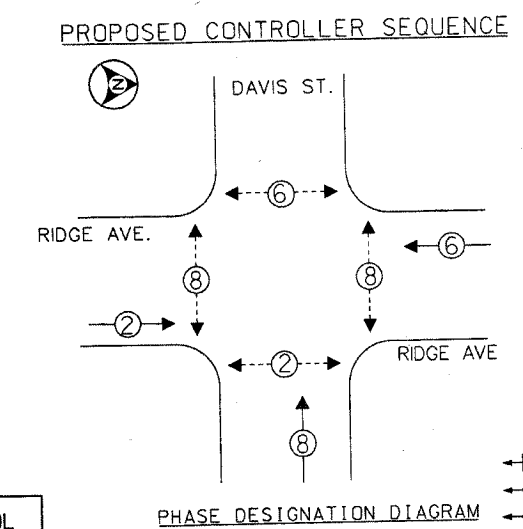
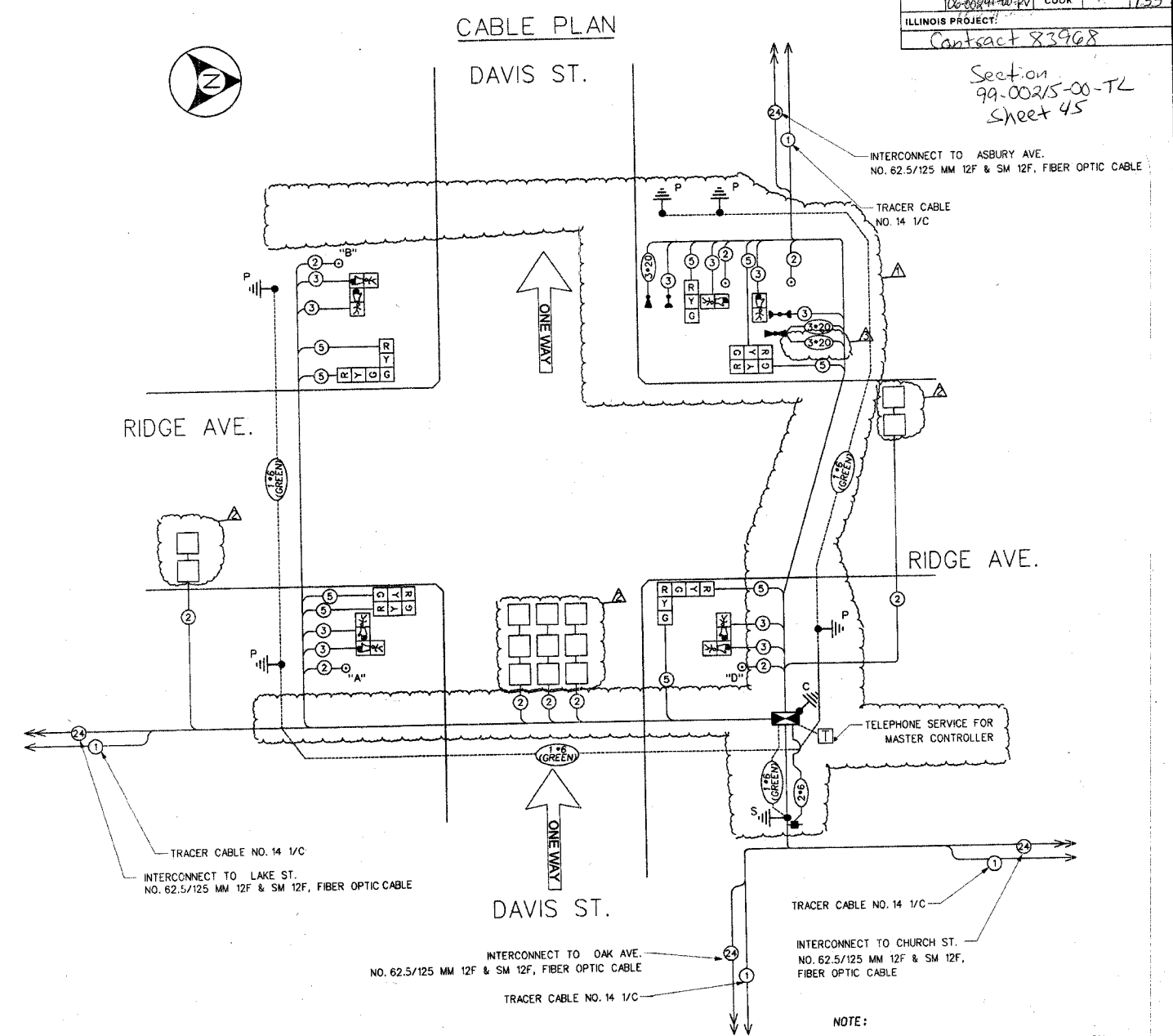
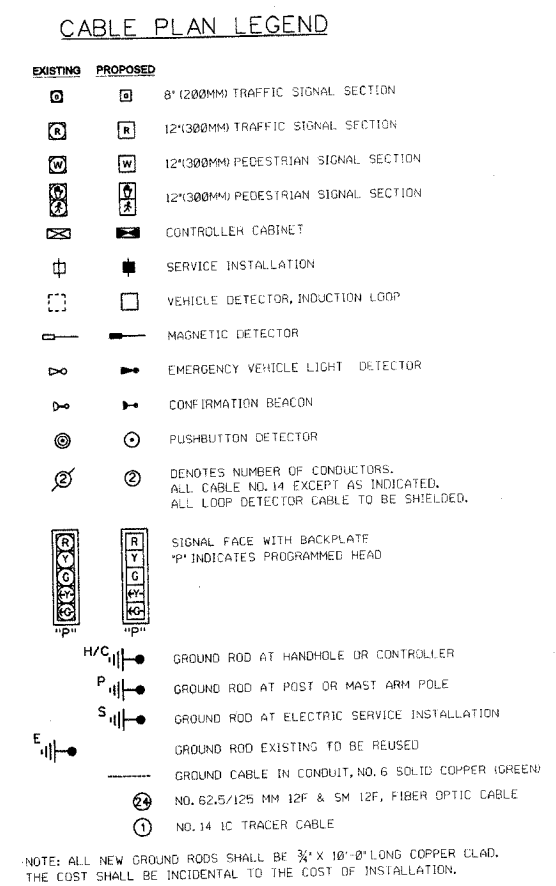

NOTE:

- PUSH BUTTON "A" SHALL PLACE A CALL IN PHASES 2 AND 8
- PUSH BUTTON "B" SHALL PLACE A CALL IN PHASES 6 AND 8
- PUSH BUTTON "D" SHALL PLACE A CALL IN PHASES 8 AND 2

I.D.O.T. TRAFFIC SIGNAL INSTALLATION ELECTRICAL SERVICE REQUIREMENTS					TOTAL WATTAGE
TYPE	NO. OF LAMPS	KINCAND	LED XX OPERATIONS	WATTAGE	
SIGNAL (RED)	9	135	17	0.50	76.5
(YELLOW)	9	135	25	0.25	56.25
(GREEN)	9	135	15	0.25	33.75
ARROW	135	12	0.10		
PED. SIGNAL	8	90	25	1.00	200
CONTROLLER	1	100	100	1.00	200
ILLUM. SIGN				0.05	100
FLASHER				0.50	
TOTAL =				466.5	

ENERGY COSTS - BILLED TO: CITY OF EVANSTON (ADDRESS)

ENERGY SUPPLY - CONTACT: MIKE LYNCH (847) 291-3329 COMPANY: COMED

THE TRAFFIC SIGNAL CONTROL EQUIPMENT FOR THIS PROJECT SHALL BE "EAGLE" TO MATCH THE EXISTING ADJACENT SYSTEM.

FOUNDATION (DEPTH)	(FT.)	CABLE SLACK	(FT.)	VERTICAL	(FT.)
TYPE A - POST	4	HANDHOLE	6.5	ALL FOUNDATIONS	3.5
D - CONTROLLER	4	DOUBLE HANDHOLE	13	MAST ARM (L) POLE	20' ± L-2 =
E - M ARM POLE	2	SIGNAL POST	2	BRACKET MOUNTED	13
24"	10	CONTROLLER CAB.	1	PED. PUSHBUTTON	4
30"	15	FIBER OPTIC	13	ELECTRIC SERVICE	13.5
		ELECTRIC SERVICE	1	SERVICE TO GROUND	13.5
		GROUND CABLE	1	POST MOUNTED	6

REVISIONS

NO.	DATE	DESCRIPTION
1	06-08-06	MISCELLANEOUS REVISION
2	11-15-06	DETECTOR LOOPS AND SYSTEM DETECTOR LOOPS TO BE INSTALLED BY OTHERS AT A LATER DATE
3	11-15-06	EVP REVISIONS

CABLE PLAN, PHASE DESIGNATION DIAGRAM AND SCHEDULE OF QUANTITIES

RIDGE AVE. @ DAVIS ST.
EVANSTON, ILLINOIS

CITY OF EVANSTON
45_cp.dgn

T45

SCALE: NOT TO SCALE
DATE: APRIL 28, 2006

DRAWN BY: DWS
CHECKED BY: PAW