

PLANS FOR PROPOSED FEDERAL-AID HIGHWAY BRIDGE PROGRAM

F.A.S. 1122 (C.H. 21) CHERRY VALLEY ROAD

SECTION 04-00206-00-BR

DEKALB COUNTY

ILLINOIS PROJECT BRS-1122(107)

JOB NO. C-93-030-06

FAS ROUTE NO.	SEC	COUNTY	TOTAL SHEETS	SHEET NO.
1122	21	DEKALB	21	1

ILLINOIS PROJECT BRS-1122(107)
* 04-00206-00-BR
CONTRACT NO. 87316



- INDEX OF SHEETS**
- COVER SHEET
 - SUMMARY OF QUANTITIES
 - SCHEDULE OF QUANTITIES AND TYPICAL SECTIONS
 - PLAN AND PROFILES
 - ROADWAY CROSS SECTIONS
 - GENERAL PLAN AND ELEVATION OF BRIDGE
 - SUPERSTRUCTURE
 - SUBSTRUCTURE - ABUTMENTS
 - ABUTMENT DETAILS
 - STEEL BRIDGE RAIL SIDE MOUNTED
 - PILING DETAILS
 - STORM WATER POLLUTION PREVENTION PLAN

- STANDARDS:**
- 000001-04 STANDARD SYMBOLS, ABBREVIATIONS, & PATTERNS
 - 280001-03 TEMPORARY EROSION CONTROL SYSTEMS
 - 515001-02 NAME PLATE FOR BRIDGES
 - 630001-07 STEEL PLATE BEAM GUARD RAIL
 - 630301-04 SHOULDER WIDENING FOR TYPE 1 TRAFFIC BARRIER TERMINALS
 - 631026-03 TRAFFIC BARRIER TERMINAL, TYPE 5 AND 5A
 - 635006-02 REFLECTOR AND TERMINAL MARKER PLACEMENT
 - 635011-01 REFLECTOR MARKER AND MOUNTING DETAILS
 - 702001-06 TRAFFIC CONTROL DEVICES
 - 780001-01 TYPICAL PAVEMENT MARKINGS
 - BLR 21-6 TYPICAL APPLICATION OF TRAFFIC CONTROL DEVICES
 - BLR 23-1 TRAFFIC BARRIER TERMINAL, TYPE 1
 - BLR 24-1 MAILBOX TURNOUT FOR LOCAL ROADS

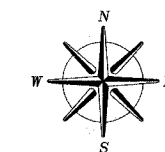
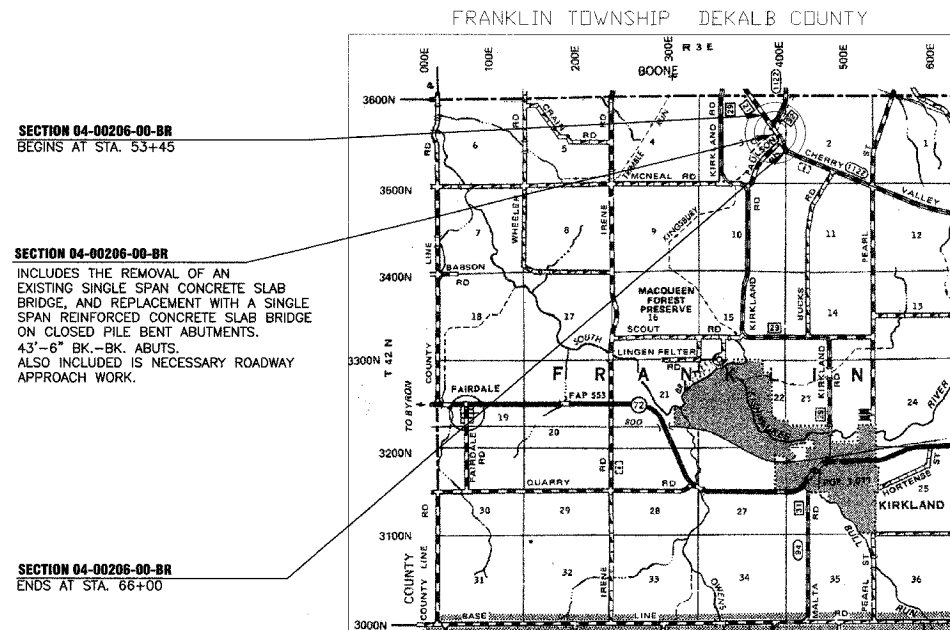

LOCATION MAP

GROSS LENGTH OF SECTION = 1255 FEET (0.24 MILE)
NET LENGTH OF SECTION = 1255 FEET (0.24 MILE)

DESIGN CRITERIA

ROADWAY	DESIGN CLASSIFICATION	ADT 2006	ADT 2026	DESIGN SPEED
CHERRY VALLEY	RURAL COLLECTOR	3950	4500	55
STONE QUARRY	LOCAL ROAD	600	700	55
PAULSON ROAD	LOCAL ROAD	75	100	30

RURAL FAPLHI GUIDELINES

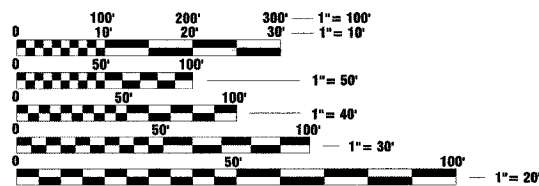

FULL SIZE PLANS HAVE BEEN PREPARED USING STANDARD ENGINEERING SCALES. REDUCED SIZED PLANS WILL NOT CONFORM TO STANDARD SCALES. IN MAKING MEASUREMENTS ON REDUCED PLANS, THE ABOVE SCALES MAY BE USED.

J.U.L.I.E.
JOINT UTILITY LOCATION INFORMATION FOR EXCAVATION
1-800-892-0123

CONTRACT NO. 87316



Scott A. Brown 9-26-07
EXP. 11-30-2007

PLANS PREPARED BY:

WENDLER ENGINEERING SERVICES

DIXON, ILLINOIS
SYCAMORE, ILLINOIS
PRINCETON, ILLINOIS
STERLING, ILLINOIS

STATE OF ILLINOIS
DEPARTMENT OF TRANSPORTATION
DIVISION OF HIGHWAYS

SUBMITTED 9/24 20 07
Wendler [Signature] COUNTY ENGINEER

PASSED 10/01 20 07
Kenneth E. Long DISTRICT 3 ENGINEER OF LOCAL ROADS & STREETS

RELEASED FOR BID BASED ON LIMITED REVIEW 10/01 20 07
George E. Brown DEPUTY DIRECTOR OF HIGHWAYS, REGION 2 ENGINEER

**PRINTED BY THE AUTHORITY
OF THE STATE OF ILLINOIS**