

ROUTE NO.	SECTION	COUNTY	TOTAL SHEETS	SHEET NO.
TR 434	*	IROUOIS	23	21
STA. 20+75.00 TO STA. 21+50.00				
FED. ROAD DIST. NO. 7			PROJECT BROS-075(131)	
* 06-126100-D1-BH			CONTRACT #87356	

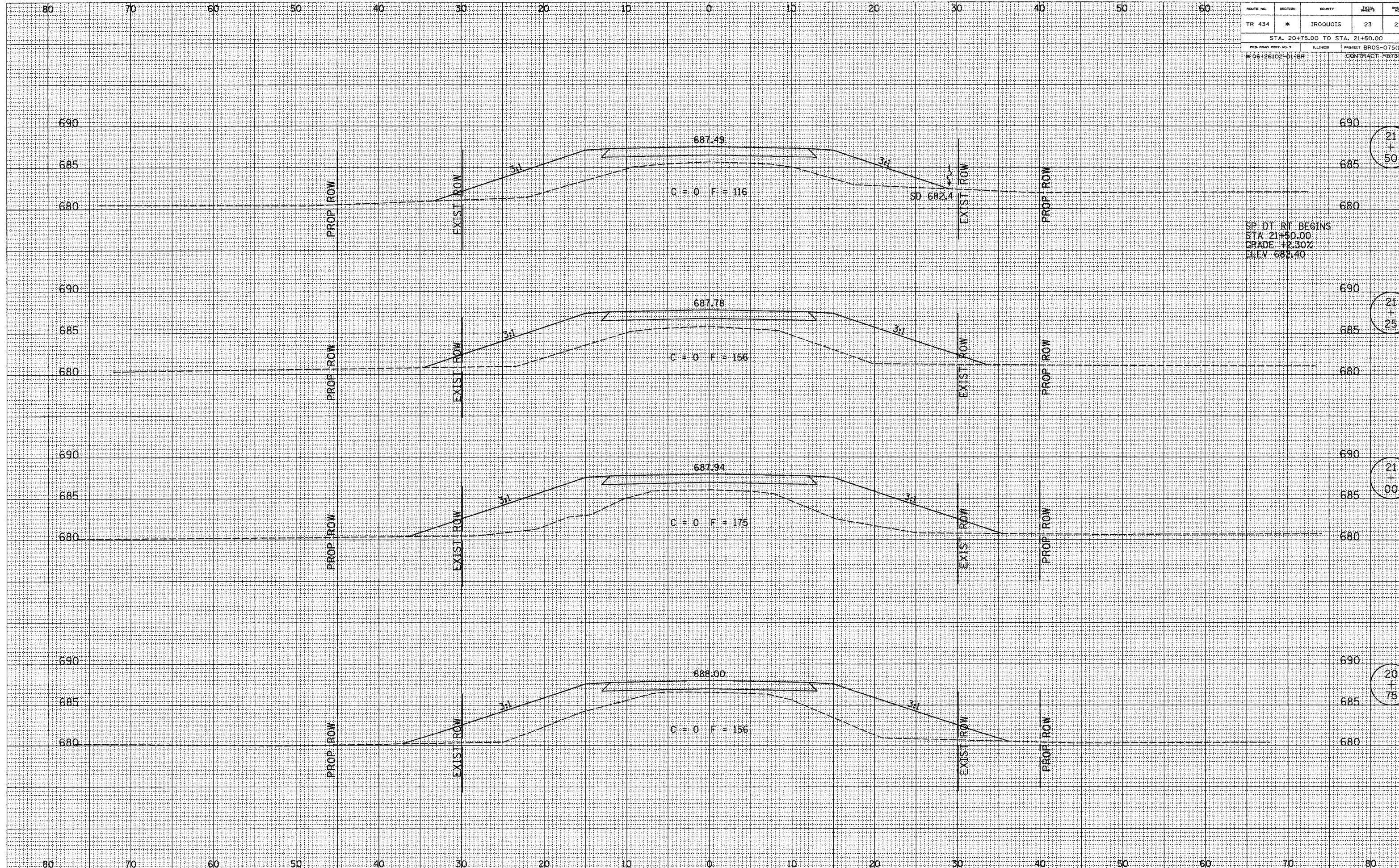

21
+
50

21
+
25

21
+
00

20
+
75

SURVEYED SURVEY
NOTE BOOK TEMPLATE
AREAS AREAS CHECKED

SURVEYED SURVEY
NOTE BOOK TEMPLATE
AREAS AREAS CHECKED